

Complaint # \_\_\_\_\_

## SANITATION COMPLAINT

\*\*\*\*\*

Date 8-27-2024

Phone# (910) (919) 984-220-2586

Name of Complainant Frank Olds [ ] ANONYMOUS

☒ Sewer [ ] Solid Waste [ ] Other \_\_\_\_\_

Nature of Complaint Water from leach field is going into neighbor's yard.

Directions to site of Complaint 84 Lahinch Drive Fuquay Varina NC  
Lot # 127 Avery Pond

Owner of property site Thomas & Michele Hoffman

Address and/or phone # 2708 Brighton Bluff Drive Apex NC 27539-8711

\*\*\*\*\*

### Inspection Information

DATE \_\_\_\_\_ TIME \_\_\_\_\_ PERFORMED BY \_\_\_\_\_

PROBLEM(S) FOUND \_\_\_\_\_

### Correction of Problem

DATE \_\_\_\_\_

COMMENTS \_\_\_\_\_

Name \_\_\_\_\_ Date Secured \_\_\_\_\_

HTE# 5FD2005-0066

## Harnett County Department of Public Health

No. 26569

PERMIT # NA

## Operation Permit

☒ New Installation ☒ Septic Tank ☒ Nitrification Line ☐ Repair ☐ ExpansionPROPERTY LOCATION: 84 LAMMETH DR. (CHALBEATER RD)Name: (owner) LGI HOMES NC LLC SUBDIVISION AVERY POND LOT # 127System Installer: THORNTONS PLUMBING Registration # 511429Basement with plumbing: ☐ Garage ☒ Number of Bedrooms 3Type of Water Supply: ☐ Community ☒ Public ☐ Well Distance from well NA feetSystem Type: 25% REDUCTION SYS. III B Types V and VI Systems expire in 5 years.

(In accordance with Table V a)

Owner must contact Health Department 6 months prior to expiration for permit renewal.

This system has been installed in compliance with applicable North Carolina General Statutes, Rules for Sewage Treatment and Disposal, and all conditions of the Improvement Permit and Construction Authorization.

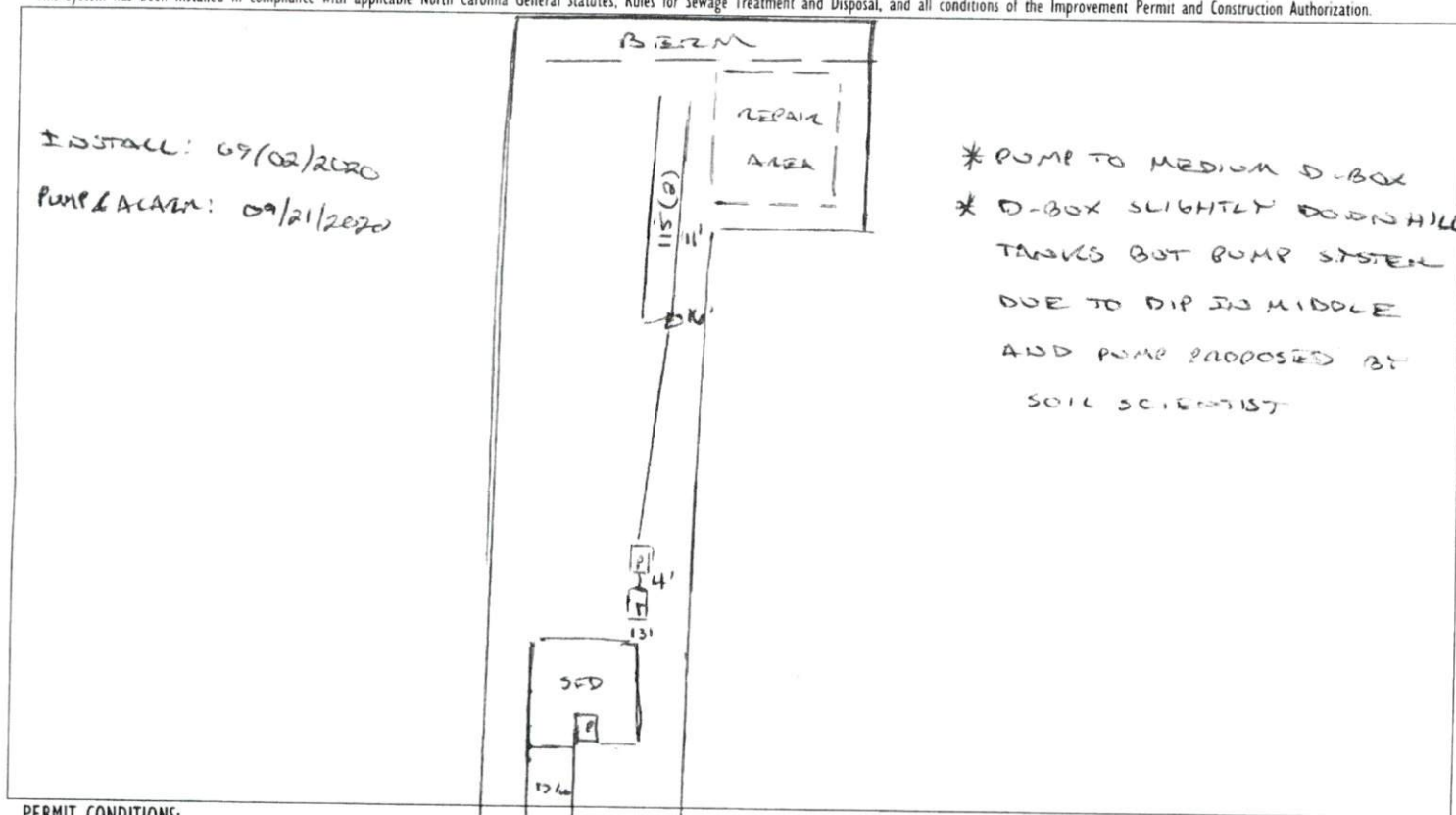

## PERMIT CONDITIONS:

I. Performance: System shall perform in accordance with Rule .1961.

II. Monitoring: As required by Rule .1961.

III. Maintenance: As required by Rule .1961. Other: \_\_\_\_\_

Subsurface system operator required? Yes ☐ No ☐

If yes, see attached sheet for additional operation conditions, maintenance and reporting.

IV. Operation: \_\_\_\_\_

V. Other: \_\_\_\_\_

☐ D-Box ☐ Pump ☐ Alarm ☐ H2O Line ☐ PWR Line

Following are the specifications for the sewage disposal system on the above captioned property.

Type of system: ☐ Conventional ☒ Other IEE FLOW III B Septic Tank: 1000 gallons Pump Tank: 1000 gallonsSubsurface No. of exact length width of depth of  
Drainage Field ditches 2 of each ditch 115 feet ditches 3 feet ditches 18 inches

French Drain Required: \_\_\_\_\_ Linear feet

Authorized State Agent

Date 09/21/2020

## Harnett County Department of Public Health

## Improvement Permit

A building permit cannot be issued with only an Improvement Permit

ISSUED TO: LGI Homes NC LLC

PROPERTY LOCATION: 84 Lahinch Dr. (Chalybeate Rd. - SR 1429)

SUBDIVISION: Avery Pond

LOT # 127

NEW ☒ REPAIR ☐ EXPANSION ☐

Site Improvements required prior to Construction Authorization Issuance:

Type of Structure: 3-Bedroom SFD

Proposed Wastewater System Type: 25% Reduction Sys.

Projected Daily Flow: 360 GPD

Number of bedrooms: 3 Number of Occupants: 6 max

Basement ☐ Yes ☒ NoPump Required: ☒ Yes ☐ No ☐ May be required based on final location and elevations of facilitiesType of Water Supply: ☐ Community ☒ Public ☐ Well Distance from well: NA feetPermit valid for: ☒ Five years  
☐ No expiration

Permit conditions:

Authorized State Agent:

Date: 06/05/2020

SEE ATTACHED SITE SKETCH

The issuance of this permit by the Health Department in no way guarantees the issuance of other permits. The permit holder is responsible for checking with appropriate governing bodies in meeting their requirements. This site is subject to revocation if the site plan, plat, or the intended use changes. The Improvement Permit shall not be affected by a change in ownership of the site. This permit is subject to compliance with the provisions of the Laws and Rules for Sewage Treatment and Disposal and to conditions of this permit.

## Construction Authorization

(Required for Building Permit)

The construction and installation requirements of Rules 1950, 1952, 1954, 1955, 1956, 1957, 1958 and 1959 are incorporated by references into this permit and shall be met. Systems shall be installed in accordance with the attached system layout.

ISSUED TO: LGI Homes NC LLC

PROPERTY LOCATION: 84 Lahinch Dr. (Chalybeate Rd. - SR 14)

SUBDIVISION: Avery Pond

LOT # 127

Facility Type: 3-Bedroom SFD ☒ New ☐ Expansion ☐ RepairBasement? ☐ Yes ☐ No Basement Fixtures? ☐ Yes ☒ No

Type of Wastewater System\*\* 25% Reduction Sys.

(Initial) Wastewater Flow: 360 GPD

(See note below, if applicable ☐)

25% Reduction Sys. (Repair)

## Installation Requirements/Conditions

Septic Tank Size 1000 gallons

Pump Tank Size 1000 gallons

Number of trenches 1

Exact length of each trench 235 feet

Trenches shall be installed on contour at a

Maximum Trench Depth of: 18 inches

(Trench bottoms shall be level to +/- 1/4"

in all directions)

Trench Spacing: 9 Feet on Center

Soil Cover: 6 inches

(Maximum soil cover shall not exceed

36" above the trench bottom)

Pump Requirements: ft. TDH vs. GPM

NA inches below pipe

Aggregate Depth: NA inches above pipe

NA inches total

Conditions: Pump to Serial Dist.; Proposal by Adams Soil Consulting

WATER LINES (INCLUDING IRRIGATION) MUST BE 10FT. FROM ANY PART OF SEPTIC SYSTEM OR REPAIR AREA.  
NO UTILITIES ALLOWED IN INITIAL OR REPAIR DRAIN FIELD AREA.

\*\*If applicable: I understand the system type specified is different from the type specified on the application. I accept the specifications of this permit.

Owner/Legal Representative Signature:

Date:

This Construction Authorization is subject to revocation if the site plan, plat, or the intended use changes. The Construction Authorization shall not be transferred when there is a change in ownership of the site. This

Construction Authorization is subject to compliance with the provisions of the Laws and Rules for Sewage Treatment and Disposal and to the conditions of this permit.

SEE ATTACHED SITE SKETCH

Authorized State Agent:

Date: 06/05/2020

ANDREW CORBIN

Construction Authorization Expiration Date: 06/05/2025



Application # SFD2005-0060

## Harnett County Department of Public Health Site Sketch

Property Location: 84 Lahinch Dr. (Chalybeate Road - Sr 1429)

Issued To: LGI Homes-NC, LLC

Subdivision Avery Pond

Lot # 127

Authorized State Agent: \_\_\_\_\_

*Andrew W. ...*  
ANDREW W. ...

Date: 06/03/2020

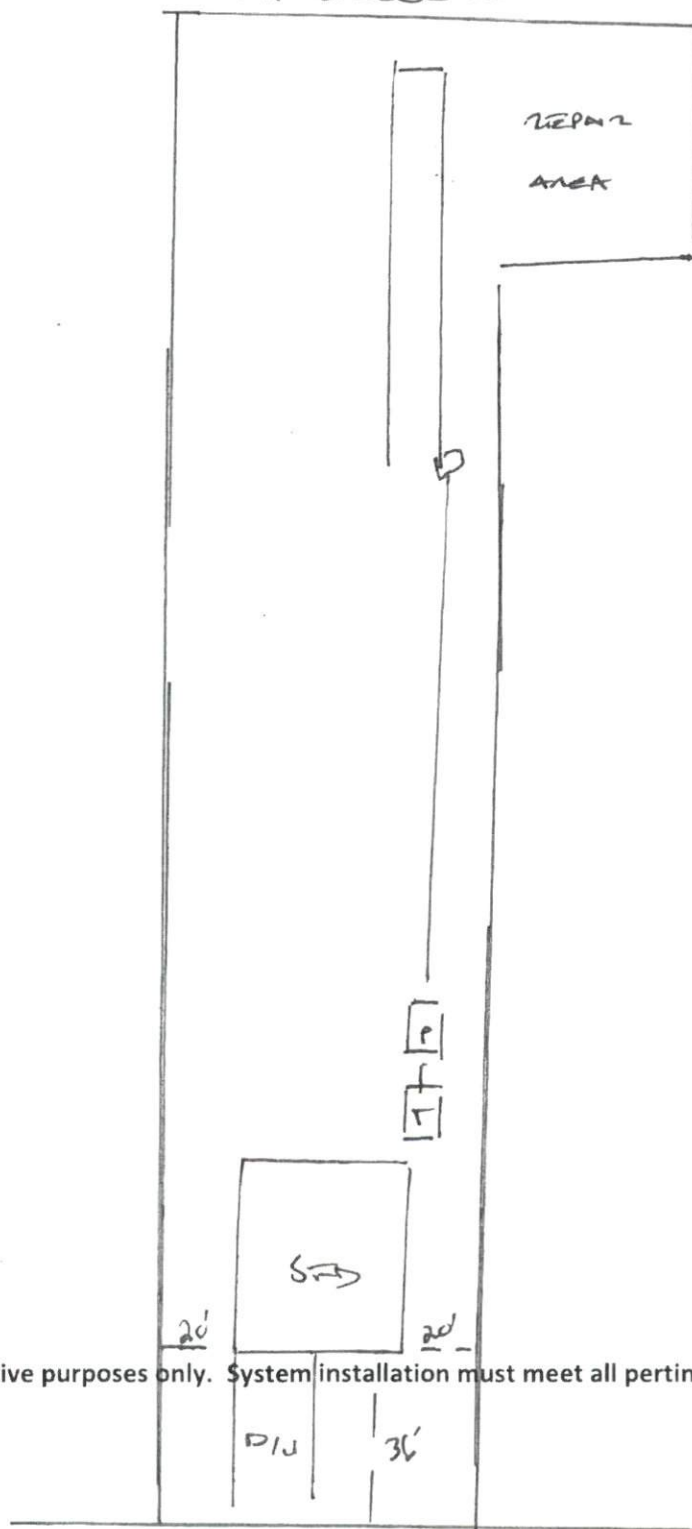

This drawing is for illustrative purposes only. System installation must meet all pertinent laws, rules, and regulations.



## Harnett County GIS

**PID:** 08065401 0090 17

**PIN:** 0653-34-6766.000

**Account Number:** 1500063734

**Owner:** HOFFMANN THOMAS TRUSTEE & HOFFMANN MICHELE CORINNE TRUSTEE

**Mailing Address:** 2708 BRIGHTON BLUFF DR APEX, NC 27539-8771

**Physical Address:** 84 LAHINCH DR FUQUAY-VARINA, NC 27526 ac

**Description:** LOT#127 AVERY POND S/D PH IIID MAP#2019-417

**Surveyed/Deeded Acreage:** 1

**Calculated Acreage:** 0.88

**Deed Date:** 1714971600000

**Deed Book/Page:** 4233 - 2209

**Plat(Survey) Book/Page:** 2019 - 417

**Last Sale:** 2024 - 5

**Sale Price:** \$0

**Qualified Code:** E

**Vacant or Improved:** I

**Transfer of Split:** T

**Actual Year Built:** 2020

**Heated Area :** 1317 SqFt

**Building Count :** 1

**Building Value:** \$195570

**Parcel Outbuilding Value:** \$0

**Parcel Land Value:** 62220

**Market Value:** \$257790

**Deferred Value:** \$0

**Total Assessed Value:** \$257790

**Zoning:** RA-30 - 0.88 acres (100.0%)

**Zoning Jurisdiction:** Harnett County

**Wetlands:** No

**FEMA Flood:** Minimal Flood Risk

**Within 1mi of Agriculture District:** Yes

**Elementary School:** Northwest Harnett Elementary

**Middle School:** Harnett Central Middle

**High School:** Harnett Central High

**Fire Department:** Northwest Harnett

**EMS Department:** Medic 16

**Law Enforcement:** Harnett County Sheriff

**Voter Precinct:** Northwest Harnett

**County Commissioner :** Lewis Weatherspoon

**School Board Member:** Duncan Jagers

