

Date: 2-3-17

Application# 17-50040569

## PROCEDURES AND GUIDELINES FOR MANUFACTURED HOME INSPECTIONS

### RA-20R & RA- 20M Certification Criteria

I, \_\_\_\_\_, understand that because I'm located in a RA-20R or RA-20M Zoning District and wish to place a manufactured home in this district I must meet the following criteria, verified by zoning inspection approval, before I will be issued a certificate of occupancy for this home.

1. The home must have a pitched roof, for a manufactured home, whether A-shaped or rounded, which has a minimum rise (measured at the center of the home) of twelve (12) inches for every seven (7) feet of total width of the home. (Example: A home measuring fourteen (14 ft.) in width must have a twenty four (24) inch rise as measured from the center of the roofline to the baseline of the roof.) (See illustrations Below.)

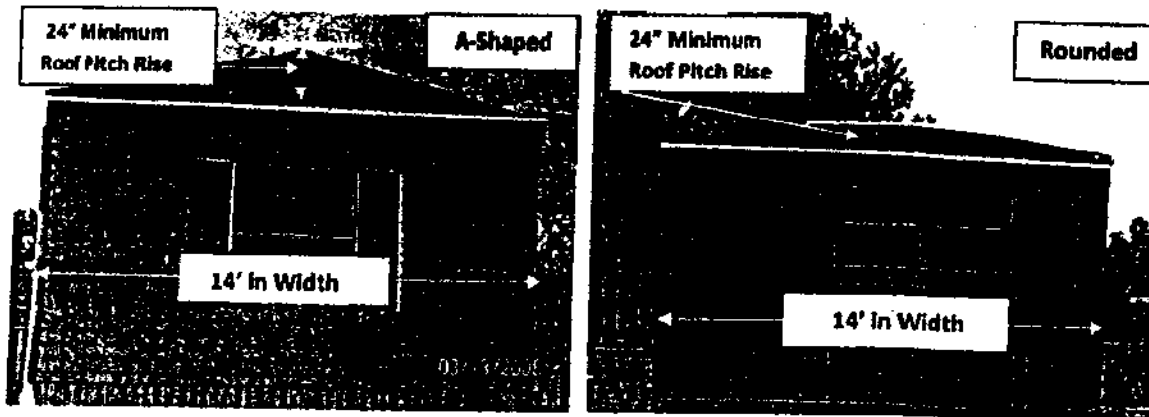

Note: Most Rounded Roofs **Will Not Meet** The Roof Pitch Requirement As Illustrated. The Measurement From The Peak Of The Roof To The Base Line Of The Roof Must Be 12" For Every 7' Of Total Width Of The Home. (Ex: 14' Wide Home = 24" Roof Rise)

Continued.....

2. The home must be underpinned, consisting of a brick curtain wall or have galvanized metal sheeting, ABS or PBC plastic color skirting with interlocking edges, installed around the perimeter of the home. Skirting shall be consistent in appearance, in good condition, continuous, permanent, and unpierced except for ventilation and access.
3. The homes moving apparatus must be removed, underpinned, or landscaped. (See examples below.)

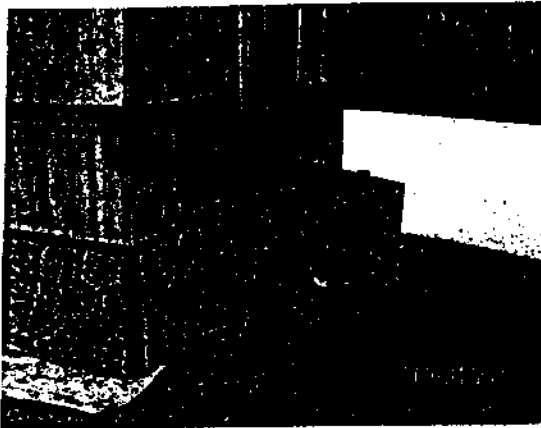

4. The home must have been constructed after July 1<sup>st</sup> 1976.

*Ashley Subanna* <sup>able</sup> *Beper*

Signature of Property Owner / Agent

*Feb 3, 2017*

Date

- By signing this form the owner / agent is stating that they have read and understand the information on this form.