



3PLU 2308-0003

3PLU 2305-0002

Initial Application Date: August 2023

Application # \_\_\_\_\_  
DRB # \_\_\_\_\_ CU # \_\_\_\_\_

COMMERCIAL

COUNTY OF HARNETT LAND USE APPLICATION

Central Permitting (Physical) 108 E. Front Street, Lillington, NC 27546 (Mailing) PO Box 65 Lillington NC 27546 Phone: (910) 893-7525 opt # 2 Fax: (910) 893-2793 www.harnett.org/permits

LANDOWNER: Christina Williams Mailing Address: 184 Rodeo Lane

City: Lillington State: NC Zip: 27546 Contact # 910-890-4099 Email: \_\_\_\_\_

APPLICANT: Christina Williams Mailing Address: 184 Rodeo Lane Lillington

City: Lillington State: NC Zip: 27546 Contact # 910-890-4099 Email: \_\_\_\_\_

\*Please fill out applicant information if different than landowner

CONTACT NAME APPLYING IN OFFICE: \_\_\_\_\_ Phone # \_\_\_\_\_

Address: \_\_\_\_\_ PIN: 0640-20-7005

Deed Book Page: 4182, 1573

PROPOSED USE:

- Multi-Family Dwelling No. Units: \_\_\_\_\_ No. Bedrooms/Unit: \_\_\_\_\_
- Business Sq. Ft. Retail Space: \_\_\_\_\_ Type: \_\_\_\_\_ # Employees: \_\_\_\_\_ Hours of Operation: \_\_\_\_\_
- Daycare # Preschoolers: \_\_\_\_\_ # Afterschoolers: \_\_\_\_\_ # Employees: \_\_\_\_\_ Hours of Operation: \_\_\_\_\_
- Industry Sq. Ft: \_\_\_\_\_ Type: \_\_\_\_\_ # Employees: \_\_\_\_\_ Hours of Operation: \_\_\_\_\_
- Church Seating Capacity: \_\_\_\_\_ # Bathrooms: \_\_\_\_\_ Kitchen: \_\_\_\_\_

Accessory/Additional/Other (Size \_\_\_\_\_ x \_\_\_\_\_) Use: \_\_\_\_\_

Water Supply:  County  Existing Well  New Well (# of dwellings using well \_\_\_\_\_) \*Must have operable water before final (Need to Complete New Well Application at the same time as New Tank)

Sewage Supply:  New Septic Tank  Expansion  Relocation  Existing Septic Tank  County Sewer Porta John (4)  
(Complete Environmental Health Checklist on other side of application if Septic)

Comments: Open at 8am on Saturday for 4 wheels. Band playing from 8pm to midnight.  
8/26/23 August 26<sup>th</sup> 2023

If permits are granted I agree to conform to all ordinances and laws of the State of North Carolina regulating such work and the specifications of plans submitted. I hereby state that foregoing statements are accurate and correct to the best of my knowledge. Permit subject to revocation if false information is provided.

Christina Williams  
Signature of Owner or Owner's Agent

8/26/23 8:25:23  
Date

\*\*This application expires 6 months from the initial date if permits have not been issued\*\*

RECORDED DEED (OR OFFER TO PURCHASE) AND PLAT ARE REQUIRED WHEN APPLYING FOR LAND USE APPLICATION

\*\*\*It is the owner/applicants responsibility to provide the county with any applicable information about the subject property, including but not limited to: boundary information, house location, underground or overhead easements, etc. The county or its employees are not responsible for any incorrect or missing information that is contained within these applications.\*\*\*

\*This application expires 6 months from the initial date if permits have not been issued\*

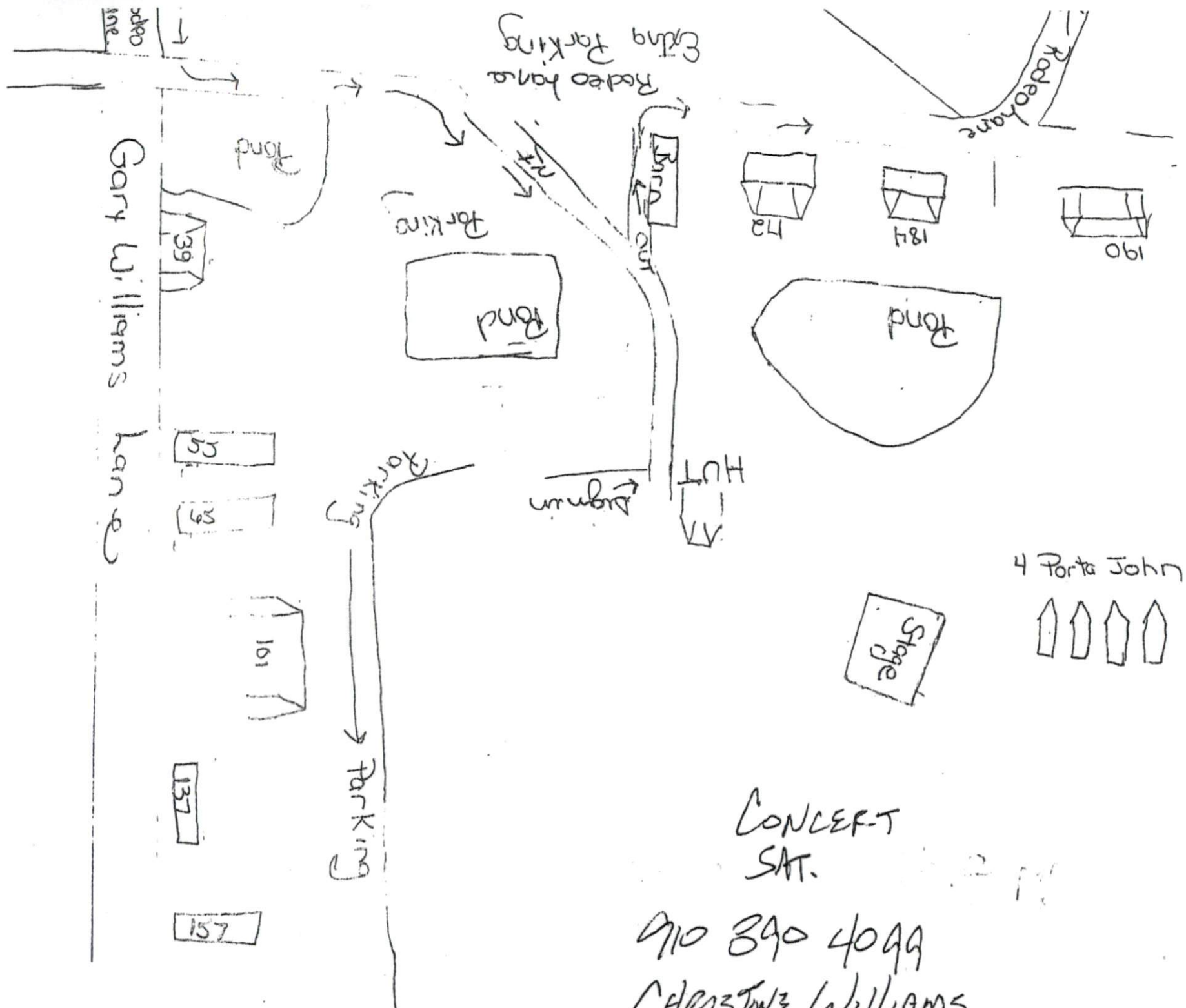

CONCERT  
SAT.  
910 390 4099  
CHRISTINE WILLIAMS

Robert Jones