



Search All

Print

Map Title: Harnett GIS

Layout: Landscape (8.5x11)

Format: PDF

Advanced

Print

Jason + Lori Brown

2729 McNeill Hobbs Rd.

Bunnlevel, NC 28323

Farm# 14844 PIN -0557-67-3005.00

PID- 120557 0015 04

Septic Permit Application

Plot Plan

30'x40' w/12' shed roof on left as facing. Bathroom will be framed into shed roof area

Note: Bathroom is a half bath consisting of 1 toilet + 1 sink. I will have 1 sink in the garage area.

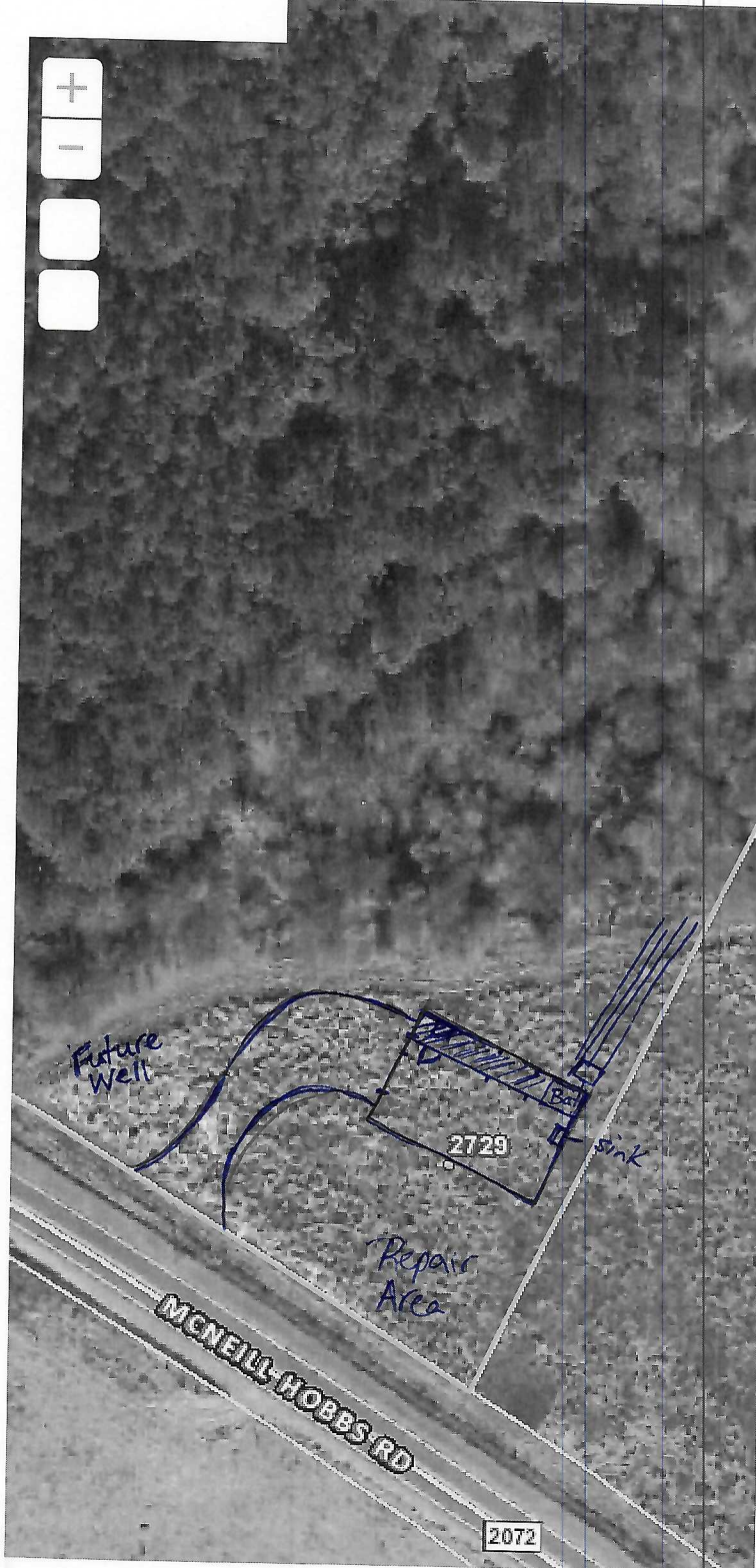

0 50 100ft

-78.811816 35.332072 Degrees

HAL OWEN & ASSOCIATES, INC.

SOIL & ENVIRONMENTAL SCIENTISTS

P.O. Box 400, Lillington, NC 27546-0400

Phone (910) 893-8743 / Fax (910) 893-3594

www.halowensoil.com

1 April 2020

Mr. Jason Brown

Reference: Preliminary Soil Investigation
2729 McNeill Hobbs Road

Dear Mr. Brown,

A site investigation has been conducted for the above referenced property, located on the northern side of McNeill Hobbs Road (SR 2072) in the Stewarts Creek Township of Harnett County, North Carolina. The purpose of this investigation was to determine the site's ability to support subsurface sewage waste disposal systems. All sewage disposal ratings and determinations were made in accordance with "Laws and Rules for Sewage Treatment and Disposal Systems, 15A NCAC 18A .1900". This report represents my professional opinion as a Licensed Soil Scientist but does not guarantee or represent permit approval for any lot by the local Health Department. An improvement permit for all residences will need to be obtained from the Health Department that specifies the proposed home size and location, and the design and location of the septic system to be installed.

A portion of this property was observed to be underlain by soils that are rated as provisionally suitable for modified or alternative subsurface sewage waste disposal (see attached map). These soils are limited in soil depth to the extent that systems that can be installed ultra shallow will likely be required. This requirement will necessitate the addition of approximately 6 inches of topsoil to completely cover the system. It is likely that ultra shallow conventional type systems can be utilized at this site when limited soil depths are observed but you should expect that 100 to 150 feet of conventional drainline would be required for the initial system per bedroom in the home. In addition, an area exists immediately inside the woods line where sediments have collected and the soils were observed to be significantly deeper. It is recommended that you attempt to have your initial septic system installed in that area, which appears adequate to support at least the initial system for a two bedroom structure.

I appreciate the opportunity to provide this service and trust that you will feel free to call on me again in the future. If you have any questions or need additional information, please contact me at your convenience.



Sincerely,

Hal Owen
Licensed Soil Scientist

Preliminary Soil Investigation
2729 McNeill Hobbs Road
1 April 2020

Scale 1 in = 100 ft

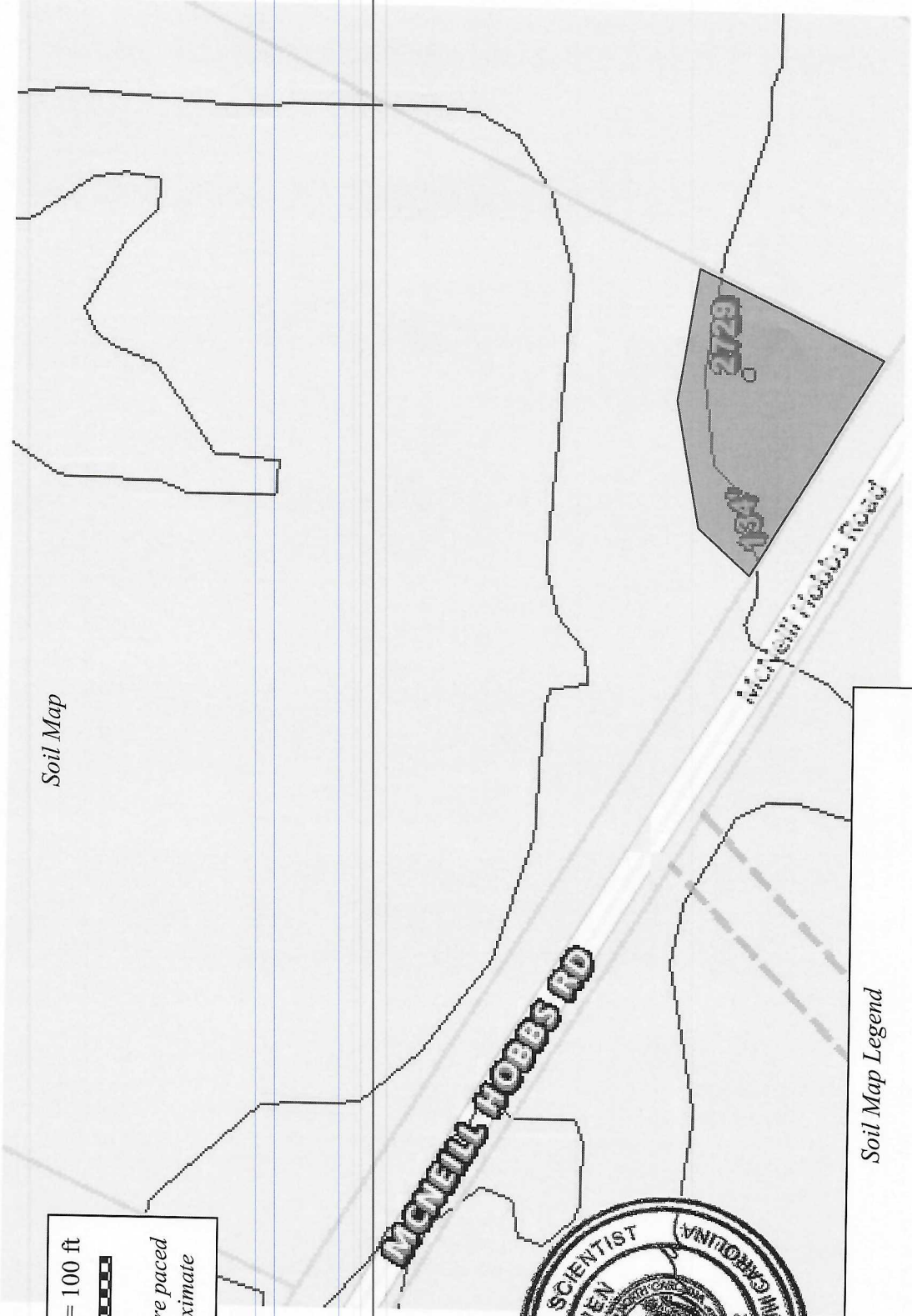
Distances are paced
and approximate



Soil Map Legend

-  Provisionally Suitable Soils for Modified or Alternative Systems