

Synthetic stucco columns approx. 48" X 24" X 24" - Includes a one color Masterwall fine spray finish



6' tall Man

SIGN SPECIFICATIONS

Color: Full Color / RGB text, pictures & video
Pitch: 10mm
Matrix: 90x210
Dimensions: 3'-0" x 7'-0" (Tall x Wide)
Max # of Lines: 13
Max Letter Per Line: 35
Cabinet Size: 3'-0" x 7'-0" (Tall x Wide)
Monument Size: 9'-10" x 11'-0" (Tall x Wide)

Cabinet PMS Color:
PANTONE 350 C
Powdercoat Color RAL 6005

Letters PMS Color:
PANTONE 7506 C
Powdercoat Color RAL 1015

Topper PMS Color:
PANTONE 125 C
Powdercoat Color RAL

Grout PMS Color:
PANTONE 7582 C
Powdercoat Color RAL

See available powdercoat colors:
<https://goldenrulesigns.com/grs-powder-coat>

The Pantone Color Matching System is the sign industry standard for color selection. Computer monitor settings and printer calibration can limit the accuracy between the color you see and the true PMS color when painted. For specialized colors, ask your Project Consultant for a sample.

* Overall sign depth may vary due to support size required by engineering.

First Choice Community Health - Anderson Creek Medical Center

VERSION #: z0927242



6750 Overhills Road #8872
Spring Lake NC 28390

Scope of Work:

Electronic Message Center (EMC):

- 10mm, 90 x 210, 3'-0" x 7'-0", Cellular, Double
- (2) USMB-G3

Fabrication:

Standard ID Cabinet

- Aluminum stick/extrusion frame, skin painted, Routed Aluminum face, saddle mount

Vent Boxes

- (2) .063" aluminum, painted, routed holes for venting per plan

Monument:

- Foamcraft monument per plan

Structural:

- Steel tube per drawings
- New Concrete Caisson, 2,500 PSI







Installation:

- Receive and inspect sign from GRS
- Remove existing sign
- Dig footer, pour concrete, set pole
- Mount and attach sign per drawings
- Connect sign to existing power (to be ran by others)
- Mount and connect Cellular antennas

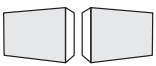
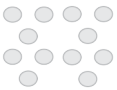
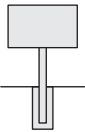
** Take completion photos.**
** Remove and/or level out any excess spoils.**
** Leave a clean job site.**

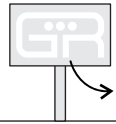
Overview:

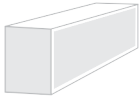

								
Double Sided	10mm	New Footer	GRS Install	GRS Remove Existing Sign	Dedicated Circuit(s)	Cellular Modem	Full Depth Cabinet	Routed Graphic

6.99" [FIRST CHOICE

2.77" [COMMUNITY HEALTH CENTERS

2.72" ["YOUR LINK TO QUALITY CARE"

2.51" [ANDERSON CREEK MEDICAL CENTER

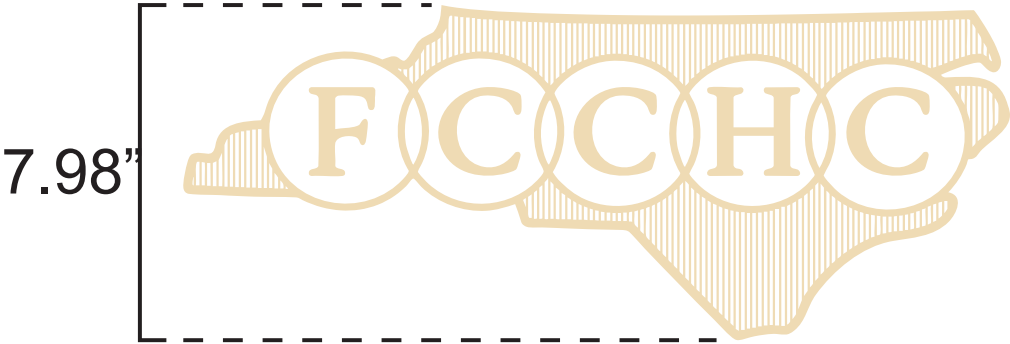

Colors used:

- Cabinet PMS Color: **PANTONE 350 C**
Powdercoat Color RAL 6005
- Letters PMS Color: **PANTONE 7506 C**
Powdercoat Color RAL 1015
- Topper PMS Color: **PANTONE 125 C**
Powdercoat Color RAL
- Grout PMS Color: **PANTONE 7582 C**
Powdercoat Color RAL

Signed Art:



Client is responsible for ensuring that the proof is correct in all areas. Double-check spelling, grammar, layout and design before approving artwork. If a proof containing errors is approved by client, the client is responsible for payment of original cost as well as corrections, revisions, and re-makes. This custom artwork is not intended to provide an exact match between ink, vinyl, paint or EMC color. Brickwork, masonry and landscaping is not included in the proposal unless otherwise specifically stated. EMC images shown are simulated. Sign is designed to be illuminated at all times. Sketches are based off of this premise. This is a custom made product, built by hand for people by people. Small blemishes/imperfections may occur and can be expected with hand made products. Industry standard is to view this product from a minimum distance of 10 feet to determine quality acceptability.

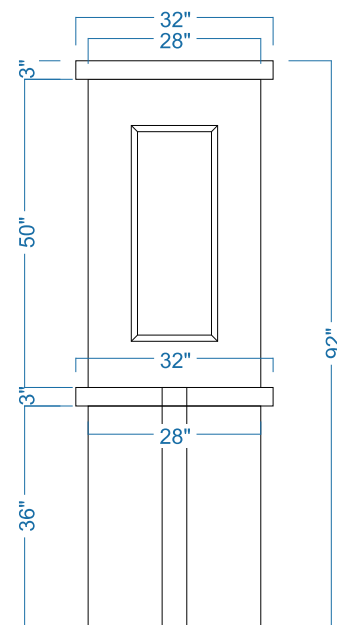
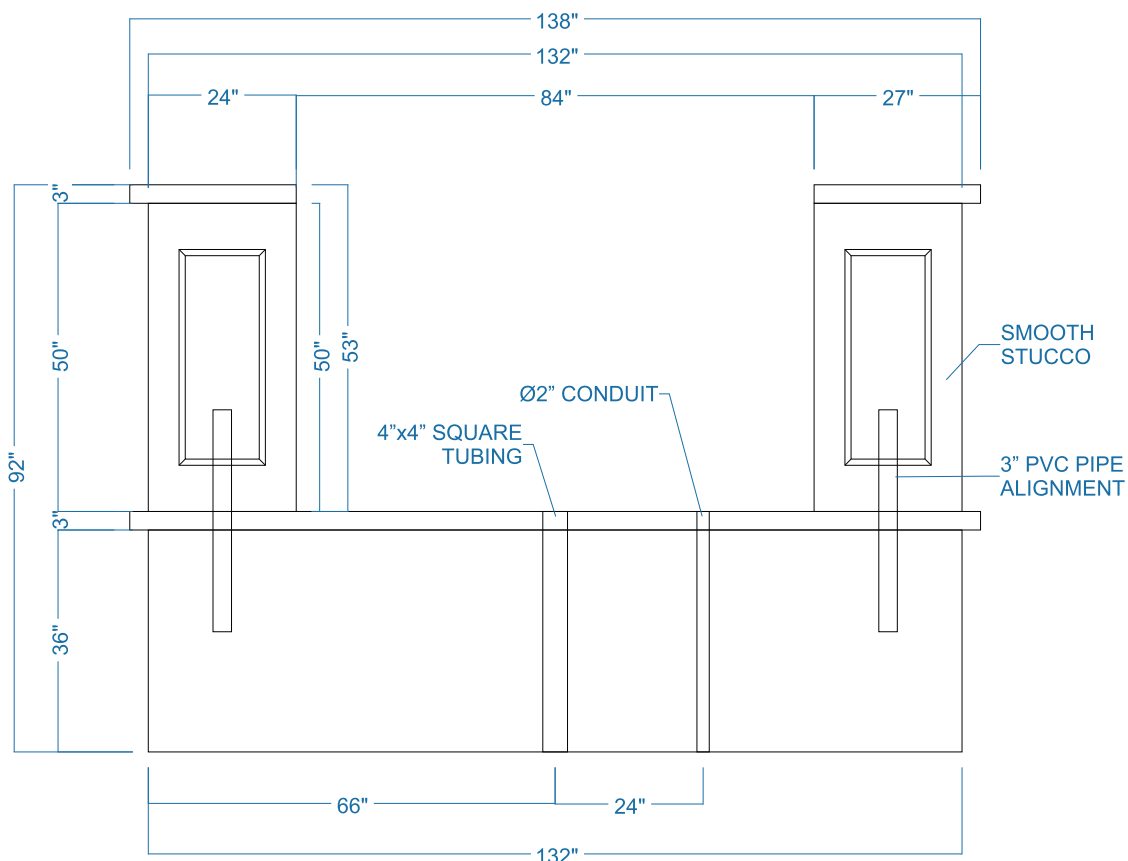

Notes:

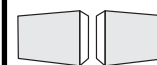

Double
Sided

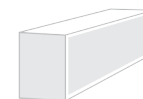

Full Depth
Cabinet

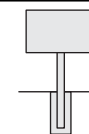

New
Footer

All ID Cabinet electrical components to be wide range power to serve up to 240 volts

LIGHT SENSOR & DISCONNECT

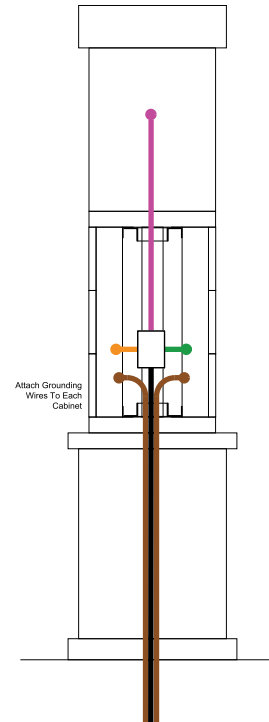
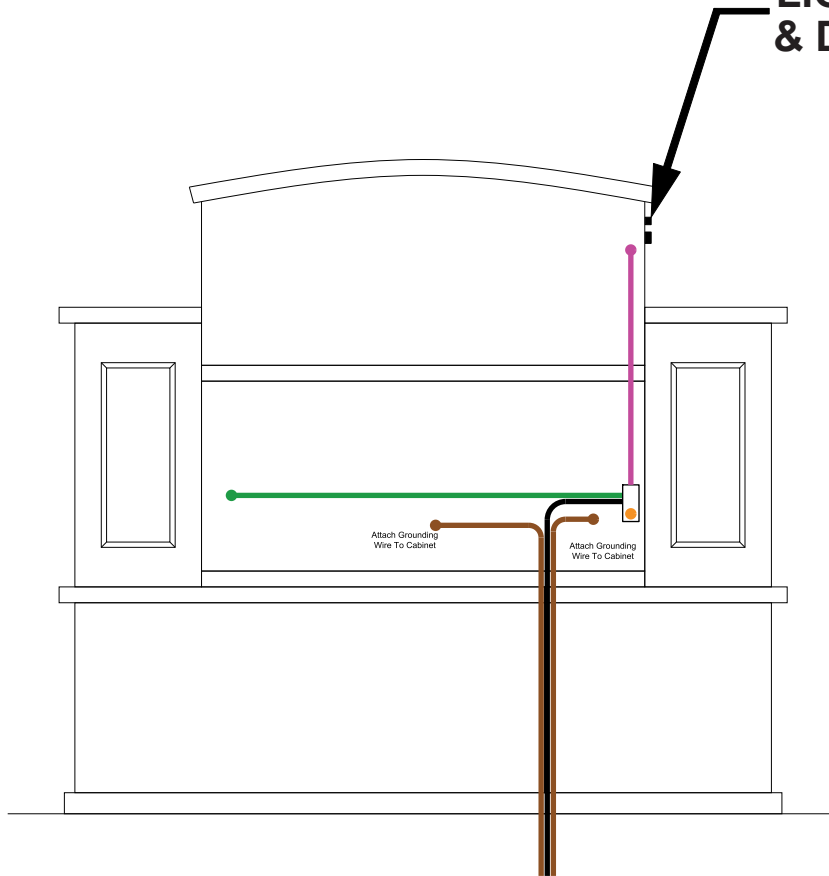

XXX volts

XX amps

Dedicated
Circuit(s)

National Electric Code requires
that lines not exceed 80% load
of any one circuit.

LED
Installation
Manual



Key:

- 6GA. COPPER AND 1/2" ROD X6'
- ID CABINET POWER WHIP
- PRIMARY EMC WHIP
- SECONDARY EMC WHIP
- CLIENT PROVIDED PRIMARY

GRS REQUIRES THAT THE SIGN OPERATE ON AT LEAST 1 DEDICATED CIRCUIT AND RECOMMENDS 1 CIRCUIT PER L.E.D. DISPLAY. WARRANTY REQUIRES EACH L.E.D. DISPLAY TO HAVE A MINIMUM 1/2" COPPER, IN-EARTH GROUND ROD WITH CONTINUOUS 6 GAUGE COPPER WIRE, 6' LONG LOCATED 8 FEET FROM THE BASE OF THE SIGN.

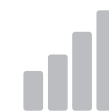

Cellular
Modem

Visit
[resource.
impactledsigns.com](http://impactledsigns.com)
for more details



Notes:

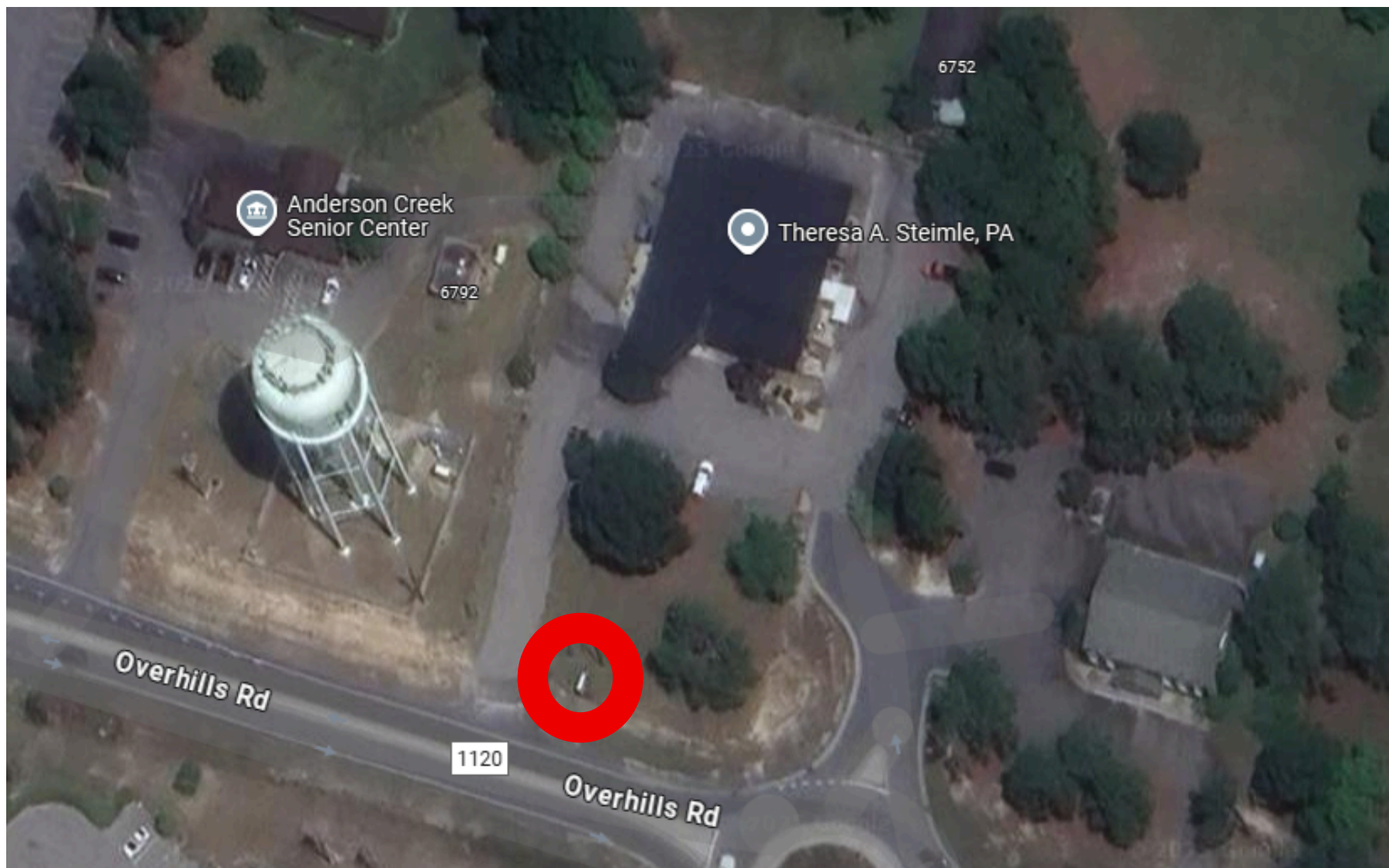

Sign Location: