



# Planning Services Sign Permit Review Form

PO Box 65  
108 E. Front Street  
Lillington, NC 27546  
Ph: (910) 893- 7525 opt. 4  
Fax: (910) 814-6459

Date of Submittal	Application Number	Applicant	Landowner
10/10/2023 Revised 10/24/2023	SIGN2310-0001	Mattamy Homes LLC	Mattamy Homes LLC

Contact Person	Seth Elliot	Contact Number	919-384-6717
Sign Location	NW Corner of Denali Dr. and Ennis Rd.	PIN Number	0682-28-1492.000

Proposed Sign			
Type	Dimensions	Location / Setbacks	Illumination
<input type="checkbox"/> Wall <input checked="" type="checkbox"/> Ground <input type="checkbox"/> Monument <input type="checkbox"/> Directory <input type="checkbox"/> Outdoor Advertising	<b>Height</b> 5' <b>Width</b> 10'  Total Sq. Ft. <b>50</b>	From Ennis Rd – 21’1” From Denali Dr- 21’1”	<input type="checkbox"/> None <input checked="" type="checkbox"/> External <input type="checkbox"/> Internal <input type="checkbox"/> Electronic Message
Total Length of Wall	<b>0</b>	Total Size of Project / Parcel	<input type="checkbox"/> Less Than 1 Acre <input checked="" type="checkbox"/> Greater Than 1 Acre
Total Sq. Ft. Electronic Message Display	<b>0</b>	Pole Style Ground Sign Encasement	Material – Width -

Current Signage			
Current Wall Signs	Current Ground Signs	Distance Between Signs On Property	Distance Between Outdoor Advertising Signs
<b>0</b>		NA	NA

Reviewed By:	Date of Review	Review Results
Sarah Arbour	10/10/2023 2 <sup>nd</sup> Review 11/2/2023	<input checked="" type="checkbox"/> Approved <input type="checkbox"/> Denied  <input type="checkbox"/> More information needed

Comments	Fence cannot be attached to the sign and is not being reviewed or approved as a part of this sign permit. The fence must be located within the buffer area.
----------	---

# Planning Services Sign Permit Review Form

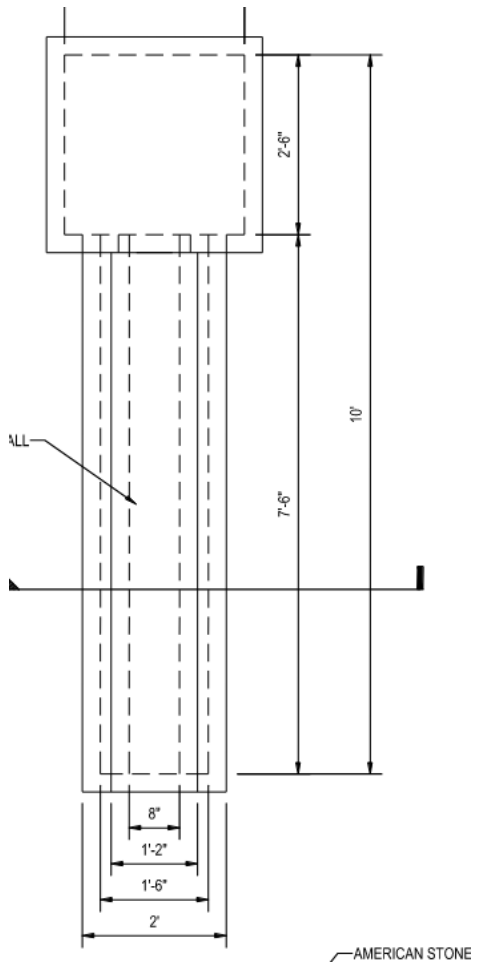
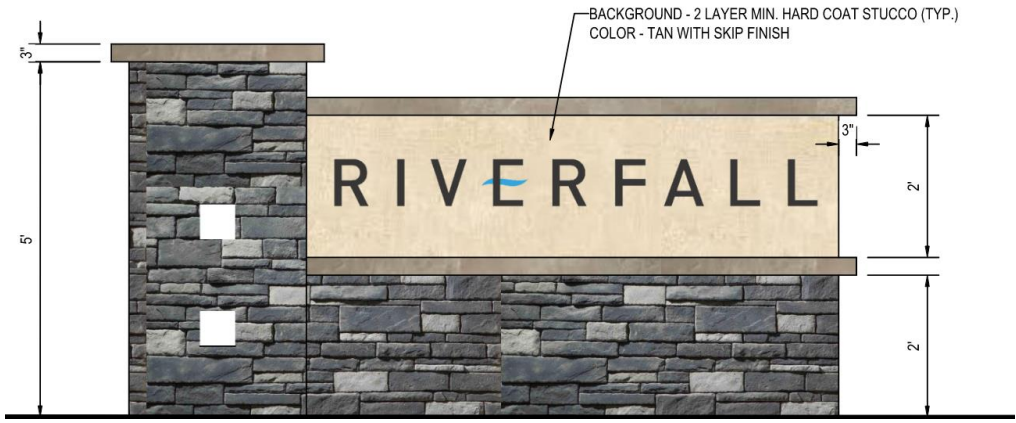

# Planning Services Sign Permit Review Form

