

PLANTING PLAN  
1" = 5'

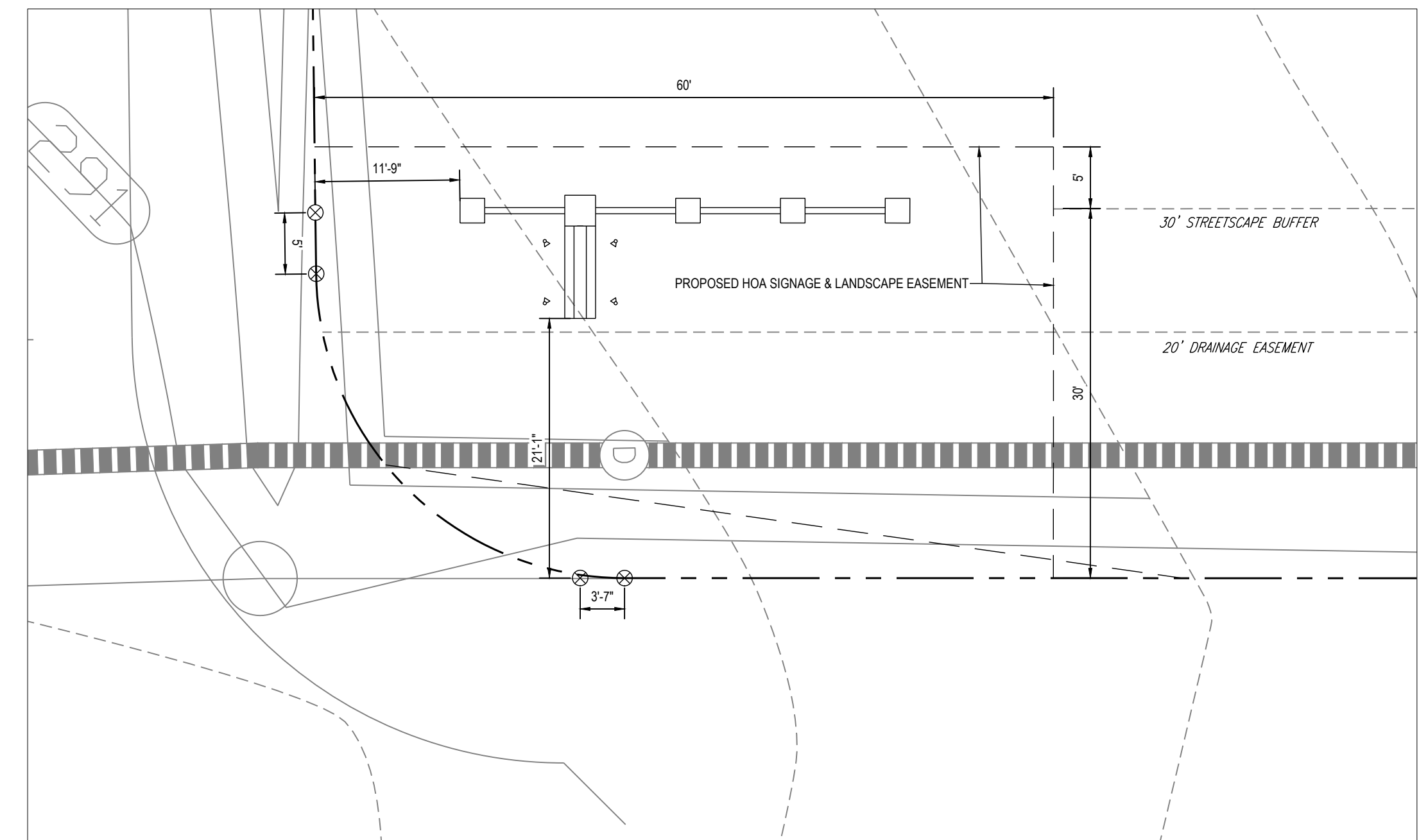

LAYOUT PLAN  
1" = 10'

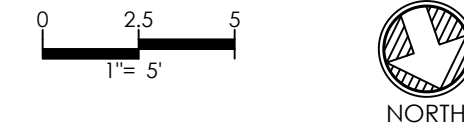
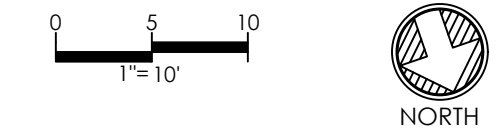

LANDSCAPE SCHEDULE							
KEY	QTY.	BOTANICAL NAME	COMMON NAME	CAL.	CONT.	SIZE	REMARKS
<b>UNDERSTORY TREES</b>							
CCRF	3	<i>Cercis canadensis</i> 'Ruby Falls'	Ruby Falls Redbud	2" CAL	8+8	8-10' HT	Full, Central Leader
SUBTOTAL:	3						
<b>EVERGREEN TREES</b>							
ILNS	2	<i>Ilex x 'Nellie R. Stevens'</i>	Nellie Stevens Holly	2" CAL	8+8	8' HT	Full, Central Leader
SUBTOTAL:	2						
<b>SHRUBS</b>							
FOCO	4	<i>Forsythia 'Coutasar'</i> GOLD TIDE	Forsythia	N/A	5 GAL	24" HT	Full
LCCH	4	<i>Loropetalum chinense</i> 'Cheng Nain Hong'	Ever Red Loropetalum	N/A	5-7 GAL	24" HT	Full
RASW	4	<i>Rhaphiolepis indica</i> 'Snow White'	Snow White Hawthorne	N/A	5-7 GAL	24" HT	Full
SUBTOTAL:	12						

**GENERAL NOTES**

- CONTRACTOR TO STAKE LOCATION AND CONFIRM WITH OWNER PRIOR TO COMMENCEMENT OF CONSTRUCTION.
- OWNER TO CONFIRM ALL MATERIALS AND COLORS PRIOR TO COMMENCEMENT OF CONSTRUCTION.

ALL CONSTRUCTION MUST BE PERFORMED IN ACCORDANCE WITH CURRENT HARNETT COUNTY STANDARDS, SPECIFICATIONS AND DETAILS IN PLACE AT TIME OF PLAN APPROVAL.

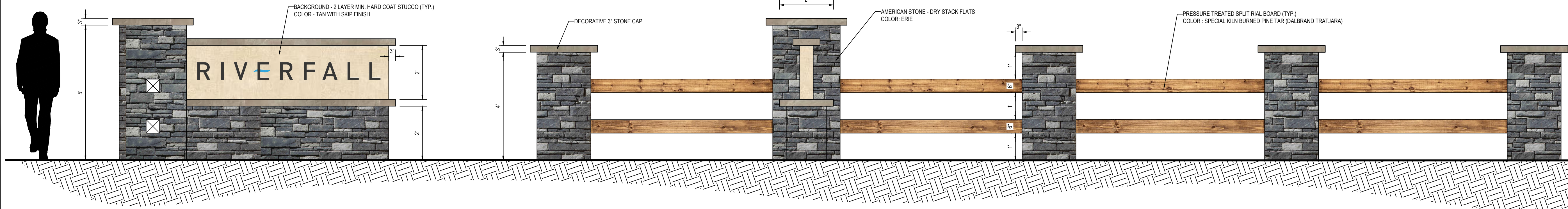
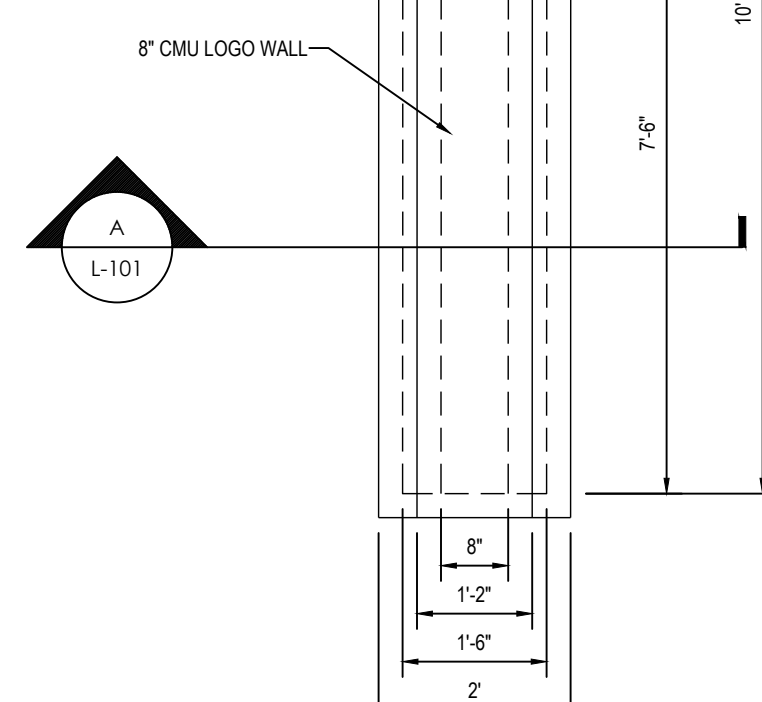
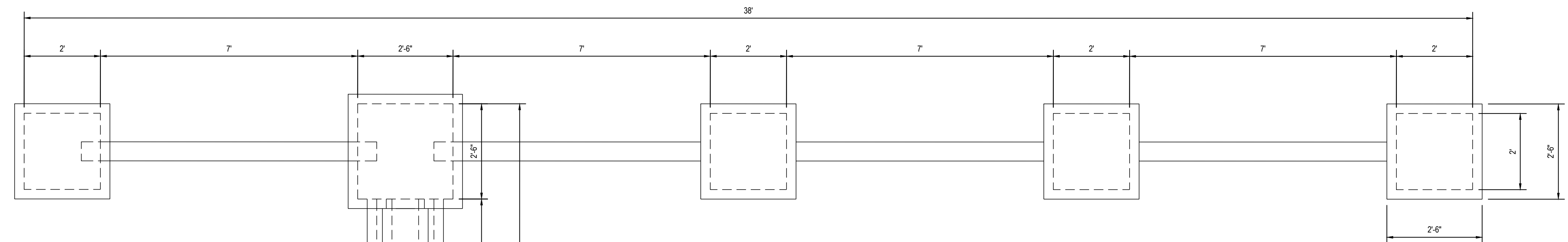

PLAN REVISIONS			
#	DATE	REVISION	BY



PROJECT:  
**RIVERFALL**  
  
ENNIS ROAD  
ANGIER, NC 27501  
  
PROJECT #:  
DRAWN BY:  
REVIEWED BY:  
1ST SUBMITTAL:  
SCALE:

PREPARED FOR:  
**MATTAMY HOMES, LLC**



SHEET:  
**FRONT ENTRANCE MONUMENT**

**L-100**

X:\CIVIL\PROJECTS\2023\C23026 - RIVERFALL DRAWINGS\EXHIBITS\RIVERFALL MONUMENT.DWG PRINTED BY: MICHAEL PETERSON 8/29/23 @ 1:04 PM. LAST SAVED BY: MICHAEL PETERSON

X:\CIVIL\PROJECTS\2023\NC23026 - RIVERFALL DRAWINGS\DWG\PRINTED BY: MICHAEL PETERSON 8/29/23 @ 1:04 PM. LAST SAVED BY: MICHAEL PETERSON

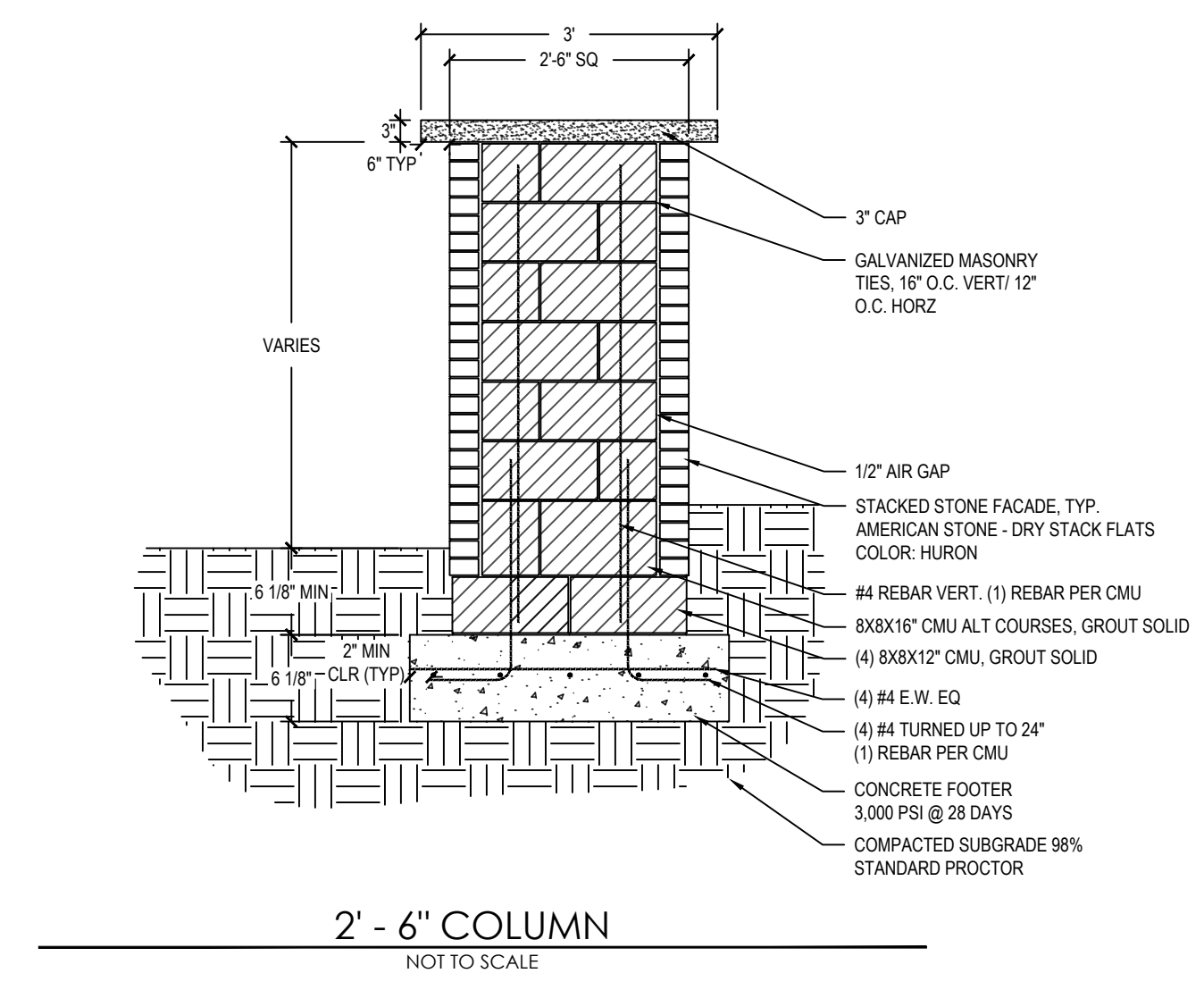

2' - 6" COLUMN  
NOT TO SCALE

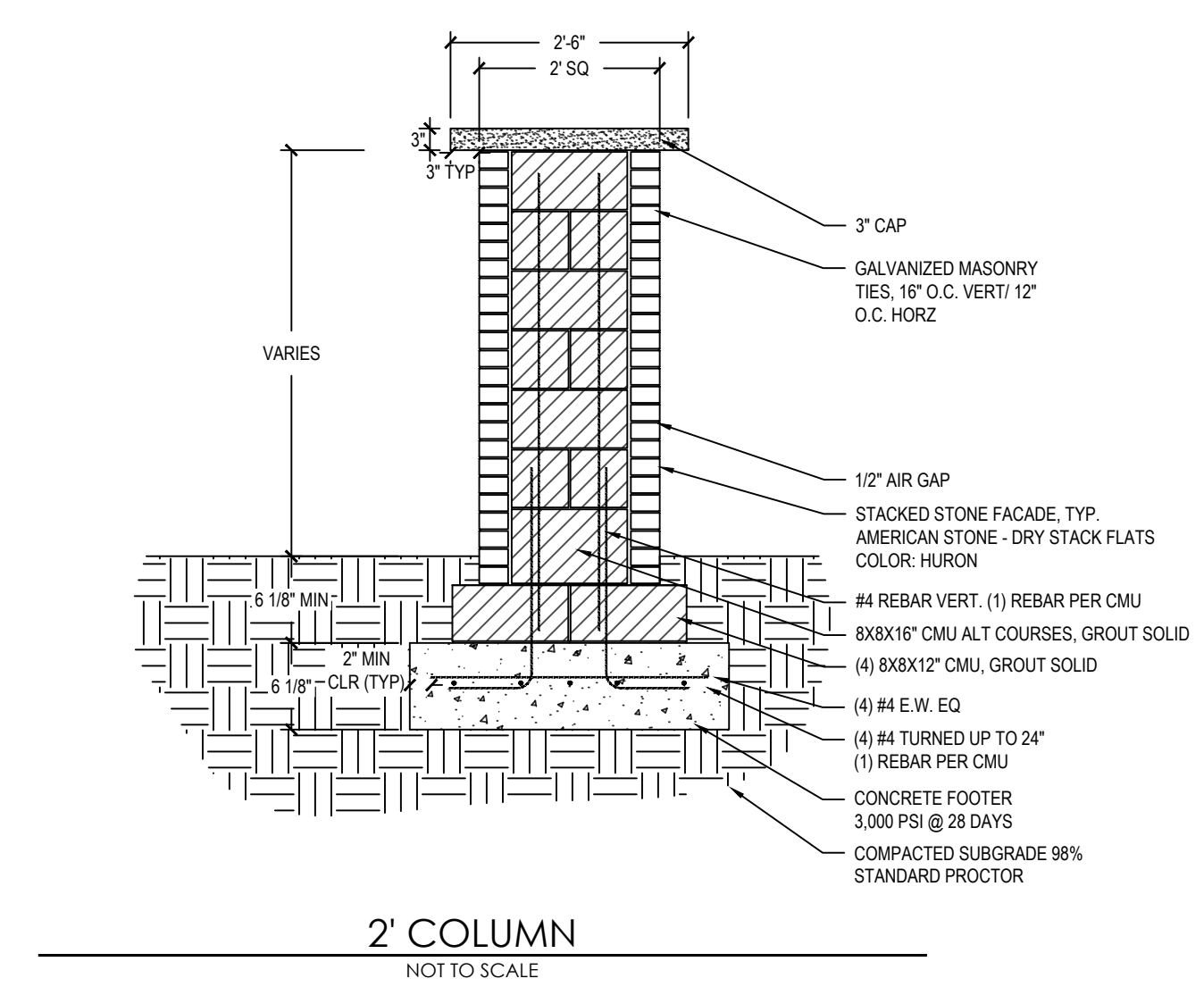

2' COLUMN  
NOT TO SCALE

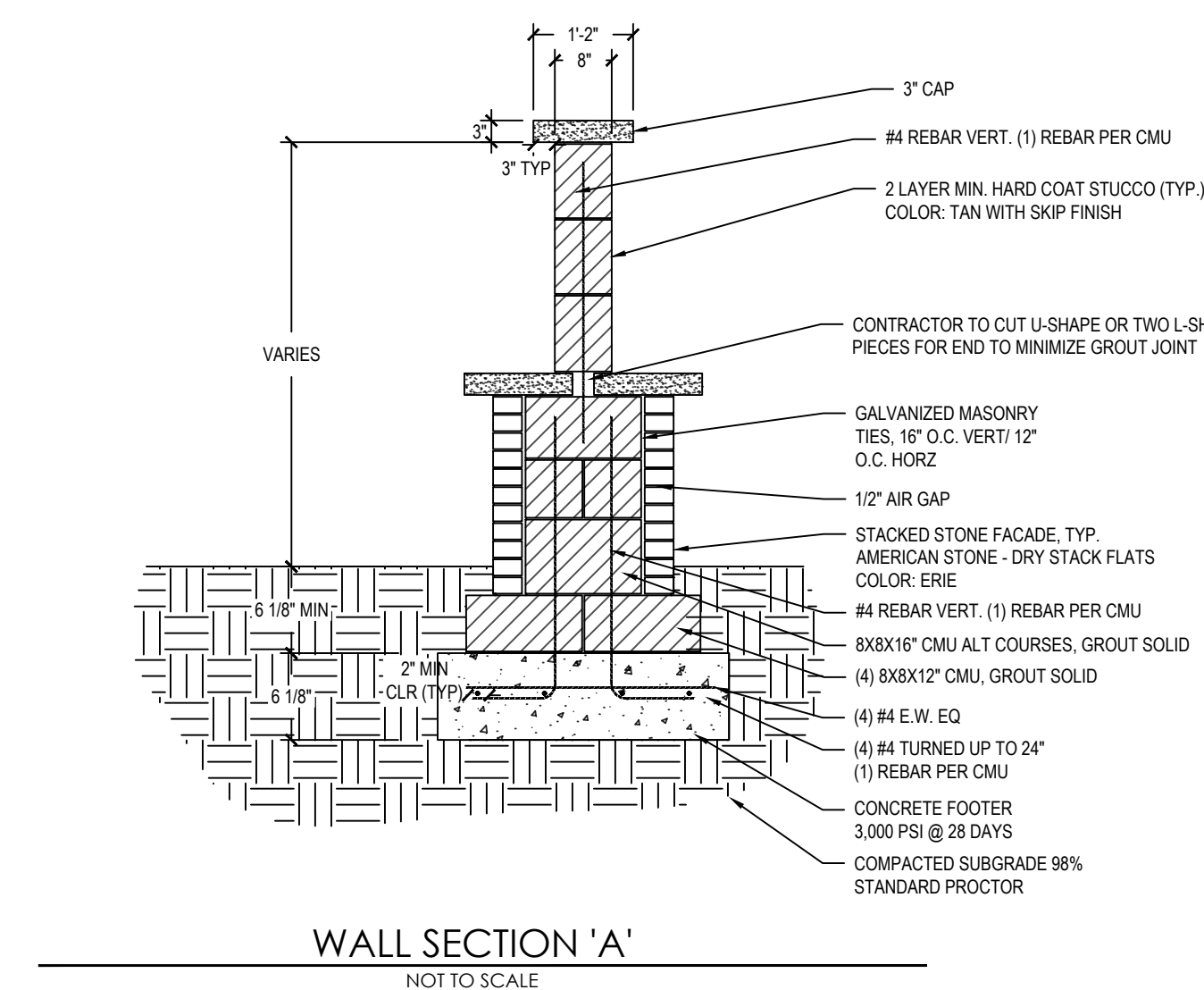

WALL SECTION 'A'  
NOT TO SCALE

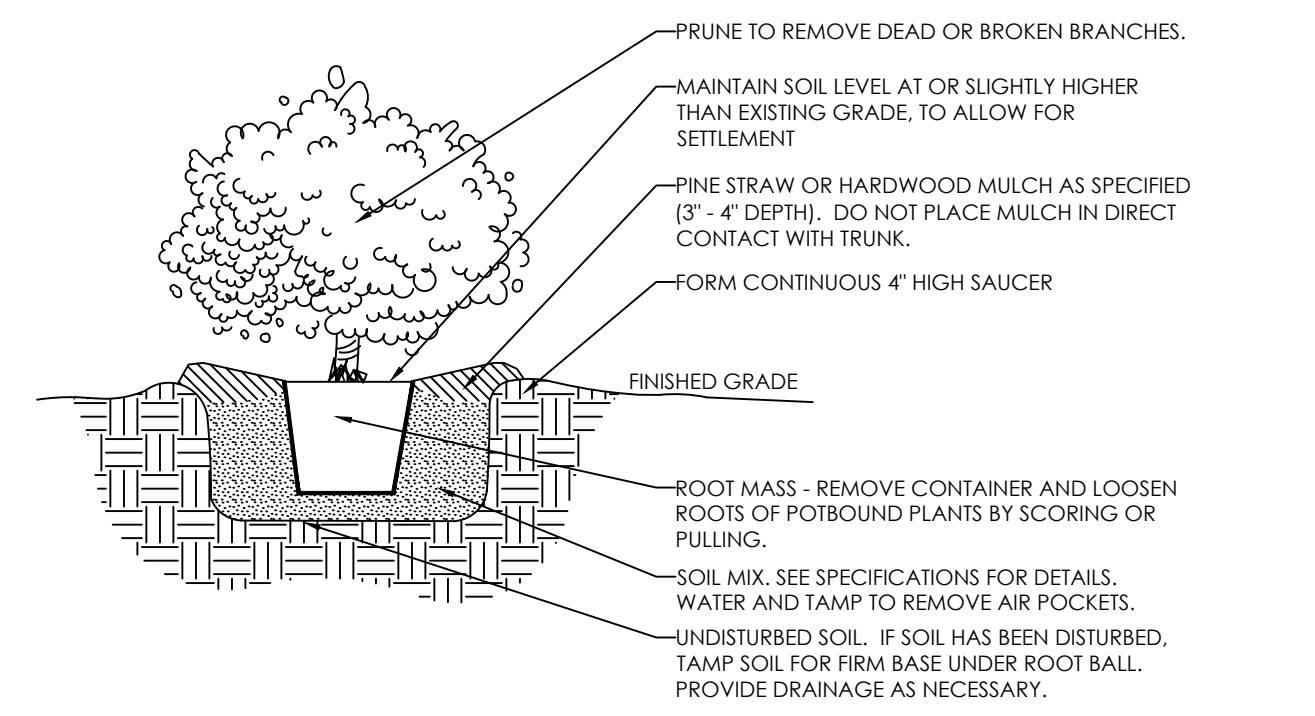

SHRUB PLANTING DETAIL  
NOT TO SCALE

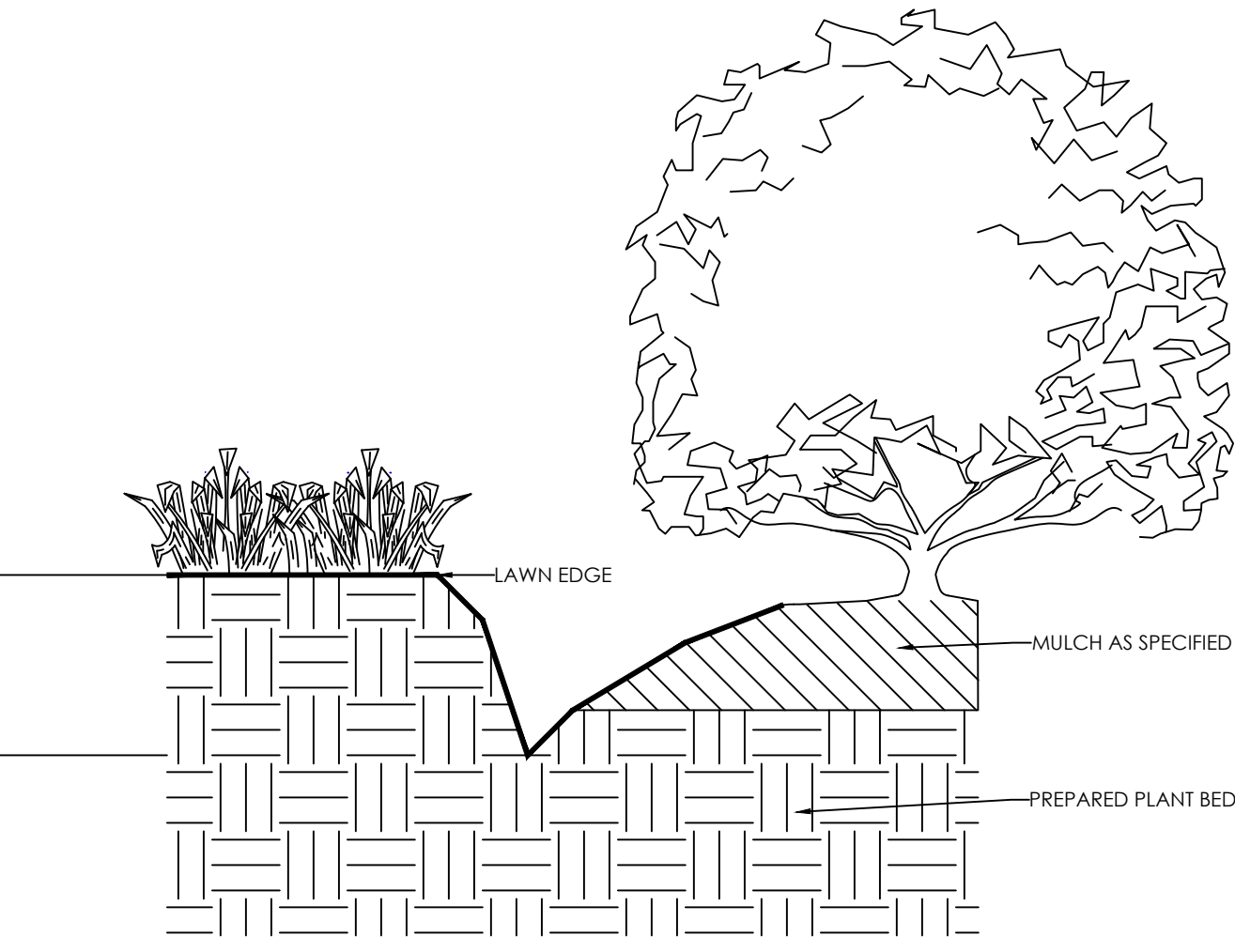

EXCAVATED PLANT BED EDGE  
NOT TO SCALE

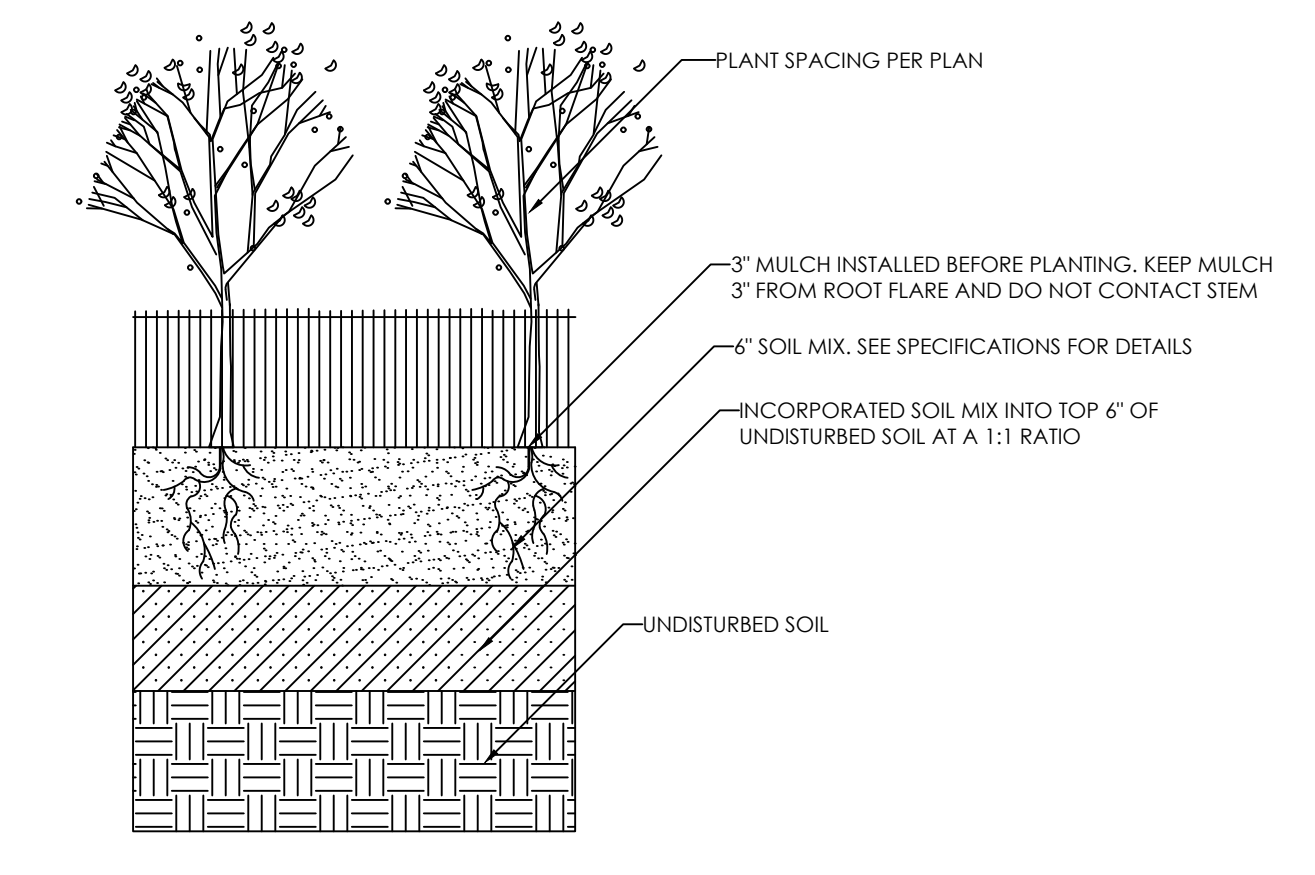

GROUND COVER PLANTING DETAIL  
NOT TO SCALE

LANDSCAPE NOTES

1. THE CONTRACTOR IS RESPONSIBLE FOR ALL QUANTITY TAKE-OFFS AND VERIFICATION OF MATERIALS AS SHOWN ON THESE PLANS AND IN WRITTEN SPECIFICATIONS. THE CONTRACTOR SHALL NOTIFY THE OWNER AND THE LANDSCAPE ARCHITECT OF ANY DISCREPANCIES PRIOR TO FINAL BIDDING OR INSTALLATION.
2. PRIOR TO CONSTRUCTION, THE CONTRACTOR SHALL BE RESPONSIBLE FOR LOCATING ALL EXISTING AND PROPOSED UNDERGROUND UTILITIES AND SHALL AVOID DAMAGE TO ALL UTILITIES DURING THE COURSE OF THE WORK. LOCATIONS OF EXISTING BURIED UTILITY LINES SHOWN ON THE PLANS ARE BASED UPON BEST AVAILABLE INFORMATION AND ARE TO BE CONSIDERED APPROXIMATE. IT SHALL BE THE RESPONSIBILITY OF THE CONTRACTOR 1) TO VERIFY THE LOCATIONS OF UTILITY LINES AND ADJACENT TO THE WORK AREA 2) TO PROTECT OF ALL UTILITY LINES DURING THE CONSTRUCTION PERIOD 3) TO REPAIR ANY AND ALL DAMAGE TO UTILITIES, STRUCTURES, SITE APPEARANCES, ETC. WHICH OCCURS AS A RESULT OF THE CONSTRUCTION.
3. CONTRACTOR SHALL BE RESPONSIBLE FOR DELIVERY SCHEDULE AND PROTECTION BETWEEN DELIVERY AND PLANTING PER SPECIFICATIONS TO MAINTAIN HEALTHY PLANT CONDITIONS.
4. THE CONTRACTOR SHALL COMPLETELY GUARANTEE AND BE RESPONSIBLE FOR FULLY MAINTAINING (INCLUDING BUT NOT LIMITED TO: WATERING, SPRAYING, MULCHING, FERTILIZING, ETC.) ALL OF THE PLANT MATERIALS AND LAWN FOR A ONE YEAR GROWING PERIOD.

PLANTING SPECIFICATIONS

1. ALL LANDSCAPE MATERIALS SHALL CONFORM TO, AT A MINIMUM, THE ACCEPTED STANDARDS ESTABLISHED BY THE AMERICAN ASSOCIATION OF NURSERYMEN, INCLUDING THE AMERICAN STANDARD FOR NURSERY STOCK (ANSI Z60.1). ANY PLANT MATERIAL WHICH IS DISEASED, DISTRESSED, DEAD, OR REJECTED (PRIOR TO SUBSTANTIAL COMPLETION) SHALL BE PROMPTLY REMOVED FROM THE SITE AND REPLACED WITH MATERIAL OF THE SAME SPECIES, QUANTITY, AND SIZE AND MEETING ALL PLANT LIST SPECIFICATIONS.
2. ALL MATERIALS, PLANTING AND LANDSCAPE WORK SHALL CONFORM TO THE LOCAL OR COUNTY JURISDICTIONAL AUTHORITY'S STANDARD SPECIFICATIONS AND DETAILS, AND SHALL BE SUBJECT TO THE APPROVAL OF THE LANDSCAPE ARCHITECT BEFORE, DURING, AND AFTER INSTALLATION.
3. ALL PLANT MATERIAL SHALL BE PLANTED AT HEIGHTS AS ILLUSTRATED IN THE PLANTING DETAILS & PLANT LIST.
4. ALL PLANT MATERIAL SHALL BE CONTAINER GROWN IN GALLON SPECIFIED OR BALLED AND BURLAPPED AS INDICATED IN THE PLANT LIST AS "B+B".
5. ALL PLANT BEDS AND RAISED SAUCER RINGS SHALL BE GRADED TO PROVIDE ADEQUATE DRAINAGE AND SHALL BE MULCHED AS SPECIFIED.
6. PRIOR TO THE END OF EACH WORKING DAY, THE CONTRACTOR SHALL PROPERLY BACKFILL ALL PLANT MATERIAL THAT HAS BEEN PLACED IN PREPARED HOLES AND PROPERLY WATER AND MULCH ALL PREPARED GROUND COVER, PERENNIAL AND ANNUAL BEDS.
7. ALL TREES AND SHRUBS SHALL BE SOAKED WITH WATER AND MULCHED IMMEDIATELY FOLLOWING INSTALLATION.
8. ALL ROOT BALLS REMOVED FROM CONTAINERS SHALL BE SCARIFIED BY HAND PRIOR TO PLACEMENT AND BACK FILLING WITH PREPARED SOILS. HAND TOOLS ARE NOT TO BE USED TO SCARIFY ROOT BALLS. ALL ROPE AND WRAPPING TWINE SHALL BE CUT AND REMOVED FROM AROUND THE UPPER PARTS OF THE ROOT BALL. METAL BASKET WIRES AND BURLAP SHALL BE PULLED BACK AND TUCKED UNDER THE EDGES OF THE SAUCER RINGS ON ALL TREES AND LARGE SHRUBS. ALL SYNTHETIC BURLAP SHALL BE REMOVED FROM PLANT BALLS PRIOR TO BACKFILLING.
9. ALL PLANTING AREAS SHALL BE EDGED WITH SMOOTH, CONTINUOUS CURVES. PINE STRAW MULCH, IF SPECIFIED, SHALL BE ROLLED AND TUCKED ALONG PLANT BED EDGE. TRIPLE SHRED MULCH, WHERE SPECIFIED, SHALL BE A MIN. 3" DEPTH.
10. ALL LANDSCAPED AND LAWN AREAS ARE TO RECEIVE A MINIMUM OF 4" OF TOPSOIL.

LANDSCAPE MAINTENANCE PLAN

THE OWNERS OF THE PROPERTY, WHICH TERM INCLUDES THEIR AGENTS, HEIRS, AND ASSIGNS, SHALL BE RESPONSIBLE FOR THE INSTALLATION, PRESERVATION, AND MAINTENANCE OF ALL PLANTING AND PHYSICAL FEATURES SHOWN ON THIS PLAN. THE OWNERS SHALL BE RESPONSIBLE FOR MAINTENANCE OF THE VEGETATION, INCLUDING BUT NOT LIMITED TO:

1. FERTILIZATION: APPLY FERTILIZER TO WARM SEASON TURF (TYP.: BERMOUDAGRASS, ZOYSIAGRASS) DURING THE GROWING SEASON BASED ON SOIL TESTING. TOTAL NITROGEN APPLICATION DURING THE YEAR FOR WARM SEASON TURF SHOULD NOT EXCEED 2-3 POUNDS OF TOTAL NITROGEN PER 1,000 S.F. APPLY IN MAY AND JULY WITH AN OPTIONAL APPLICATION IN SEPTEMBER - EACH APPLICATION SHOULD NOT EXCEED 1 POUND OF NITROGEN PER 1,000 S.F. FOR COOL SEASON TURF (TYP.: TALL FESCUE, KENTUCKY BLUEGRASS), APPLY BETWEEN 2 TO 4 POUNDS OF ACTUAL NITROGEN PER 1,000 S.F. PER YEAR. THIS SHOULD BE SPREAD ACROSS 3-4 APPLICATIONS, WITH APPROXIMATELY 2/3 OF THE NITROGEN APPLIED DURING THE FALL SEASON. WITH NO APPLICATION EXCEEDING 1 POUND OF NITROGEN PER 1,000 S.F. APPLY LIME ANNUALLY PER SOIL TEST. (SOURCE: CAROLINA LAWN, PRODUCED BY THE NC COOPERATIVE EXTENSION SERVICE)
2. PRUNING: PRUNING SHALL BE LIMITED TO THE REMOVAL OF DEAD AND DECAYING WOOD OR FOR SAFETY AND SIGHT DISTANCE REASONS. PRUNING FOR SHRUBS (EXCEPT FOR THOSE INTENDED FOR SHEARED HEDGES) SHALL BE LIMITED TO THE ABOVE REASONS PLUS MAINTENANCE NECESSARY TO MAINTAIN THE NATURAL SHAPE OF THE PLANT MATERIAL.
3. PEST CONTROL: PRE-EMERGENT WEED CONTROL FOR LAWN AREAS AND SHRUB BEDS CAN BE APPLIED BASED ON PRODUCT LABEL RECOMMENDATIONS. GENERALLY APPLIED IN EARLY SPRING FOR SUMMER ANNUAL WEEDS. CHEMICAL PEST CONTROL MAY BE USED TO TREAT SPECIFIC WEED, INSECT, OR DISEASE PROBLEMS THAT ARE IMPACTING LAWN AND LANDSCAPE PLANT HEALTH. INTEGRATED PEST MANAGEMENT (IPM) PRACTICES AND STANDARDS SHOULD BE FOLLOWED WHENEVER PRACTICAL BASED ON PUBLISHED LITERATURE FROM THE NC COOPERATIVE EXTENSION SERVICE.
4. MULCHING: MAINTAIN MULCH WITHIN PLANT BED AREAS AT A MINIMUM 2-3" DEPTH. REPLENISH AS NECESSARY, BUT AT LEAST ANNUALLY.
5. MOWING: MAINTAIN WARM SEASON TURF AT A CUTTING HEIGHT OF 1-2". FOR TALL FESCUE (AND FESCUE/BUEGRASS MIXTURES) THE CUTTING HEIGHT SHOULD BE 2.5-3.5".
6. PLANT PROTECTION: AVOID SOIL DISTURBANCE, COMPACTION, AND STORAGE OF MATERIALS WITHIN THE ROOTZONE OF LANDSCAPE PLANTINGS, INCLUDING THE CRITICAL ROOT ZONE (CRZ) FOR TREES. USE TREE PROTECTION FENCING AS NECESSARY TO MAINTAIN DISTURBANCE FREE ZONES.
7. IRRIGATION, WATERING SCHEDULE: WHENEVER POSSIBLE, WATER IN THE EARLY MORNING. FOR ESTABLISHED LAWNS, WATER TO A DEPTH OF 6-8" TO PROMOTE DEEP ROOT GROWTH. DURING THE GROWING SEASON, APPLY WATER OVER SEVERAL APPLICATIONS AT A RATE OF 1" PER WEEK (NOT TO EXCEED 1/2" PER APPLICATION).

PLAN REVISIONS			
#	DATE	REVISION	BY



PROJECT:  
  
**RIVERFALL**

ENNIS ROAD  
ANGIER, NC 27501

PROJECT #: C23026  
DRAWN BY: MP  
REVIEWED BY: MR  
1ST SUBMITTAL: XXXXX  
SCALE: AS NOTED

PRELIMINARY  
NOT FOR CONSTRUCTION

PREPARED FOR:  
  
MATTAMY HOMES, LLC

PREPARED BY:

1149 EXECUTIVE CIRCLE  
CARY, NC 27511  
919.576.9733  
NCBELS C3847 | NCBOLA C683

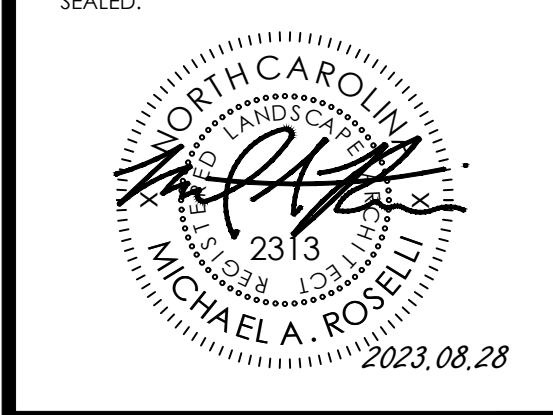

SHEET:  
**LANDSCAPE DETAIL SHEET**  
  
**L-101**