

# EXHIBIT B

**HARNETT COUNTY NOTES**  
 US 421 IS ON THE HARNETT COUNTY COMPREHENSIVE TRANSPORTATION PLAN.  
 THIS DEVELOPMENT IS WITHIN ONE MILE OF A VOLUNTARY AGRICULTURAL DISTRICT.  
 WATER SUPPLY WATERSHED SPECIAL INTENSITY ALLOCATION PERMIT (SNI42303-0002) WAS APPROVED ON 4/11/2022  
 HOURS OF OPERATION: 7 DAYS PER WEEK, 8AM - 10PM  
 DOLLAR GENERAL WILL BE RESPONSIBLE FOR MAINTENANCE OF THE PARKING AREAS, DRIVE AISLES, AND ALL LANDSCAPE BUFFERING

**SIGN LEGEND**

LEGEND	QTY.
	2
	1
	1

**IMPERVIOUS AREA SUMMARY**

ON-SITE AREA = 67,473 SF (1.54 AC)			
BUILDINGS	10,640 SF	0.24 ACRE(S)	15.84 % OF AREA
PAVEMENT	26,733 SF	0.62 ACRE(S)	39.80 % OF AREA
SIDEWALK	2,748 SF	0.06 ACRE(S)	4.09 % OF AREA
TOTAL IMPERVIOUS AREA	40,121 SF	0.92 ACRE(S)	59.73 % OF AREA
GREEN/OPEN SPACE	27,052 SF	0.62 ACRE(S)	40.27 % OF AREA
INCREASE IN IMPERVIOUS AREA:	40,121 SF	0.92 ACRE(S)	

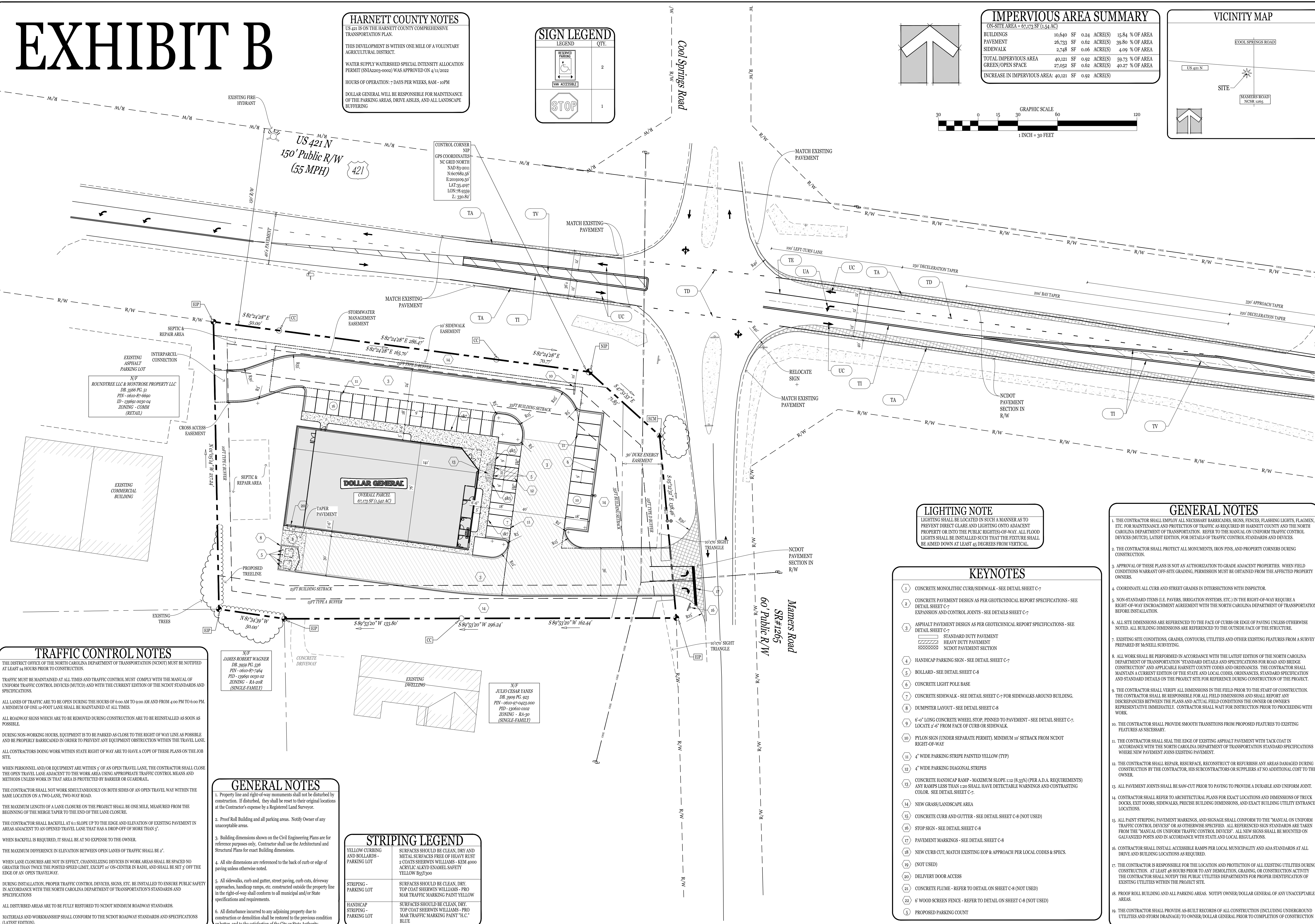
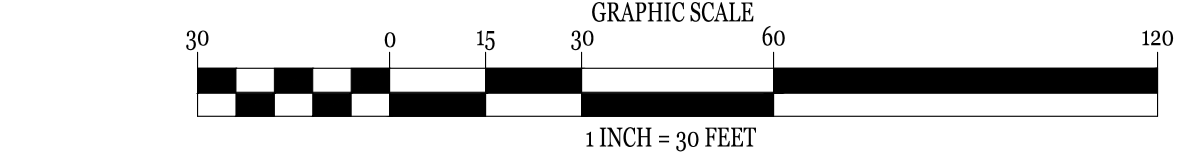
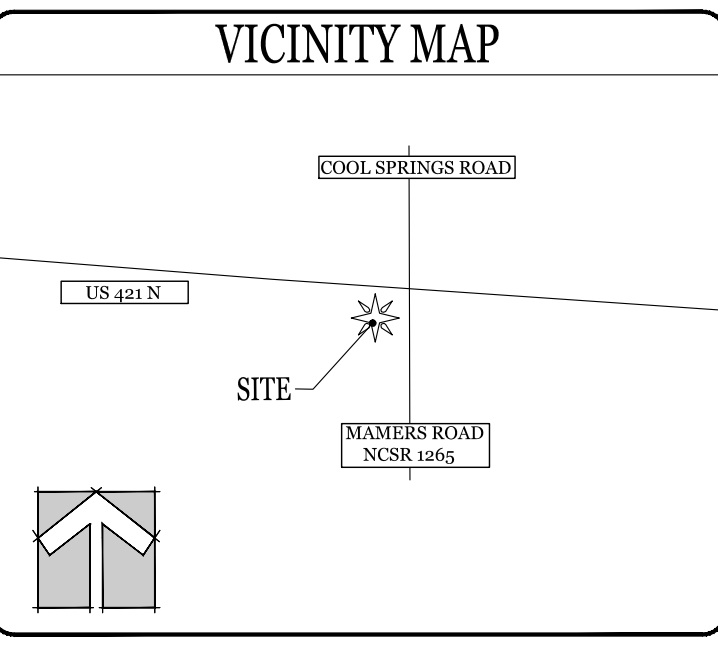

**TRAFFIC CONTROL NOTES**

THE DISTRICT OFFICE OF THE NORTH CAROLINA DEPARTMENT OF TRANSPORTATION (NCDOT) MUST BE NOTIFIED AT LEAST 24 HOURS PRIOR TO CONSTRUCTION.

TRAFFIC MUST BE MAINTAINED AT ALL TIMES AND TRAFFIC CONTROL MUST COMPLY WITH THE MANUAL OF UNIFORM TRAFFIC CONTROL DEVICES (MUTCD) AND WITH THE CURRENT EDITION OF THE NCDOT STANDARDS AND SPECIFICATIONS.

ALL LANES OF TRAFFIC ARE TO BE OPEN DURING THE HOURS OF 6:00 AM TO 9:00 AM AND FROM 4:00 PM TO 6:00 PM. A MINIMUM OF ONE 12-FOOT LANE SHALL BE MAINTAINED AT ALL TIMES.

ALL ROADWAY SIGNS WHICH ARE TO BE REMOVED DURING CONSTRUCTION ARE TO BE REINSTALLED AS SOON AS POSSIBLE.

DURING NON-WORKING HOURS, EQUIPMENT IS TO BE PARKED AS CLOSE TO THE RIGHT OF WAY LINE AS POSSIBLE AND BE PROPERLY BARRICADED IN ORDER TO PREVENT ANY EQUIPMENT OBSTRUCTION WITHIN THE TRAVEL LANE.

ALL CONTRACTORS DOING WORK WITHIN STATE RIGHT OF WAY ARE TO HAVE A COPY OF THESE PLANS ON THE JOB SITE.

WHEN PERSONNEL AND/OR EQUIPMENT ARE WITHIN 5' OF AN OPEN TRAVEL LANE, THE CONTRACTOR SHALL CLOSE THE OPEN TRAVEL LANE ADJACENT TO THE WORK AREA USING APPROPRIATE TRAFFIC CONTROL MEANS AND METHODS UNLESS WORK IN THAT AREA IS PROTECTED BY BARRIER OR GUARDRAIL.

THE CONTRACTOR SHALL NOT WORK SIMULTANEOUSLY ON BOTH SIDES OF AN OPEN TRAVEL WAY WITHIN THE SAME LOCATION ON A TWO-LANE, TWO-WAY ROAD.

THE MAXIMUM LENGTH OF A LANE CLOSURE ON THE PROJECT SHALL BE ONE MILE, MEASURED FROM THE BEGINNING OF THE MERGE TAPER TO THE END OF THE LANE CLOSURE.

THE CONTRACTOR SHALL BACKFILL AT 6:1 SLOPE UP TO THE EDGE AND ELEVATION OF EXISTING PAVEMENT IN AREAS ADJACENT TO AN OPENED TRAVEL LANE THAT HAS A DROP-OFF OF MORE THAN 2".

WHEN BACKFILL IS REQUIRED, IT SHALL BE AT NO EXPENSE TO THE OWNER.

THE MAXIMUM DIFFERENCE IN ELEVATION BETWEEN OPEN LANES OF TRAFFIC SHALL BE 2".

WHEN LANE CLOSURES ARE NOT IN EFFECT, CHANNELIZING DEVICES IN WORK AREAS SHALL BE SPACED NO GREATER THAN TWICE THE POSTED SPEED LIMIT, EXCEPT 10' ON-CENTER IN RADIUS, AND SHALL BE SET 3' OFF THE EDGE OF AN OPEN TRAVELWAY.

DURING INSTALLATION, PROPER TRAFFIC CONTROL DEVICES, SIGNS, ETC. BE INSTALLED TO ENSURE PUBLIC SAFETY IN ACCORDANCE WITH THE NORTH CAROLINA DEPARTMENT OF TRANSPORTATION'S STANDARDS AND SPECIFICATIONS.

ALL DISTURBED AREAS ARE TO BE FULLY RESTORED TO NCDOT MINIMUM ROADWAY STANDARDS.

MATERIALS AND WORKMANSHIP SHALL CONFORM TO THE NCDOT ROADWAY STANDARDS AND SPECIFICATIONS (LATEST EDITION).

**GENERAL NOTES**

- Property lines and right-of-way monuments shall not be disturbed by construction. If disturbed, they shall be reset to their original locations at the Contractor's expense by a Registered Land Surveyor.
- Proof Roll Building and all parking areas. Notify Owner of any unacceptable areas.
- Building dimensions shown on the Civil Engineering Plans are for reference purposes only. Contractor shall use the Architectural and Structural Plans for exact Building dimensions.
- All site dimensions are referenced to the back of curb or edge of paving unless otherwise noted.
- All sidewalks, curb and gutter, street paving, curb cuts, driveway approaches, handicap ramps, etc. constructed outside the property line in the right-of-way shall conform to all municipal and/or State specifications and requirements.
- All disturbance incurred to any adjoining property due to construction or demolition shall be restored to the previous condition or better, and to the satisfaction of the City or State Authority.

**STRIPING LEGEND**

YELLOW CURBING AND BOLLARDS - PARKING LOT	SURFACES SHOULD BE CLEAN, DRY AND METAL SURFACES FREE OF HEAVY RUST ± COATS SHERWIN WILLIAMS - PRO MAR TRAFFIC MARKING PAINT YELLOW 1553300
STRIPING - PARKING LOT	SURFACES SHOULD BE CLEAN, DRY. TOP COAT SHERWIN WILLIAMS - PRO MAR TRAFFIC MARKING PAINT YELLOW
HANDICAP STRIPING - PARKING LOT	SURFACES SHOULD BE CLEAN, DRY. TOP COAT SHERWIN WILLIAMS - PRO MAR TRAFFIC MARKING PAINT "H.C." BLUE

**LIGHTING NOTE**

LIGHTING SHALL BE LOCATED IN SUCH A MANNER AS TO PREVENT DIRECT GLARE AND LIGHTING ONTO ADJACENT PROPERTY OR INTO THE PUBLIC RIGHTS-OF-WAY. ALL FLOOD LIGHTS SHALL BE INSTALLED SUCH THAT THE FIXTURE SHALL BE AIMED DOWN AT LEAST 45 DEGREES FROM VERTICAL.

**KEYNOTES**

- CONCRETE MONOLITHIC CURB/SIDEWALK - SEE DETAIL SHEET C-7
- CONCRETE PAVEMENT DESIGN AS PER GEOTECHNICAL REPORT SPECIFICATIONS - SEE DETAIL SHEET C-7
- ASPHALT PAVEMENT DESIGN AS PER GEOTECHNICAL REPORT SPECIFICATIONS - SEE DETAIL SHEET C-7
  - STANDARD DUTY PAVEMENT
  - HEAVY DUTY PAVEMENT
  - NCDOT PAVEMENT SECTION
- HANDICAP PARKING SIGN - SEE DETAIL SHEET C-7
- BOLLARD - SEE DETAIL SHEET C-8
- CONCRETE LIGHT POLE BASE
- CONCRETE SIDEWALK - SEE DETAIL SHEET C-7 FOR SIDEWALKS AROUND BUILDING.
- DUMPSTER LAYOUT - SEE DETAIL SHEET C-8
- 6'-0" LONG CONCRETE WHEEL STOP, FINISHED TO PAVEMENT - SEE DETAIL SHEET C-7. LOCATE 2'-4" FROM FACE OF CURB OR SIDEWALK.
- PYLON SIGN (UNDER SEPARATE PERMIT), MINIMUM 10' SETBACK FROM NCDOT RIGHT-OF-WAY
- 4" WIDE PARKING STRIPE PAINTED YELLOW (TYP)
- 4" WIDE PARKING DIAGONAL STRIPES
- CONCRETE HANDICAP RAMP - MAXIMUM SLOPE 1:12 (8.33%) (PER A.D.A. REQUIREMENTS) ANY RAMPS LESS THAN 120 SHALL HAVE DETECTABLE WARNINGS AND CONTRASTING COLOR. SEE DETAIL SHEET C-7.
- NEW GRASS/LANDSCAPE AREA
- CONCRETE CURB AND GUTTER - SEE DETAIL SHEET C-8 (NOT USED)
- STOP SIGN - SEE DETAIL SHEET C-8
- PAVEMENT MARKINGS - SEE DETAIL SHEET C-8
- NEW CURB CUT, MATCH EXISTING EOP & APPROACH PER LOCAL CODES & SPECS.
- (NOT USED)
- DELIVERY DOOR ACCESS
- CONCRETE FLUME - REFER TO DETAIL ON SHEET C-8 (NOT USED)
- PROPOSED PARKING COUNT

**GENERAL NOTES**

- THE CONTRACTOR SHALL EMPLOY ALL NECESSARY BARRICADES, SIGNS, FENCES, FLASHING LIGHTS, FLAGMEN, ETC. FOR MAINTENANCE AND PROTECTION OF TRAFFIC AS REQUIRED BY HARNETT COUNTY AND THE NORTH CAROLINA DEPARTMENT OF TRANSPORTATION. REFER TO THE MANUAL ON UNIFORM TRAFFIC CONTROL DEVICES (MUTCD), LATEST EDITION, FOR DETAILS OF TRAFFIC CONTROL STANDARDS AND DEVICES.
- THE CONTRACTOR SHALL PROTECT ALL MONUMENTS, IRON PINS, AND PROPERTY CORNERS DURING CONSTRUCTION.
- APPROVAL OF THESE PLANS IS NOT AN AUTHORIZATION TO GRADE ADJACENT PROPERTIES. WHEN FIELD CONDITIONS WARRANT OFF-SITE GRADING, PERMISSION MUST BE OBTAINED FROM THE AFFECTED PROPERTY OWNERS.
- COORDINATE ALL CURB AND STREET GRADES IN INTERSECTIONS WITH INSPECTOR.
- NON-STANDARD ITEMS (I.E. PAVERS, IRRIGATION SYSTEMS, ETC.) IN THE RIGHT-OF-WAY REQUIRE A RIGHT-OF-WAY ENCROACHMENT AGREEMENT WITH THE NORTH CAROLINA DEPARTMENT OF TRANSPORTATION BEFORE INSTALLATION.
- ALL SITE DIMENSIONS ARE REFERENCED TO THE FACE OF CURBS OR EDGE OF PAVING UNLESS OTHERWISE NOTED. ALL BUILDING DIMENSIONS ARE REFERENCED TO THE OUTSIDE FACE OF THE STRUCTURE.
- EXISTING SITE CONDITIONS, GRADES, CONTOURS, UTILITIES AND OTHER EXISTING FEATURES FROM A SURVEY PREPARED BY MANEILL SURVEYING.
- ALL WORK SHALL BE PERFORMED IN ACCORDANCE WITH THE LATEST EDITION OF THE NORTH CAROLINA DEPARTMENT OF TRANSPORTATION STANDARD DETAILS AND SPECIFICATIONS FOR ROAD AND BRIDGE CONSTRUCTION AND APPLICABLE HARNETT COUNTY CODES AND ORDINANCES. THE CONTRACTOR SHALL MAINTAIN A CURRENT EDITION OF THE STATE AND LOCAL CODES, ORDINANCES, STANDARD SPECIFICATION AND STANDARD DETAILS ON THE PROJECT SITE FOR REFERENCE DURING CONSTRUCTION OF THE PROJECT.
- THE CONTRACTOR SHALL VERIFY ALL DIMENSIONS IN THE FIELD PRIOR TO THE START OF CONSTRUCTION. THE CONTRACTOR SHALL BE RESPONSIBLE FOR ALL FIELD DIMENSIONS AND SHALL REPORT ANY DISCREPANCIES BETWEEN THE PLANS AND ACTUAL FIELD CONDITIONS TO THE OWNER OR OWNERS REPRESENTATIVE IMMEDIATELY. CONTRACTOR SHALL WAIT FOR INSTRUCTION PRIOR TO PROCEEDING WITH WORK.
- THE CONTRACTOR SHALL PROVIDE SMOOTH TRANSITIONS FROM PROPOSED FEATURES TO EXISTING FEATURES AS NECESSARY.
- THE CONTRACTOR SHALL SEAL THE EDGE OF EXISTING ASPHALT PAVEMENT WITH TACK COAT IN ACCORDANCE WITH THE NORTH CAROLINA DEPARTMENT OF TRANSPORTATION STANDARD SPECIFICATIONS WHERE NEW PAVEMENT JOINS EXISTING PAVEMENT.
- THE CONTRACTOR SHALL REPAIR, RESURFACE, RECONSTRUCT OR REFURBISH ANY AREAS DAMAGED DURING CONSTRUCTION BY THE CONTRACTOR, HIS SUBCONTRACTORS OR SUPPLIERS AT NO ADDITIONAL COST TO THE OWNER.
- ALL PAVEMENT JOINTS SHALL BE SAW-CUT PRIOR TO PAVING TO PROVIDE A DURABLE AND UNIFORM JOINT.
- CONTRACTOR SHALL REFER TO ARCHITECTURAL PLANS FOR EXACT LOCATIONS AND DIMENSIONS OF TRUCK DOCKS, EXIT DOORS, SIDEWALKS, PRECISE BUILDING DIMENSIONS, AND EXACT BUILDING UTILITY ENTRANCE LOCATIONS.
- ALL PAINT STRIPING, PAVEMENT MARKINGS, AND SIGNAGE SHALL CONFORM TO THE "MANUAL ON UNIFORM TRAFFIC CONTROL DEVICES" OR AS OTHERWISE SPECIFIED. ALL REFERENCED SIGN STANDARDS ARE TAKEN FROM THE "MANUAL ON UNIFORM TRAFFIC CONTROL DEVICES". ALL NEW SIGNS SHALL BE MOUNTED ON GALVANIZED POSTS AND IN ACCORDANCE WITH STATE AND LOCAL REGULATIONS.
- THE CONTRACTOR SHALL BE RESPONSIBLE FOR THE LOCATION AND PROTECTION OF ALL EXISTING UTILITIES DURING CONSTRUCTION. AT LEAST 48 HOURS PRIOR TO ANY DEMOLITION, GRADING, OR CONSTRUCTION ACTIVITY THE CONTRACTOR SHALL NOTIFY THE PUBLIC UTILITIES DEPARTMENT FOR PROPER IDENTIFICATION OF EXISTING UTILITIES WITHIN THE PROJECT SITE.
- PROOF ROLL BUILDING AND ALL PARKING AREAS. NOTIFY OWNER/DOLLAR GENERAL OF ANY UNACCEPTABLE AREAS.
- THE CONTRACTOR SHALL PROVIDE AS-BUILT RECORDS OF ALL CONSTRUCTION (INCLUDING UNDERGROUND UTILITIES AND STORM DRAINAGE) TO OWNER/DOLLAR GENERAL PRIOR TO COMPLETION OF CONSTRUCTION

**Bowman**  
 Bowman North Carolina Ltd.  
 4006 BARRETT DR  
 Suite 104  
 RALEIGH, NC 27609  
 Phone: (919) 959-6870  
 bowman.com  
 F-1445

**PRELIMINARY DO NOT USE FOR CONSTRUCTION**

OWNER/DEVELOPER:  
 RHETSON COMPANIES, INC.  
 ATTN: JOHN PARKER  
 2075 JUNIPER LAKE ROAD  
 WEST END, NC 27376  
 (910) 944-0881  
 john@rhetsom.com

**RHETSON COMPANIES, INC.**

**DOLLAR GENERAL** — US 421 N  
 Lillington, NC — Harnett County

This document, together with the concepts and designs presented herein, as an instrument of services, is intended only for the specific purpose and client for which it was prepared. Reuse of and improper reliance on this document without written authorization and adaptation by Bowman North Carolina, Ltd. shall be without liability to Bowman North Carolina, Ltd.

REV.	DATE	DESC.
1	5/30/22	REVISED PER HARNETT COUNTY DMI COMMENTS

Drawn  
 Rhetsom Project# 21103  
 Project No. 058004  
 Initial Date February 28, 2022  
 Title

**SITE PLAN**

Sheet No. **C-3**

1922680-US 421 N, Harnett County