



# Planning Services Sign Permit Review Form

PO Box 65  
108 E. Front Street  
Lillington, NC 27546  
Ph: (910) 893- 7525 opt. 4  
Fax: (910) 814-6459

Date of Submittal	Application Number	Applicant	Landowner
7/25/2022	SUB2207-0004	Allen Industries	Pioneer Companies LLC

Contact Person	Heather English	Contact Number	336-799-4670
Sign Location	7003 US 421 N NE Corner of property 10' ROW minimum noted on plans note # 10 and as shown on site plan.	PIN Number	0610-97-0587.000

Proposed Sign			
Type	Dimensions	Location / Setbacks	Illumination
<input type="checkbox"/> Wall <input checked="" type="checkbox"/> Ground <input type="checkbox"/> Monument <input type="checkbox"/> Directory <input type="checkbox"/> Outdoor Advertising	<b>Length</b> 5' - 1/2"  <b>Width</b> 10' - 1/2"  <b>Height:</b> 14'-11 1/2"  Total Sq. Ft. 50.61 square feet	Setbacks 10'	<input type="checkbox"/> None <input type="checkbox"/> External <input checked="" type="checkbox"/> Internal <input type="checkbox"/> Electronic Message
Total Length of Wall	NA	Total Size of Project / Parcel	<input type="checkbox"/> Less Than 1 Acre <input checked="" type="checkbox"/> Greater Than 1 Acre
Total Sq. Ft. Electronic Message Display	0	Pole Style Ground Sign Encasement	Material <b>Steel</b> Width <b>2' 6"</b>

Current Signage			
Current Wall Signs	Current Ground Signs	Distance Between Signs On Property	Distance Between Outdoor Advertising Signs
0	0	NA	NA

Reviewed By:	Date of Review	Review Results
Sarah Arbour	8/1/2022	<input checked="" type="checkbox"/> Approved <input type="checkbox"/> Denied

Comments	

# Planning Services

## Sign Permit Review Form

### Site Plan

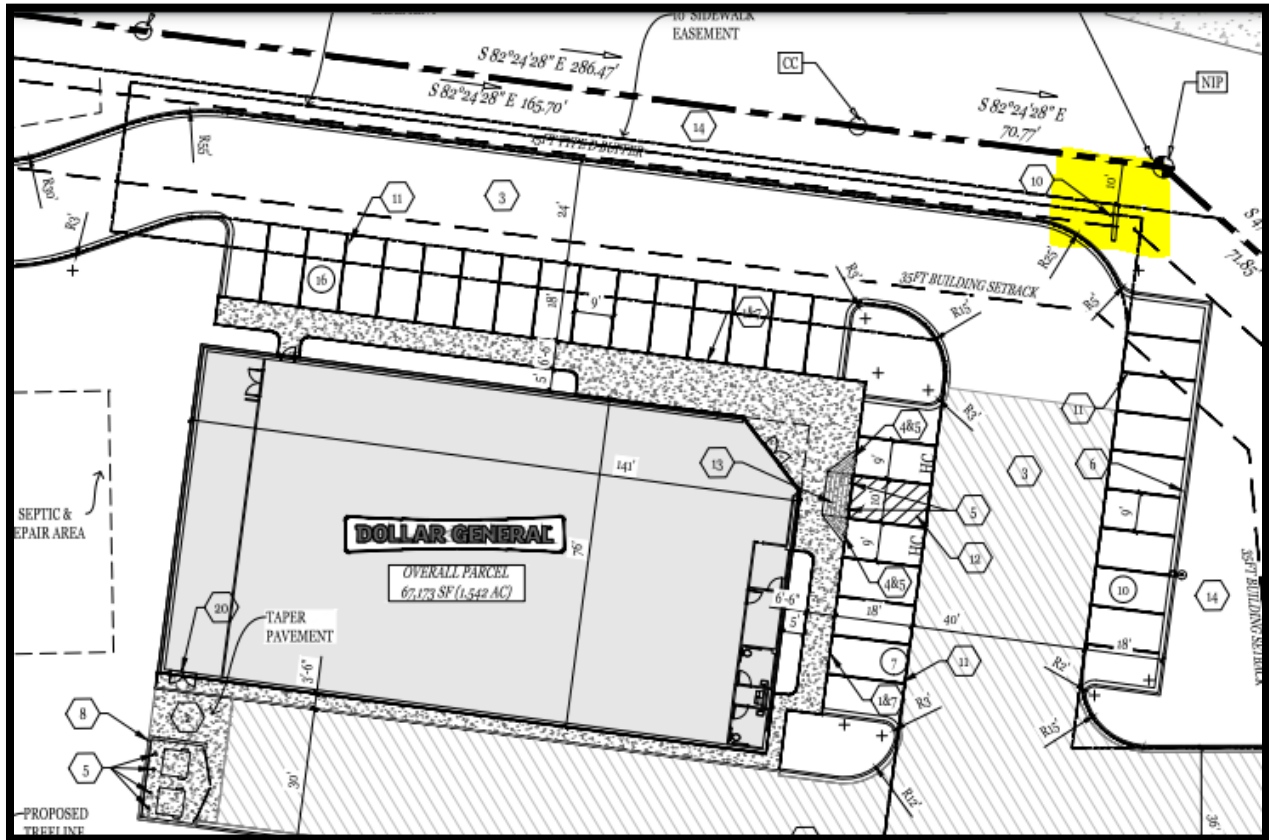

### Pole Covers

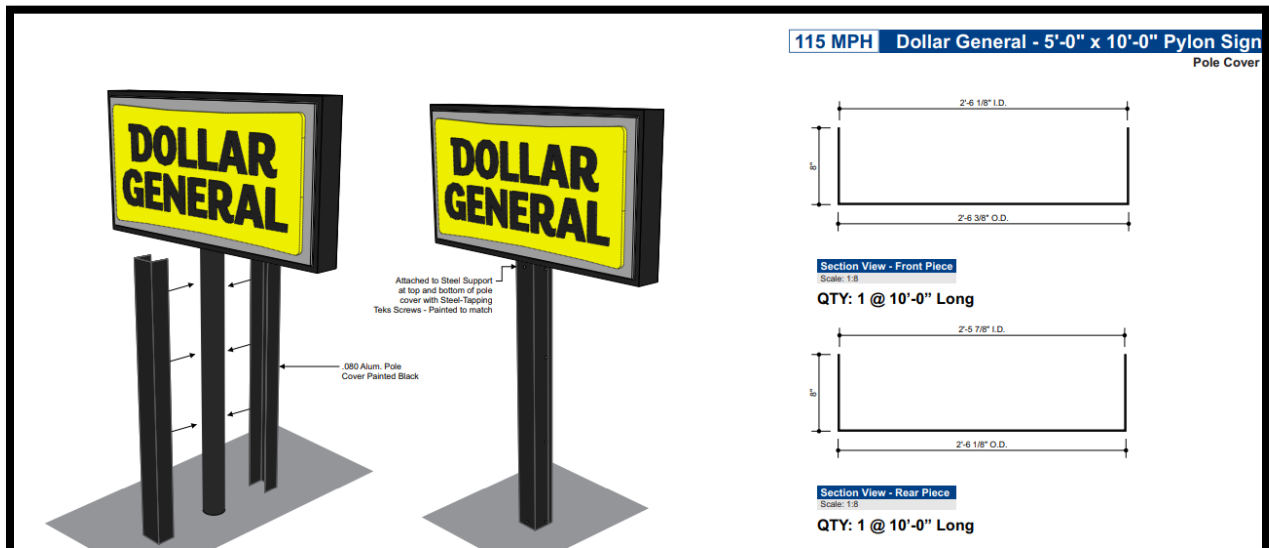

# Planning Services Sign Permit Review Form

Pole Covers

## Ground Sign

