

# WOODGROVE ENTRY MONUMENT SITE PLAN

HARNETT COUNTY, NORTH CAROLINA



THIS DRAWING PREPARED AT THE  
**RALEIGH OFFICE**  
5410 Trinity Road, Suite 102 | Raleigh, NC 27607  
TEL 919-866-4951 FAX 919-833-8124 www.timmons.com

YOUR VISION ACHIEVED THROUGH OURS.

DATE  
5/25/2021

DRAWN BY  
331

DESIGNED BY  
331

CHECKED BY  
MVZ

SCALE  
NTS

**TIMMONS GROUP**  
NORTH CAROLINA LICENSE NO. C-1652

**WOODGROVE**  
HARNETT COUNTY, NORTH CAROLINA

**COVER SHEET**

JOB NO.  
41015

SHEET NO.  
C0.0

These plans and associated documents are the exclusive property of TIMMONS GROUP and may not be reproduced in whole or in part and shall not be used for any purpose whatsoever, inclusive, but not limited to construction, bidding, and/or construction staking without the express written consent of TIMMONS GROUP.

### SITE DATA

PROJECT:	WOODGROVE
ENGINEER:	TIMMONS GROUP 5410 TRINITY ROAD, SUITE 102 RALEIGH, NC 27607 PHONE: 919-532-3281 FAX: 919-859-5663 MIKE ZACCARDO, PE EMAIL: mike.zaccardo@timmons.com
DEVELOPER:	GHD WOODGROVE LLC 1330 SUNDAY DR STE 105 RALEIGH, NC 27607-5196 JEFF WHITE 919-422-5741 jwhite@greenhawkcorp.com
PROPERTY LOCATION:	166 KIT STEWART LN
PINS:	0653-77-4878
ZONING:	RA-30
TOWNSHIP:	HECTORS CREEK
PROPOSED USE:	RESIDENTIAL
TOTAL TRACT AREA:	116.84 ACRES

VICINITY MAP

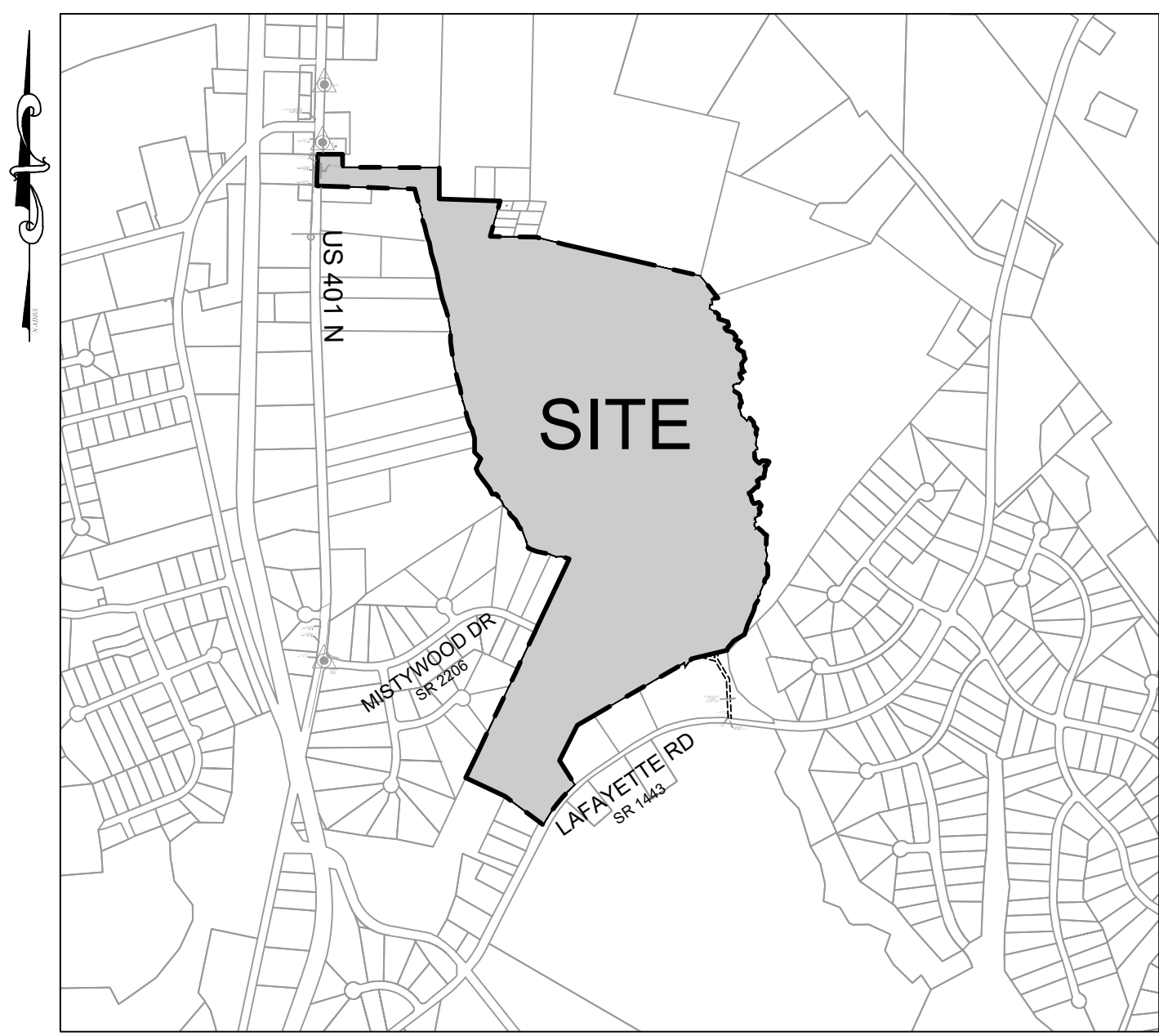

### OWNERS OF RECORD

GHD WOODGROVE LLC  
1330 SUNDAY DR  
STE 105  
RALEIGH, NC 27607-5196  
PIN: 0653-77-4878  
DB 3688 P 0768

Sheet List Table

Sheet Number	Sheet Title
C0.0	COVER
C2.0	ENTRY MONUMENT SITE PLAN OVERVIEW
C2.1	ENTRY MONUMENT SITE PLAN - SILVER MAPLE DRIVE
C2.2	ENTRY MONUMENT SITE PLAN - RED CEDAR WAY
L2.1	ENTRY MONUMENT LANDSCAPE PLAN - SILVER MAPLE DRIVE
L2.2	ENTRY MONUMENT LANDSCAPE PLAN - RED CEDAR WAY
L5.0	ENTRY MONUMENT LANDSCAPE DETAILS



**LEGEND**

	PROPERTY LINE
	PROPOSED RIGHT-OF-WAY
	PROPOSED LOT LINE
	PROPOSED BUILDING SETBACK LINE
	SANITARY SEWER EASEMENT
	MAINTENANCE & ACCESS EASEMENT
	CREEK CENTERLINE
	OPEN SPACE
	EXISTING WETLANDS

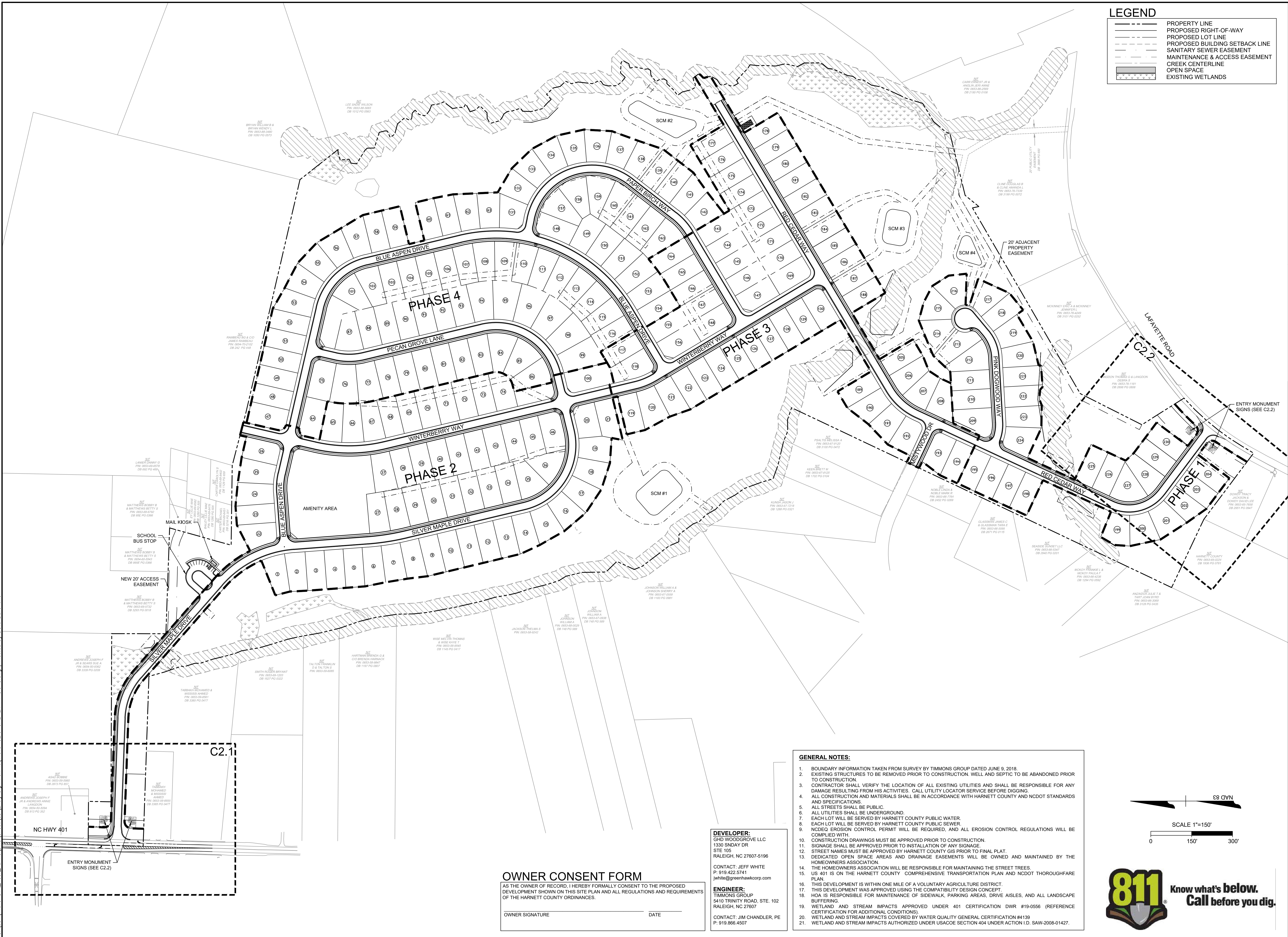

THIS DRAWING PREPARED AT THE  
**RALEIGH OFFICE**  
5410 Trinity Road, Suite 102 | Raleigh, NC 27607  
TEL 919.866.4951 FAX 919.833.8124 www.timmons.com

REVISION DESCRIPTION	DATE
YOUR VISION ACHIEVED THROUGH OURS.	5/25/2021

DRAWN BY	331
DESIGNED BY	331
CHECKED BY	MVZ
SCALE	1" = 150'

**TIMMONS GROUP**  
WOODGROVE  
HARNETT COUNTY, NORTH CAROLINA  
NORTH CAROLINA LICENSE NO. C-1652

**ENTRY MONUMENT SITE PLAN OVERVIEW**

JOB NO. 41015  
SHEET NO. C2.0

- GENERAL NOTES:**
- BOUNDARY INFORMATION TAKEN FROM SURVEY BY TIMMONS GROUP DATED JUNE 9, 2018.
  - EXISTING STRUCTURES TO BE REMOVED PRIOR TO CONSTRUCTION. WELL AND SEPTIC TO BE ABANDONED PRIOR TO CONSTRUCTION.
  - CONTRACTOR SHALL VERIFY THE LOCATION OF ALL EXISTING UTILITIES AND SHALL BE RESPONSIBLE FOR ANY DAMAGE RESULTING FROM HIS ACTIVITIES. CALL UTILITY LOCATOR SERVICE BEFORE DIGGING.
  - ALL CONSTRUCTION AND MATERIALS SHALL BE IN ACCORDANCE WITH HARNETT COUNTY AND NCDOT STANDARDS AND SPECIFICATIONS.
  - ALL STREETS SHALL BE PUBLIC.
  - ALL UTILITIES SHALL BE UNDERGROUND.
  - EACH LOT WILL BE SERVED BY HARNETT COUNTY PUBLIC WATER.
  - EACH LOT WILL BE SERVED BY HARNETT COUNTY PUBLIC SEWER.
  - NDCOE EROSION CONTROL PERMIT WILL BE REQUIRED, AND ALL EROSION CONTROL REGULATIONS WILL BE COMPLIED WITH.
  - CONSTRUCTION DRAWINGS MUST BE APPROVED PRIOR TO CONSTRUCTION.
  - SIGNAGE SHALL BE APPROVED PRIOR TO INSTALLATION OF ANY SIGNAGE.
  - STREET NAMES MUST BE APPROVED BY HARNETT COUNTY GIS PRIOR TO FINAL PLAN.
  - DEDICATED OPEN SPACE AREAS AND DRAINAGE EASEMENTS WILL BE OWNED AND MAINTAINED BY THE HOMEOWNERS ASSOCIATION.
  - THE HOMEOWNERS ASSOCIATION WILL BE RESPONSIBLE FOR MAINTAINING THE STREET TREES.
  - US 401 IS ON THE HARNETT COUNTY COMPREHENSIVE TRANSPORTATION PLAN AND NCDOT THOROUGHFARE PLAN.
  - THIS DEVELOPMENT IS WITHIN ONE MILE OF A VOLUNTARY AGRICULTURE DISTRICT.
  - THIS DEVELOPMENT WAS APPROVED USING THE COMPATIBILITY DESIGN CONCEPT.
  - HOA IS RESPONSIBLE FOR MAINTENANCE OF SIDEWALK, PARKING AREAS, DRIVE AISLES, AND ALL LANDSCAPE BUFFERS.
  - WETLAND AND STREAM IMPACTS APPROVED UNDER 401 CERTIFICATION DWR #19-0556 (REFERENCE CERTIFICATION FOR ADDITIONAL CONDITIONS).
  - WETLAND AND STREAM IMPACTS COVERED BY WATER QUALITY GENERAL CERTIFICATION #4139
  - WETLAND AND STREAM IMPACTS AUTHORIZED UNDER USAODE SECTION 404 UNDER ACTION I.D. SAW-2008-41427.

**DEVELOPER:**  
GHD WOODGROVE LLC  
1330 SUNDAY DR  
STE 105  
RALEIGH, NC 27607-5196  
CONTACT: JEFF WHITE  
P: 919.422.5741  
jwhite@greenthawkcorp.com

**ENGINEER:**  
TIMMONS GROUP  
5410 TRINITY ROAD, STE. 102  
RALEIGH, NC 27607  
CONTACT: JIM CHANDLER, PE  
P: 919.866.4507

**OWNER CONSENT FORM**

AS THE OWNER OF RECORD, I HEREBY FORMALLY CONSENT TO THE PROPOSED DEVELOPMENT SHOWN ON THIS SITE PLAN AND ALL REGULATIONS AND REQUIREMENTS OF THE HARNETT COUNTY ORDINANCES.

OWNER SIGNATURE \_\_\_\_\_ DATE \_\_\_\_\_

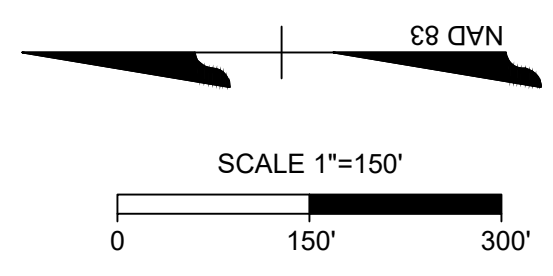

S:\331\41015-Dirt\_Poor\_Forms\DMC\_Sheet\CD Entry\_Sign\_Permits\41015-C2.0-SITE-ENTRY\_SIGN.dwg | Plotted by Dave Ballentine

S:\331\41015-Drl\_Poor\_Farms\DWG\_Sheet\CD\_Entry\_Sign\_Permit\41015-C2.1-SITE-ENTRY\_SIGNS.dwg | Plotted by Dave Balentine

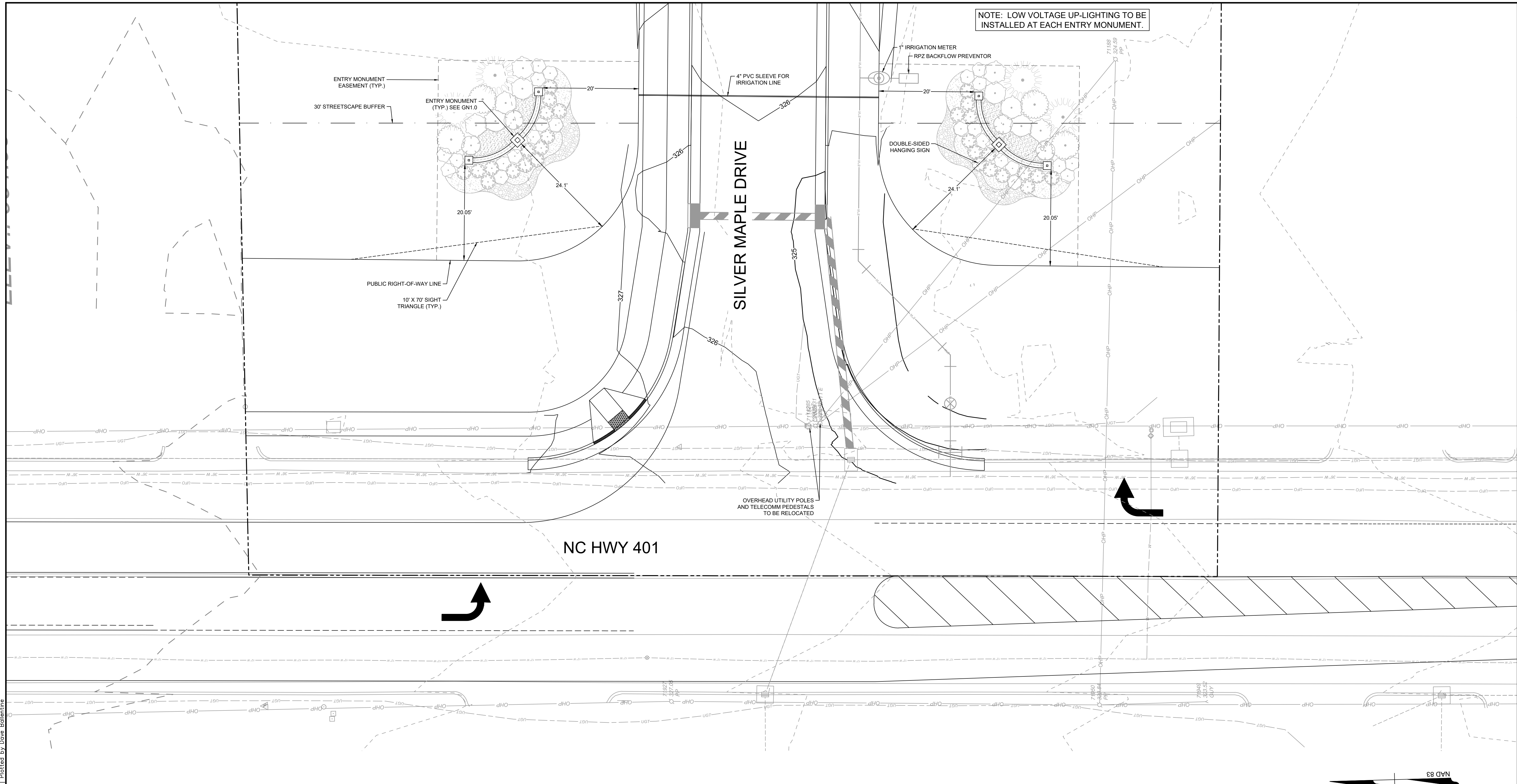

SCALE 1"=10'

0 10' 20'

NAD 83

**LEGEND**

- PROPERTY LINE
- PROPOSED RIGHT-OF-WAY
- PROPOSED LOT LINE
- PROPOSED BUILDING SETBACK LINE
- SANITARY SEWER EASEMENT
- MAINTENANCE & ACCESS EASEMENT
- CREEK CENTERLINE
- OPEN SPACE
- EXISTING WETLANDS
- 2'-6" ROLLED TYPE CURB & GUTTER
- TYPICAL 20" CURB & GUTTER

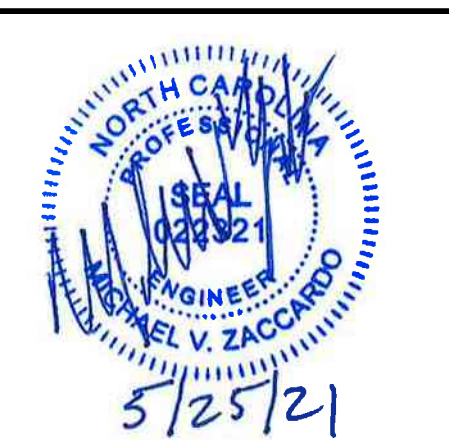

THIS DRAWING PREPARED AT THE  
**RALEIGH OFFICE**  
 5410 Trinity Road, Suite 102 | Raleigh, NC 27607  
 TEL 919.866.4951 FAX 919.833.8124 www.timmons.com

YOUR VISION ACHIEVED THROUGH OURS.

DATE	REVISION DESCRIPTION
5/25/2021	

DRAWN BY	331
DESIGNED BY	331
CHECKED BY	MVZ
SCALE	1" = 60'

**TIMMONS GROUP**

NORTH CAROLINA LICENSE NO. C-1652

WOODGROVE  
 HARNETT COUNTY, NORTH CAROLINA

**ENTRY MONUMENT SITE PLAN - SILVER MAPLE DRIVE**

JOB NO.	41015
SHEET NO.	C2.1

These plans and associated documents are the exclusive property of TIMMONS GROUP and may not be reproduced in whole or in part and shall not be used for any purpose whatsoever, inclusive, but not limited to construction, bidding, and/or construction staking without the express written consent of TIMMONS GROUP.

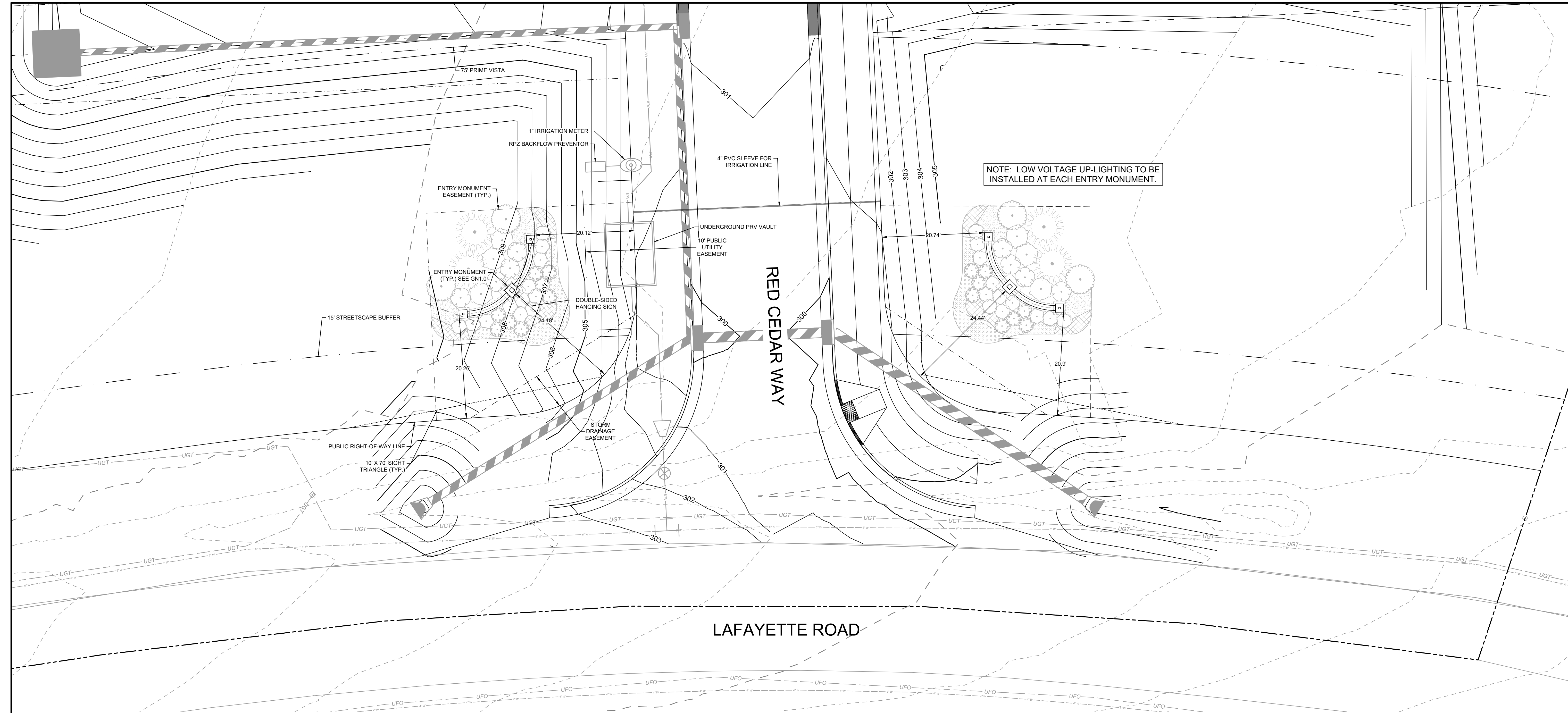

NOTE: LOW VOLTAGE UP-LIGHTING TO BE INSTALLED AT EACH ENTRY MONUMENT.

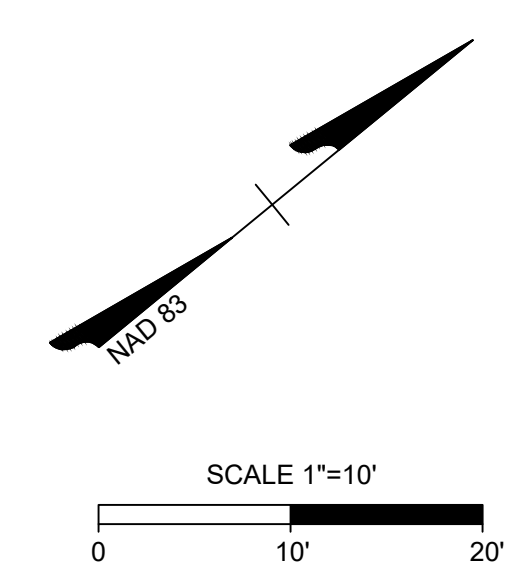

**LEGEND**

	PROPERTY LINE
	PROPOSED RIGHT-OF-WAY
	PROPOSED LOT LINE
	PROPOSED BUILDING SETBACK LINE
	SANITARY SEWER EASEMENT
	MAINTENANCE & ACCESS EASEMENT
	CREEK CENTERLINE
	OPEN SPACE
	EXISTING WETLANDS
	2'-6" ROLLED TYPE CURB & GUTTER
	TYPICAL 20" CURB & GUTTER



THIS DRAWING PREPARED AT THE  
**RALEIGH OFFICE**  
 5410 Trinity Road, Suite 102 | Raleigh, NC 27607  
 TEL 919.866.4951 FAX 919.833.8124 www.timmons.com

YOUR VISION ACHIEVED THROUGH OURS.

DATE  
 5/25/2021  
 DRAWN BY  
 331  
 DESIGNED BY  
 331  
 CHECKED BY  
 MVZ  
 SCALE  
 1" = 60'

**TIMMONS GROUP**  
 NORTH CAROLINA LICENSE NO. C-1652

**WOODGROVE**  
 HARNETT COUNTY, NORTH CAROLINA  
**ENTRY MONUMENT SITE PLAN - RED CEDAR WAY**

JOB NO.  
**41015**  
 SHEET NO.  
**C2.2**

S:\331\41015-Drl\_Poor\_Farms\DWG\_Sheet\CD\_Entry\_Sign\_Permit\41015-C2.2-SITE-ENTRY\_SIGNS.dwg | Plotted by Dave Ballentine

These plans and associated documents are the exclusive property of TIMMONS GROUP and may not be reproduced in whole or in part and shall not be used for any purpose whatsoever, inclusive, but not limited to construction, bidding, and/or construction staking without the express written consent of TIMMONS GROUP.



THIS DRAWING PREPARED AT THE  
**RALEIGH OFFICE**  
 5410 Trinity Road, Suite 102 | Raleigh, NC 27607  
 TEL 919.866.4951 FAX 919.833.8124 www.timmons.com

YOUR VISION ACHIEVED THROUGH OURS.

DATE  
 4/22/2021  
 DRAWN BY  
 CL  
 DESIGNED BY  
 CL  
 CHECKED BY  
 JM  
 SCALE  
 1" = 10'

**TIMMONS GROUP**  
 NORTH CAROLINA LICENSE NO. C-1652

**WOODGROVE**  
 HARNETT COUNTY, NORTH CAROLINA  
**ENTRY MONUMENT LANDSCAPE PLAN - SILVER MAPLE DRIVE**

JOB NO.  
 41015  
 SHEET NO.  
 L2.1

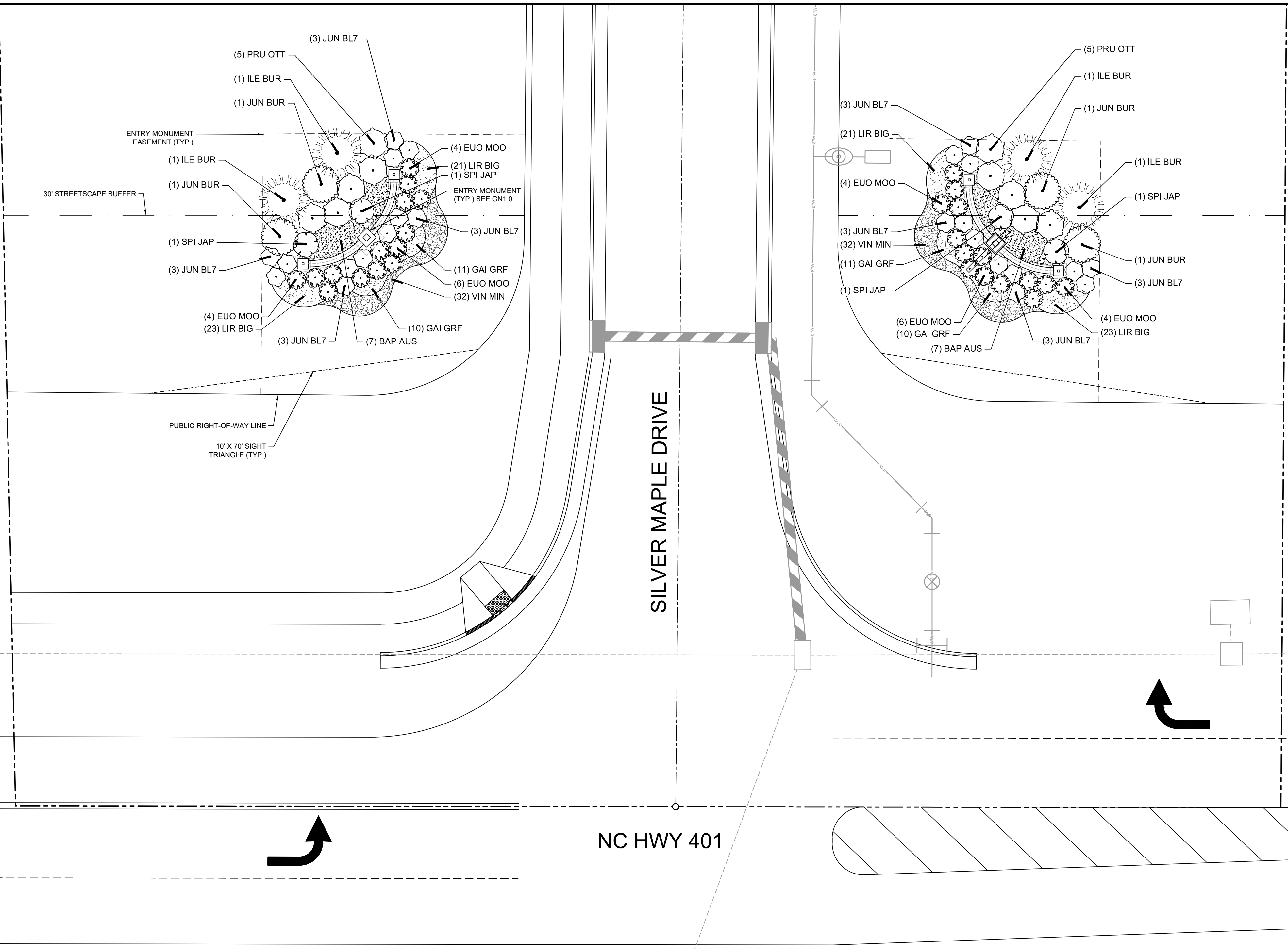

**PLANT SCHEDULE SILVER MAPLE DRIVE**

EVERGREEN TREES	QTY	BOTANICAL NAME	COMMON NAME	MIN. INSTALLED SIZE	ROOT	TYPE
JUN BUR	4	JUNIPERUS VIRGINIANA 'BURKII'	BURK RED CEDAR	7'-8" HT.	CONTAINER	FULL TO GROUND

SHRUBS	QTY	BOTANICAL NAME	COMMON NAME	MIN. INSTALLED SIZE	ROOT	TYPE
EUO MOO	28	EUONYMUS FORTUNEI 'MOONSHADOW' TM	MOONSHADOW EUONYMUS	24" HT./SPRD.	CONTAINER	3" O.C.
ILE BUR	4	ILEX CORNUTA 'BURFORDII NANA'	DWARF BURFORD HOLLY	7'-8" HT.	CONTAINER	
JUN BL7	24	JUNIPERUS SQUAMATA 'BLUE STAR'	BLUE STAR JUNIPER	24" HT./SPRD.	CONTAINER	3" O.C.
PRU OTT	10	PRUNUS LAUROCERASUS 'OTTO LUYKEN'	LUYKENS LAUREL	48" HT./SPRD.	CONTAINER	5" O.C.
SPI JAP	4	SPIRAEA JAPONICA 'GOLDFLAME'	SPIREA	48" HT./SPRD.	CONTAINER	4" O.C.

GROUND COVERS	QTY	BOTANICAL NAME	COMMON NAME	MIN. INSTALLED SIZE	ROOT	SPACING
BAP AUS	14	BAPTISIA AUSTRALIS	BLUE WILD INDIGO	24" HT./SPRD	CONTAINER	36" O.C.
GAI GRF	42	GAILLARDIA X GRANDIFLORA	BLANKETFLOWER	1 QT.	CONTAINER	12" O.C.
LIR BIG	88	LIRIOPE MUSCARI 'BIG BLUE'	BIG BLUE LILYTURF	1 GAL.	CONTAINER	12" O.C.
VIN MIN	64	VINCA MINOR	COMMON PERIWINKLE	1 QT.	CONTAINER	18" O.C.

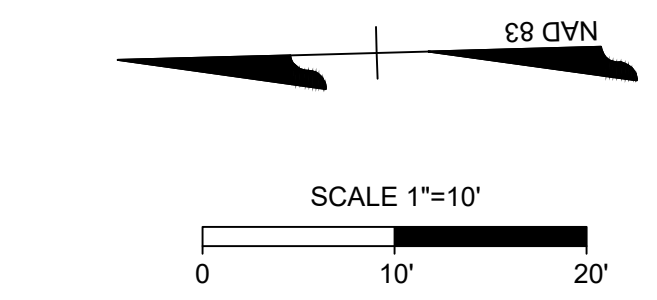

**LEGEND**

	PROPERTY LINE
	PROPOSED RIGHT-OF-WAY
	PROPOSED LOT LINE
	PROPOSED BUILDING SETBACK LINE
	SANITARY SEWER EASEMENT
	MAINTENANCE & ACCESS EASEMENT
	CREEK CENTERLINE
	OPEN SPACE
	EXISTING WETLANDS
	2'-6" ROLLED TYPE CURB & GUTTER
	TYPICAL 20" CURB & GUTTER



S:\331\41015-Drv-Plan-Forms\DWG\_Sheet\CD\_Entry\_Sign\_Permits\41015-L2.0-SITE-ENTRY\_SIGNS.dwg | Plotted by Dave Balentine



# GENERAL NOTES

## PRE-CONSTRUCTION

- CONTRACTOR IS RESPONSIBLE FOR CONTACTING "MISS UTILITY" AT 1.800.552.7001 FOR LOCATION OF ALL UTILITY LINES. TREES SHALL BE LOCATED A MINIMUM OF 5 FEET FROM SEWER/WATER CONNECTIONS. NOTIFY LANDSCAPE ARCHITECT OF CONFLICTS.
- VERIFY ALL PLANT MATERIAL QUANTITIES ON THE PLAN PRIOR TO BIDDING. PLANT LIST TOTALS ARE FOR CONVENIENCE ONLY AND SHALL BE VERIFIED PRIOR TO BIDDING.
- PROVIDE PLANT MATERIALS OF QUANTITY, SIZE, GENUS, SPECIES, AND VARIETY INDICATED ON PLANS. ALL PLANT MATERIALS AND INSTALLATION SHALL COMPLY WITH RECOMMENDATIONS AND REQUIREMENTS OF ANSI Z60.1 "AMERICAN STANDARD FOR NURSERY STOCK". IF SPECIFIED PLANT MATERIAL IS NOT OBTAINABLE, SUBMIT PROOF OF NON AVAILABILITY TO THE LANDSCAPE ARCHITECT, TOGETHER WITH PROPOSAL FOR USE OF EQUIVALENT MATERIAL.
- PROVIDE AND INSTALL ALL PLANTS AS IN ACCORDANCE WITH DETAILS AND CONTRACT SPECIFICATIONS.
- SOIL TESTS SHALL BE PERFORMED TO DETERMINE SOIL CHARACTER AND QUALITY. NECESSARY SOIL AMENDMENTS SHALL BE PERFORMED PER TEST RESULTS TO ENSURE PLANT HEALTH.

## CONSTRUCTION/INSTALLATION

- LANDSCAPE ARCHITECT RESERVES THE RIGHT TO REJECT ANY PLANTS AND MATERIALS THAT ARE IN AN UNHEALTHY OR UNSIGHTLY CONDITION, AS WELL AS PLANTS AND MATERIALS THAT DO NOT CONFORM TO ANSI Z60.1 "AMERICAN STANDARD FOR NURSERY STOCK" LABEL AT LEAST ONE TREE AND ONE SHRUB OF EACH VARIETY AND CALIPER WITH A SECURELY ATTACHED, WATERPROOF TAG BEARING THE DESIGNATION OF BOTANICAL AND COMMON NAME.
- INSTALL LANDSCAPE PLANTINGS AT ENTRANCES/EXITS AND PARKING AREAS ACCORDING TO PLANS SO THAT MATERIALS WILL NOT INTERFERE WITH SIGHT DISTANCES.
- CONTRACTOR IS RESPONSIBLE FOR WATERING ALL PLANT MATERIAL DURING INSTALLATION AND UNTIL FINAL INSPECTION AND ACCEPTANCE BY OWNER. CONTRACTOR SHALL NOTIFY OWNER OF CONDITIONS WHICH AFFECTS THE GUARANTEE.

## INSPECTIONS/GUARANTEE

- UPON COMPLETION OF LANDSCAPE INSTALLATION, THE LANDSCAPE CONTRACTOR SHALL NOTIFY THE GENERAL CONTRACTOR WHO WILL VERIFY COMPLETENESS, INCLUDING THE REPLACEMENT OF ALL DEAD PLANT MATERIAL. CONTRACTOR IS RESPONSIBLE FOR SCHEDULING A FINAL INSPECTION BY THE LANDSCAPE ARCHITECT.
- ALL EXTERIOR PLANT MATERIALS SHALL BE GUARANTEED FOR ONE FULL YEAR AFTER DATE OF FINAL INSPECTION AGAINST DEFECTS INCLUDING DEATH AND UNSATISFACTORY GROWTH. DEFECTS RESULTING FROM NEGLIGENCE BY THE OWNER, ABUSE OR DAMAGE BY OTHERS, OR UNUSUAL PHENOMENA OR INCIDENTS WHICH ARE BEYOND THE CONTRACTORS CONTROL ARE NOT THE RESPONSIBILITY OF THE CONTRACTOR.
- PLANT MATERIAL QUANTITIES AND SIZES WILL BE INSPECTED FOR COMPLIANCE WITH APPROVED PLANS BY A SITE PLAN REVIEW AGENT OF THE PLANNING DEPARTMENT PRIOR TO THE RELEASE OF THE CERTIFICATE OF OCCUPANCY.
- REMOVE ALL GUY WIRES AND STAKES 12 MONTHS AFTER INSTALLATION.

## 4 GENERAL NOTES

NTS

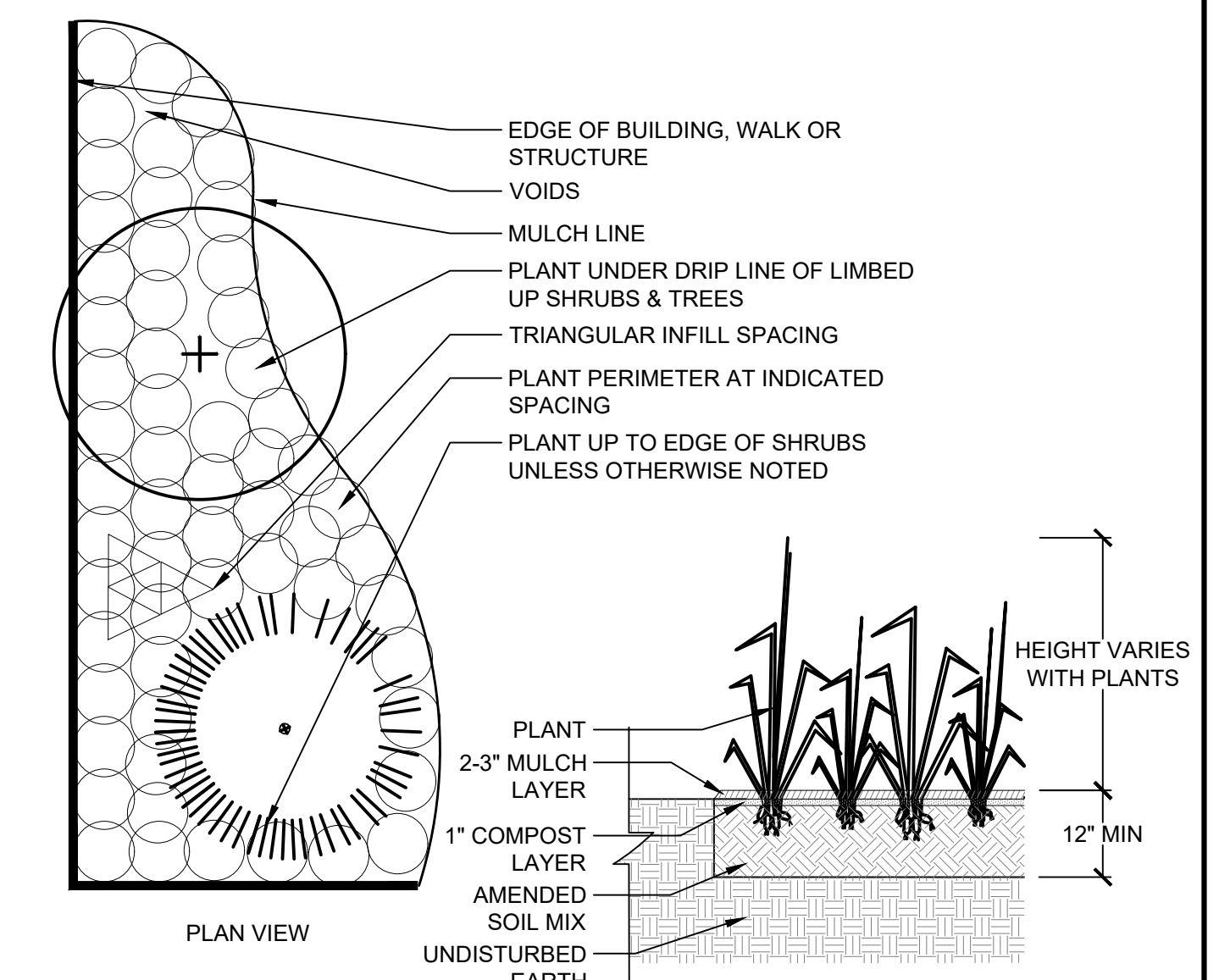
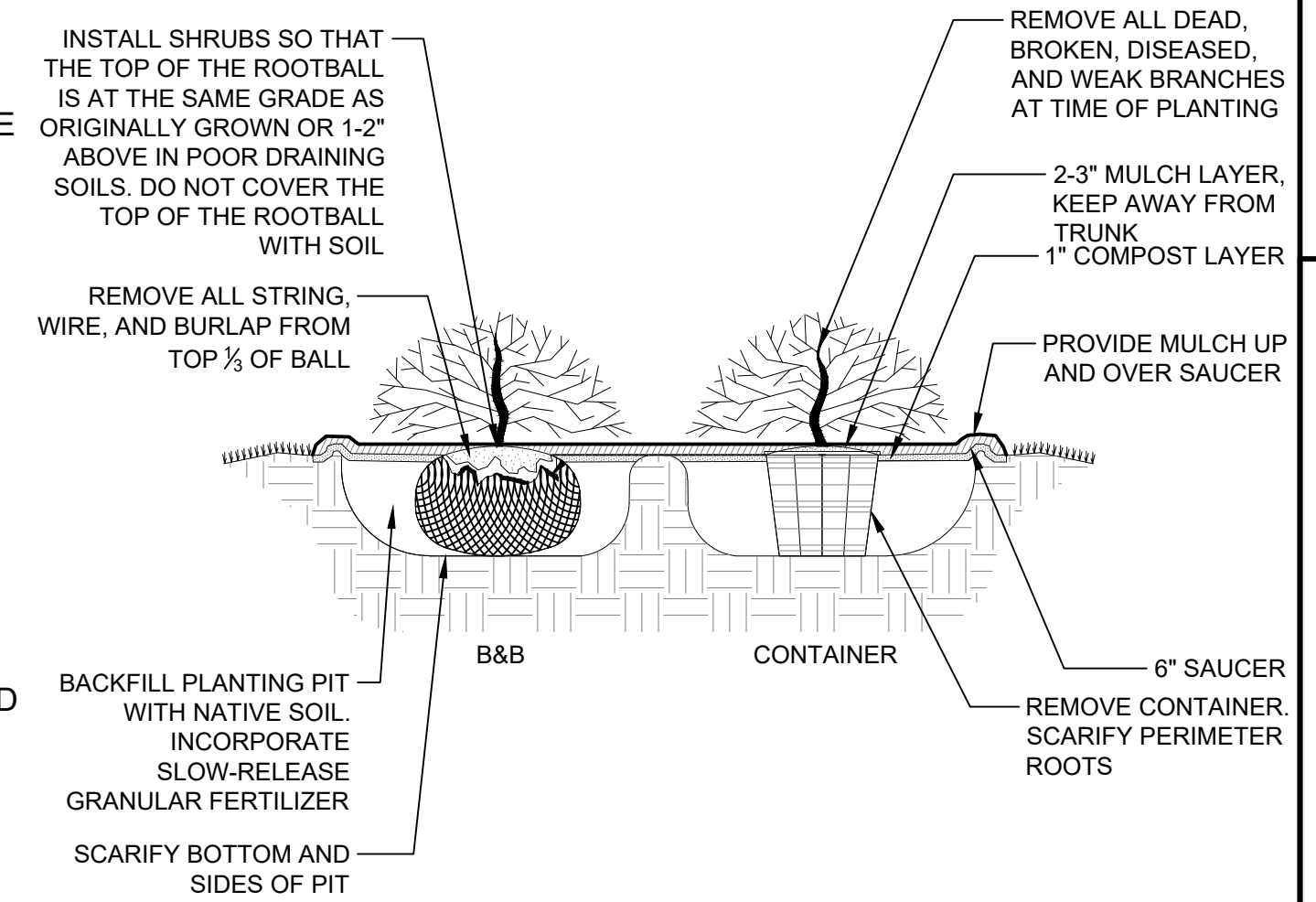
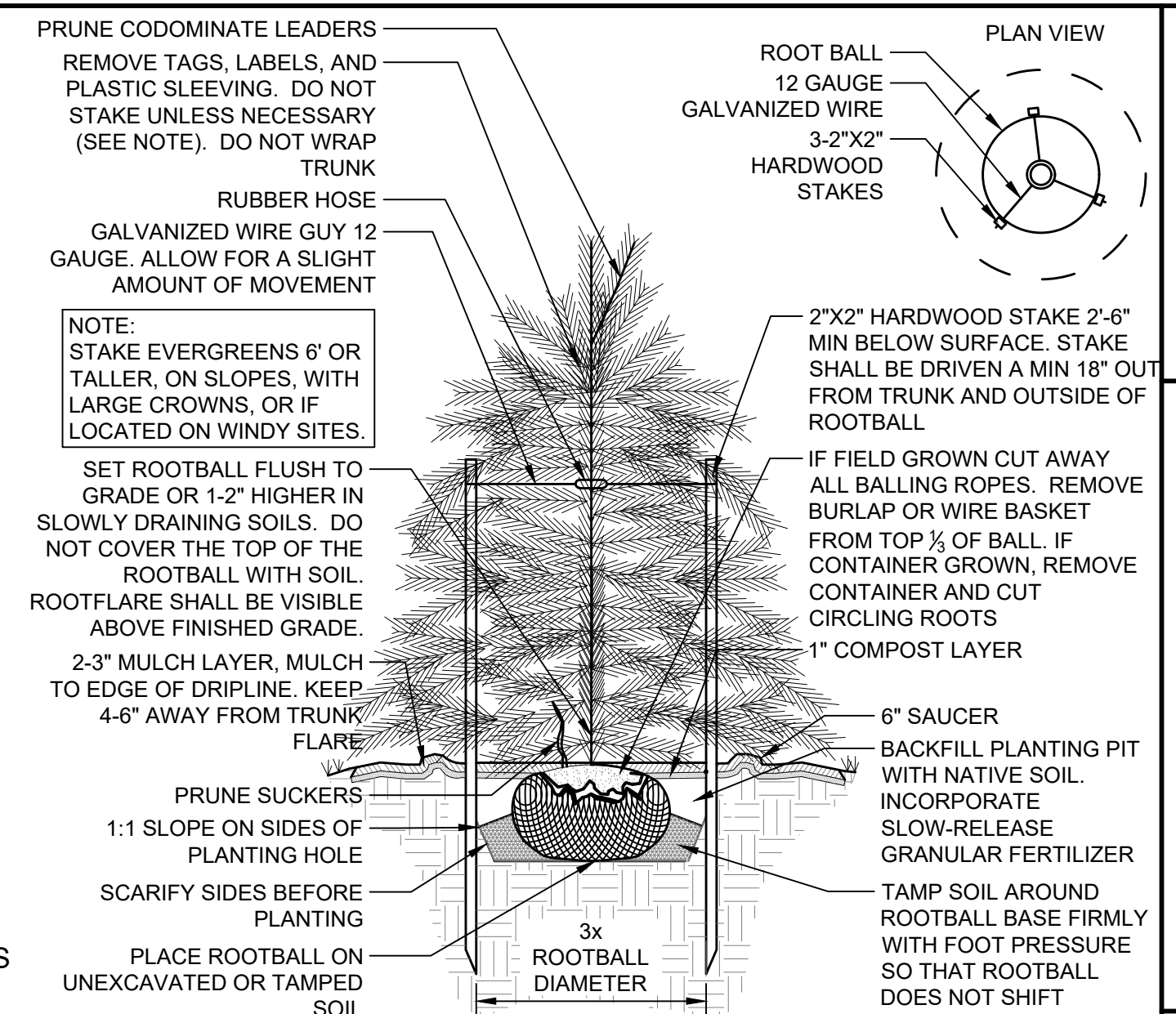

THIS DRAWING PREPARED AT THE  
**RALEIGH OFFICE**  
5410 Trinity Road, Suite 102 | Raleigh, NC 27607  
TEL 919.866.4951 | FAX 919.833.8124 | www.timmons.com

YOUR VISION ACHIEVED THROUGH OURS.

DATE  
4/22/2021

DRAWN BY  
CL

DESIGNED BY  
CL

CHECKED BY  
JM

SCALE  
N/A

**TIMMONS GROUP**  
WOODGROVE  
HARNETT COUNTY, NORTH CAROLINA  
NORTH CAROLINA LICENSE NO. C-1652  
ENTRY MONUMENT LANDSCAPE DETAILS

JOB NO.  
41015

SHEET NO.  
L5.0

S:\331\41015-Drl\_Poor\_Farms\DWG\_Sheet\CD\_Entry\_Sign\_Permits\41015-L5.0-SITE-ENTRY\_LANDSCAPE\_DETAILS.dwg | Plotted by Dave Ballentine



These plans and associated documents are the exclusive property of TIMMONS GROUP and may not be reproduced in whole or in part and shall not be used for any purpose whatsoever, inclusive, but not limited to construction, bidding, and/or construction staking without the express written consent of TIMMONS GROUP.