

landscape architect:
 TMTLA Associates
 5011 Southpark Drive Suite 200
 Durham, North Carolina 27713
 p: (919) 484-8880
 f: (919) 484-8881
 chris@tmtla.com

developer:
 Dan Ryan Builders
 3000 RDU Center Drive | Ste
 202 | Morrisville, NC | 27560

Sign Plan

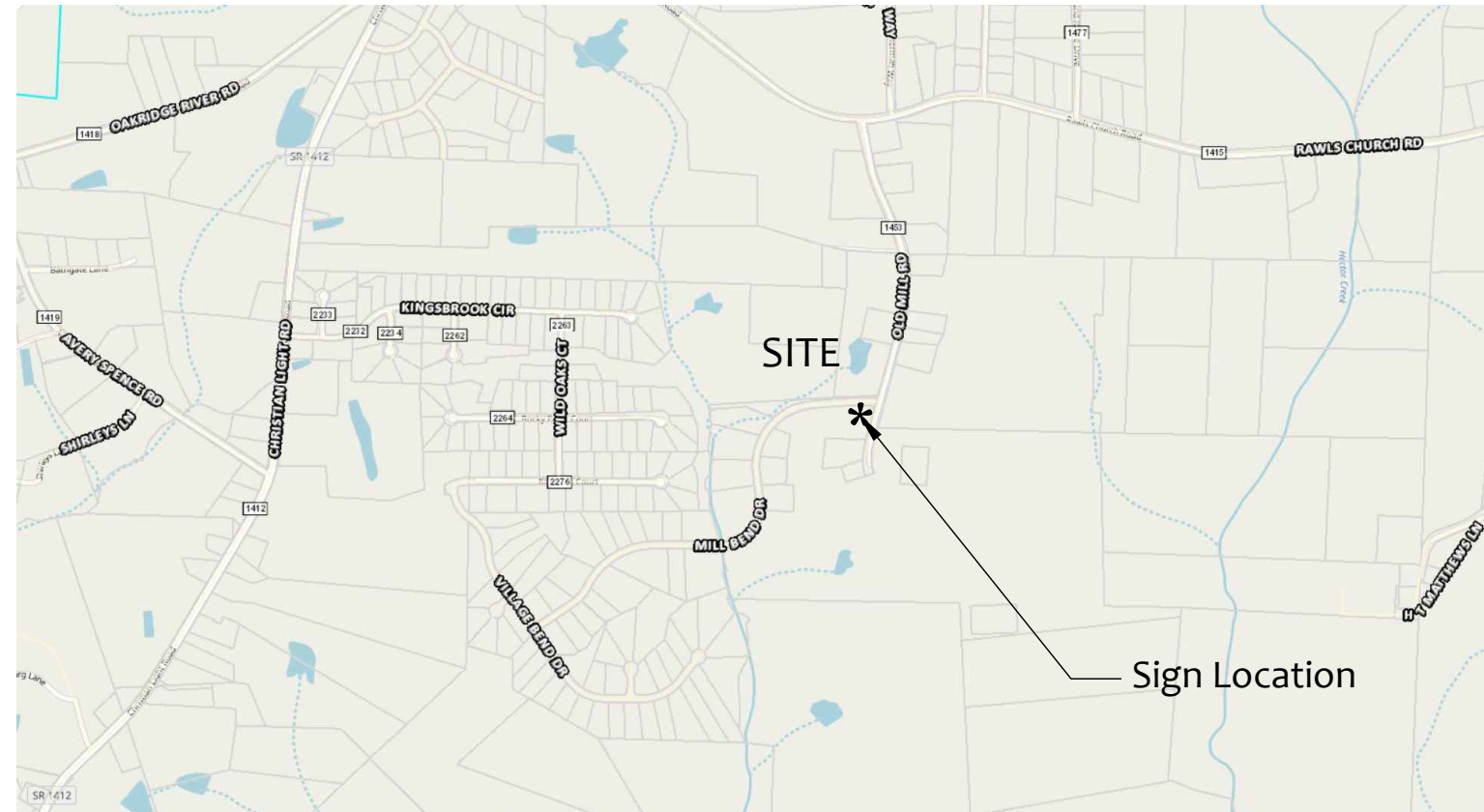

VICINITY MAP

SCALE: NTS

SHEET INDEX

COVER SHEET	_____	
LAYOUT PLAN	_____	S-1
SIGN DETAILS	_____	S-2
SIGN DETAILS	_____	S-3

NOTES:
 1. No entry feature may be located in or overhang any public right-of-way except as permitted and erected by the NC. Dept. of Transportation. No entry feature shall be located in such a manner as to create a visual obstruction for traffic or otherwise create a traffic hazard.

TMTLA ASSOCIATES
 5011 SOUTH PARK DRIVE, STE. 200 - DURHAM, NC 27713
 p: (919) 484-8880 e: info@tmtla.com

02-05-20

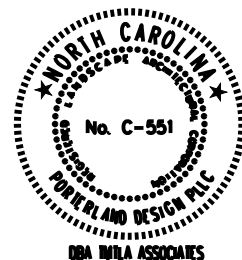

Olde Mill Village
 COVER SHEET
 Mill Bend Drive
 Fuquay-Varina, North Carolina



Dan Ryan Builders
 3000 RDU Center Drive | Ste
 202 | Morrisville, NC | 27560

COVER

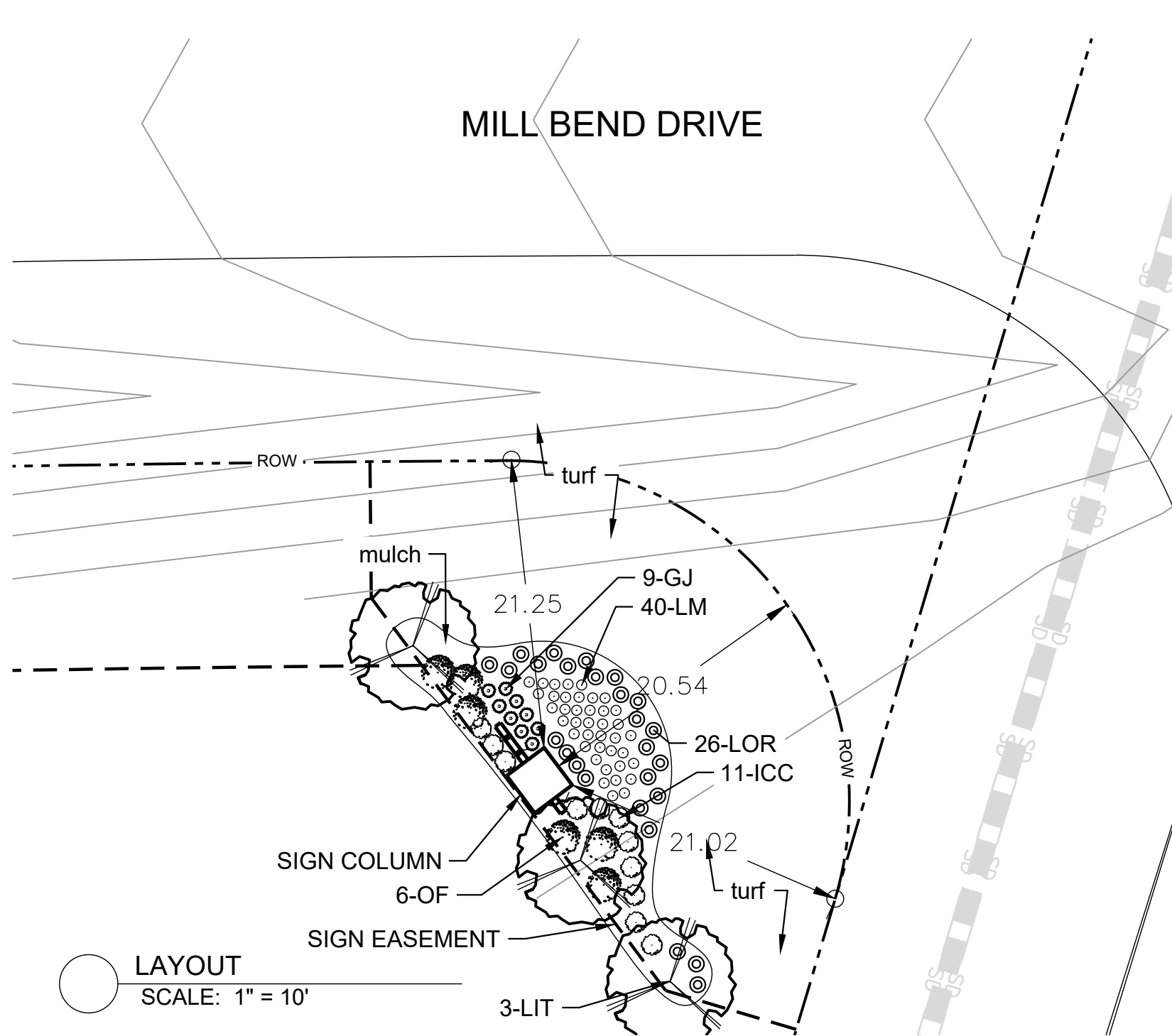

PLANT LIST					
KEY	BOTANICAL NAME	COMMON NAME	SIZE	ROOT	QTY.
LIT	Lagerstroemia indica 'Tuscarora'	Crape Myrtle	12-14' HT.	B&B	3
OF	Osmathus fragens	Tea Olive	36" HT.	Cont.	6
ICC	Ilex cornuta 'Carissa'	Carissa Holly	24"	Cont.	11
LOR	Loropetalum chinense x 'Daruma'	Compact Loropetalum	18"	Cont.	26
GJ	Gardenia jasminoides 'Radicans'	Dwarf Gardenia	18"	Cont.	9
LM	Liriope muscari 'Varigata'	Varigated Liriope	1 gal	Cont.	40

LAYOUT
SCALE: 1" = 10'

OLD MILL ROAD
NCSR #1453 VARIABLE R/W

NOTE: MAP BASE PROVIDED BY DEVELOPER.



Know what's below.
Call before you dig.

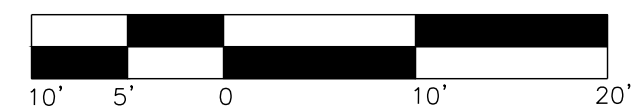
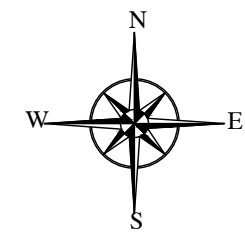

SCALE: 1" = 10'

TMTLA ASSOCIATES
5011 SOUTHPARK DRIVE, STE. 200 - DURHAM, NC 27713
p: (919) 484-8880 e: info@tmtla.com

02-05-20



Olde Mill Village
Mill Bend Drive
Fuquay-Varina, North Carolina

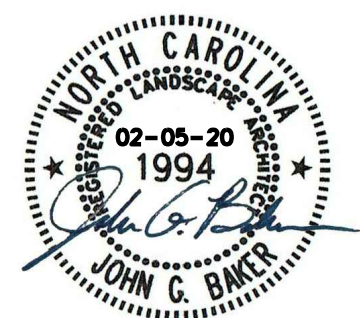

Dan Ryan Builders
3000 RDU Center Drive | Ste 202 | Morrisville, NC | 27560

S-1

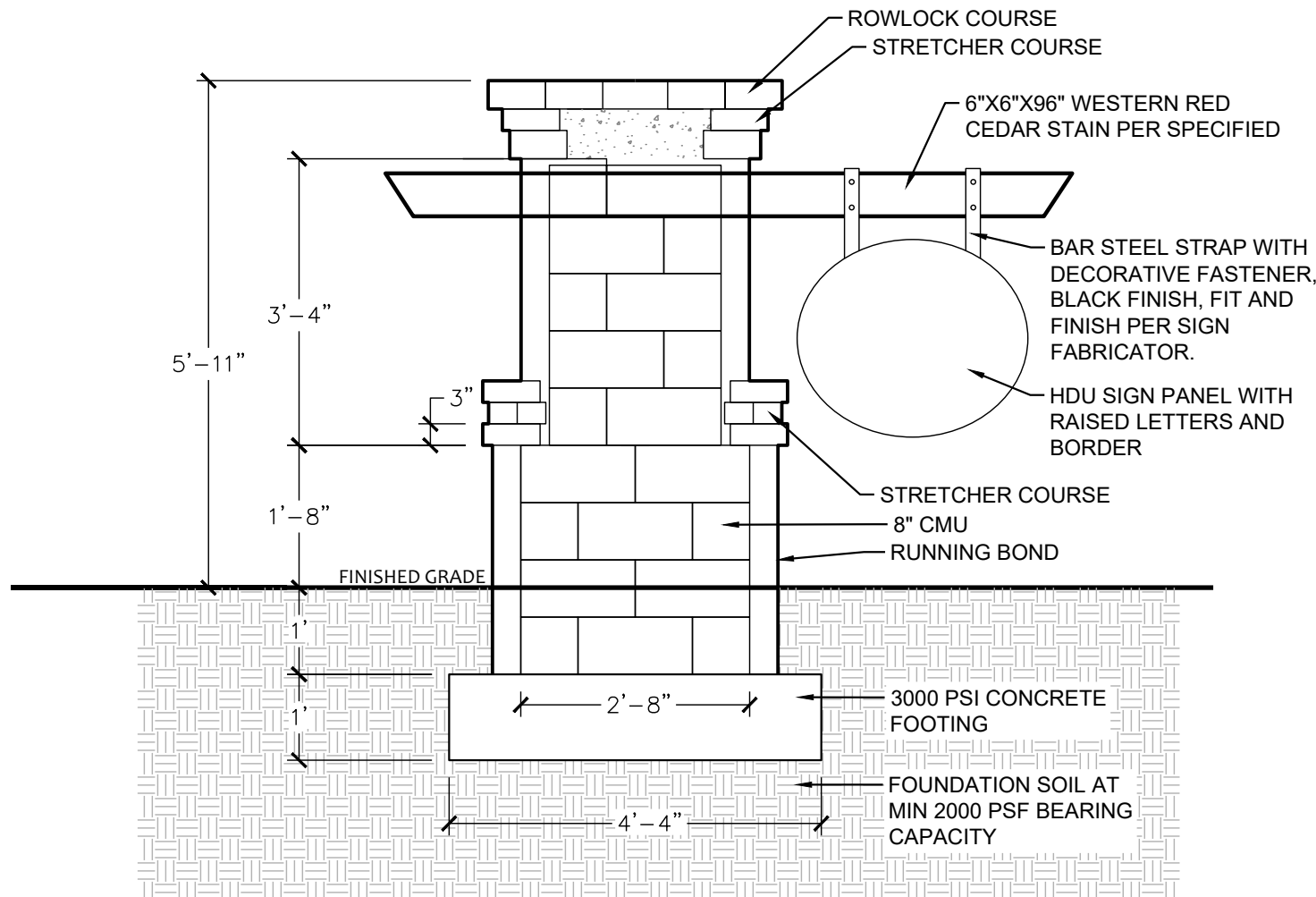

SECTION DETAIL

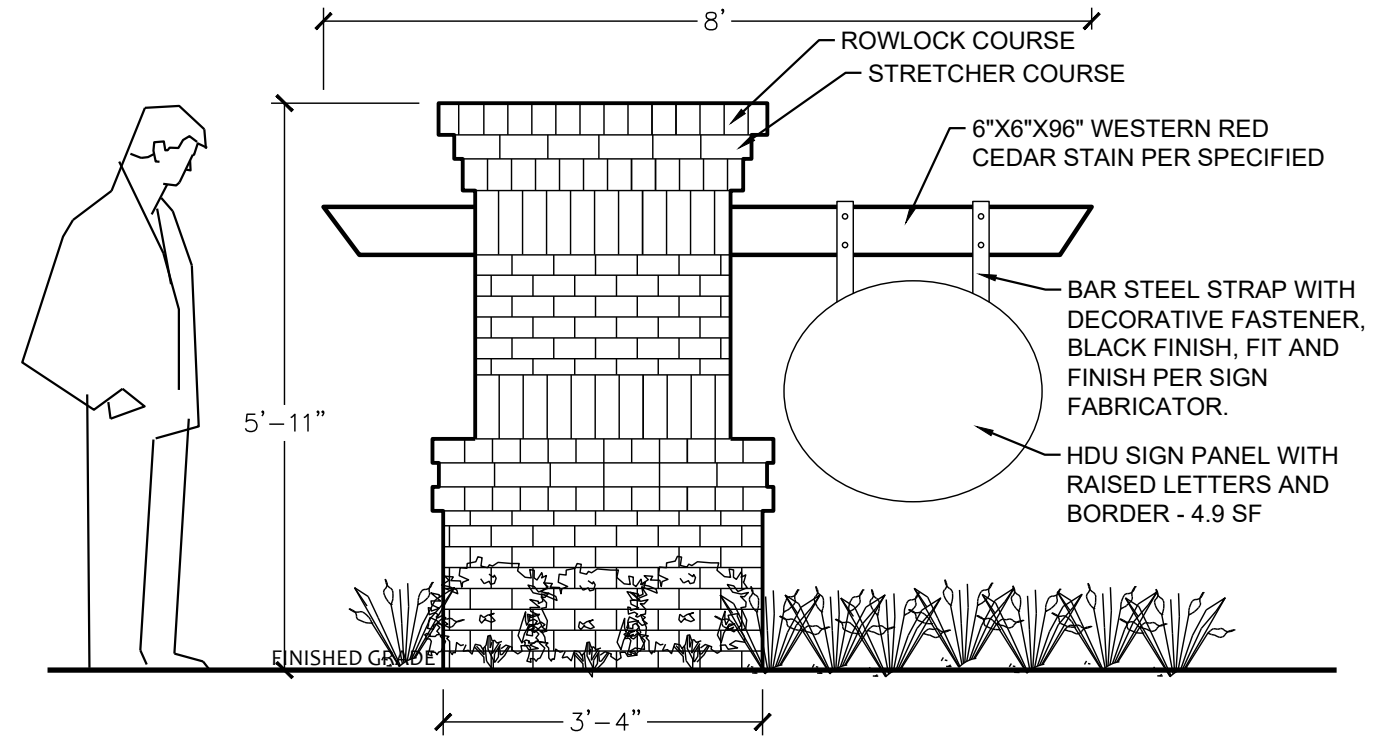

FRONT ELEVATION DETAIL

GENERAL NOTES:

1. All construction shall be in conformance with local ordinance and building code.
2. Secure required building permit(s) prior to commencement of work.
3. Contractor to contact utility locator service, maintain record of marked utilities, and field verify marked utility locations prior to the commencement of construction within area of work.
4. All areas not otherwise landscaped shall be permanently established as turf.
5. All turf areas shall be seeded with Rebel IV tall turf fescue or eqv and established per sediment and erosion control requirements.
6. Do not change the design without approval from the Owner and governing body.
7. Installed plants shall be guaranteed for one year to be free of disease, defect, damage or death and shall be replaced within the warranty period per the request of the owner or its agents.
8. Contractor shall honor plant quantity and size as specified on the plant list.
9. Apply 3 inches of triple shredded hardwood mulch to all landscape areas and tree rings.
10. Brick to be Pine Hall Brick type Chesapeake Pearl or Triangle Brick Cape Fear with ivory buff mortar.
11. Submit brick sample and mortar color to Owner for approval prior to commencement of work.
12. Sign panel art and attachment method shall be approved by owner prior to commencement of work.
13. No structures or plantings shall be erected within right of way.

SIGN DETAILS
SCALE: 1/2"=1'



MONUMENT BRICK - TRIANGLE BRICK CAPE FEAR OR PINE HALL BRICK CHESAPEAKE PEARL WITH CONCAVE IVORY BUFF MORTAR JOINT OR APPROVED EQV



BEHR PREMIUM #ST-110 CHESTNUT SEMI-TRANSPARENT WATERPROOFING EXTERIOR WOOD STAIN AND SEALER OR EQUIVALENT



02-05-20

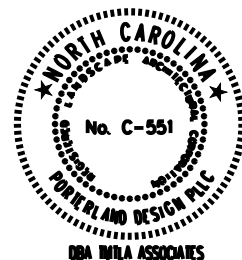

Olde Mill Village
Mill Bend Drive
Fuquay-Varina, North Carolina



Dan Ryan Builders
3000 RDU Center Drive | Ste
202 | Morrisville, NC | 27560

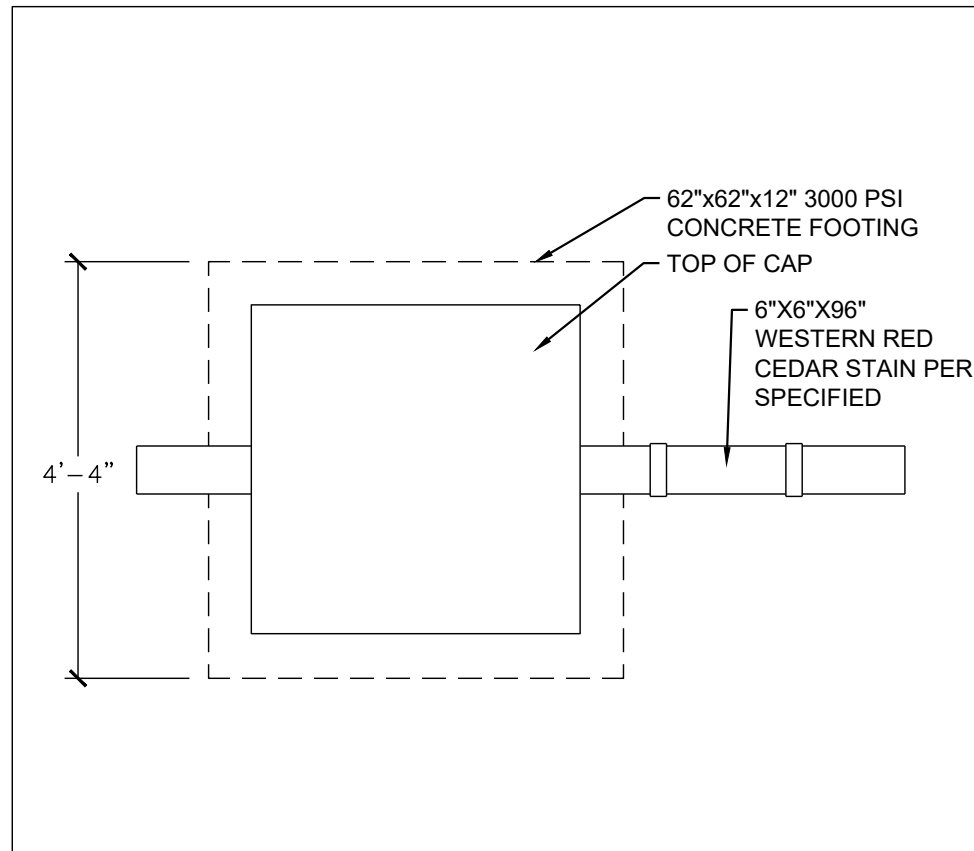

SIGN CROSS SECTION
SCALE: $\frac{1}{2}$ "=1'

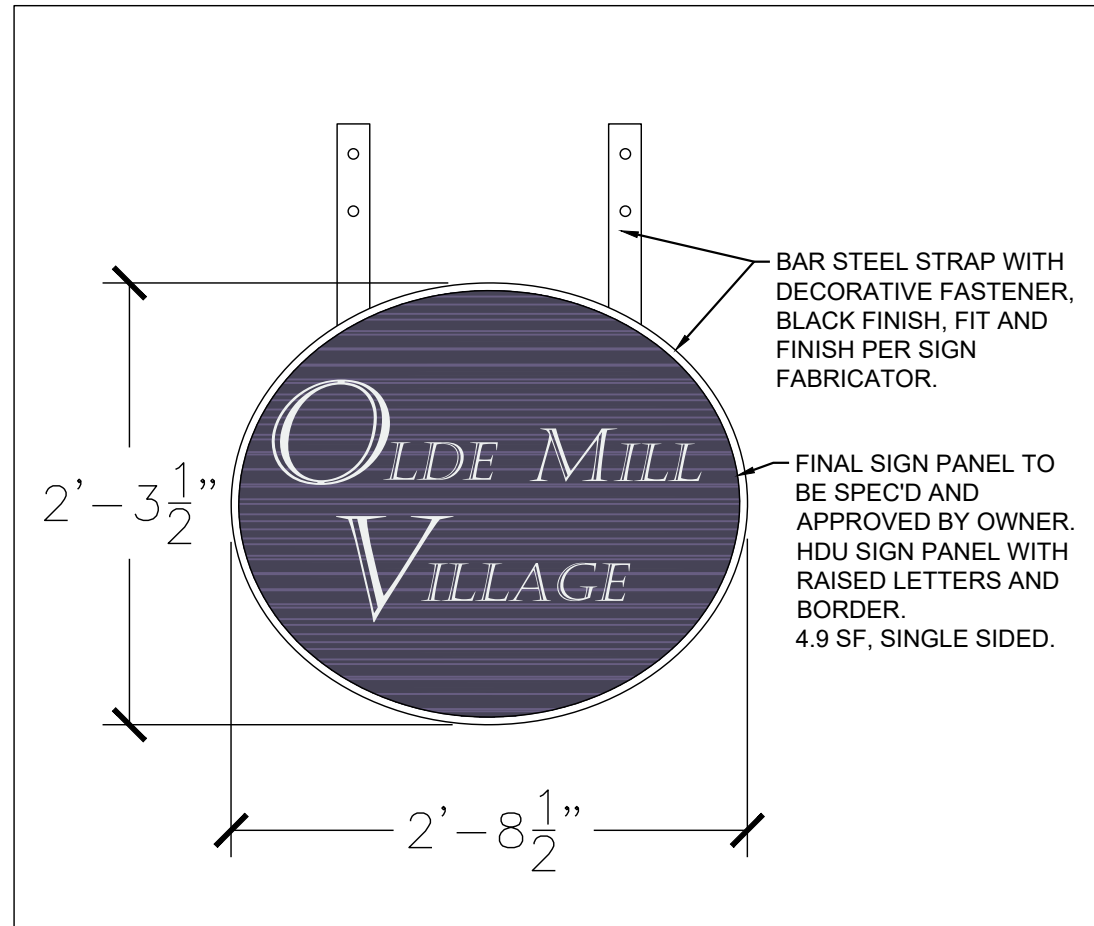

SIGN PANEL DETAIL
SCALE: 1"=1'

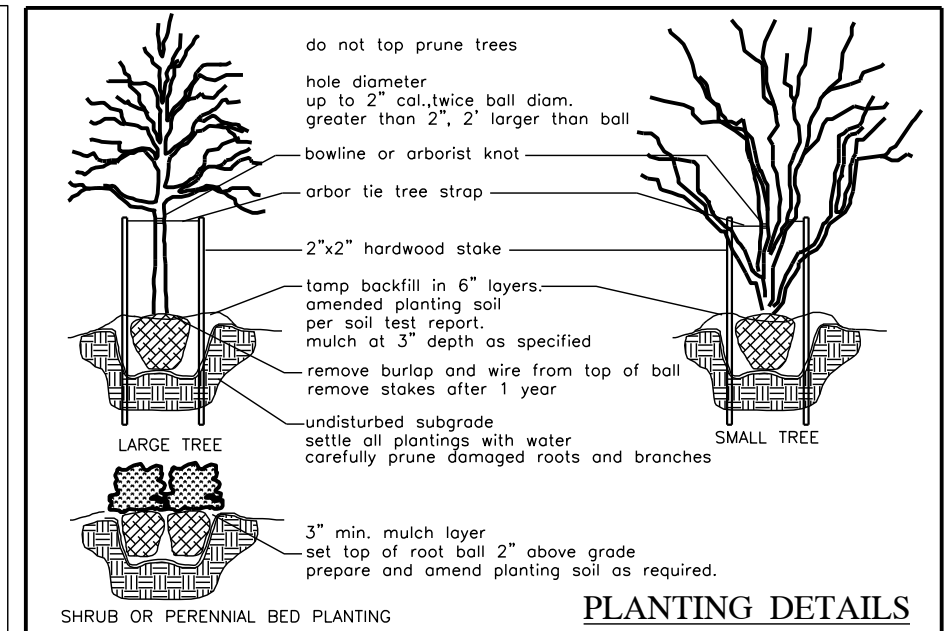

GENERAL PLANTING NOTES

1. VERIFICATION OF TOTAL QUANTITIES AS SHOWN SHALL BE THE RESPONSIBILITY OF THE PLANTING CONTRACTOR.
2. ALL TREES, SHRUBS, AND BEDDING PLANTS SHALL CONFORM TO THE ACCEPTED STANDARDS ESTABLISHED BY THE AMERICAN ASSOCIATION OF NURSERYMEN.
3. ALL SAUCERS SHALL BE SOAKED WITH WATER AND MULCHED IMMEDIATELY FOLLOWING PLANTING.
4. SET TOP OF TREE ROOT BALL 3" ABOVE GRADE, SHRUBS 2" ABOVE GRADE.
5. PLANT MATERIAL SHALL CARRY A ONE YEAR WARRANTY AND REPLACEMENT GUARANTEE.
6. AMEND PLANTING SOIL WITH FERTILIZER AND/OR LIME PER SOIL TEST REPORT AT THE RECOMMENDED MANUFACTURER'S APPLICATION RATE.
7. BLACK COW PLANTING MIX TO BE ADDED TO PLANTING SOILS DURING INSTALLATION AT A RATE OF 10% BY VOLUME FOR SAUCER BACKFILL.
8. GUYING AND STAKING SHALL BE REMOVED AFTER ONE GROWING SEASON.
9. ALL ROOT BALLS REMOVED FROM CONTAINERS SHALL BE SCARIFIED PRIOR TO BACKFILLING.
10. ALL TREES HAVE BEEN LOCATED WITH RESPECT TO KNOWN OR EXISTING FACILITIES OR STRUCTURES, COORDINATE FIELD ADJUSTMENT WITH PROJECT OWNER OR AGENT.
11. ALL PLANT BEDS AND PLANT MATERIAL SHALL BE MAINTAINED IN GOOD HEALTH, AND ANY DEAD, UNHEALTHY OR MISSING PLANTS SHALL BE REPLACED WITH LOCALLY ADAPTED VEGETATION WHICH CONFORMS TO THE INITIAL PLANTING STANDARDS OF THE LANDSCAPE ORDINANCE.
12. REPORT ANY DESCREANCIES TO THE PROJECT OWNER OR AGENT.
13. SUBSTITUTIONS OR ALTERATIONS SHALL NOT BE MADE WITHOUT PRIOR WRITTEN NOTIFICATION BY THE OWNER OR AGENT.
14. APPLY MULCH TO ALL PLANTING AREAS AS SPECIFIED.
15. ALL TREES ARE TO HAVE A MINIMUM 5' DIAMETER MULCH RING.
16. ALL BEDS ARE TO HAVE A SPADE CUT MULCH EDGE WHEN ADJACENT TO TURF.



02-05-20

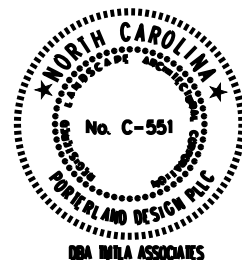

Olde Mill Village
Mill Bend Drive
Fuquay-Varina, North Carolina



Dan Ryan Builders
3000 RDU Center Drive | Ste
202 | Morrisville, NC | 27560