



Initial Application Date: 5/15/19

Application # \_\_\_\_\_  
DRB # \_\_\_\_\_ CU # \_\_\_\_\_

**COMMERCIAL**

**COUNTY OF HARNETT LAND USE APPLICATION**

Central Permitting (Physical) 108 E. Front Street, Lillington, NC 27546 (Mailing) PO Box 65 Lillington NC 27546 Phone: (910) 893-7525 opt # 2 Fax: (910) 893-2793 www.harnett.org/permits

LANDOWNER: ARC FD34PCK001, LLC Mailing Address: 1681 Buffalo Lake Road

City: Sanford State: NC Zip: 27332 Contact # \_\_\_\_\_ Email: \_\_\_\_\_

APPLICANT\*: Anchor Sign, Inc. - Jill Hopkins, contact Mailing Address: 2200 Discher Street

City: Charleston State: SC Zip: 29405 Contact # 843-576-3241 Email: jhopkins@anchorsign.com

\*Please fill out applicant information if different than landowner

CONTACT NAME APPLYING IN OFFICE: \_\_\_\_\_ Phone # \_\_\_\_\_

Address: 1681 Buffalo Lake Road PIN: 03-9587-03-0020-70

Deed Book Page: 03256 / 0641

**PROPOSED USE:**

- Multi-Family Dwelling No. Units: \_\_\_\_\_ No. Bedrooms/Unit: \_\_\_\_\_
- Business Sq. Ft. Retail Space: \_\_\_\_\_ Type: \_\_\_\_\_ # Employees: \_\_\_\_\_ Hours of Operation: \_\_\_\_\_
- Daycare # Preschoolers: \_\_\_\_\_ # Afterschoolers: \_\_\_\_\_ # Employees: \_\_\_\_\_ Hours of Operation: \_\_\_\_\_
- Industry Sq. Ft: \_\_\_\_\_ Type: \_\_\_\_\_ # Employees: \_\_\_\_\_ Hours of Operation: \_\_\_\_\_
- Church Seating Capacity: \_\_\_\_\_ # Bathrooms: \_\_\_\_\_ Kitchen: \_\_\_\_\_
- Accessory/Addition/Other (Size See x<sub>below</sub>) Use: \_\_\_\_\_

Water Supply:  County  Existing Well  New Well (# of dwellings using well \_\_\_\_\_) **\*Must have operable water before final (Need to Complete New Well Application at the same time as New Tank)**

Sewage Supply:  New Septic Tank  Expansion  Relocation  Existing Septic Tank  County Sewer  
(Complete Environmental Health Checklist on other side of application if Septic)

Comments: Install (1) 15.9 sq.ft. Logo internally illuminated channel letter on a raceway on the Front Northwest elevation and (1) 30" Dollar Tree internally illuminated channel letters on a raceway on the Left North elevation and (1) 30" Dollar Tree internally illuminated channel letters on a raceway on the Right Southwest elevation.

If permits are granted I agree to conform to all ordinances and laws of the State of North Carolina regulating such work and the specifications of plans submitted. I hereby state that foregoing statements are accurate and correct to the best of my knowledge. Permit subject to revocation if false information is provided.

\_\_\_\_\_  
Signature of Owner or Owner's Agent

5/15/19  
\_\_\_\_\_  
Date

**\*\*This application expires 6 months from the initial date if permits have not been issued\*\***

**RECORDED DEED (OR OFFER TO PURCHASE) AND PLAT ARE REQUIRED WHEN APPLYING FOR LAND USE APPLICATION**

**\*\*\*It is the owner/applicants responsibility to provide the county with any applicable information about the subject property, including but not limited to: boundary information, house location, underground or overhead easements, etc. The county or its employees are not responsible for any incorrect or missing information that is contained within these applications.\*\*\***

**\*This application expires 6 months from the initial date if permits have not been issued\***



March 20, 2019

County of Harnett, NC  
Attn: Central Permitting  
108 E. Front Street  
Lillington, NC 27546  
Phone: 910-893-7525

To whom this may concern:

In regards to:

Dollar Tree (DL-6934R)  
1681 Buffalo Lake Road  
Sanford, NC 27332

Enclosed please find a check for \$50.00 for permit fees, a permit application and (3) sets of detailed drawings for proposed signage at the above location.

Please contact me right away if there is anything else that you will need or if you have any questions and with any additional fees that are due.

Sincerely,



Jill Hopkins  
Permit Coordinator  
Direct: 843-576-3241  
Fax: 843-576-7241  
Toll-Free: 800-213-3331  
Email: [jhopkins@anchorsign.com](mailto:jhopkins@anchorsign.com)

P.O. Box 22737 • Charleston, SC 29413  
Charleston 843.747.5901 • Toll Free 1.800.213.3331 • Fax 843.747.5907  
[www.AnchorSign.com](http://www.AnchorSign.com)



<b>SIGN A</b>	54" Medallion
Type:	Channel Letter on a Raceway
Illumination:	Internally Illuminated LED
Square Footage:	15.90
To Grade:	Top of Sign to Grade = 21'-5" Bottom of Sign to Grade = 16'-11"

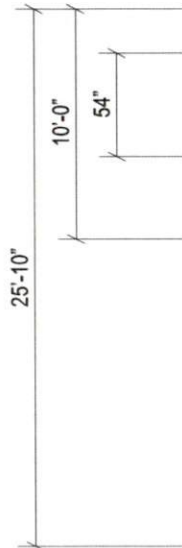
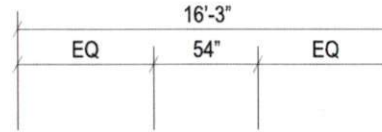

**Front Elevation (Northwest)**

Scale: 1/8" = 1'-0"



Paint bollards (15 total)



Client:	Dollar Tree
Site #:	DL-6934R
Address:	1681 Buffalo Lake Road Sanford, NC 27332

REVISION INFO	02/12/2019	Original Renderings	SD
	03/15/2019	Updated Address	KD

This rendering is the property of Anchor Sign, Inc. It is for the exclusive use of the client. It is not to be distributed, reproduced or exhibited without the consent of Anchor Sign, Inc. Please contact your account manager with questions regarding this statement.

Allowable  
Formula:  
Actual S

<b>SIGN A</b>	54" Medallion
Type:	Channel Letter on a Raceway
Illumination:	Internally Illuminated LED
Square Footage:	15.90
To Grade:	Top of Sign to Grade = 21'-5" Bottom of Sign to Grade = 16'-11"

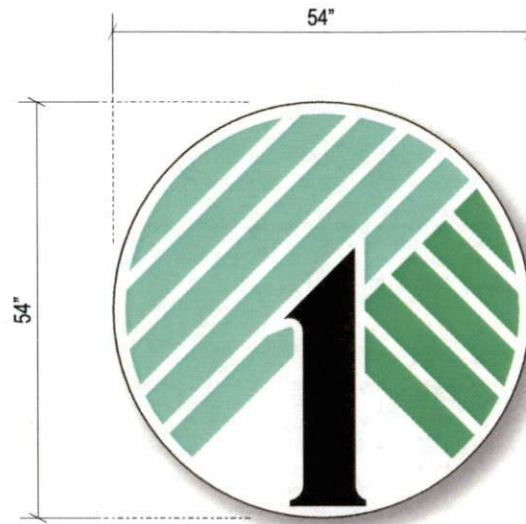

### Sign Layout Detail

Scale: 1/2" = 1'-0"

#### Electrical Detail:

- P-LED White LEDs
- (2) 60w Transformers @ 1.1 amps each
- Total Amps: 2.2
- (1) 20 amp 120V Circuit Req.



#### General Notes:

This sign is to be installed in accordance with the requirements of Article 600 of the National Electrical Code.

- 1) Grounded and bonded per NEC 600.7/NEC 250
- 2) Existing branch circuit in compliance with NEC 600.5, not to exceed 20 amps
- 3) Sign is to be UL listed per NEC 600.3
- 4) UL disconnect switch per NEC 600.6- required per sign component before leaving manufacturer\*  
\*For multiple signs, a disconnect is permitted but not required for each section

#### Specifications: Channel Letter on a Raceway

1. Existing Facade: Brick
2. 0.040" Aluminum letter returns painted to match Bronze
3. 1" Jewelite trimcap (Bronze) bonded to face and #8 pan head screws to returns
4. 3mm Signabond Lite composite backs fastened to returns w/ 1/2" 18 gauge staples. Seal w/ VOC compliant 360 white latex caulk to prevent moisture penetration. (interior of sign can painted white for maximum illumination)
5. White LEDs
6. 3/16" Clear lexan faces w/ second surface digital print vinyl to match:
  - 3M 3630-156 Vivid Green
  - 3M 3630-146 Kelly Green
  - 3M 3650-12 Black (Opaque)
  - White (Translucent)
7. Disconnect switch UL Outdoor rated toggle type w/ neoprene boot per NEC 600-6
8. Primary electrical feed in UL conduit / customer supplied UL junction box
9. Transformers
10. 0.080" Aluminum raceway painted to match **SW 7598 Sierra Redwood**
11. 15" x 2" x 0.1875" Aluminum mounting tabs welded to raceway - Maximum 6" from each end and every 48" o.c.
12. #12 x 1" TEC screws with 1 1/4" fender washers
13. 3/8" Sleeve anchors

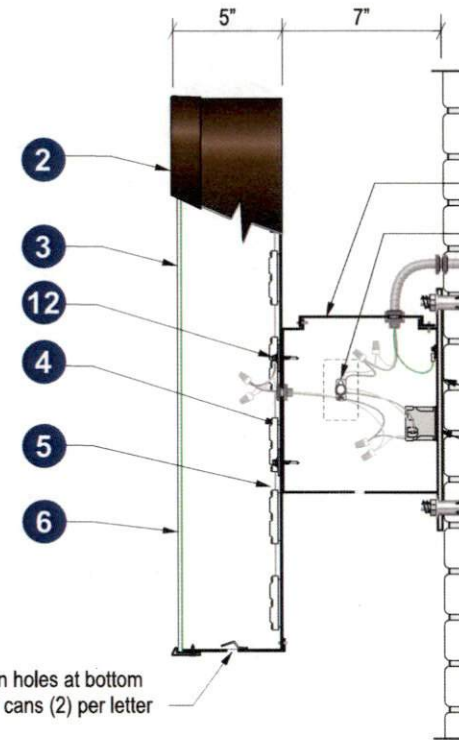

### Section @ LED Channel Raceway (Center)



Client: Dollar Tree  
 Site #: DL-6934R  
 Address: 1681 Buffalo Lake Road  
 Sanford, NC 27332

REVISION INFO

02/12/2019	Original Renderings
03/15/2019	Updated Address

SD  
KD

This rendering is the property of Anchor Sign, Inc. It is for the exclusive use of Anchor Sign, Inc. and the party who requested the rendering. It is unpublished original drawing not to be distributed, reproduced or exhibited without the consent of Anchor Sign, Inc. Please contact your account manager with questions regarding this statement.



<b>SIGN B</b>	30" Dollar Tree [Linear]
Type:	Channel Letters on a Raceway
Illumination:	Internally Illuminated LED
Square Footage:	66.82
To Grade:	Top of Sign to Grade = 22'-8" Bottom of Sign to Grade = 20'-2"

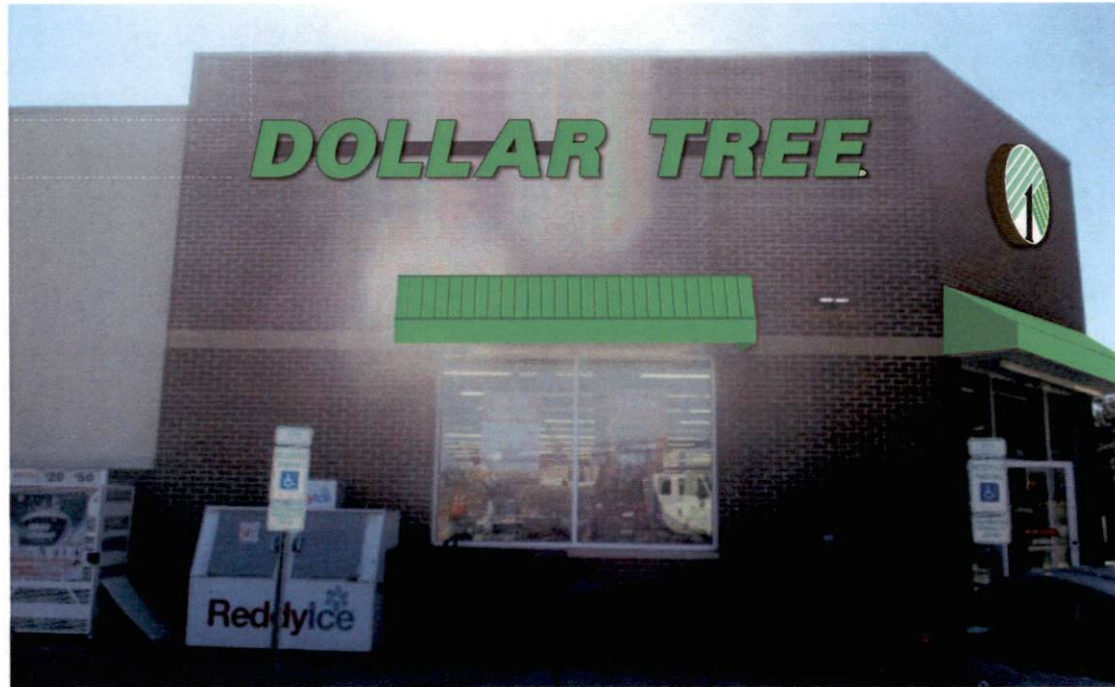
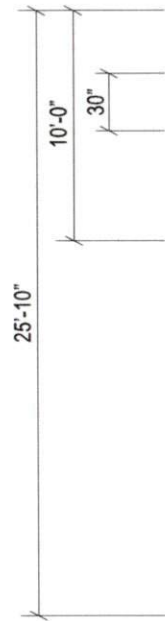
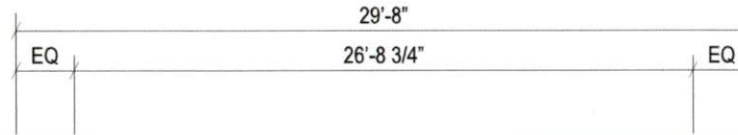

**Left Elevation (North)**

Scale: 1/8" = 1'-0"

Allowabl  
Formula:  
Actual S

<b>DOLLAR TREE</b>	Client: Dollar Tree	02/12/2019	Original Renderings	SD
	Site #: DL-6934R	03/15/2019	Updated Address	KD
	Address: 1681 Buffalo Lake Road			
	Sanford, NC 27332			

This rendering is the property of Anchor Sign, Inc. It is for the exclusive use of the client. Anchor Sign, Inc. and the party requested the rendering. It is an unpublished original drawing not to be distributed, reproduced or exhibited without the consent of Anchor Sign, Inc. Please contact your account manager with questions regarding this state

<b>SIGN B</b>	30" Dollar Tree [Linear]
Type:	Channel Letters on a Raceway
Illumination:	Internally Illuminated LED
Square Footage:	66.82
To Grade:	Top of Sign to Grade = 22'-8" Bottom of Sign to Grade = 20'-2"



### Sign Layout Detail

Scale: 1/4" = 1'-0"

#### Electrical Detail:

- P-LED Green LEDs
- (2) 60w Transformers @ 1.1 amps each  
Total Amps: 2.2
- (1) 20 amp 120V Circuit Req.



#### General Notes:

This sign is to be installed in accordance with the requirements of Article 600 of the National Electrical Code.

- 1) Grounded and bonded per NEC 600.7/NEC 250
- 2) Existing branch circuit in compliance with NEC 600.5, not to exceed 20 amps
- 3) Sign is to be UL listed per NEC 600.3
- 4) UL disconnect switch per NEC 600.6- required per sign component before leaving manufacturer\*  
\*For multiple signs, a disconnect is permitted but not required for each section

#### Specifications: Channel Letters on a Raceway

1. Existing Facade: Brick
2. 0.040" Aluminum letter returns painted to match Bronze
3. 1" Jewelite trimcap (Bronze) bonded to face and #8 pan head screws to returns
4. 3mm Signabond Lite composite backs fastened to returns w/ 1/2" 18 gauge staples. Seal w/ VOC compliant 360 white latex caulk to prevent moisture penetration. (interior of sign can painted white for maximum illumination)
5. Green LEDs
6. 3/16" Clear lexan faces w/ second surface vinyl  
 3M 3630-156 Vivid Green (Translucent)  
 3635-70 diffuser
7. Disconnect switch UL Outdoor rated toggle type w/ neoprene boot per NEC 600-6
8. Primary electrical feed in UL conduit / customer supplied UL junction box
9. Transformers
10. 0.080" Aluminum raceway painted to match **SW 7598 Sierra Redwood**
11. 15" x 2" x 0.1875" Aluminum mounting tabs welded to raceway - Maximum 6" from each end and every 48" o.c.
12. #12 x 1" TEC screws with 1 1/4" fender washers
13. 3/8" Sleeve anchors

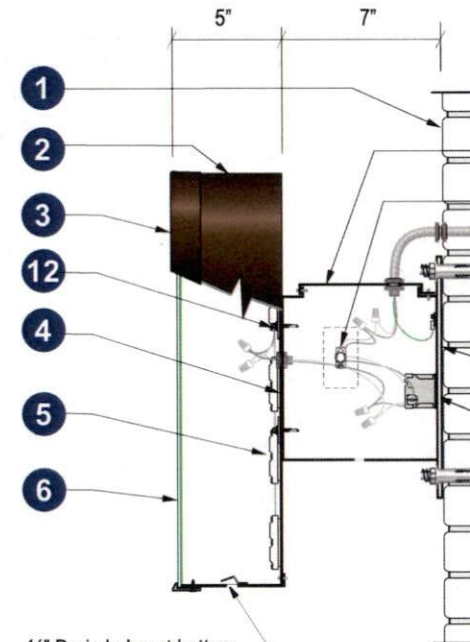

#### Section @ LED Channel Raceway (Center)

**DOLLAR TREE**

Client: Dollar Tree  
 Site #: DL-6934R  
 Address: 1681 Buffalo Lake Road  
 Sanford, NC 27332

REVISION INFO

02/12/2019	Original Renderings
03/15/2019	Updated Address

SD  
 KD

This rendering is the property of Anchor Sign, Inc. It is for the exclusive use of Anchor Sign, Inc. and the party who requested the rendering. It is unpublished original drawing not to be distributed, reproduced or exhibited without the consent of Anchor Sign, Inc. Please contact your account manager with questions regarding this matter.



<b>SIGN C</b>	30" Dollar Tree [Linear]
Type:	Channel Letters on a Raceway
Illumination:	Internally Illuminated LED
Square Footage:	66.82
To Grade:	Top of Sign to Grade = 22'-8" Bottom of Sign to Grade = 20'-2"

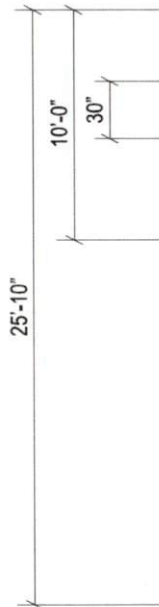
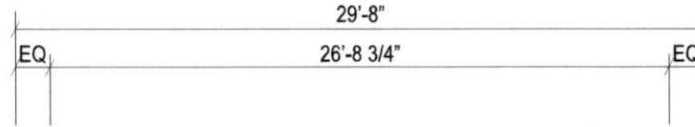

**Right Elevation (Southwest)**

Scale: 1/8" = 1'-0"



**DOLLAR TREE**

Client: Dollar Tree  
 Site #: DL-6934R  
 Address: 1681 Buffalo Lake Road  
 Sanford, NC 27332

REVISION INFO

02/12/2019	Original Renderings	SD
03/15/2019	Updated Address	KD

This rendering is the property of Anchor Sign, Inc. It is for the exclusive use of Anchor Sign, Inc. and the party requested the rendering. It is unpublished original drawing not distributed, reproduced or exhibited without the consent of Anchor Sign, Inc. Please contact your account manager with questions regarding this state.

Allowable  
 Formula:  
 Actual S

<b>SIGN C</b>	30" Dollar Tree [Linear]
Type:	Channel Letters on a Raceway
Illumination:	Internally Illuminated LED
Square Footage:	66.82
To Grade:	Top of Sign to Grade = 22'-8" Bottom of Sign to Grade = 20'-2"



### Sign Layout Detail

Scale: 1/4" = 1'-0"

#### Electrical Detail:

- P-LED Green LEDs
- (2) 60w Transformers @ 1.1 amps each  
Total Amps: 2.2
- (1) 20 amp 120V Circuit Req.



#### General Notes:

This sign is to be installed in accordance with the requirements of Article 600 of the National Electrical Code.

- 1) Grounded and bonded per NEC 600.7/NEC 250
- 2) Existing branch circuit in compliance with NEC 600.5, not to exceed 20 amps
- 3) Sign is to be UL listed per NEC 600.3
- 4) UL disconnect switch per NEC 600.6- required per sign component before leaving manufacturer\*  
\*For multiple signs, a disconnect is permitted but not required for each section

#### Specifications: Channel Letters on a Raceway

1. Existing Facade: Brick
2. 0.040" Aluminum letter returns painted to match Bronze
3. 1" Jewelite trimcap (Bronze) bonded to face and #8 pan head screws to returns
4. 3mm Signabond Lite composite backs fastened to returns w/ 1/2" 18 gauge staples. Seal w/ VOC compliant 360 white latex caulk to prevent moisture penetration. (interior of sign can painted white for maximum illumination)
5. Green LEDs
6. 3/16" Clear lexan faces w/ second surface vinyl  
 3M 3630-156 Vivid Green (Translucent)  
 3635-70 diffuser
7. Disconnect switch UL Outdoor rated toggle type w/ neoprene boot per NEC 600-6
8. Primary electrical feed in UL conduit / customer supplied UL junction box
9. Transformers
10. 0.080" Aluminum raceway painted to match **SW 7598 Sierra Redwood**
11. 15" x 2" x 0.1875" Aluminum mounting tabs welded to raceway - Maximum 6" from each end and every 48" o.c.
12. #12 x 1" TEC screws with 11/4" fender washers
13. 3/8" Sleeve anchors

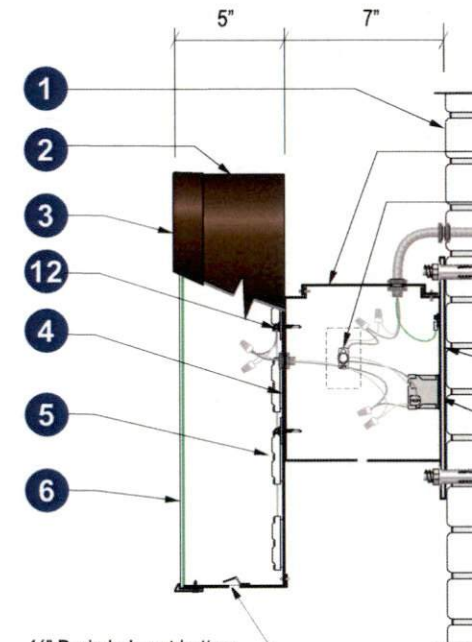

#### Section @ LED Channel Raceway (Center)



Client: Dollar Tree  
 Site #: DL-6934R  
 Address: 1681 Buffalo Lake Road  
 Sanford, NC 27332

REVISION INFO

02/12/2019	Original Renderings
03/15/2019	Updated Address

SD  
KD

This rendering is the property of Anchor Sign, Inc. It is for the exclusive use of Anchor Sign, Inc. and the party requesting the rendering. It is unpublished original drawing not to be distributed, reproduced or exhibited without the consent of Anchor Sign, Inc. Please contact your account manager with questions regarding this matter.



# DOLLAR TREE

<b>SIGN A</b>	54" Medallion
Type:	Channel Letter on a Raceway
Illumination:	Internally Illuminated LED
Square Footage:	15.90
To Grade:	Top of Sign to Grade = 21'-5" Bottom of Sign to Grade = 16'-11"

<b>SIGN B</b>	30" Dollar Tree [Linear]
Type:	Channel Letters on a Raceway
Illumination:	Internally Illuminated LED
Square Footage:	66.82
To Grade:	Top of Sign to Grade = 22'-8" Bottom of Sign to Grade = 20'-2"

<b>SIGN C</b>	30" Dollar Tree [Linear]
Type:	Channel Letters on a Raceway
Illumination:	Internally Illuminated LED
Square Footage:	66.82
To Grade:	Top of Sign to Grade = 22'-8" Bottom of Sign to Grade = 20'-2"

<b>SIGN D</b>	Dollar Tree
Type:	New Panform Panel w/ Applied Vinyl
Actual Size:	86" x 121 1/2"
Viewable Size:	82" x 117 1/2"
Square Footage:	72.56



**DOLLAR TREE**

Client: Dollar Tree  
 Site #: DL-6934R  
 Address: 1681 Buffalo Lake Road  
 Sanford, NC 27332

REVISION INFO

02/12/2019	Original Renderings	SD
03/15/2019	Updated Address	KD

This rendering is the property of Anchor Sign, Inc. It is for the exclusive use of Anchor Sign, Inc. and the party who requested the rendering. It is an unpublished original drawing not to be distributed, reproduced or exhibited without the consent of Anchor Sign, Inc. Please contact your account manager with questions regarding this state-