

IMPROVEMENT PERMIT

Be it ordained by the Harnett County Board of Health as follows: Section III, Item B. "No Person shall begin construction of any building at which a septic tank system is to be used for disposal of sewage without first obtaining a written permit from the Harnett County Health Department."

Name: (owner) William Billings

New Installation Septic Tank

Property Location: SR# 1443 Lafayette Rd

Repairs Nitrification Line

Subdivision Victoria Hills Lot # 167

Tax ID # _____ Quadrant # _____

Number of Bedrooms Proposed: 3 Lot Size: .66 ac

Basement with Plumbing: Garage:

Water Supply: Well Public Community

Distance From Well: 50 min ft.

Following is the minimum specifications for sewage disposal system on above captioned property. Subject to final approval.

Type of system: Conventional Other 25% Reduction System

Size of tank: Septic Tank: 1000 gallons Pump Tank: _____ gallons

Subsurface Drainage Field No. of ditches 1 exact length of each ditch 300 ft. width of ditches 3 ft. depth of ditches 18 in. MAX

French Drain Required: _____ Linear feet

Date: 6/18/2003

This permit is subject to revocation if site plans or intended use change.

Signed: Bryan McSwain R.S.
Environmental Health Specialist

- * Maintain all setbacks
- * Run line on contour to NO DEEPER than 18 inches
- * End of line should be NO closer than 20 feet from back left property corner

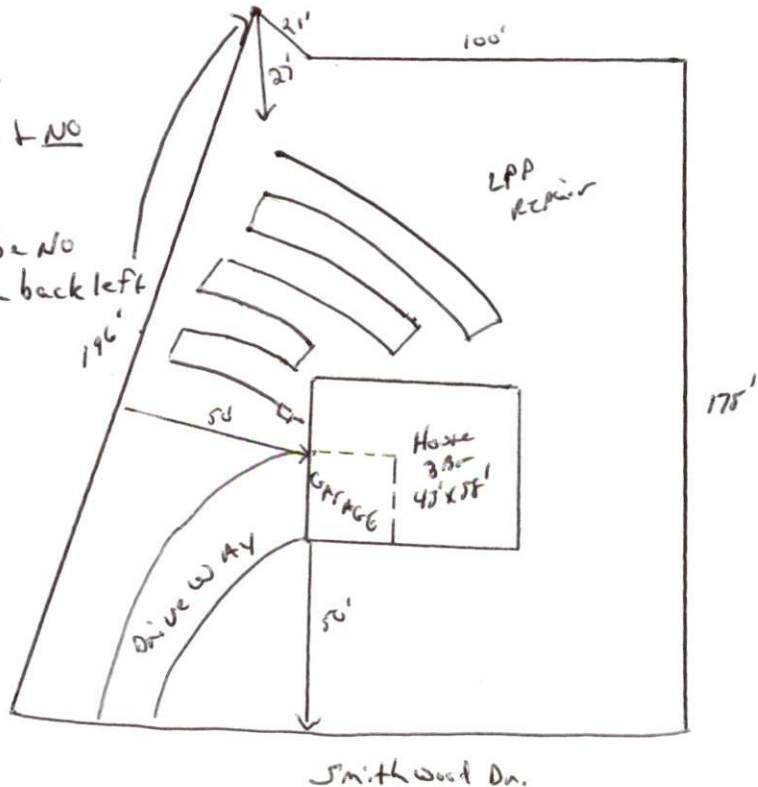

HAI HARNETT COUNTY HEALTH DEPARTMENT
AUTHORIZATION TO CONSTRUCT

Authorization is hereby given to construct a wastewater system to the specifications described by Harnett County Health Department, Improvement Permit # 19351. This authorization shall be valid for a period not to exceed five (5) years from the date of issuance. This authorization will be invalid if ownership, site plans, or intended use change.

Name W. Williams Billing Telephone# 911 967-0438

Address 10012 Crew Chapel Hill, N.C. 27517

Property Location SR# 1443 Road Name LaFayette

Subdivision Victoria Hills Lot # 167 # Bedrooms Proposed 3 Lot Size .664c

TYPE OF SYSTEM

New Installation Repair Septic Tank Nitrification Lines

Conventional Other 25% Redaction System

Basement With Plumbing Without Plumbing

Water Supply: Well Public Water Supply Minimum Well Setback: 50 Ft.

Septic Tank 1000 gal Pump Chamber gal

NITRIFICATION FIELD SPECIFICATIONS

Number of fields 1 # of lines per field 1 Length of lines 300 Ft.

Width of ditches 3 ft. Depth of ditches 18 inches MAX

French Drain: Linear feet required Depth of gravel

No wastewater system shall be covered or placed into use by any person until an inspection by the Harnett County Health Department has determined that the system has been installed according to the conditions of the Improvement Permit and that a valid Operations Permit has been issued.

Bryan McLean R.S.
Signature of Authorized Agent for Harnett County of Harnett

6/18/2003
Date