

IMPROVEMENT PERMIT

03-5-7026

Be it ordained by the Harnett County Board of Health as follows: Section III, Item B. "No Person shall begin construction of any building at which a septic tank system is to be used for disposal of sewage without first obtaining a written permit from the Harnett County Health Department."

Name: (owner) Hutaff Cont. New Installation Septic Tank Repairs Nitrification Line

Property Location: SR# 1115

Subdivision Crestview Est. Lot # 108

Tax ID # _____ Quadrant # _____

Number of Bedrooms Proposed: 4 (54x52) Lot Size: 0.345 AC

Basement with Plumbing: Garage: Meat on site may not require pump.

Water Supply: Well Public Community

Distance From Well: _____ ft.

Following is the minimum specifications for sewage disposal system on above captioned property. Subject to final approval.

Type of system: Conventional Other _____

Size of tank: Septic Tank: 1000 gallons Pump Tank: 1000 gallons

Subsurface Drainage Field No. of ditches 4 exact length 75 ft. width of 3 ft. depth of 18 in. ditches

French Drain Required: _____ Linear feet

Date: 5-12-03

This permit is subject to revocation if site plans or intended use change.

Signed: Joe Waters Environmental Health Specialist

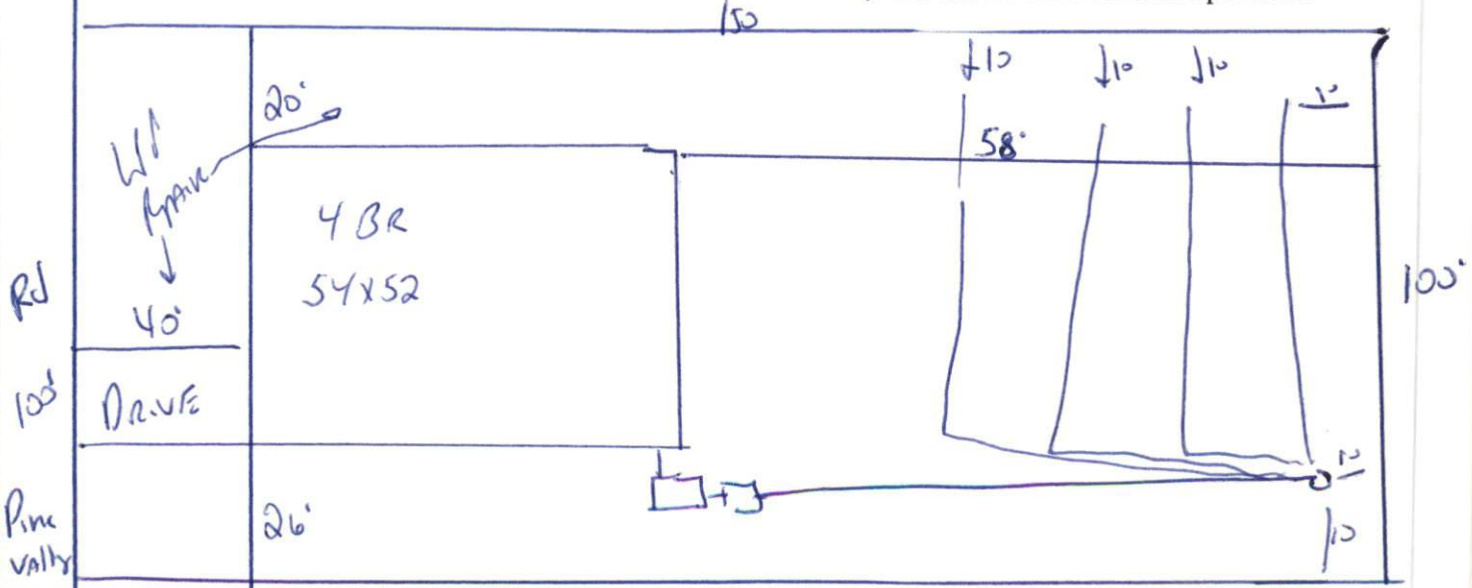

STUB out plumbing shallow where shown and Pump may not be needed - meet on site - MAINTAIN ALL SET BACKS Follow contours - Do not DRIVE OR park on septic SYSTEM.

HARNETT COUNTY HEALTH DEPARTMENT
AUTHORIZATION TO CONSTRUCT

Authorization is hereby given to construct a wastewater system to the specifications described by Harnett County Health Department, Improvement Permit # 20041. This authorization shall be valid for a period not to exceed five (5) years from the date of issuance. This authorization will be invalid if ownership, site plans, or intended use change.

Huntall Court. 322-5552
Name Telephone#

Address

1115

Property Location SR# Road Name

CRESTVIEW 108 4 (54x52) 345 AC

Subdivision Lot # # Bedrooms Proposed Lot Size

TYPE OF SYSTEM

New Installation Repair Septic Tank Nitrification Lines

Conventional Other Pump to Conv.

Basement With Plumbing Without Plumbing

Water Supply: Well Public Water Supply Minimum Well Setback: _____ Ft.

Septic Tank 1000 gal Pump Chamber 1000 gal

NITIRFICATION FIELD SPECIFICATIONS

Number of fields 1 # of lines per field 4 Length of lines 75 Ft.

Width of ditches 3 ft. Depth of ditches 18.24 inches

French Drain: Linear feet required _____ Depth of gravel _____

No wastewater system shall be covered or placed into use by any person until an inspection by the Harnett County Health Department has determined that the system has been installed according to the conditions of the Improvement Permit and that a valid Operations Permit has been issued.

[Signature] 5-12-03
Signature of Authorized Agent for Harnett County of Harnett Date