

IMPROVEMENT PERMIT

03-5-6912

Be it ordained by the Harnett County Board of Health as follows: Section III, Item B. "No Person shall begin construction of any building at which a septic tank system is to be used for disposal of sewage without first obtaining a written permit from the Harnett County Health Department."

Name: (owner) Kent Pierce

New Installation Septic Tank

Property Location: SR# 1115

Repairs Nitrification Line

Subdivision Peach Tree Crossing Lot # 103

Tax ID # _____ Quadrant # _____

Number of Bedrooms Proposed: 3 (47x50) Lot Size: 1.14 AC

Basement with Plumbing: Garage: NOTE Changes in how

Water Supply: Well Public Community DRIVE and GARAGE location

Distance From Well: 50 ft.

Following is the minimum specifications for sewage disposal system on above captioned property. Subject to final approval.

Type of system: Conventional Other Sept-Combined

Size of tank: Septic Tank: 1000 gallons Pump Tank: 100 gallons

Subsurface Drainage Field No. of 4 exact length 75 width of 3 depth of 18 max ditches 4 of each ditch 75 ft. ditches 3 ft. ditches 18 in.

French Drain Required: To Be Determined Linear feet Before system is installed

Date: 5-20-03

This permit is subject to revocation if site plans or intended use change.

Signed: Jon Walker
Environmental Health Specialist

Repair is pretreatment to LPP

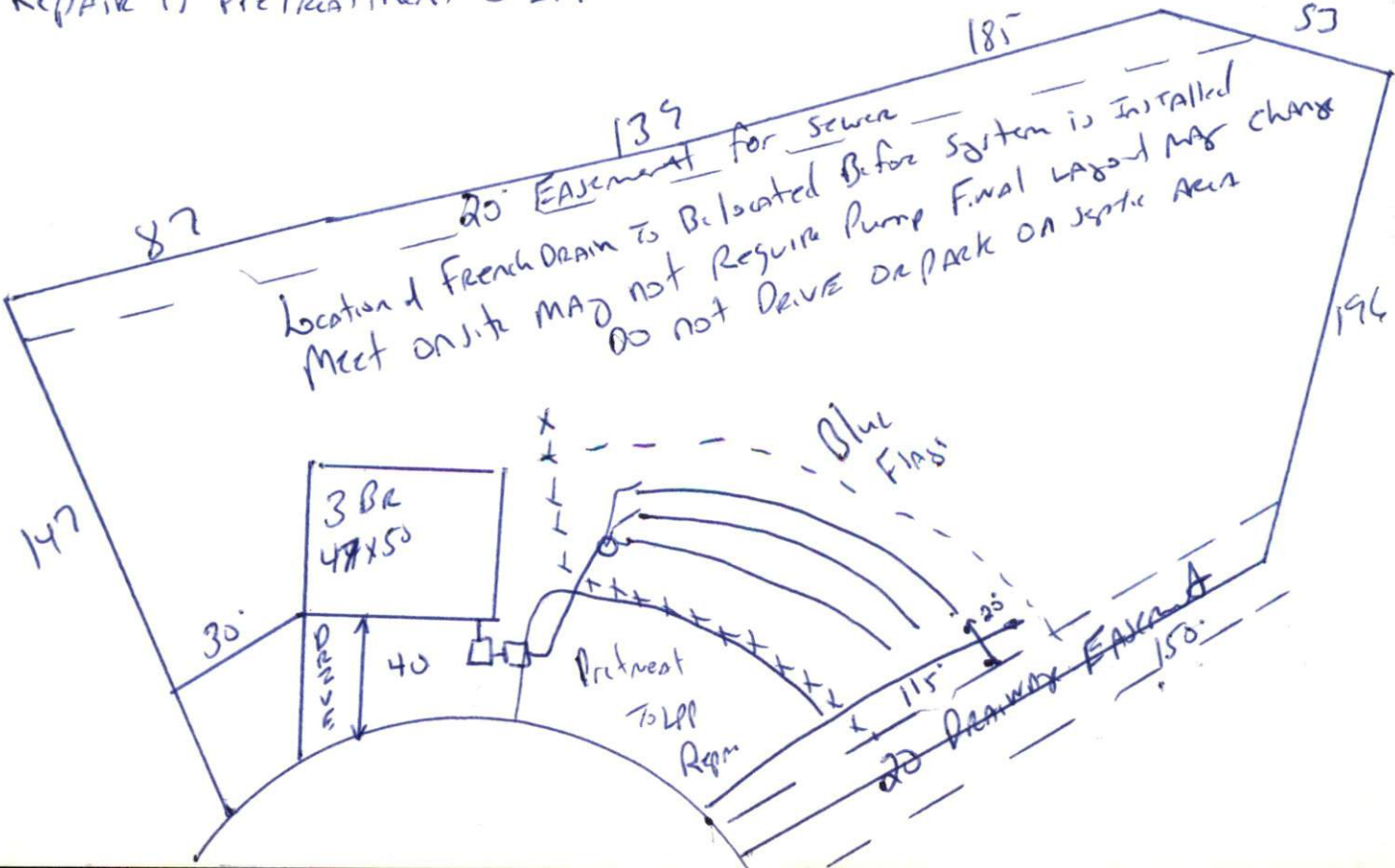

HARNETT COUNTY HEALTH DEPARTMENT
AUTHORIZATION TO CONSTRUCT

Authorization is hereby given to construct a wastewater system to the specifications described by Harnett County Health Department, Improvement Permit # 19404. This authorization shall be valid for a period not to exceed five (5) years from the date of issuance. This authorization will be invalid if ownership, site plans, or intended use change.

Name Kent Pierce Telephone# 424-1294

Address _____

1115

Property Location SR# _____ Road Name _____

Peach Tree

109

3(4) x 50

1.14 ac

Subdivision _____ Lot # _____ # Bedrooms Proposed _____ Lot Size _____

TYPE OF SYSTEM

New Installation [] Repair [] Septic Tank [] Nitrification Lines

[] Conventional Other Pump to Ground

[] Basement [] With Plumbing [] Without Plumbing

Water Supply: [] Well Public Water Supply Minimum Well Setback: _____ Ft.

Septic Tank 1000 gal Pump Chamber 1000 gal

NITIRFICATION FIELD SPECIFICATIONS

Number of fields 1 # of lines per field 3 Length of lines 100 Ft.

Width of ditches 9 ft. Depth of ditches 18 inches

French Drain: Linear feet required 500 Depth of gravel 36"

No wastewater system shall be covered or placed into use by any person until an inspection by the Harnett County Health Department has determined that the system has been installed according to the conditions of the Improvement Permit and that a valid Operations Permit has been issued.

Signature of Authorized Agent for Harnett County of Harnett [Signature] Date 5-22-03