

NORTH CAROLINA HARNETT COUNTY
[Mickey R.Bennett.PLS do certify that this plat was drawn under
my supervision(deed description recorded in Book(see ref),Page
Page(ref),and that boundaries not surveyed are clear
indicated as drawn from information found in Book(see ref),Page
(see ref),that the ratio of precision as calculated is 1:10000.
Witness my original signature,registration number and seal this
23rd day of April,2025 A.D.

Mickey R.Bennett PLS

MICKEY R.BENNETT
L - 1514



I MICKEY R. BENNETT PLS CERTIFY
That this survey is of and existing parcel
or parcels of land or one or more existing
subdivisions and does not create a new street
or change an existing street.

9

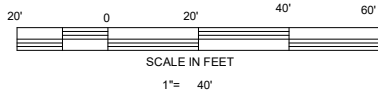

PROPOSED IMPREVIOUS AREA = 2900 SF+-

MINIMUM BUILDING SETBACKS

RA-30

FRONT --- 35'FROM R/W

REAR --- 25'

SIDE --- 10'

CORNER LOT SIDE - 20'

MAXIMUM HEIGHT - 35'

MAXIMUM IMPREVIOUS AREA PER LOT - 5000 SF

DEED REFERENCE DEED BOOK 4231,PAGE 1889
MAP REFERENCE PLAT BOOK 2025,PAGE 176

DISCLAIMER

ALL INFORMATION SHOWN ON THIS MAP WAS TAKEN FROM
RECORDED DEEDS,PLATS AND OTHER PUBLIC INFORMATION.
BENNETT SURVEYS HAS NOT PERFORMED ANY SURVEY IN
PREPARING THIS PLAT AS OF DATE SHOWN.

OWNER: GREGORY INC.
62 E MCIVERY STREET
ANGIER, NC
27501-5891

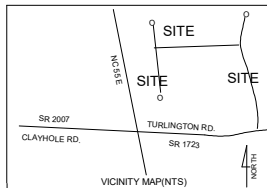

VERBENA POINT
50'PUBLIC R/W

NO FIELD SURVEY WAS PERFORMED IN .
PREPARING THIS PLAT
PROPOSED PLOT PLAN
BEEBALM RUN, DUNN,NC 28334

ALTON FIELDS SUBDIVISION.

LOT - 8

GROVE TOWNSHIP		HARNETT COUNTY	
STATE: NORTH CAROLINA		DATE: APRIL 23,2025	
ZONE RA-30	PIN 1509-12-3233.000	PID 071509 0037 18	

BENNETT SURVEYS F-1304

1662 CLARK ROAD LILLINGTON, NC 27546 910-893-5252

SCALE: 1"= 40'			DRAWING NO.
	DRAWN BY:	MRB	
CHECKED BY:			25146

CURVE	RADIUS	LENGTH	CHORD	CH.BEARING
C14	50.00'	42.37'	41.11'	S 00°45'57"E
C15	25.00'	18.43'	18.02'	S 03°55'04"E
C16	258.00'	29.99'	29.97'	S 13°52'28"W
C17	25.00'	35.08'	32.27'	S 50°45'02"W