

I, MICHAEL P. GRIFFIN, certify that under my direction and supervision this map was drawn from an actual field survey; that the error of closure of the survey as calculated by coordinates is 1: 10,000+; that the area shown hereon was calculated by coordinates.

Witness my hand and seal this day of MONTH 2024.

BK 2024 PGS 217-218  
HARNETT CO. REGISTRY

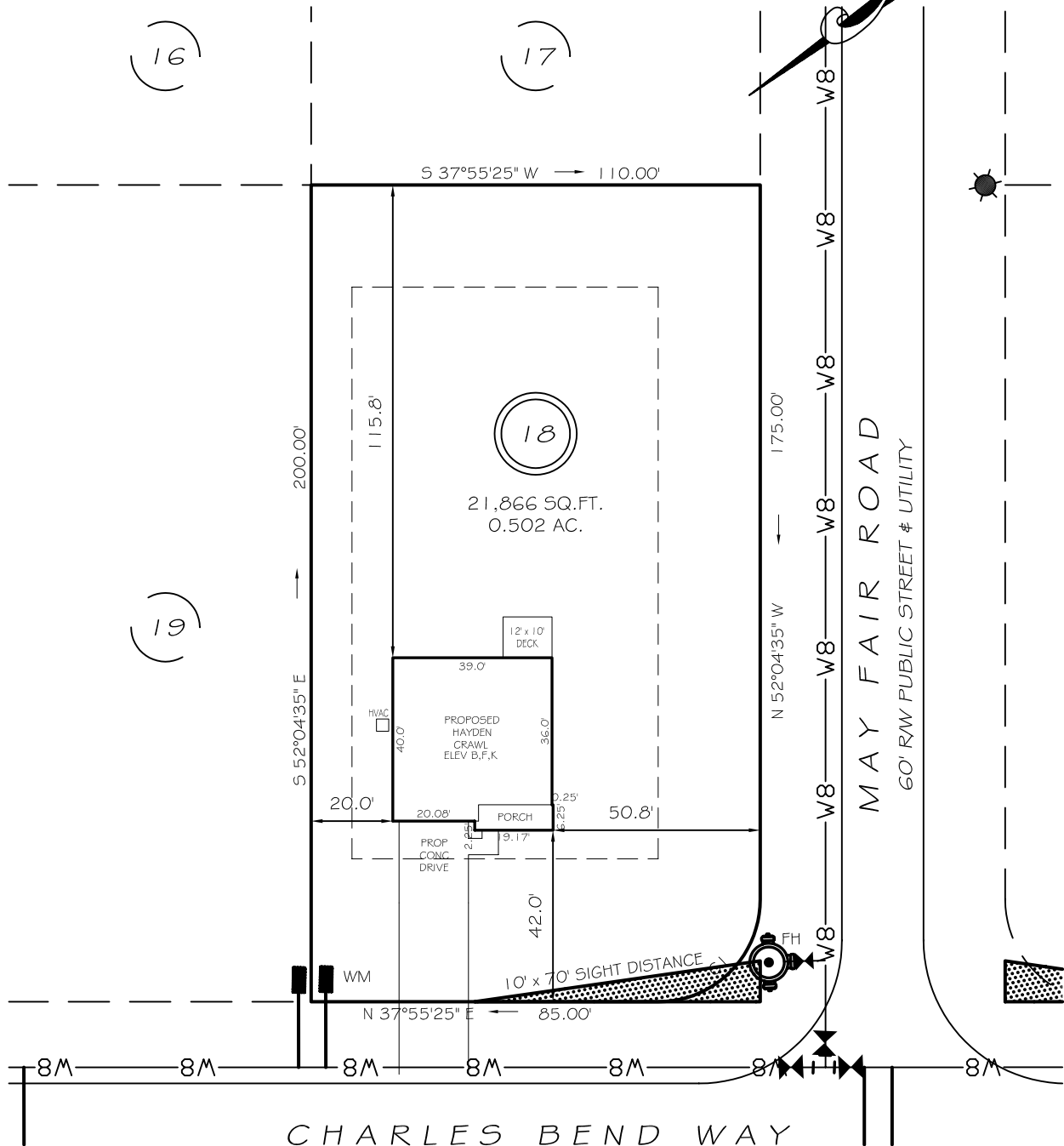

IMPERVIOUS AREAS

60' RW PUBLIC STREET & UTILITY

HOUSE	1,604 SQ. FT.
DRIVE & WALKS	1,130 SQ. FT.
HVAC	9 SQ. FT.
TOTAL	2,743 SQ. FT.
ALLOWED	5,000 SQ. FT.

THE MAXIMUM ALLOWABLE BUILT-UPON AREA PER LOT IS 5,000 SQUARE FEET. THIS ALLOTTED AMOUNT INCLUDES ANY BUILT-UPON AREA CONSTRUCTED WITHIN THE LOT PROPERTY BOUNDARIES, AND THAT PORTION OF THE RIGHT-OF-WAY BETWEEN THE FRONT LOT LINE AND THE EDGE OF PAVEMENT. PER STATE STORMWATER MANAGEMENT PERMIT NUMBER SW6211101.

CI R=25.00' L=39.27' S07°04'35"E 35.36'

LEGEND

EIP	EXISTING IRON PIPE	FES	FLARED END SECTION
ISS	IRON STAKE SET	WM	WATER METER
R/W	RIGHT OF WAY	CO	CLEAN OUT
N/F	NOW OR FORMERLY	FH	FIRE HYDRANT
EIS	EXISTING IRON STAKE	LP	LIGHT POLE

ZONING RA-20R  
SETBACKS

FRONT	35'
REAR	25'
SIDE	10'
CORNER SIDE	20'

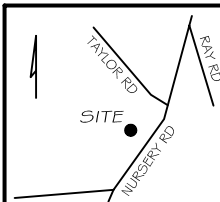

**P R E L I M I N A R Y**  
NOT FOR RECORDATION,  
SALES OR CONVEYANCE



GRIFFIN LAND SURVEYING, INC.

P. O. BOX 148  
FUQUAY-VARINA, NC 27526  
(919) - 567 - 1963

PLOT PLAN  
FOR

**D. R. HORTON**

MASON RIDGE SUBDIVISION

LOT 18

CHARLES BEND WAY

SPRING LAKE, N.C.

HARNETT COUNTY ANDERSON CREEK TOWNSHIP

DRAWN BY **KDF**

DATE **6/14/24**

CHECKED BY **MPG**

SCALE **1" = 40'**