



TYNDALL
ENGINEERING & DESIGN, P.A.

T 919 773-1200 • F 919 773-9658
250 Shipwash Drive, Suite 104 • Garner • North Carolina • 27529
www.tyndallengineering.com

November 25, 2025

A&G Residential
Jamie Goodwin
916 Arsenal Avenue | Suite B
Fayetteville, NC 28305
Ph: 910-237-7944
Email: jamie@agresidentialnc.com

Reference: Engineering Services
The Havilland
Project No.: DRB2301-0091_E

As requested by the client, a representative of Tyndall Engineering & Design, PA (TE&D) has reviewed the following item(s):

- 1) Rear porch deck option.

The following conclusions and recommendations were noted:

- 1) Please refer to the drawing on page 2 of this report.

We appreciate being able to assist you during this phase of the project. If you need further assistance or require additional information, please do not hesitate to contact us.

Sincerely,
Tyndall Engineering & Design

Alex Moore, PE
AM/ DRB2301-0091_E

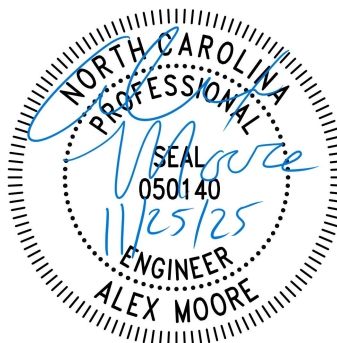

SECURE PT 6" X 6" POST TO 20" X 20" X 10"
CONC. FTG. W/ SIMP. ABU66Z W/ 5/8" DIA.
ANCHOR BOLTS W/ 6" MIN. EMBED., TYP.

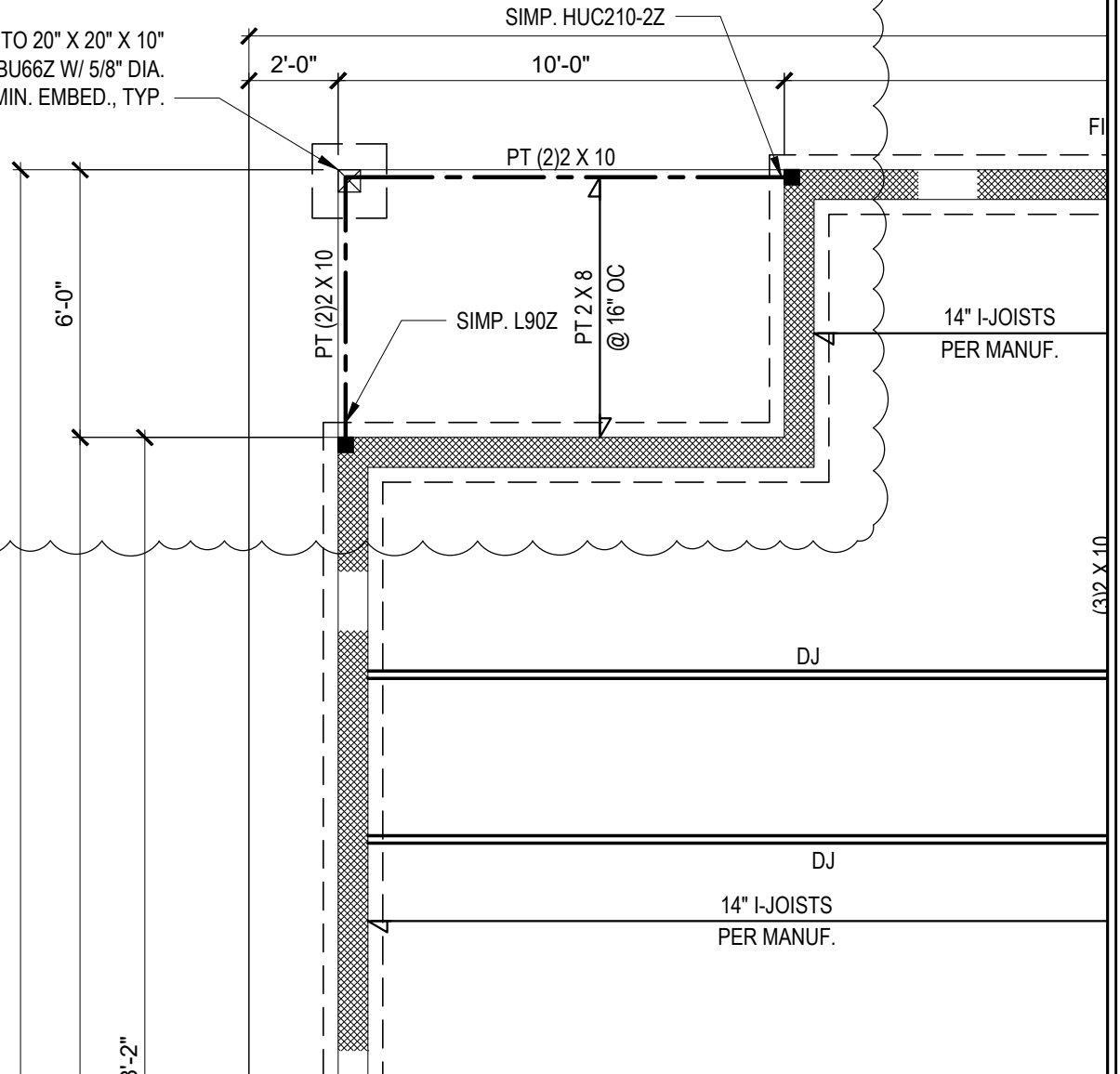

TYNDALL
ENGINEERING & DESIGN, P.A.

T 919 773-1200 • F 919 773-0838
200 Shipman Drive • Garner • North Carolina • 27529
www.tyndallengineering.com

4			
3			
2			
1			
NO.	DATE	REVISIONS AND RECORD OF ISSUE	CHK.

DRAWN: AM	CHECKED: AM	DATE: 11/25/25	PROJECT #: DRB2301-0091
--------------	----------------	-------------------	----------------------------

PROJECT: THE HAVILLAND	DRAWING NUMBER: 2 of 2	REV. E
------------------------	---------------------------	-----------

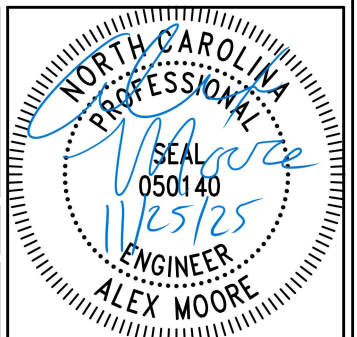

CLIENT: A&G RESIDENTIAL