



## RoofDropped Beams\BM2(i59) (Dropped Beam)

BC Design Engine Member Report

Dry | 2 spans | No cant.

November 12, 2025 15:25:28

Build 8898

Job name:

File name: 250604731716.mmdl

Address:

Description: RoofDropped Beams\BM2(i59)

City, State, Zip:

Specifier:

Customer:

Designer: [Designer Alias]

Code reports: ESR-1040

Company:

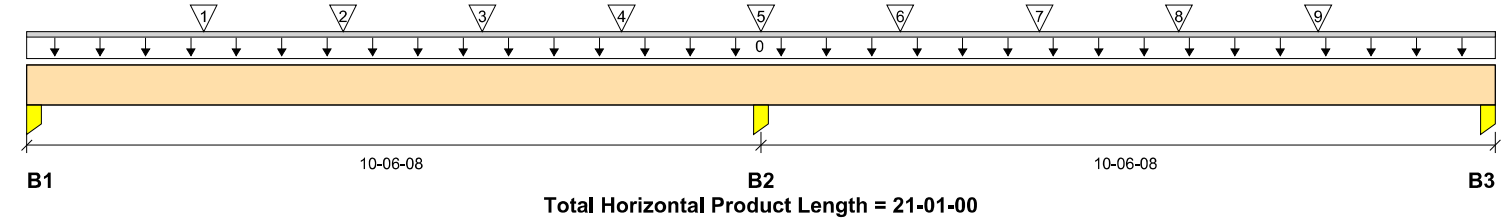

### Reaction Summary (Down / Uplift) (lbs)

Bearing	Live	Dead	Snow	Wind	Roof Live
B1, 3-3/4"		165 / 0	48 / 0	80 / 210	179 / 30
B2, 5-7/16"		622 / 0	172 / 0	139 / 840	597 / 0
B3, 3-3/4"		165 / 0	48 / 0	80 / 210	179 / 30

### Load Summary

Tag	Description	Load Type	Ref.	Start	End	Loc.	Live	Dead	Snow	Wind	Roof Live	Tributary
							100%	90%	115%	160%	125%	
0	Self-Weight	Unf. Lin. (lb/ft)	L	00-00-00	21-01-00	Top		9				00-00-00
1	B1E(c01)	Conc. Pt. (lbs)	L	02-06-08	02-06-08	Top		111	37		124	n/a
2	B1E(c01)	Conc. Pt. (lbs)	L	04-06-08	04-06-08	Top		71	26		99	n/a
3	B1E(c01)	Conc. Pt. (lbs)	L	06-06-08	06-06-08	Top		84	30		97	n/a
4	B1E(c01)	Conc. Pt. (lbs)	L	08-06-08	08-06-08	Top		80	28		90	n/a
5	B1E(c01)	Conc. Pt. (lbs)	L	10-06-08	10-06-08	Top		62	17		76	n/a
6	B1E(c01)	Conc. Pt. (lbs)	L	12-06-08	12-06-08	Top		80	28		90	n/a
7	B1E(c01)	Conc. Pt. (lbs)	L	14-06-08	14-06-08	Top		84	30		97	n/a
8	B1E(c01)	Conc. Pt. (lbs)	L	16-06-08	16-06-08	Top		71	26		99	n/a
9	B1E(c01)	Conc. Pt. (lbs)	L	18-06-08	18-06-08	Top		111	37		124	n/a

### Controls Summary

	Value	% Allowable	Duration	Case	Location
Pos. Moment	910 ft-lbs	14.8%	125%	3	16-06-08
Neg. Moment	-944 ft-lbs	15.3%	125%	3	10-06-08
End Shear	334 lbs	4.3%	125%	2	01-01-00
Cont. Shear	531 lbs	6.9%	125%	1	11-06-07
Total Load Deflection	L/999 (0.034")	n/a	n/a	3	16-02-00
Live Load Deflection	L/999 (0.02")	n/a	n/a	445	16-00-08
Total Neg. Defl.	L/999 (-0.002")	n/a	n/a	169	08-11-00
Max Defl.	0.034"	n/a	n/a	3	16-02-00
Span / Depth	13.4				

### Bearing Supports

		Dim. (LxW)	Value	% Allow Support	% Allow Member	Material
B1	Column	3-3/4" x 3-1/2"	344 lbs	3.6%	3.5%	Unspecified
B2	Column	5-7/16" x 3-1/2"	1219 lbs	8.8%	8.5%	Unspecified
B2	Uplift		131 lbs			
B3	Column	3-3/4" x 3-1/2"	344 lbs	3.6%	3.5%	Unspecified

### Cautions

Uplift of -131 lbs found at bearing B2.

Member is not fully supported at post B1. A connector is required at this bearing.

Member is not fully supported at post B2. A connector is required at this bearing.

Member is not fully supported at post B3. A connector is required at this bearing.

**Roof\Dropped Beams\BM2(i59) (Dropped Beam)**

BC Design Engine Member Report

Dry | 2 spans | No cant.

November 12, 2025 15:25:28

Build 8898

Job name:

File name: 250604731716.mmdl

Address:

Description: Roof\Dropped Beams\BM2(i59)

City, State, Zip:

Specifier:

Customer:

Designer: [Designer Alias]

Code reports: ESR-1040

Company:

## Notes

Design meets User specified (L/360) Total load deflection criteria.

Design meets User specified (L/480) Live load deflection criteria.

Design meets arbitrary (1") Maximum Total load deflection criteria.

Design meets arbitrary (0.75") Maximum live load deflection criteria.

Wind loads determined from building geometry were used in selected product's verification.

Unbalanced snow loads determined from building geometry were used in selected product's verification.

Design based on Dry Service Condition.

BC CALC® analysis is based on IBC 2021.

Calculations assume unbraced length of Top: 21-01-00, Bottom: 21-01-00.

Bearing length at bearing(s) B2 was calculated based on the actual bearing area divided by the supported member width and may not match expected value when bearing is not rectangular or when the supported member is not supported by its full width.

One or more plies are not properly supported at bearing(s) B2. Verify with structural engineer or EWP manufacturer if this condition is acceptable.

## Connection Diagram: Full Length of Member

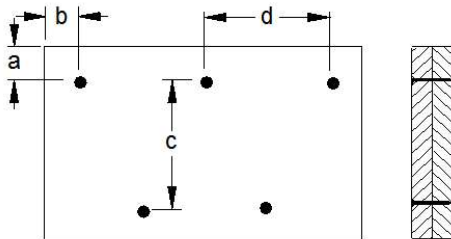

a minimum = 2"

c = 5-1/4"

b minimum = 3"

d = 24"

Calculated Side Load = 0.0 lb/ft

Connectors are: 3-1/4 in. Pneumatic Gun Nails

## Disclosure

Use of the Boise Cascade Software is subject to the terms of the End User License Agreement (EULA). Completeness and accuracy of input must be reviewed and verified by a qualified engineer or other appropriate expert to assure its adequacy, prior to anyone relying on such output as evidence of suitability for a particular application. The output here is based on building code-accepted design properties and analysis methods. Installation of Boise Cascade engineered wood products must be in accordance with current Installation Guide and applicable building codes. To obtain Installation Guide or ask questions, please call (800)232-0788 before installation.

BC CALC®, BC FRAMER®, AJS™, ALLJOIST®, BC RIM BOARD™, BCI®, BOISE GLULAM™, BC FloorValue®, VERSA-LAM®, VERSA-RIM PLUS®,

**Roof/Dropped Beams\GDH(i67) (Dropped Beam)**

BC Design Engine Member Report

Dry | 1 span | No cant.

November 12, 2025 15:25:28

Build 8898

Job name:

File name: 250604731716.mmdl

Address:

Description: Roof/Dropped Beams\GDH(i67)

City, State, Zip:

Specifier:

Customer:

Designer: [Designer Alias]

Code reports: ESR-1040

Company:

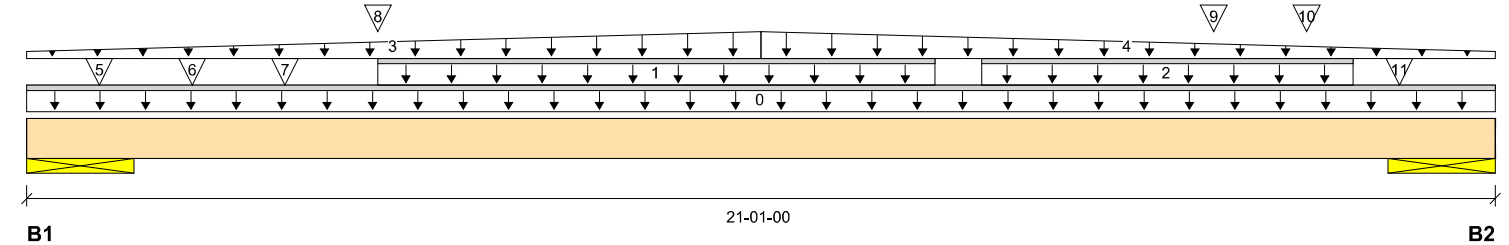

Total Horizontal Product Length = 21-01-00

**Reaction Summary (Down / Uplift) (lbs)**

Bearing	Live	Dead	Snow	Wind	Roof Live
B1, 18-1/2"	343 / 0	2842 / 0			
B2, 18-1/2"	338 / 0	2837 / 0			

**Load Summary**

Tag	Description	Load Type	Ref.	Start	End	Loc.	Live	Dead	Snow	Wind	Roof Live	Tributary
							100%	90%	115%	160%	125%	
0	Self-Weight	Unf. Lin. (lb/ft)	L	00-00-00	21-01-00	Top		36				00-00-00
1	Smoothed Load	Unf. Lin. (lb/ft)	L	05-00-08	13-00-08	Top	34	24				n/a
2	Smoothed Load	Unf. Lin. (lb/ft)	L	13-08-08	19-00-08	Top	34					n/a
3	User Load	Trapezoidal (lb/ft)	L	00-00-00	10-06-08	Top		80				n/a
4	User Load	Trapezoidal (lb/ft)	L	10-06-08	21-01-00	Top		310				n/a
5	F1L(c01)	Conc. Pt. (lbs)	L	01-00-08	01-00-08	Top	40					n/a
6	F1L(c01)	Conc. Pt. (lbs)	L	02-04-08	02-04-08	Top	45					n/a
7	F1L(c01)	Conc. Pt. (lbs)	L	03-08-08	03-08-08	Top	46	186				n/a
8	F1L(c01)	Conc. Pt. (lbs)	L	05-00-08	05-00-08	Top	46					n/a
9	F1L(c01)	Conc. Pt. (lbs)	L	17-00-08	17-00-08	Top		162				n/a
10	F1L(c01)	Conc. Pt. (lbs)	L	18-04-08	18-04-08	Top		83				n/a
11	F1L(c01)	Conc. Pt. (lbs)	L	19-08-08	19-08-08	Top	45					n/a

**Controls Summary**

	Value	% Allowable	Duration	Case	Location
Pos. Moment	14285 ft-lbs	93.0%	100%	1	10-04-08
End Shear	2513 lbs	11.7%	90%	0	03-06-08
Total Load Deflection	L/999 (0.078")	n/a	n/a	1	10-06-08
Live Load Deflection	L/999 (0.008")	n/a	n/a	2	10-06-08
Max Defl.	0.078"	n/a	n/a	1	10-06-08
Span / Depth	9.1				
Dist. Load (B1)	113.64 lb/ft	1.8%	90%		
Dist. Load (B2)	113.64 lb/ft	1.8%	90%		
Conc. Load (B1)	71 lbs	0.7%	100%		
Conc. Load (B2)	69 lbs	0.6%	100%		

**Bearing Supports**

	Dim. (LxW)	Value	% Allow Support	% Allow Member	Material
B1	Wall/Plate 18-1/2" x 5-1/4"	3186 lbs	7.7%	4.4%	Spruce-Pine-Fir
B2	Wall/Plate 18-1/2" x 5-1/4"	3174 lbs	7.7%	4.4%	Spruce-Pine-Fir

Roof/Dropped Beams\GDH(i67) (Dropped Beam)

BC Design Engine Member Report

Dry | 1 span | No cant.

November 12, 2025 15:25:28

Build 8898

Job name:

File name: 250604731716.mmdl

Address:

Description: Roof/Dropped Beams\GDH(i67)

City, State, Zip:

Specifier:

Customer:

Designer: [Designer Alias]

Code reports: ESR-1040

Company:

## Notes

Design meets User specified (L/360) Total load deflection criteria.

Design meets User specified (L/480) Live load deflection criteria.

Design meets arbitrary (1") Maximum Total load deflection criteria.

Design meets arbitrary (0.75") Maximum live load deflection criteria.

Design based on Dry Service Condition.

BC CALC® analysis is based on IBC 2021.

Calculations assume unbraced length of Top: 21-01-00, Bottom: 21-01-00.

## Connection Diagram: Full Length of Member

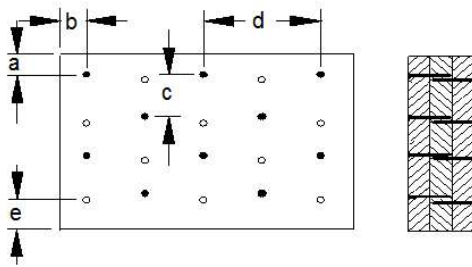

a minimum = 2"

c = 6-3/8"

b minimum = 3"

d = 24"

e minimum = 3"

Calculated Side Load = 0.0 lb/ft

Nailing applies to both sides of the member.

Connectors are: 3-1/4 in. Pneumatic Gun Nails

## Disclosure

Use of the Boise Cascade Software is subject to the terms of the End User License Agreement (EULA). Completeness and accuracy of input must be reviewed and verified by a qualified engineer or other appropriate expert to assure its adequacy, prior to anyone relying on such output as evidence of suitability for a particular application. The output here is based on building code-accepted design properties and analysis methods. Installation of Boise Cascade engineered wood products must be in accordance with current Installation Guide and applicable building codes. To obtain Installation Guide or ask questions, please call (800)232-0788 before installation.

BC CALC®, BC FRAMER®, AJS™, ALLJOIST®, BC RIM BOARD™, BCI®, BOISE GLULAM™, BC FloorValue®, VERSA-LAM®, VERSA-RIM PLUS®,



## Roof\Flush Beams\BM1(i58) (Flush Beam)

BC Design Engine Member Report

Dry | 1 span | No cant.

November 12, 2025 15:25:28

Build 8898

Job name:

File name: 250604731716.mmdl

Address:

Description: Roof\Flush Beams\BM1(i58)

City, State, Zip:

Specifier:

Customer:

Designer: [Designer Alias]

Code reports: ESR-1040

Company:

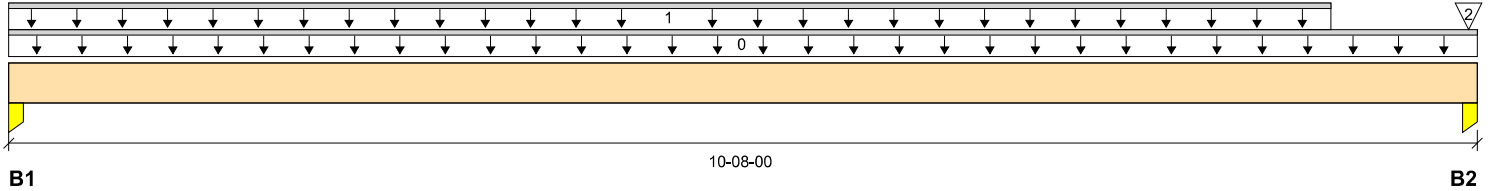

Total Horizontal Product Length = 10-08-00

## Reaction Summary (Down / Uplift) (lbs)

Bearing	Live	Dead	Snow	Wind	Roof Live
B1, 7-1/4"		1369 / 0	479 / 0	561 / 1763	1387 / 0
B2, 7-1/4"		1096 / 0	391 / 0	465 / 1504	1129 / 0

## Load Summary

Tag	Description	Load Type	Ref.	Start	End	Loc.	100%	90%	115%	160%	Roof Live 125%	Tributary
0	Self-Weight	Unf. Lin. (lb/ft)	L	00-00-00	10-08-00	Top		9				00-00-00
1	Smoothed Load	Unf. Lin. (lb/ft)	L	00-00-00	09-07-04	Top		237	86		249	n/a
2	B1E(c01)	Conc. Pt. (lbs)	L	10-07-04	10-07-04	Top		85	42		121	n/a

## Controls Summary

	Value	% Allowable	Duration	Case	Location
Pos. Moment	5386 ft-lbs	33.1%	125%	1	04-07-04
Neg. Moment	-443 ft-lbs	3.4%	160%	261	04-07-04
End Shear	2006 lbs	26.1%	125%	1	09-03-08
Total Load Deflection	L/573 (0.201")	62.8%	n/a	1	05-04-04
Live Load Deflection	L/999 (0.101")	n/a	n/a	263	05-04-04
Max Defl.	0.201"	20.1%	n/a	1	05-04-04
Span / Depth	12.4				

## Bearing Supports

	Dim. (LxW)	Value	% Allow Support	% Allow Member	Material
B1 Column	7-1/4" x 3-1/2"	2756 lbs	15.0%	14.5%	Unspecified
B1 Uplift		237 lbs			
B2 Column	7-1/4" x 3-1/2"	2225 lbs	12.1%	11.7%	Unspecified
B2 Uplift		245 lbs			

## Cautions

Uplift of -245 lbs found at bearing B2.

Member is not fully supported at post B1. A connector is required at this bearing.

Member is not fully supported at post B2. A connector is required at this bearing.

## Notes

Design meets User specified (L/360) Total load deflection criteria.

Design meets User specified (L/480) Live load deflection criteria.

Design meets arbitrary (1") Maximum Total load deflection criteria.

Design meets arbitrary (0.75") Maximum live load deflection criteria.

Wind loads determined from building geometry were used in selected product's verification.

Unbalanced snow loads determined from building geometry were used in selected product's verification.

Design based on Dry Service Condition.

BC CALC® analysis is based on IBC 2021.

Calculations assume unbraced length of Top: 01-10-08, Bottom: 10-04-08.



Roof\Flush Beams\BM1(i58) (Flush Beam)

BC Design Engine Member Report

Dry | 1 span | No cant.

November 12, 2025 15:25:28

Build 8898

Job name:

File name: 250604731716.mmdl

Address:

Description: Roof\Flush Beams\BM1(i58)

City, State, Zip:

Specifier:

Customer:

Designer: [Designer Alias]

Code reports: ESR-1040

Company:

Connection Diagram: Full Length of Member

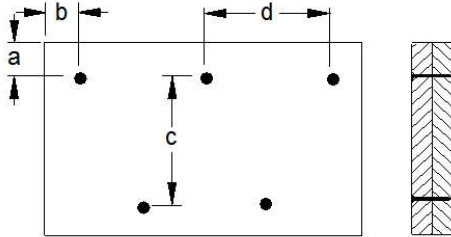

a minimum = 2"

c = 5-1/4"

b minimum = 3"

d = 24"

Calculated Side Load = 0.0 lb/ft

Connectors are: 3-1/4 in. Pneumatic Gun Nails

Disclosure

Use of the Boise Cascade Software is subject to the terms of the End User License Agreement (EULA). Completeness and accuracy of input must be reviewed and verified by a qualified engineer or other appropriate expert to assure its adequacy, prior to anyone relying on such output as evidence of suitability for a particular application. The output here is based on building code-accepted design properties and analysis methods. Installation of Boise Cascade engineered wood products must be in accordance with current Installation Guide and applicable building codes. To obtain Installation Guide or ask questions, please call (800)232-0788 before installation.

BC CALC®, BC FRAMER®, AJS™, ALLJOIST®, BC RIM BOARD™, BCI®, BOISE GLULAM™, BC FloorValue®, VERSA-LAM®, VERSA-RIM PLUS®,



## Roof\Flush Beams\BM3(i60) (Flush Beam)

BC Design Engine Member Report

Dry | 1 span | No cant.

November 12, 2025 15:25:28

Build 8898

Job name:

File name: 250604731716.mmdl

Address:

Description: Roof\Flush Beams\BM3(i60)

City, State, Zip:

Specifier:

Customer:

Designer: [Designer Alias]

Code reports: ESR-1040

Company:

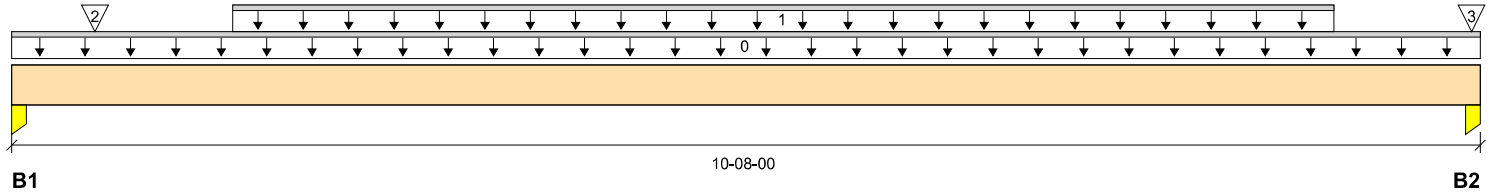

### Reaction Summary (Down / Uplift) (lbs)

Bearing	Live	Dead	Snow	Wind	Roof Live
B1, 7-1/4"		1394 / 0	497 / 0	588 / 1829	1437 / 0
B2, 7-1/4"		1096 / 0	391 / 0	465 / 1504	1129 / 0

### Load Summary

Tag	Description	Load Type	Ref.	Start	End	Loc.	100%	90%	115%	160%	Roof Live 125%	Tributary
0	Self-Weight	Unf. Lin. (lb/ft)	L	00-00-00	10-08-00	Top		9				00-00-00
1	Smoothed Load	Unf. Lin. (lb/ft)	L	01-07-04	09-07-04	Top		228	83		239	n/a
2	B1(c05)	Conc. Pt. (lbs)	L	00-07-04	00-07-04	Top		485	186		537	n/a
3	B1E(c01)	Conc. Pt. (lbs)	L	10-07-04	10-07-04	Top		85	42		121	n/a

### Controls Summary

	Value	% Allowable	Duration	Case	Location
Pos. Moment	5386 ft-lbs	33.1%	125%	1	04-07-04
Neg. Moment	-443 ft-lbs	3.4%	160%	261	04-07-04
End Shear	2006 lbs	26.1%	125%	1	09-03-08
Total Load Deflection	L/573 (0.201")	62.8%	n/a	1	05-04-04
Live Load Deflection	L/999 (0.101")	n/a	n/a	263	05-04-04
Max Defl.	0.201"	20.1%	n/a	1	05-04-04
Span / Depth	12.4				

### Bearing Supports

Bearing Supports		Dim. (LxW)	Value	% Allow Support	% Allow Member	Material
B1	Column	7-1/4" x 3-1/2"	2831 lbs	15.4%	14.9%	Unspecified
B1	Uplift		261 lbs			
B2	Column	7-1/4" x 3-1/2"	2225 lbs	12.1%	11.7%	Unspecified
B2	Uplift		245 lbs			

### Cautions

Uplift of -261 lbs found at bearing B1.

Member is not fully supported at post B1. A connector is required at this bearing.

Member is not fully supported at post B2. A connector is required at this bearing.

**Roof\Flush Beams\BM3(i60) (Flush Beam)**

BC Design Engine Member Report

Dry | 1 span | No cant.

November 12, 2025 15:25:28

Build 8898

Job name:

File name: 250604731716.mmdl

Address:

Description: Roof\Flush Beams\BM3(i60)

City, State, Zip:

Specifier:

Customer:

Designer: [Designer Alias]

Code reports: ESR-1040

Company:

## Notes

Design meets User specified (L/360) Total load deflection criteria.

Design meets User specified (L/480) Live load deflection criteria.

Design meets arbitrary (1") Maximum Total load deflection criteria.

Design meets arbitrary (0.75") Maximum live load deflection criteria.

Wind loads determined from building geometry were used in selected product's verification.

Unbalanced snow loads determined from building geometry were used in selected product's verification.

Design based on Dry Service Condition.

BC CALC® analysis is based on IBC 2021.

Calculations assume unbraced length of Top: 01-10-08, Bottom: 10-04-08.

## Connection Diagram: Full Length of Member

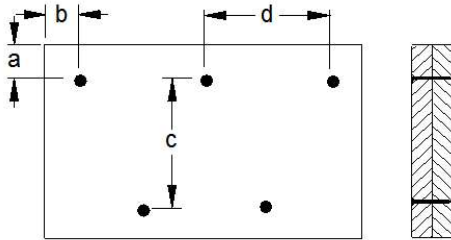

a minimum = 2"

c = 5-1/4"

b minimum = 3"

d = 24"

Calculated Side Load = 0.0 lb/ft

Connectors are: 3-1/4 in. Pneumatic Gun Nails

## Disclosure

Use of the Boise Cascade Software is subject to the terms of the End User License Agreement (EULA). Completeness and accuracy of input must be reviewed and verified by a qualified engineer or other appropriate expert to assure its adequacy, prior to anyone relying on such output as evidence of suitability for a particular application. The output here is based on building code-accepted design properties and analysis methods. Installation of Boise Cascade engineered wood products must be in accordance with current Installation Guide and applicable building codes. To obtain Installation Guide or ask questions, please call (800)232-0788 before installation.

BC CALC®, BC FRAMER®, AJS™, ALLJOIST®, BC RIM BOARD™, BCI®, BOISE GLULAM™, BC FloorValue®, VERSA-LAM®, VERSA-RIM PLUS®,



## Roof\Flush Beams\FB1(i69) (Flush Beam)

BC Design Engine Member Report

Dry | 1 span | No cant.

November 12, 2025 15:25:28

Build 8898

Job name:

File name: 250604731716.mmdl

Address:

Description: Roof\Flush Beams\FB1(i69)

City, State, Zip:

Specifier:

Customer:

Designer: [Designer Alias]

Code reports: ESR-1040

Company:

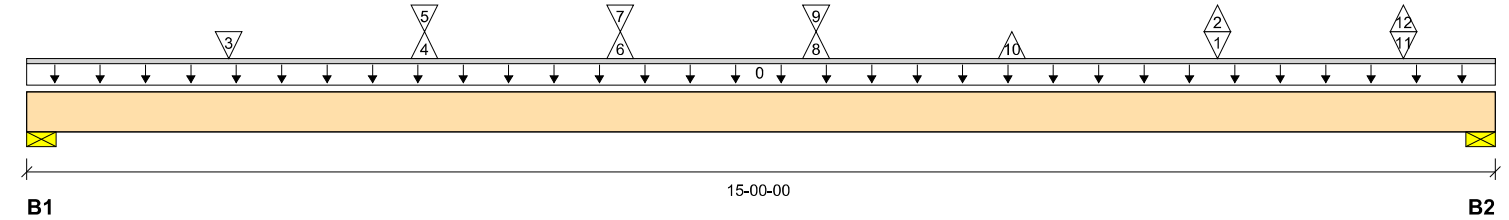

Total Horizontal Product Length = 15-00-00

### Reaction Summary (Down / Uplift) (lbs)

Bearing	Live	Dead	Snow	Wind	Roof Live
B1, 3-1/2"	85 / 0	276 / 0	16 / 31	118 / 94	98 / 129
B2, 3-1/2"	394 / 0	864 / 0	39 / 32	110 / 137	198 / 156

### Load Summary

Tag	Description	Load Type	Ref.	Start	End	Loc.	Live	Dead	Snow	Wind	Roof Live	Tributary
							100%	90%	115%	160%	125%	
0	Self-Weight	Unf. Lin. (lb/ft)	L	00-00-00	15-00-00	Top		16				00-00-00
1	-	Conc. Pt. (lbs)	L	12-01-15	12-01-15	Front	479	596	3		68	n/a
2	-	Conc. Pt. (lbs)	L	12-01-15	12-01-15	Front					-52	n/a
3	A10(c01)	Conc. Pt. (lbs)	L	02-00-12	02-00-12	Back		62	16		52	n/a
4	A11(c04)	Conc. Pt. (lbs)	L	04-00-12	04-00-12	Back		-5	-11		-55	n/a
5	A11(c04)	Conc. Pt. (lbs)	L	04-00-12	04-00-12	Back					27	n/a
6	A11(c03)	Conc. Pt. (lbs)	L	06-00-12	06-00-12	Back		-9	-14		-55	n/a
7	A11(c03)	Conc. Pt. (lbs)	L	06-00-12	06-00-12	Back					19	n/a
8	A11(c02)	Conc. Pt. (lbs)	L	08-00-12	08-00-12	Back		-15	-18		-55	n/a
9	A11(c02)	Conc. Pt. (lbs)	L	08-00-12	08-00-12	Back					5	n/a
10	A11(c01)	Conc. Pt. (lbs)	L	10-00-12	10-00-12	Back		-18	-20		-58	n/a
11	A13(c01)	Conc. Pt. (lbs)	L	14-00-12	14-00-12	Back		285	36		124	n/a
12	A13(c01)	Conc. Pt. (lbs)	L	14-00-12	14-00-12	Back					-8	n/a

### Controls Summary

	Value	% Allowable	Duration	Case	Location
Pos. Moment	2658 ft-lbs	18.7%	100%	1	12-00-12
End Shear	1084 lbs	10.2%	100%	1	13-04-08
Total Load Deflection	L/999 (0.04")	n/a	n/a	146	08-03-12
Live Load Deflection	L/999 (0.019")	n/a	n/a	1371	08-00-12
Max Defl.	0.04"	n/a	n/a	146	08-03-12
Span / Depth	10.9				

### Bearing Supports

	Dim. (LxW)	Value	% Allow Support	% Allow Member	Material
B1	Wall/Plate 3-1/2" x 3-1/2"	466 lbs	6.7%	5.1%	Southern Pine
B2	Wall/Plate 3-1/2" x 3-1/2"	1357 lbs	15.3%	14.8%	Unspecified

## Roof\Flush Beams\FB1(i69) (Flush Beam)

BC Design Engine Member Report

Dry | 1 span | No cant.

November 12, 2025 15:25:28

Build 8898

Job name:

File name: 250604731716.mmdl

Address:

Description: Roof\Flush Beams\FB1(i69)

City, State, Zip:

Specifier:

Customer:

Designer: [Designer Alias]

Code reports: ESR-1040

Company:

### Notes

Design meets User specified (L/360) Total load deflection criteria.

Design meets User specified (L/480) Live load deflection criteria.

Design meets arbitrary (1") Maximum Total load deflection criteria.

Design meets arbitrary (0.75") Maximum live load deflection criteria.

Wind loads determined from building geometry were used in selected product's verification.

Unbalanced snow loads determined from building geometry were used in selected product's verification.

Design based on Dry Service Condition.

BC CALC® analysis is based on IBC 2021.

Calculations assume unbraced length of Top: 12-00-08, Bottom: 01-10-08.

### Connection Diagram: Full Length of Member

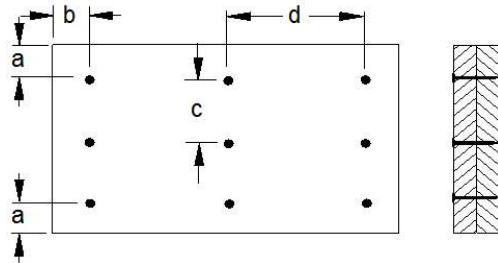

a minimum = 2"

c = 6"

b minimum = 3"

d = 12"

Calculated Side Load = 434.0 lb/ft

Connectors are: 3-1/4 in. Pneumatic Gun Nails

### Disclosure

Use of the Boise Cascade Software is subject to the terms of the End User License Agreement (EULA). Completeness and accuracy of input must be reviewed and verified by a qualified engineer or other appropriate expert to assure its adequacy, prior to anyone relying on such output as evidence of suitability for a particular application. The output here is based on building code-accepted design properties and analysis methods. Installation of Boise Cascade engineered wood products must be in accordance with current Installation Guide and applicable building codes. To obtain Installation Guide or ask questions, please call (800)232-0788 before installation.

BC CALC®, BC FRAMER®, AJS™, ALLJOIST®, BC RIM BOARD™, BCI®, BOISE GLULAM™, BC FloorValue®, VERSA-LAM®, VERSA-RIM PLUS®,