

AS-BUILT IMPROVEMENTS FOR
MATTAMY HOMES
452 PROVIDENCE CREEK DRIVE
LOT 152, PROVIDENCE CREEK PHASE 3B
HECTORS CREEK AND BLACK RIVER TOWNSHIP, HARNETT COUNTY, NORTH CAROLINA

RIVERSTONE SUBDIVISION
B.M. 2005, PGS. 1021-1022

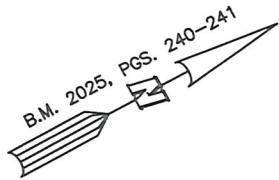

(10)

N 05°30'39" E 103.47'

15' PERIMETER BUFFER

(149)

(152)

16,496 S.F.
0.378 AC.

LEGEND

- AIR CONDITIONER
- BACK of CURB
- BACK FLOW PREVENTER
- CLEANOUT
- CURB INLET
- DRILL HOLE SET
- EXISTING CONCRETE MONUMENT
- EXISTING DRILL HOLE
- EXISTING IRON STAKE
- EXISTING IRON PIPE
- ELECTRIC METER
- EXISTING PK NAIL
- ELECTRIC STUB
- FLARED END SECTION
- FIRE HYDRANT
- FIBER OPTIC PEDESTAL
- GAS METER
- GUY
- INVERT
- IRON PIPE SET
- IRON ROD SET
- LIGHT POLE
- MAGNETIC NAIL SET
- MANHOLE SANITARY SEWER
- MANHOLE STORM SEWER
- OVERHEAD WIRES
- PK NAIL SET
- POINT NOT SET
- RAIL ROAD SPIKE
- TELEPHONE PEDESTAL
- CABLE TV PEDESTAL
- UTILITY POLE
- WATER METER
- WATER VALVE
- YARD INLET
- FIELD MEASUREMENT
- REVISION TRIANGLE

(153)

20' PUBLIC DRAINAGE EASEMENT
& OPEN SPACE ACCESS
N 65°02'46" W 177.58'

SETBACK LINES

S 58°24'56" E 217.69'

(151)

10'x12'
COV'D
PORCH

EXISTING
FOUNDATION

SETBACK INFO

FRONT: 20'
REAR: 15'
SIDES: 5'
CORNER SIDE: 15'

PROVIDENCE CREEK DRIVE
50' PUBLIC R/W & UTILITY EASEMENT

THIS AS-BUILT IS
FOR CODE COMPLIANCE.
NOT FOR SALES OR
CONVEYANCE

NUM	RADIUS	ARC	DELTA	CHORD BRG	CHORD
C1	625.00'	72.59'	6°39'18"	S 28°16'53" W	72.55'

REFERENCES:

B.M. 2025, PGS. 240-241



SCALE: 1" = 30'

NOTES

- THIS SURVEY SUBJECT TO ANY FACTS THAT MAY BE DISCLOSED BY A FULL AND ACCURATE TITLE SEARCH.
- THIS MAP MAY NOT BE A CERTIFIED SURVEY AND HAS NOT BEEN REVIEWED BY A LOCAL GOVERNMENT AGENCY FOR COMPLIANCE WITH ANY APPLICABLE LAND DEVELOPMENT REGULATIONS AND HAS NOT BEEN REVIEWED FOR COMPLIANCE WITH RECORDING REQUIREMENTS FOR PLATS.

WAKE COUNTY, NORTH CAROLINA

I CERTIFY THAT THIS MAP WAS DRAWN UNDER MY SUPERVISION FROM FIELDWORK DONE UNDER MY SUPERVISION; THAT THE IMPROVEMENTS LIE WHOLLY UPON THE LOT AND THAT THE PROPERTY SHOWN IS AN EXISTING PARCEL OR PARCELS OF LAND.

CLRP

CHARLES R. PIRATZKY
L-2813

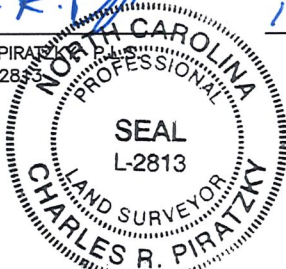

11.18.25
DATE

DATE: NOV. 07, 2025

Q:\FieldLoc\PK152FDN.txt

RWK, PA
ENGINEERING ~ SURVEYING
CORPORATE LICENSE: C-1771
101 W. MAIN ST., SUITE 202
GARNER, NC 27529
PHONE (919) 779-4854
FAX (919) 779-4056

Q:\PROVIDENCE CREEK\PK152\PK 152.DWG