

ELECTRICAL LEGEND		
ELECTRICAL	COUNT	SYMBOL
ceiling fan spotlights 01	4	
billiard light	1	
can light 6inch	14	
ceiling ivette	2	
ceiling light 03	4	
ceiling light 04	3	
ceiling light 17	1	
fluorescent light 2 x 4	3	
exterior craftsman light fixture	7	
garage door opener with track	2	
dryer outlet 220v	1	
fan	3	
outlet	35	
outlet 220v	2	
outlet gfi	12	
outlet wp	3	
stove outlet 220v	1	
switch	9	
switch double	4	
switch quad	3	
switch triple	4	
vanity bar light 01	1	
wall mounted 03 3 lights	2	

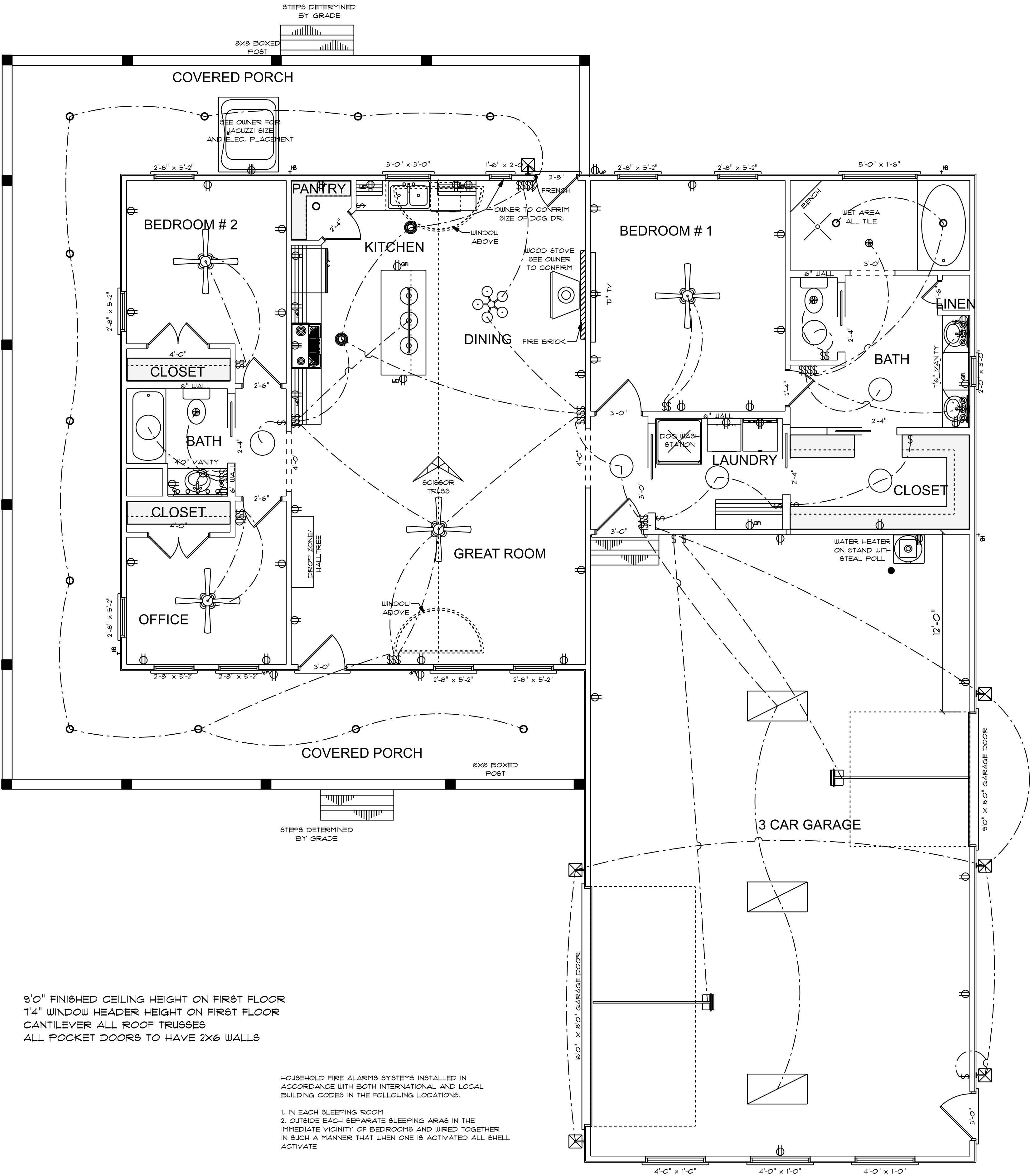

9'0" FINISHED CEILING HEIGHT ON FIRST FLOOR  
T'4" WINDOW HEADER HEIGHT ON FIRST FLOOR  
CANTILEVER ALL ROOF TRUSSES  
ALL POCKET DOORS TO HAVE 2X6 WALLS

HOUSEHOLD FIRE ALARMS SYSTEMS INSTALLED IN ACCORDANCE WITH BOTH INTERNATIONAL AND LOCAL BUILDING CODES IN THE FOLLOWING LOCATIONS.  
1. IN EACH SLEEPING ROOM  
2. OUTSIDE EACH SEPARATE SLEEPING AREA IN THE IMMEDIATE VICINITY OF BEDROOMS AND WIRED TOGETHER IN SUCH A MANNER THAT WHEN ONE IS ACTIVATED ALL SHALL ACTIVATE

ELECTRICAL PLAN  
SCALE: 1/4" = 1'0"

ELECTRICAL CONTRACTOR TO CONFIRM LOCATION OF OUTLET AND FIXTURES, SEE HOME OWNER FOR TYPE AND STYLE OF ELECTRICAL FIXTURES

JANE  
8C - 1646

NOTES:

1. ALL FINAL MATERIALS ARE TO BE CHOSEN BY THE HOME OWNER.
2. FINAL NUMBER OF EXTERIOR STEPS WILL BE DETERMINED ON SITE BY GRADE.
3. CONTRACTOR MUST MEET OR EXCEED ALL REQUIREMENTS OF ALL APPLICABLE LOCAL, STATE, AND FEDERAL CODES.
4. DESIGNER ASSUMES NO RESPONSIBILITY FOR CHANGES TO DRAWINGS BY OTHERS DURING CONSTRUCTION.
5. ALL STRUCTURAL INFO SHOWN ON PLANS ARE FOR INFORMATION ONLY. THE CONTRACTOR SHALL HAVE STRUCTURAL ENGR. REVIEW AND DESIGN ALL STRUCTURAL ELEMENTS.

GCP Designs Group LLC  
Designs You Can Trust

DATE: 6-30-2025  
SUBDIVISION:  
BUILDER:

**SOUTHEASTERN CONSTRUCTION**  
**HOMES & DEVELOPMENT**

NOTE:  
BUILDING CONTRACTOR TO MEET LOCAL WIND LOADS PER LOCAL CODE AS IT PERTAINS TO LOCATION OF HOUSE  
ICC, IBC, ASCE, IRC, ILC, IFBC, IFHC