

Harnett County Department of Public Health

PERMIT # SFD 2507-0040

Operation Permit

☒ New Installation ☒ Septic Tank ☒ Nitrification Line ☐ Repair ☐ Expansion

PROPERTY LOCATION: 160 Greene Leaf Dr, Lillington

Name: (owner) DRG Group North Carolina SUBDIVISION Birke pond LOT # 26

System Installer: Weather Master

Basement with plumbing: ☐ Garage ☒ Number of Bedrooms 4

Type of Water Supply: ☐ Community ☒ Public ☐ Well Distance from well _____ feet

System Type: 25% Reduction Type II (G) 24 Channels Types V and VI Systems expire in 5 years.

(In accordance with Table V a)

Owner must contact Health Department 6 months prior to expiration for permit renewal.

This system has been installed in compliance with applicable North Carolina General Statutes, Rules for Sewage Treatment and Disposal, and all conditions of the Improvement Permit and Construction Authorization.

~~* Needs curtain drain installed~~
~~* Needs 6" of cover on lines~~

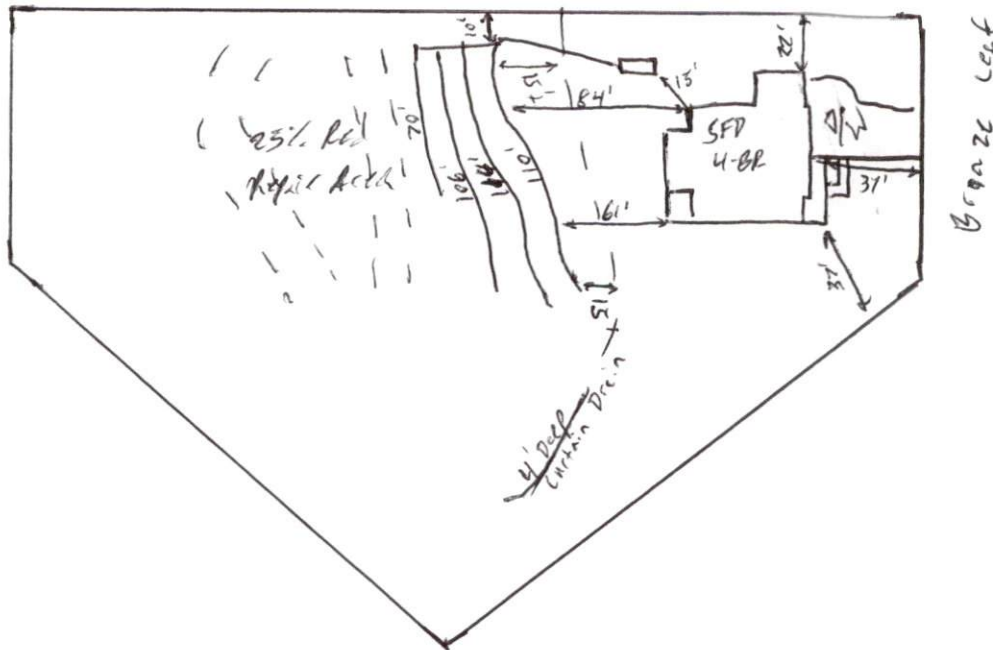

PERMIT CONDITIONS:

- I. Performance: System shall perform in accordance with Rule .1961.
- II. Monitoring: As required by Rule .1961.
- III. Maintenance: As required by Rule .1961. Other: _____
Subsurface system operator required? Yes ☐ No ☐
If yes, see attached sheet for additional operation conditions, maintenance and reporting.

- IV. Operation: _____
- V. Other: _____

☐ D-Box ☐ Pump ☐ Alarm ☐ H2O Line ☐ PWR Line

Following are the specifications for the sewage disposal system on the above captioned property.

Type of system: ☐ Conventional ☒ Other Type II (G) 24 Channels Septic Tank: 1,000 gallons Pump Tank: _____ gallons
Subsurface No. of exact length width of depth of
Drainage Field ditches 1 of each ditch 400' feet ditches 3' feet ditches 12" inches
French Drain Required: _____ Linear feet

Authorized State Agent REHS

Date 11-7-25