

Owner: GALT, Applicant:

Owner: (9A) Applicant  
Address: 61 Mathogany

Address: 61 Methuena  
Proposed Facility: SCD

Proposed Facility: SFD

Location of Site:

**Water Supply:**

Evaluation Method: ☒ Auger Boring

Type of Wastewater:

Date Evaluated:

Design Flow (.1949):

Property Recorded:

Public

☐ Individual

☐ Well

☐ Pit

☐ Cut

☐ Industrial Process

Property Size:

☐ Spring☐ Other☐ Mixed

Description	Initial System	Repair System	Other Factors (.1946): Site Classification (.1948): Evaluated By: Others Present:
Available Space (.1945)	✓	✓	S M A R E H
System Type(s)	✓	✓	
Site LTAR	.6	.6	

COMMENTS: \_\_\_\_\_

LANDSCAPE POSITIONS	GROUP	TEXTURES	.1955 LTAR	CONSISTENCE MOIST	WET
R-RIDGE	I	S-SAND	1.2 - 0.8	VFR-VERY FRIABLE	NS-NON-STICKY
S-SHOULDER SLOPE		LS-LOAMY SAND		FR-FRIABLE	SS-SLIGHTLY STICKY
L-LINEAR SLOPE				FI-FIRM	S-STICKY
FS-FOOT SLOPE	II	SL-SANDY LOAM	0.8 - 0.6	VFI-VERY FIRM	VS-VERY STICKY
N-NOSE SLOPE		L-LOAM		EFI-EXTREMELY FIRM	NP-NON-PLASTIC
H-HEAD SLOPE					SP-SLIGHTLY STICKY
CC-CONCLAVE SLOPE	III	SI-SILT	0.6 - 0.3		P-PLASTIC
CV-CONVEX SLOPE		SIL-SILT LOAM			VP-VERY PLASTIC
T-TERRACE		CL-CLAY LOAM			
FP-FLOOD PLAN		SCL-SANDY CLAY LOAM			
	IV	SIC-SILTY CLAY	0.4 - 0.1		
		C-CLAY			
		SC-SANDY CLAY			

STRUCTURE

SG-SINGLE GRAIN  
M-MASSIVE  
CR-CRUMB  
GR-GRANULAR  
SBK-SUBANGULAR BLOCKY  
ABK-ANGULAR BLOCKY  
PL-PLATY  
PR-PRISMATIC

MINERALOGY

SLIGHTLY EXPANSIVE  
EXPANSIVE

Show profile locations and other site features (dimensions, references or benchmark, and North)

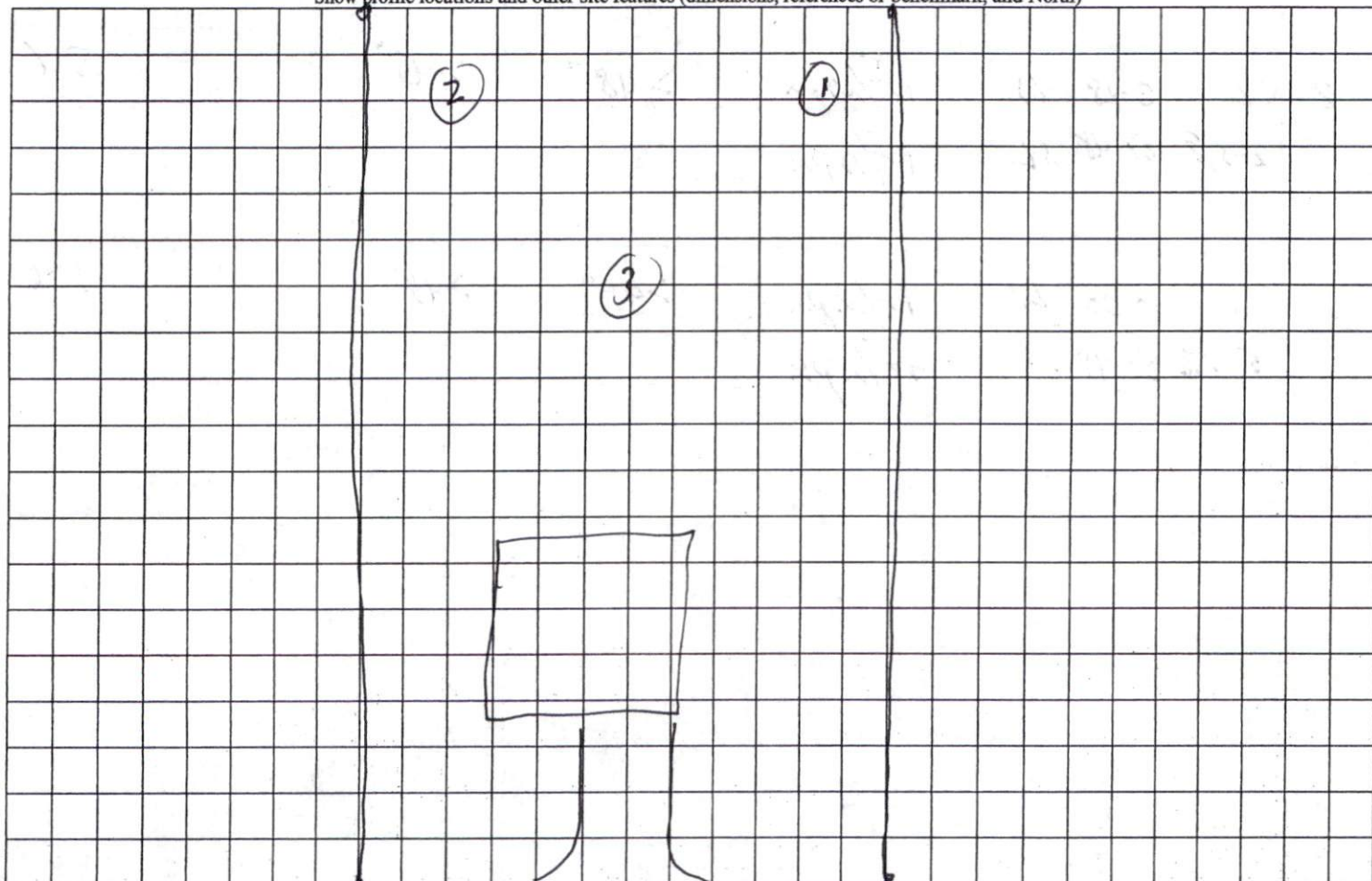

Mahogany