

LOT INFORMATION:

PIN: 9574-01-9461,000
REFERENCE: DB, 4292, PGS. 2348-2351
TOTAL LOT AREA = 0.459 AC = 20,000 SF
FOUNDATION = 2,100 SF
EXISTING IMPERVIOUS = 2,100 SF
PERCENT IMPERVIOUS = 10.50%
MAXIMUM LOT IMPERVIOUS = 5,683 SF

BUILDING SETBACKS

FRONT - 35'
SIDE - 10'
REAR - 25'
STREET SIDE - 20'

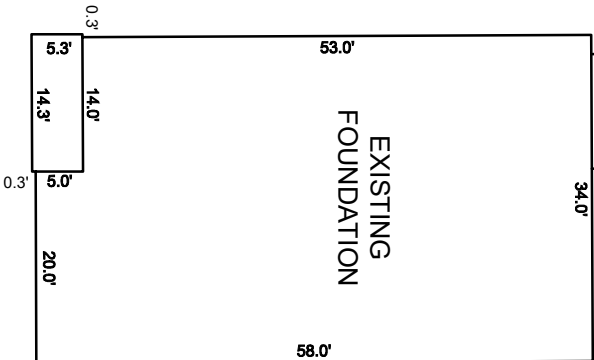

INSET SCALE: 1"=20'



18

17

16

- NOTES:**
1. THIS SURVEY WAS PREPARED BY BATEMAN CIVIL SURVEY CO., UNDER THE SUPERVISION OF STEVEN P. CARSON, PLS.
 2. THIS PLAN HAS BEEN PREPARED FOR LAYOUT AND PERMITTING PURPOSES ONLY.
 3. PROPERTY LINES SHOWN WERE TAKEN FROM EXISTING FIELD EVIDENCE, EXISTING DEEDS AND PLATS OF PUBLIC RECORD, AND INFORMATION SUPPLIED TO THE SURVEYOR BY THE CLIENT.
 4. ALL DISTANCES ARE HORIZONTAL GROUND DISTANCES AND ALL BEARINGS ARE NORTH CAROLINA STATE PLANE COORDINATE SYSTEM UNLESS OTHERWISE SHOWN.
 5. THIS MAP IS NOT FOR RECORDATION AND SHOULD BE REVIEWED BY A LOCAL GOVERNMENT AGENCY FOR COMPLIANCE WITH ANY APPLICABLE LAND DEVELOPMENT REGULATIONS.
 6. THE BASIS OF NORTH AND ALL EASEMENTS, RIGHTS-OF-WAYS, BUFFERS, SETBACKS AND ADJOINERS, ETC. REFERENCED IN TITLE BLOCK.
 7. NO INVESTIGATION INTO THE EXISTENCE OF JURISDICTIONAL WETLANDS, FLOOD ZONES OR RIPARIAN BUFFERS PERFORMED BY THIS FIRM. ALL LINES SHOWN, IF ANY, ARE SCALED FROM THE RECORDED PLAT.
 8. SURVEYOR HAS MADE NO INVESTIGATION OR INDEPENDENT SEARCH FOR EASEMENTS OF RECORD, ENCUMBRANCES, RESTRICTIVE COVENANTS, OWNERSHIP TITLE EVIDENCE OR ANY OTHER FACTS THAT AN ACCURATE AND CURRENT TITLE SEARCH MAY DISCLOSE.
 9. ZONING: RA-20R
 10. BUILDER/DEVELOPER: SMITH DOUGLAS HOMES

3412 APEX PEAKWAY
APEX, NC 27502



25' VARIABLE WIDTH PRIVATE STORM
WATER & DRAINAGE EASEMENT

OPEN SPACE A

S81°33'07"W 80.00'

25' REAR SETBACK

144.8'

S8°26'53"E 250.00'

N8°26'53"W 250.00'

EXISTING
FOUNDATION

10' SIDE SETBACK
22.8'
23.1'
22.9'

35' FRONT
SETBACK

21' PRIVATE
UTILITY &
LANDSCAPE
EASEMENT

21.0'

10' PRIVATE
DRAINAGE
EASEMENT

N81°33'07"E 80.00'

IPF

DEODORA LANE

50' PUBLIC RW



Bateman Civil Survey Company

Engineers • Surveyors • Planners

2524 Reliance Avenue, Apex, NC 27539 Ph: 919.577.1080 Fax: 919.577.1081
www.batemancivilsurvey.com info@batemancivilsurvey.com
NCBELS Firm No. C-2378

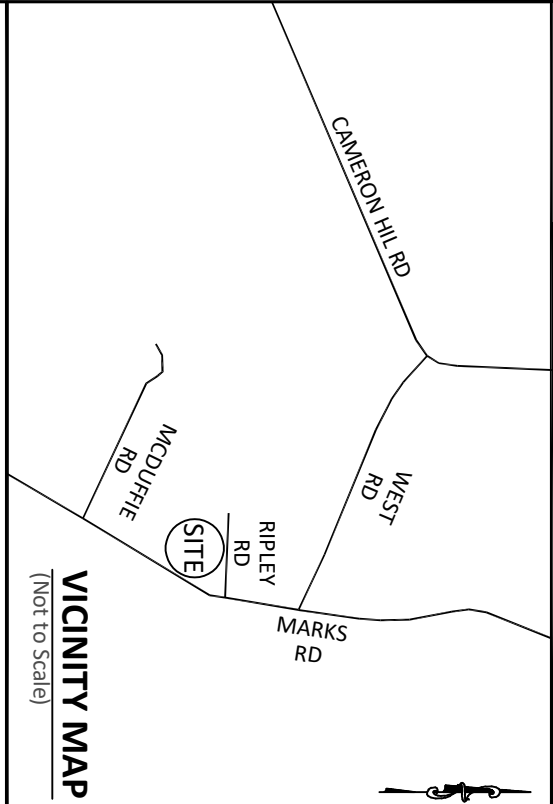

VICINITY MAP
(Not to Scale)

LEGEND

PO = FRONT COVERED PORCH
SP = SCREENED PORCH/PATIO
CP = COVERED PORCH/PATIO
WD = WOOD DECK
SW = SIDEWALK
DW = CONC DRIVEWAY
S = STOOP
X = COMPUTED POINT
X = MAG NAIL FOUND (IPF)
● = IRON PIPE SET (IPS)
● = DRILL HOLE FOUND
[WMD] = WATER METER
CO = CLEAN OUT
AC = AIR CONDITIONER PAD
[S] = SEWER MANHOLE
[EB] = ELECTRIC BOX
[CB] = CABLE BOX
[TP] = TELEPHONE PEDESTAL
CB = CATCH BASIN/CURB INLET
IC = IRRIGATION CONTROLLER
☼ = LIGHT POLE
☼ = UTILITY POLE
☼ = FIRE HYDRANT
DI = DRAIN INLET
WV = WATER VALVE
[X] = STREET SIGN
YI = YARD INLET
G = GAS METER
E = ELECTRIC METER

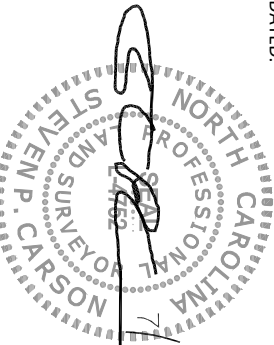

This map is of an existing parcel of land and is only intended for the parties and purposes shown. This map not for recordation. No title report provided.

FOUNDATION SURVEY

FOR

SMITH DOUGLAS HOMES

CEDAR POINTE - LOT 17

322 DEODORA LANE, CAMERON, NC
JOHNSONVILLE TOWNSHIP, HARNETT COUNTY

DATE: 7/3/25 DRAWN BY: DOM CHECKED BY: SPC

REFERENCE: BK. 2024, PGS. 275-276

BCS# 240381

SCALE: 1" = 30'