

Witness my hand and seal this day of MONTH 2025.

N/F
COUNTY OF HARNETT, NORTH CAROLINA
PARCEL FIVE OF DB 3334, PG 574

COMMON AREA

15' PERIMETER BUFFER

$$S\ 73^{\circ}09'53''\ E \longrightarrow 70.00'$$

548

10,150 SF
0.23 AC

10' x 8' COVERED PATIO

PROPOSED FREELANCE ELEV D2

5' UTILITY EASEMENT

549

547

BENNINGTON WAY

50' RW (PUBLIC & UTILITY ACCESS)

REVISION: LEFT HAND 5/7/25

IMPERVIOUS AREAS

HOUSE	1 204 SQ. FT.
DRIVE & WALKS	602 SQ. FT.
COVERED PATIO	80 SQ. FT.
<hr/>	
TOTAL	1 886 SQ. FT.
ALLOWED	3000 SQ. FT.

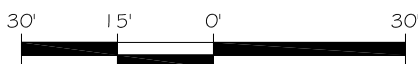

GRAPHIC SCALE
1"=30'

ZONING: RA-2OR
SETBACKS
FRONT 20
CORNER SIDE 20
REAR 15
SIDE 5

LEGEND

P R E L I M I N A R Y

NOT FOR RECORDATION,
SALES OR CONVEYANCE

EIP	EXISTING IRON PIPE	FES	FLARED END SECTION
RBS	REBAR SET	WM	WATER METER
RAW	RIGHT OF WAY	CO	CLEAN OUT
N/F	NOW OR FORMERLY	FH	FIRE HYDRANT
EIS	EXISTING IRON STAKE	CB	CATCH BASIN

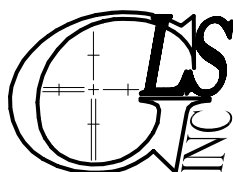
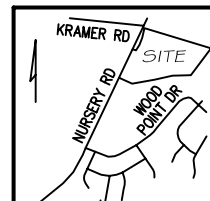

GRIFFIN LAND SURVEYING, INC.

P. O. BOX 148
FUQUAY-VARINA, NC 27526
(919) - 567-1963

FIRM LIC.# C-1345

PLOT PLAN

DREAM FINDERS HOMES LLC

CREEKSIDE OAKS
NORTH SUBDIVISION
LOT 548

BENNINGTON WAY

LILLINGTON, N.C.

HARNETT COUNTY ANDERSON CREEK TOWNSHIP

DRAWN BY **KDF**

DATE **4/22/25**

CHECKED BY **MPG**

SCALE 1" = 30'