

*Witness my hand and seal this day of MONTH 2025.*

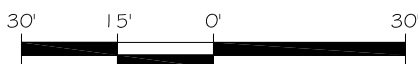

IMPERVIOUS AREAS

HOUSE	1488 SQ. FT.
DRIVE & WALKS	500 SQ. FT.
COVERED PATIO	80 SQ. FT.
<hr/>	
TOTAL	2068 SQ. FT.
ALLOWED	3000 SQ. FT.



GRAPHIC SCALE  
1"=30'

ZONING: RA-20R  
SETBACKS  
FRONT 20'  
CORNER SIDE 20'  
REAR 15'  
SIDE 5'

CI R=255.00' L=70.22' N56°16'49"E 70.00'

## LEGEND

P R E L I M I N A R Y  
NOT FOR RECORDATION,  
SALES OR CONVEYANCE

EIP	EXISTING IRON PIPE	FES	FLARED END SECTION
RBS	REBAR SET	WM	WATER METER
RAW	RIGHT OF WAY	CO	CLEAN OUT
N/F	NOW OR FORMERLY	FH	FIRE HYDRANT
EIS	EXISTING IRON STAKE	CB	CATCH BASIN

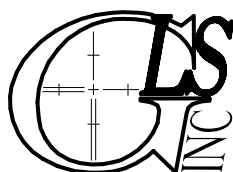
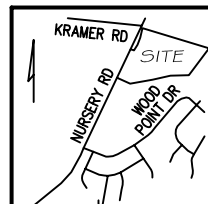

GRIFFIN LAND SURVEYING, INC.

P. O. BOX 148  
FUQUAY-VARINA, NC 27526  
(919) - 567-1963

FIRM LIC.# C-1345

## PLOT PLAN

*DREAM FINDERS HOMES LLC*

CREEKSIDE OAKS  
NORTH SUBDIVISION  
LOT 542

GREENBAY STREET

LILLINGTON, N.C.

HARNETT COUNTY      ANDERSON CREEK TOWNSHIP

DRAWN BY **KDF**

DATE **4/22/25**

CHECKED BY **MPG**

SCALE 1" = 30'