

FOUNDATION SURVEY FOR:  
**BVA BUILDERS INC.**

OWNERS: LNCE SOLUTIONS LLC  
DEED BOOK 4272, PAGE 1927 (SOURCE OF TITLE)  
BOOK OF MAPS 21, PAGE 52  
LOT 31

CAPTAINS LANDING SUBDIVISION  
BLOCK 4  
ADDRESS: 358 NATCHEZ TRACE  
HARNETT COUNTY, NORTH CAROLINA  
PIN: 0613-85-7576  
ZONE: RA-30

CURVE TABLE				
CURVE	LENGTH	RADIUS	DELTA	CHD. BRG.
C1	55.26	1224.04	02°35'12"	N40°03'11"E

CHD. 55.26

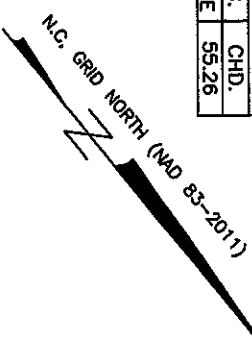

LOT 33

LOT 30  
N/F  
KING, KIAN S  
PIN: 0613-85-5771  
D.B. 882, PG. 907  
B.M. 21, PG. 52

1/2" EIP LOT 29

CONTROL CORNER  
NAD 83 (2011)  
N = 635,691.5094 sft.  
E = 2,018,720.311 sft.

NAIL  
BENT EIP

N34°54'22"E

N35°00'59"E

28.92'  
N34°42'19"E

73.97' 1/2" EIP 1/2" EIP

DITCH

LOT 32

N/F  
CHAVIS JAMES D &  
CHAVIS KIM  
PIN: 0613-85-7418  
D.B. 2289, PG. 804  
B.M. 21, PG. 52

25,631 S.F.  
0.588 ACS.

31

LOT 28

N/F  
DELGADILLO CESARIA  
MEZA  
PIN: 0613-85-8645  
D.B. 3752, PG. 208  
B.M. 21, PG. 52

MINIMUM BUILDING SETBACKS  
FRONT = 35'  
SIDE = 10'  
REAR = 25'

**LEGEND**

EIP = EXISTING IRON PIPE  
ERB = #4 RE-BAR  
CP = CALCULATED POINT  
R/W = RIGHT-OF-WAY

R/W

ERB

C1

ERB

N38°52'46"E

CP

57.24'

37.8'

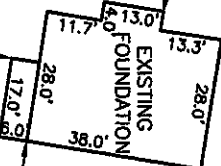

EXISTING  
FOUNDATION

NATCHEZ TRACE  
40' PUBLIC R/W

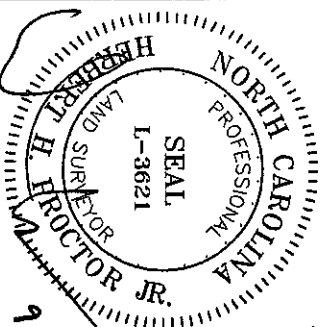

**NOTES**

1. AREA BY COORDINATE CALCULATION.
2. PROPERTY IS SUBJECT TO ALL EASEMENTS AND RIGHT-OF-WAYS OF RECORD PRIOR TO THE DATE OF
3. NO GRID MONUMENTS FOUND WITHIN 2000' OF PROPERTY.

HOUSE PLAN: NICHOLAS LT

- REFERENCES**
1. D.B. 4272, PG. 1927
  2. B.M. 21, PG. 52
  3. ALL DEEDS AND MAPS WITH ADJOINERS.
  4. HARNETT COUNTY G.I.S.

**STEWART-PROCTOR**

ENGINEERING and SURVEYING  
319 CHAPANOKE ROAD, SUITE 106  
RALEIGH, NC 27603 (LICENSE # P-0148)  
TEL. 919 779-1855 FAX 919 779-1661

DATE 09/05/2025

SCALE 1"=40'

DRAWING  
"358 NATCHEZ  
TRACE 40SCALE  
FOUNDATION SURVEY"

**GRAPHIC SCALE**



( IN FEET )  
1 inch = 40 ft.

**NOTE:**

NO DETERMINATION HAS BEEN MADE BY THE SURVEYOR AS TO THE EXISTENCE OF THE FOLLOWING:  
- WETLANDS  
- UNDER GROUND UTILITIES  
- UNDER GROUND STORAGE FACILITIES  
- CEMETERIES OR BURIAL GROUNDS  
- RIPARIAN/STREAM BUFFERS  
- IMPERVIOUS SURFACE CALCULATIONS OR LIMITATIONS

THIS PROPERTY IS  
NOT LOCATED IN A F.E.M.A. 100  
TEAR FLOOD HAZARD AREA.  
REFERENCE: F.E.M.A. COMMUNITY  
PANEL NO. 3720060200J  
EFFECTIVE DATE: 10/03/2006

TYLER DENAR RD.

