

Witness my hand and seal this day of MONTH 2025.

BK 2024 PG 512
HARNETT CO. REGISTRY



HOUSE	1 488 SQ. FT.
DRIVE & WALKS	499 SQ. FT.
COVERED PATIO	80 SQ. FT.
<hr/>	
TOTAL	2067 SQ. FT.
ALLOWED	3000 SQ. FT.

CI R=400.00' L=70.09' S86°35'07"E 70.00'



GRAPHIC SCALE
1"=30'

ZONING: RA-2OR
SETBACKS
FRONT 20
CORNER SIDE 20
REAR 15
SIDE 5

LEGEND

P R E L I M I N A R Y

NOT FOR RECORDATION,
SALES OR CONVEYANCE

EIP	EXISTING IRON PIPE	FES	FLARED END SECTION
RBS	REBAR SET	WM	WATER METER
RAW	RIGHT OF WAY	CO	CLEAN OUT
N/F	NOW OR FORMERLY	FH	FIRE HYDRANT
EIS	EXISTING IRON STAKE	CB	CATCH BASIN

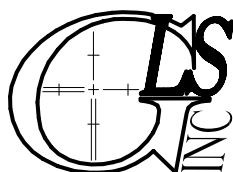
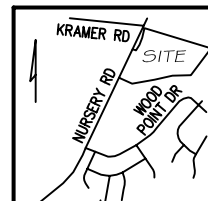

GRIFFIN LAND SURVEYING, INC.

P. O. BOX 148
FUQUAY-VARINA, NC 27526
(919) - 567-1963

FIRM LIC.# C-1345

PLOT PLAN

DREAM FINDERS HOMES LLC

CREEKSIDE OAKS
NORTH SUBDIVISION
LOT 529

GREENBAY STREET

LILLINGTON, N.C.

HARNETT COUNTY ANDERSON CREEK TOWNSHIP

DRAWN BY **KDF**

DATE **4/4/25**

CHECKED BY **MPG**

SCALE 1" = 30'