

**SOIL/SITE EVALUATION
for ON-SITE WASTEWATER SYSTEM**

Owner: Jeff Anderson
Applicant:

Address: 648 Hayes Rd
Proposed Facility: SFD

Location of Site:

Water Supply:

Evaluation Method: ☒ Auger Boring

Type of Wastewater: ☒ Sewage

Date Evaluated:

Design Flow (.1949): 360 GPD

Property Recorded:

☒ Public ☐ Individual ☐ Well

☐ Pit ☐ Cut

☐ Industrial Process

Property Size:

☐ Spring

☐ Other

☐ Mixed

P R O F I L E #	.1940 Landscape Position/ Slope %	Horizon Depth (In.)	SOIL MORPHOLOGY .1941		OTHER PROFILE FACTORS				Profile Class & LTAR
			.1941 Structure/ Texture	.1941 Consistence Mineralogy	.1942 Soil Wetness/ Color	.1943 Soil Depth (IN.)	.1956 Sapro Class	.1944 Restr Horiz	
1	L	0-24	LS	Fr/nspx	>48"	>48"	—	—	S-4
	2-5%	24-32	SCI	Fr/sspx					
		32-48	SL	Fr/nspx					
2	L	0-30	LS	Fr/nspx	>48"	>48"	—	—	S-4
	2-5%	30-36	SCI	Fr/sspx					
		36-48	SL	Fr/nspx					
3	L	0-30	LS	Fr/nspx	>48"	>48"	—	—	S-4
	2-5%	30-40	SCI	Fr/sspx					
		40-48	SL	Fr/nspx					
4	L	0-27	LS	Fr/nspx	10/128/1	>48"	—	—	S-4
	25%	27-42	SCI	Fr/sspx	>42"				
		42-48	SL	Fr/nspx					

Description	Initial System	Repair System	Other Factors (.1946): Site Classification (.1948): Evaluated By: <u>MD RCHS</u> Others Present:
Available Space (.1945)	<input checked="" type="checkbox"/>	<input checked="" type="checkbox"/>	
System Type(s)	<input checked="" type="checkbox"/>	<input checked="" type="checkbox"/>	
Site LTAR	.4	.4	

COMMENTS: _____

LANDSCAPE POSITIONS

R-RIDGE
S-SHOULDER SLOPE
L-LINEAR SLOPE
FS-FOOT SLOPE
N-NOSE SLOPE
H-HEAD SLOPE
CC-CONCLAVE SLOPE
CV-CONVEX SLOPE
T-TERRACE
FP-FLOOD PLAN

GROUPTEXTURES.1955 LTARCONSISTENCE MOISTWET

I S-SAND
LS-LOAMY SAND

II SL-SANDY LOAM
L-LOAM

III SI-SILT
SIL-SILT LOAM
CL-CLAY LOAM
SCL-SANDY CLAY LOAM

IV SIC-SILTY CLAY
C-CLAY
SC-SANDY CLAY

1.2 - 0.8

0.8 - 0.6

0.6 - 0.3

0.4 - 0.1

VFR-VERY FRIABLE
FR-FRIABLE
FI-FIRM
VFI-VERY FIRM
EFI-EXTREMELY FIRM

NS-NON-STICKY
SS-SLIGHTLY STICKY
S-STICKY
VS-VERY STICKY
NP-NON-PLASTIC
SP-SLIGHTLY STICKY
P-PLASTIC
VP-VERY PLASTIC

STRUCTURE

SG-SINGLE GRAIN
M-MASSIVE
CR-CRUMB
GR-GRANULAR
SBK-SUBANGULAR BLOCKY
ABK-ANGULAR BLOCKY
PL-PLATY
PR-PRISMATIC

MINERALOGY

SLIGHTLY EXPANSIVE

EXPANSIVE

Show profile locations and other site features (dimensions, references or benchmark, and North)

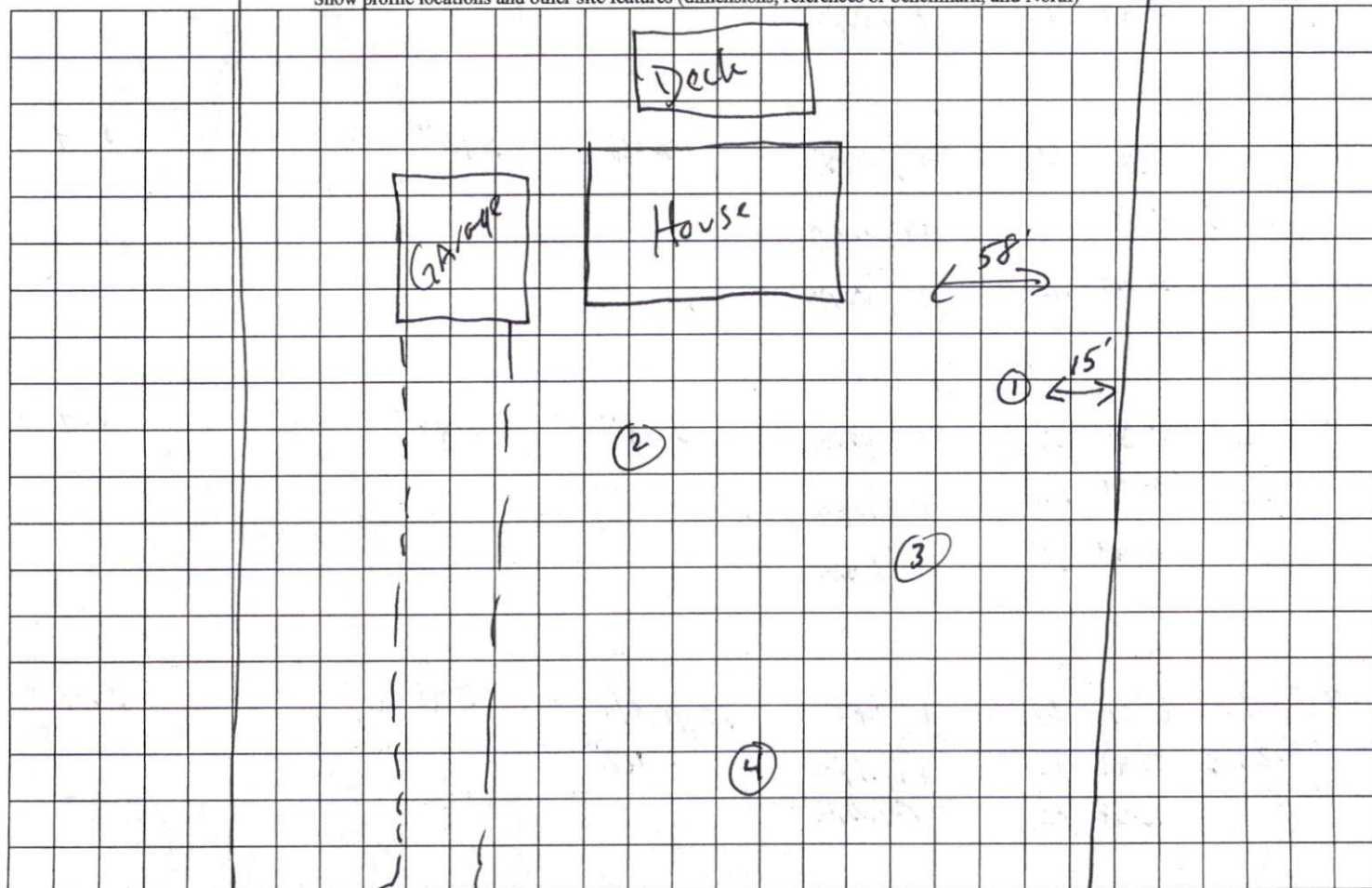

← TO Hayer rd →
←