

Owner: Bridgeport Applicant:

Date Evaluated:
Design Flow (.1949): 480 GPD

Property Size:

Property Recorded:

☒ Public

☐ Individual ☐ Well

☐ Spring☐ Other☐ Pit☐ Pit☐ Mixed☒ Sewage☐ Industrial Process

| Description | Initial System | Repair System | Other Factors (.1946): Site Classification (.1948): Evaluated By: <i>MD-12 & HS</i> Others Present: |
|-------------------------|----------------|---------------|--|
| Available Space (.1945) | <i>✓</i> | <i>✓</i> | |
| System Type(s) | <i>✓</i> | <i>✓</i> | |
| Site LTAR | <i>-7</i> | <i>-7</i> | |

COMMENTS: _____

| LANDSCAPE POSITIONS | GROUP | TEXTURES | .1955 LTAR | CONSISTENCE MOIST | WET |
|---------------------|-------|---------------------|------------|-------------------|--------------------|
| R-RIDGE | I | S-SAND | 1.2 - 0.8 | VFR-VERY FRIABLE | NS-NON-STICKY |
| S-SHOULDER SLOPE | | LS-LOAMY SAND | | | SS-SLIGHTLY STICKY |
| L-LINEAR SLOPE | II | SL-SANDY LOAM | 0.8 - 0.6 | FI-FIRM | S-STICKY |
| FS-FOOT SLOPE | | L-LOAM | | | VS-VERY STICKY |
| N-NOSE SLOPE | III | SI-SILT | 0.6 - 0.3 | VFI-VERY FIRM | NP-NON-PLASTIC |
| H-HEAD SLOPE | | SIL-SILT LOAM | | | SP-SLIGHTLY STICKY |
| CC-CONCLAVE SLOPE | | CL-CLAY LOAM | | | P-PLASTIC |
| CV-CONVEX SLOPE | | SCL-SANDY CLAY LOAM | | | VP-VERY PLASTIC |
| T-TERRACE | IV | SIC-SILTY CLAY | 0.4 - 0.1 | | |
| FP-FLOOD PLAN | | C-CLAY | | | |
| | | SC-SANDY CLAY | | | |

STRUCTURE

SG-SINGLE GRAIN
M-MASSIVE
CR-CRUMB
GR-GRANULAR
SBK-SUBANGULAR BLOCKY
ABK-ANGULAR BLOCKY
PL-PLATY
PR-PRISMATIC

MINERALOGY

SLIGHTLY EXPANSIVE
EXPANSIVE

Show profile locations and other site features (dimensions, references or benchmark, and North)

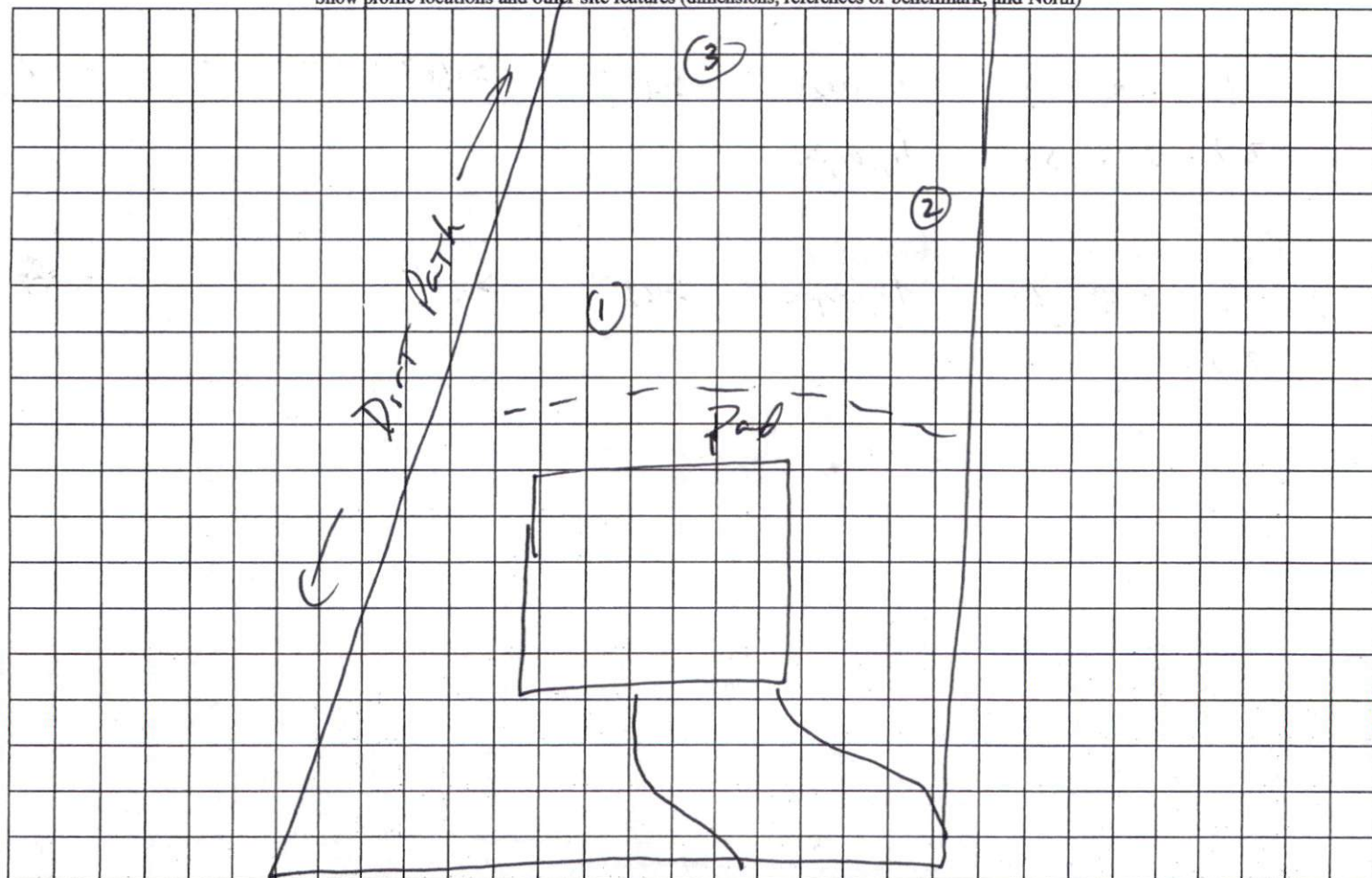

Cameron hill