



Client: Signature Homes
Project:
Address:

Date: 3/12/2025
Input by: Anthony Williams
Job Name: Lot 4 Mabry Ridge
Project #: J0325-1367

Page 1 of 10

HDR-1 Kerto-S LVL 1.750" X 9.250" 2-Ply - PASSED

Level: Level

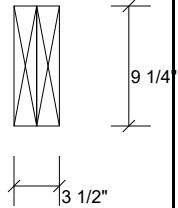
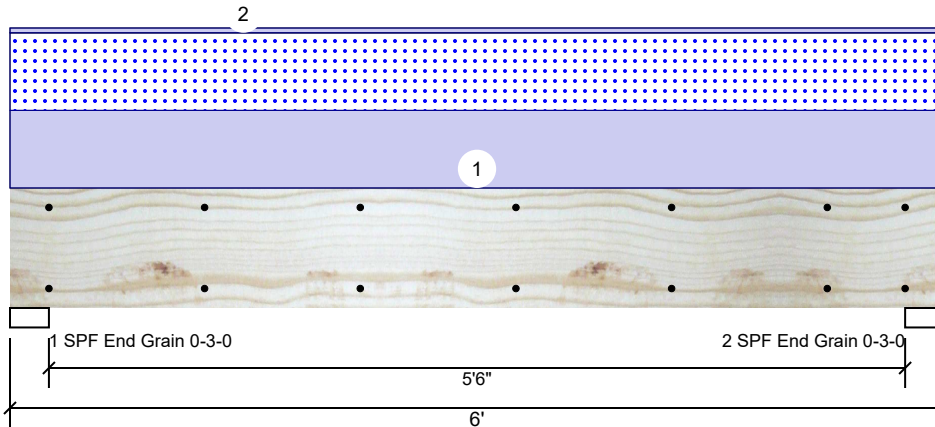

Member Information

Type: Girder
Plies: 2
Moisture Condition: Dry
Deflection LL: 480
Deflection TL: 360
Importance: Normal - II
Temperature: Temp <= 100°F

Application: Floor
Design Method: ASD
Building Code: IBC/IRC 2015
Load Sharing: No
Deck: Not Checked

Reactions UNPATTERNED lb (Uplift)

Brg	Direction	Live	Dead	Snow	Wind	Const
1	Vertical	0	1576	1464	0	0
2	Vertical	0	1576	1464	0	0

Bearings

Bearing	Length	Dir.	Cap.	React D/L lb	Total	Ld. Case	Ld. Comb.
1 - SPF End Grain	3.000"	Vert	34%	1576 / 1464	3040	L	D+S
2 - SPF End Grain	3.000"	Vert	34%	1576 / 1464	3040	L	D+S

Analysis Results

Analysis	Actual	Location	Allowed	Capacity	Comb.	Case
Moment	4007 ft-lb	3'	14423 ft-lb	0.278 (28%)	D+S	L
Unbraced	4007 ft-lb	3'	10944 ft-lb	0.366 (37%)	D+S	L
Shear	2011 lb	1' 1/4"	7943 lb	0.253 (25%)	D+S	L
LL Defl inch	0.031 (L/2200)	3'	0.141 (L/480)	0.218 (22%)	S	L
TL Defl inch	0.064 (L/1060)	3'	0.188 (L/360)	0.340 (34%)	D+S	L

Design Notes

- 1 Provide support to prevent lateral movement and rotation at the end bearings. Lateral support may also be required at the interior bearings by the building code.
- 2 Fasten all plies using 2 rows of 10d Box nails (.128x3") at 12" o.c. Maximum end distance not to exceed 6".
- 3 Refer to last page of calculations for fasteners required for specified loads.
- 4 Girders are designed to be supported on the bottom edge only.
- 5 Top loads must be supported equally by all plies.
- 6 Top must be laterally braced at end bearings.
- 7 Bottom must be laterally braced at end bearings.
- 8 Lateral slenderness ratio based on single ply width.

ID	Load Type	Location	Trib Width	Side	Dead 0.9	Live 1	Snow 1.15	Wind 1.6	Const. 1.25	Comments
1	Uniform			Top	488 PLF	0 PLF	488 PLF	0 PLF	0 PLF	B2 TRUSS
2	Uniform			Top	30 PLF	0 PLF	0 PLF	0 PLF	0 PLF	WALL
	Self Weight				7 PLF					

Notes

Calculated Structural Designs is responsible only of the structural adequacy of this component based on the design criteria and loadings shown. It is the responsibility of the customer and/or the contractor to ensure the component suitability of the intended application, and to verify the dimensions and loads.

Lumber

1. Dry service conditions, unless noted otherwise
2. LVL not to be treated with fire retardant or corrosive chemicals

chemicals

Handling & Installation

1. LVL beams must not be cut or drilled
2. Refer to manufacturer's product information regarding installation requirements, multi-ply fastening details, beam strength values, and code approvals
3. Damaged Beams must not be used
4. Design assumes top edge is laterally restrained
5. Provide lateral support at bearing points to avoid lateral displacement and rotation

6. For flat roofs provide proper drainage to prevent ponding

This design is valid until 6/28/2026

Manufacturer Info

Metsä Wood
301 Merritt 7 Building, 2nd Floor
Norwalk, CT 06851
(800) 622-5850
www.metsawood.com/us



Client: Signature Homes
Project:
Address:

Date: 3/12/2025
Input by: Anthony Williams
Job Name: Lot 4 Mabry Ridge
Project #: J0325-1367

Page 2 of 10

HDR-1 Kerto-S LVL 1.750" X 9.250" 2-Ply - PASSED

Level: Level

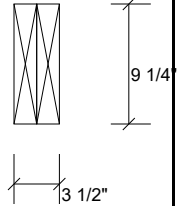
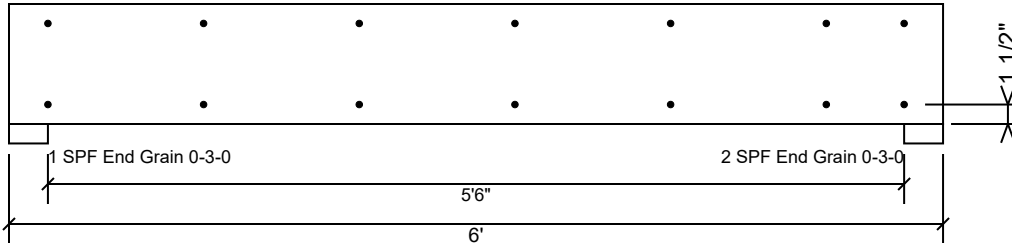

Multi-Ply Analysis

Fasten all plies using 2 rows of 10d Box nails (.128x3") at 12" o.c.. Maximum end distance not to exceed 6".

Capacity	0.0 %
Load	0.0 PLF
Yield Limit per Foot	163.7 PLF
Yield Limit per Fastener	81.9 lb.
C _m	1
Yield Mode	IV
Edge Distance	1 1/2"
Min. End Distance	3"
Load Combination	
Duration Factor	1.00

Notes

Calculated Structural Designs is responsible only of the structural adequacy of this component based on the design criteria and loadings shown. It is the responsibility of the customer and/or the contractor to ensure the component suitability of the intended application, and to verify the dimensions and loads.

Lumber

1. Dry service conditions, unless noted otherwise
2. LVL not to be treated with fire retardant or corrosive

chemicals

Handling & Installation

1. LVL beams must not be cut or drilled
2. Refer to manufacturer's product information regarding installation requirements, multi-ply fastening details, beam strength values, and code approvals
3. Damaged Beams must not be used
4. Design assumes top edge is laterally restrained
5. Provide lateral support at bearing points to avoid lateral displacement and rotation

6. For flat roofs provide proper drainage to prevent ponding

This design is valid until 6/28/2026

Manufacturer Info

Metsä Wood
301 Merritt 7 Building, 2nd Floor
Norwalk, CT 06851
(800) 622-5850
www.metsawood.com/us



Client: Signature Homes
Project:
Address:

Date: 3/12/2025
Input by: Anthony Williams
Job Name: Lot 4 Mabry Ridge
Project #: J0325-1367

Page 3 of 10

HDR-2 Kerto-S LVL 1.750" X 9.250" 2-Ply - PASSED

Level: Level

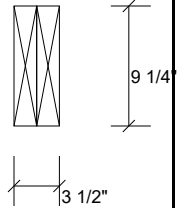
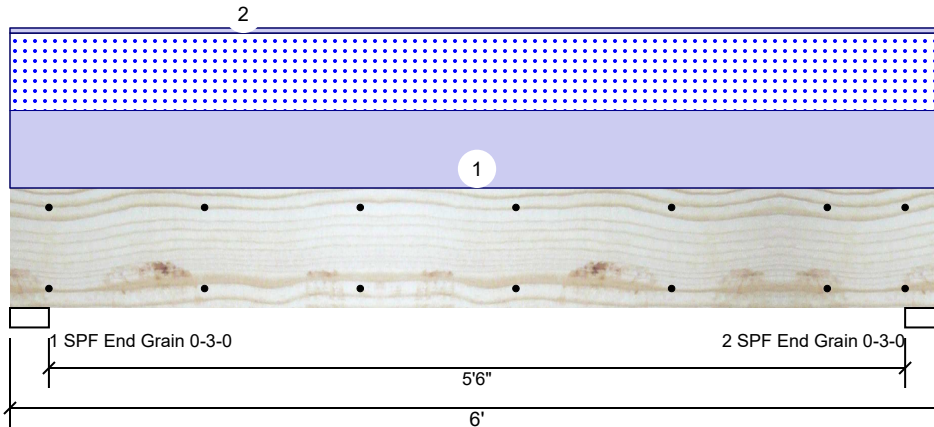

Member Information

Type: Girder
Plies: 2
Moisture Condition: Dry
Deflection LL: 480
Deflection TL: 360
Importance: Normal - II
Temperature: Temp <= 100°F

Application: Floor
Design Method: ASD
Building Code: IBC/IRC 2015
Load Sharing: No
Deck: Not Checked

Reactions UNPATTERNED lb (Uplift)

Brg	Direction	Live	Dead	Snow	Wind	Const
1	Vertical	0	1498	1386	0	0
2	Vertical	0	1498	1386	0	0

Bearings

Bearing	Length	Dir.	Cap.	React D/L lb	Total	Ld. Case	Ld. Comb.
1 - SPF End Grain	3.000"	Vert	33%	1498 / 1386	2884	L	D+S
2 - SPF End Grain	3.000"	Vert	33%	1498 / 1386	2884	L	D+S

Analysis Results

Analysis	Actual	Location	Allowed	Capacity	Comb.	Case
Moment	3802 ft-lb	3'	14423 ft-lb	0.264 (26%)	D+S	L
Unbraced	3802 ft-lb	3'	10944 ft-lb	0.347 (35%)	D+S	L
Shear	1908 lb	1' 1/4"	7943 lb	0.240 (24%)	D+S	L
LL Defl inch	0.029 (L/2324)	3'	0.141 (L/480)	0.207 (21%)	S	L
TL Defl inch	0.060 (L/1117)	3'	0.188 (L/360)	0.322 (32%)	D+S	L

Design Notes

- 1 Provide support to prevent lateral movement and rotation at the end bearings. Lateral support may also be required at the interior bearings by the building code.
- 2 Fasten all plies using 2 rows of 10d Box nails (.128x3") at 12" o.c. Maximum end distance not to exceed 6".
- 3 Refer to last page of calculations for fasteners required for specified loads.
- 4 Girders are designed to be supported on the bottom edge only.
- 5 Top loads must be supported equally by all plies.
- 6 Top must be laterally braced at end bearings.
- 7 Bottom must be laterally braced at end bearings.
- 8 Lateral slenderness ratio based on single ply width.

ID	Load Type	Location	Trib Width	Side	Dead 0.9	Live 1	Snow 1.15	Wind 1.6	Const. 1.25	Comments
1	Uniform			Top	462 PLF	0 PLF	462 PLF	0 PLF	0 PLF	B2 TRUSS
2	Uniform			Top	30 PLF	0 PLF	0 PLF	0 PLF	0 PLF	WALL
	Self Weight				7 PLF					

Notes

Calculated Structural Designs is responsible only of the structural adequacy of this component based on the design criteria and loadings shown. It is the responsibility of the customer and/or the contractor to ensure the component suitability of the intended application, and to verify the dimensions and loads.

Lumber

1. Dry service conditions, unless noted otherwise
2. LVL not to be treated with fire retardant or corrosive chemicals

Handling & Installation

1. LVL beams must not be cut or drilled
2. Refer to manufacturer's product information regarding installation requirements, multi-ply fastening details, beam strength values, and code approvals
3. Damaged Beams must not be used
4. Design assumes top edge is laterally restrained
5. Provide lateral support at bearing points to avoid lateral displacement and rotation

6. For flat roofs provide proper drainage to prevent ponding

This design is valid until 6/28/2026

Manufacturer Info

Metsä Wood
301 Merritt 7 Building, 2nd Floor
Norwalk, CT 06851
(800) 622-5850
www.metsawood.com/us



Client: Signature Homes
Project:
Address:

Date: 3/12/2025
Input by: Anthony Williams
Job Name: Lot 4 Mabry Ridge
Project #: J0325-1367

Page 4 of 10

HDR-2 Kerto-S LVL 1.750" X 9.250" 2-Ply - PASSED

Level: Level

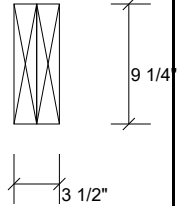
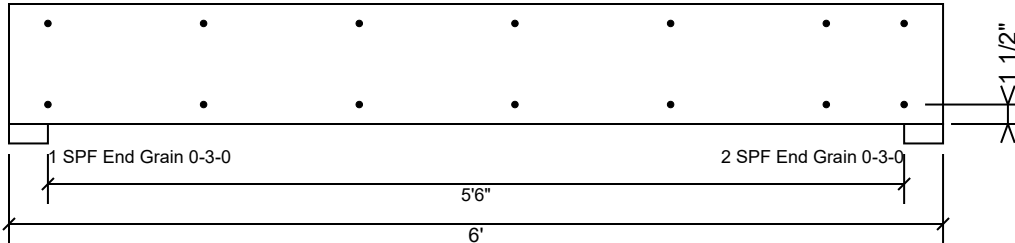

Multi-Ply Analysis

Fasten all plies using 2 rows of 10d Box nails (.128x3") at 12" o.c.. Maximum end distance not to exceed 6".

Capacity	0.0 %
Load	0.0 PLF
Yield Limit per Foot	163.7 PLF
Yield Limit per Fastener	81.9 lb.
C _m	1
Yield Mode	IV
Edge Distance	1 1/2"
Min. End Distance	3"
Load Combination	
Duration Factor	1.00

Notes

Calculated Structural Designs is responsible only of the structural adequacy of this component based on the design criteria and loadings shown. It is the responsibility of the customer and/or the contractor to ensure the component suitability of the intended application, and to verify the dimensions and loads.

Lumber

1. Dry service conditions, unless noted otherwise
2. LVL not to be treated with fire retardant or corrosive

chemicals

Handling & Installation

1. LVL beams must not be cut or drilled
2. Refer to manufacturer's product information regarding installation requirements, multi-ply fastening details, beam strength values, and code approvals
3. Damaged Beams must not be used
4. Design assumes top edge is laterally restrained
5. Provide lateral support at bearing points to avoid lateral displacement and rotation

6. For flat roofs provide proper drainage to prevent ponding

This design is valid until 6/28/2026

Manufacturer Info

Metsä Wood
301 Merritt 7 Building, 2nd Floor
Norwalk, CT 06851
(800) 622-5850
www.metsawood.com/us



Client: Signature Homes
Project:
Address:

Date: 3/12/2025
Input by: Anthony Williams
Job Name: Lot 4 Mabry Ridge
Project #: J0325-1367

Page 5 of 10

HDR-3 Kerto-S LVL 1.750" X 9.250" 2-Ply - PASSED

Level: Level

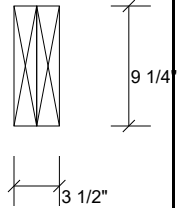
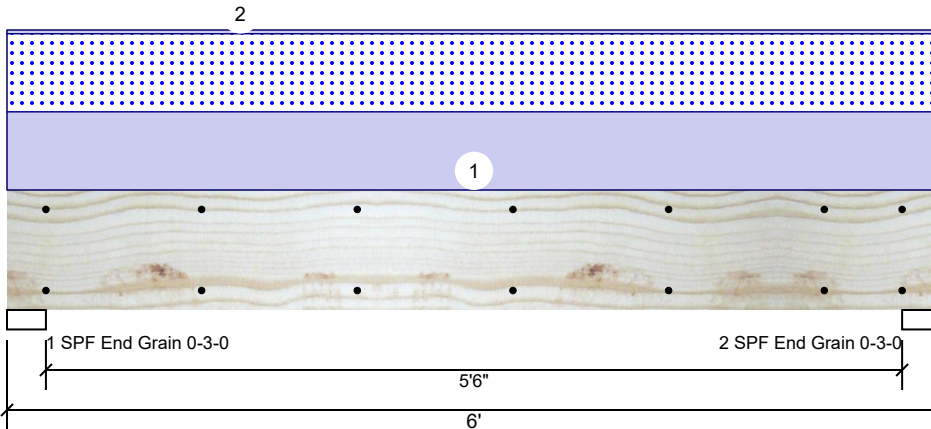

Member Information

Type: Girder
Plies: 2
Moisture Condition: Dry
Deflection LL: 480
Deflection TL: 360
Importance: Normal - II
Temperature: Temp <= 100°F

Application: Floor
Design Method: ASD
Building Code: IBC/IRC 2015
Load Sharing: No
Deck: Not Checked

Reactions UNPATTERNED lb (Uplift)

Brg	Direction	Live	Dead	Snow	Wind	Const
1	Vertical	0	2044	1932	0	0
2	Vertical	0	2044	1932	0	0

Bearings

Bearing	Length	Dir.	Cap.	React D/L lb	Total	Ld. Case	Ld. Comb.
1 - SPF End Grain	3.000"	Vert	45%	2044 / 1932	3976	L	D+S
2 - SPF End Grain	3.000"	Vert	45%	2044 / 1932	3976	L	D+S

Analysis Results

Analysis	Actual	Location	Allowed	Capacity	Comb.	Case
Moment	5241 ft-lb	3'	14423 ft-lb	0.363 (36%)	D+S	L
Unbraced	5241 ft-lb	3'	10944 ft-lb	0.479 (48%)	D+S	L
Shear	2628 lb	1' 1/4"	7943 lb	0.331 (33%)	D+S	L
LL Defl inch	0.040 (L/1667)	3'	0.141 (L/480)	0.288 (29%)	S	L
TL Defl inch	0.083 (L/810)	3'	0.188 (L/360)	0.444 (44%)	D+S	L

Design Notes

- 1 Provide support to prevent lateral movement and rotation at the end bearings. Lateral support may also be required at the interior bearings by the building code.
- 2 Fasten all plies using 2 rows of 10d Box nails (.128x3") at 12" o.c. Maximum end distance not to exceed 6".
- 3 Refer to last page of calculations for fasteners required for specified loads.
- 4 Girders are designed to be supported on the bottom edge only.
- 5 Top loads must be supported equally by all plies.
- 6 Top must be laterally braced at end bearings.
- 7 Bottom must be laterally braced at end bearings.
- 8 Lateral slenderness ratio based on single ply width.

ID	Load Type	Location	Trib Width	Side	Dead 0.9	Live 1	Snow 1.15	Wind 1.6	Const. 1.25	Comments
1	Uniform			Top	644 PLF	0 PLF	644 PLF	0 PLF	0 PLF	A2 TRUSS
2	Uniform			Top	30 PLF	0 PLF	0 PLF	0 PLF	0 PLF	WALL
	Self Weight				7 PLF					

Notes

Calculated Structural Designs is responsible only of the structural adequacy of this component based on the design criteria and loadings shown. It is the responsibility of the customer and/or the contractor to ensure the component suitability of the intended application, and to verify the dimensions and loads.

Lumber

1. Dry service conditions, unless noted otherwise
2. LVL not to be treated with fire retardant or corrosive chemicals

Handling & Installation

1. LVL beams must not be cut or drilled
2. Refer to manufacturer's product information regarding installation requirements, multi-ply fastening details, beam strength values, and code approvals
3. Damaged Beams must not be used
4. Design assumes top edge is laterally restrained
5. Provide lateral support at bearing points to avoid lateral displacement and rotation

6. For flat roofs provide proper drainage to prevent ponding

This design is valid until 6/28/2026

Manufacturer Info

Metsä Wood
301 Merritt 7 Building, 2nd Floor
Norwalk, CT 06851
(800) 622-5850
www.metsawood.com/us



Client: Signature Homes
Project:
Address:

Date: 3/12/2025
Input by: Anthony Williams
Job Name: Lot 4 Mabry Ridge
Project #: J0325-1367

Page 6 of 10

HDR-3 Kerto-S LVL 1.750" X 9.250" 2-Ply - PASSED

Level: Level

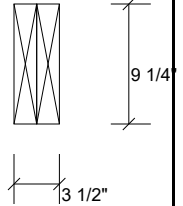
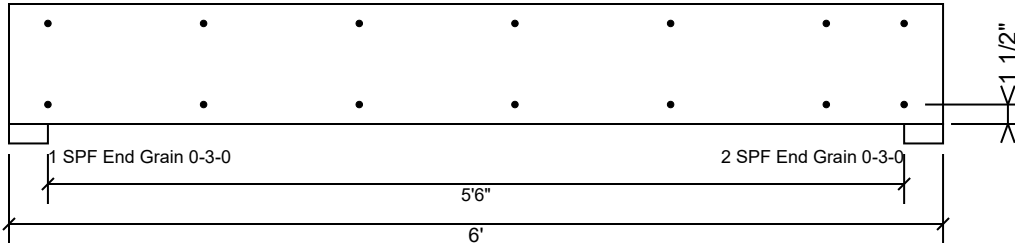

Multi-Ply Analysis

Fasten all plies using 2 rows of 10d Box nails (.128x3") at 12" o.c.. Maximum end distance not to exceed 6".

Capacity	0.0 %
Load	0.0 PLF
Yield Limit per Foot	163.7 PLF
Yield Limit per Fastener	81.9 lb.
C _m	1
Yield Mode	IV
Edge Distance	1 1/2"
Min. End Distance	3"
Load Combination	
Duration Factor	1.00

Notes

Calculated Structural Designs is responsible only of the structural adequacy of this component based on the design criteria and loadings shown. It is the responsibility of the customer and/or the contractor to ensure the component suitability of the intended application, and to verify the dimensions and loads.

Lumber

1. Dry service conditions, unless noted otherwise
2. LVL not to be treated with fire retardant or corrosive

chemicals

Handling & Installation

1. LVL beams must not be cut or drilled
2. Refer to manufacturer's product information regarding installation requirements, multi-ply fastening details, beam strength values, and code approvals
3. Damaged Beams must not be used
4. Design assumes top edge is laterally restrained
5. Provide lateral support at bearing points to avoid lateral displacement and rotation

6. For flat roofs provide proper drainage to prevent ponding

This design is valid until 6/28/2026

Manufacturer Info

Metsä Wood
301 Merritt 7 Building, 2nd Floor
Norwalk, CT 06851
(800) 622-5850
www.metsawood.com/us



Client: Signature Homes
Project:
Address:

Date: 3/12/2025
Input by: Anthony Williams
Job Name: Lot 4 Mabry Ridge
Project #: J0325-1367

Page 7 of 10

GDH-18 Kerto-S LVL 1.750" X 14.000" 2-Ply - PASSED

Level: Level

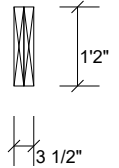
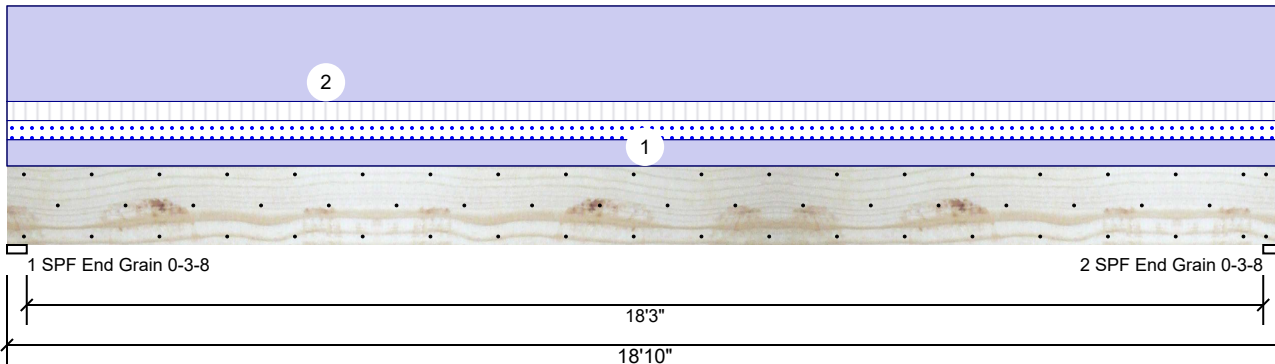

Member Information

Type:	Girder	Application:	Floor
Plies:	2	Design Method:	ASD
Moisture Condition:	Dry	Building Code:	IBC/IRC 2015
Deflection LL:	480	Load Sharing:	No
Deflection TL:	360	Deck:	Not Checked
Importance:	Normal - II		
Temperature:	Temp <= 100°F		

Reactions UNPATTERNED lb (Uplift)

Brg	Direction	Live	Dead	Snow	Wind	Const
1	Vertical	377	2504	377	0	0
2	Vertical	377	2504	377	0	0

Bearings

Bearing	Length	Dir.	Cap.	React D/L lb	Total	Ld. Case	Ld. Comb.
1 - SPF End Grain	3.500"	Vert	30%	2504 / 565	3069	L	D+0.75(L+S)
2 - SPF End Grain	3.500"	Vert	30%	2504 / 565	3069	L	D+0.75(L+S)

Analysis Results

Analysis	Actual	Location	Allowed	Capacity	Comb.	Case
Moment	12910 ft-lb	9'5"	26999 ft-lb	0.478 (48%)	D+L	L
Unbraced	13754 ft-lb	9'5"	13784 ft-lb	0.998 (100%)	D+0.75(L+S)	L
Shear	2447 lb	1'5 1/2"	10453 lb	0.234 (23%)	D+L	L
LL Defl inch	0.102 (L/2160)	9'5 1/16"	0.459 (L/480)	0.222 (22%)	0.75(L+S)	L
TL Defl inch	0.555 (L/398)	9'5 1/16"	0.612 (L/360)	0.905 (91%)	D+0.75(L+S)	L

Design Notes

- 1 Provide support to prevent lateral movement and rotation at the end bearings. Lateral support may also be required at the interior bearings by the building code.
- 2 Fasten all plies using 3 rows of 10d Box nails (.128x3") at 12" o.c. Maximum end distance not to exceed 6".
- 3 Refer to last page of calculations for fasteners required for specified loads.
- 4 Girders are designed to be supported on the bottom edge only.
- 5 Top loads must be supported equally by all plies.
- 6 Top must be laterally braced at a maximum of 7'5 9/16" o.c.
- 7 Bottom must be laterally braced at end bearings.
- 8 Lateral slenderness ratio based on single ply width.

ID	Load Type	Location	Trib Width	Side	Dead 0.9	Live 1	Snow 1.15	Wind 1.6	Const. 1.25	Comments
1	Uniform			Top	55 PLF	40 PLF	40 PLF	0 PLF	0 PLF	R + F
2	Uniform			Top	200 PLF	0 PLF	0 PLF	0 PLF	0 PLF	WALL
	Self Weight				11 PLF					

Notes

Calculated Structural Designs is responsible only of the structural adequacy of this component based on the design criteria and loadings shown. It is the responsibility of the customer and/or the contractor to ensure the component suitability of the intended application, and to verify the dimensions and loads.

Lumber

1. Dry service conditions, unless noted otherwise
2. LVL not to be treated with fire retardant or corrosive

chemicals

Handling & Installation

1. LVL beams must not be cut or drilled
2. Refer to manufacturer's product information regarding installation requirements, multi-ply fastening details, beam strength values, and code approvals
3. Damaged Beams must not be used
4. Design assumes top edge is laterally restrained
5. Provide lateral support at bearing points to avoid lateral displacement and rotation

6. For flat roofs provide proper drainage to prevent ponding

This design is valid until 6/28/2026

Manufacturer Info

Metsä Wood
301 Merritt 7 Building, 2nd Floor
Norwalk, CT 06851
(800) 622-5850
www.metsawood.com/us



Client: Signature Homes
Project:
Address:

Date: 3/12/2025
Input by: Anthony Williams
Job Name: Lot 4 Mabry Ridge
Project #: J0325-1367

Page 8 of 10

GDH-18 Kerto-S LVL 1.750" X 14.000" 2-Ply - PASSED

Level: Level

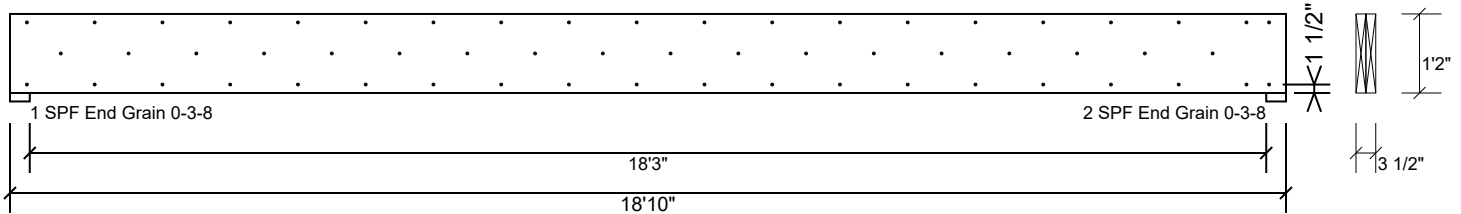

Multi-Ply Analysis

Fasten all plies using 3 rows of 10d Box nails (.128x3") at 12" o.c.. Maximum end distance not to exceed 6".

Capacity	0.0 %
Load	0.0 PLF
Yield Limit per Foot	245.6 PLF
Yield Limit per Fastener	81.9 lb.
C _m	1
Yield Mode	IV
Edge Distance	1 1/2"
Min. End Distance	3"
Load Combination	
Duration Factor	1.00

Notes

Calculated Structural Designs is responsible only of the structural adequacy of this component based on the design criteria and loadings shown. It is the responsibility of the customer and/or the contractor to ensure the component suitability of the intended application, and to verify the dimensions and loads.

Lumber

1. Dry service conditions, unless noted otherwise
2. LVL not to be treated with fire retardant or corrosive

chemicals

Handling & Installation

1. LVL beams must not be cut or drilled
2. Refer to manufacturer's product information regarding installation requirements, multi-ply fastening details, beam strength values, and code approvals
3. Damaged Beams must not be used
4. Design assumes top edge is laterally restrained
5. Provide lateral support at bearing points to avoid lateral displacement and rotation

6. For flat roofs provide proper drainage to prevent ponding

This design is valid until 6/28/2026

Manufacturer Info

Metsä Wood
301 Merritt 7 Building, 2nd Floor
Norwalk, CT 06851
(800) 622-5850
www.metsawood.com/us



Client: Signature Homes
Project:
Address:

Date: 3/12/2025
Input by: Anthony Williams
Job Name: Lot 4 Mabry Ridge
Project #: J0325-1367

Page 9 of 10

GDH-9 Kerto-S LVL 1.750" X 11.875" 2-Ply - PASSED

Level: Level

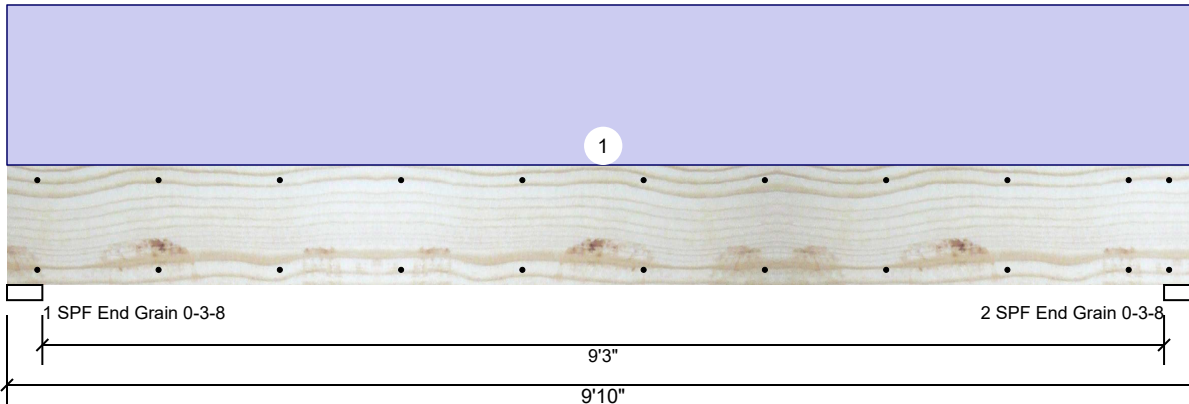

Member Information

Type: Girder
Plies: 2
Moisture Condition: Dry
Deflection LL: 480
Deflection TL: 360
Importance: Normal - II
Temperature: Temp <= 100°F

Application: Floor
Design Method: ASD
Building Code: IBC/IRC 2015
Load Sharing: No
Deck: Not Checked

Reactions UNPATTERNED lb (Uplift)

Brg	Direction	Live	Dead	Snow	Wind	Const
1	Vertical	0	517	0	0	0
2	Vertical	0	517	0	0	0

Bearings

Bearing	Length	Dir.	Cap.	React D/L lb	Total	Ld. Case	Ld. Comb.
1 - SPF End Grain	3.500"	Vert	5%	517 / 0	517	Uniform	D
2 - SPF End Grain	3.500"	Vert	5%	517 / 0	517	Uniform	D

Analysis Results

Analysis	Actual	Location	Allowed	Capacity	Comb.	Case
Moment	1156 ft-lb	4'11"	17919 ft-lb	0.065 (6%)	D	Uniform
Unbraced	1156 ft-lb	4'11"	9664 ft-lb	0.120 (12%)	D	Uniform
Shear	392 lb	8'6 5/8"	7980 lb	0.049 (5%)	D	Uniform
LL Defl inch	0.000 (L/999)	0	999.000 (L/0)	0.000 (0%)		
TL Defl inch	0.022 (L/5130)	4'11"	0.312 (L/360)	0.070 (7%)	D	Uniform

Design Notes

- 1 Provide support to prevent lateral movement and rotation at the end bearings. Lateral support may also be required at the interior bearings by the building code.
- 2 Fasten all plies using 2 rows of 10d Box nails (.128x3") at 12" o.c. Maximum end distance not to exceed 6".
- 3 Refer to last page of calculations for fasteners required for specified loads.
- 4 Girders are designed to be supported on the bottom edge only.
- 5 Top loads must be supported equally by all plies.
- 6 Top must be laterally braced at end bearings.
- 7 Bottom must be laterally braced at end bearings.
- 8 Lateral slenderness ratio based on single ply width.

ID	Load Type	Location	Trib Width	Side	Dead 0.9	Live 1	Snow 1.15	Wind 1.6	Const. 1.25	Comments
1	Uniform			Top	96 PLF	0 PLF	0 PLF	0 PLF	0 PLF	Wall
	Self Weight				9 PLF					

Notes

Calculated Structural Designs is responsible only of the structural adequacy of this component based on the design criteria and loadings shown. It is the responsibility of the customer and/or the contractor to ensure the component suitability of the intended application, and to verify the dimensions and loads.

Lumber

1. Dry service conditions, unless noted otherwise
2. LVL not to be treated with fire retardant or corrosive

chemicals

Handling & Installation

1. LVL beams must not be cut or drilled
2. Refer to manufacturer's product information regarding installation requirements, multi-ply fastening details, beam strength values, and code approvals
3. Damaged Beams must not be used
4. Design assumes top edge is laterally restrained
5. Provide lateral support at bearing points to avoid lateral displacement and rotation

6. For flat roofs provide proper drainage to prevent ponding

This design is valid until 6/28/2026

Manufacturer Info

Metsä Wood
301 Merritt 7 Building, 2nd Floor
Norwalk, CT 06851
(800) 622-5850
www.metsawood.com/us



Client: Signature Homes
Project:
Address:

Date: 3/12/2025
Input by: Anthony Williams
Job Name: Lot 4 Mabry Ridge
Project #: J0325-1367

Page 10 of 10

GDH-9 Kerto-S LVL 1.750" X 11.875" 2-Ply - PASSED

Level: Level

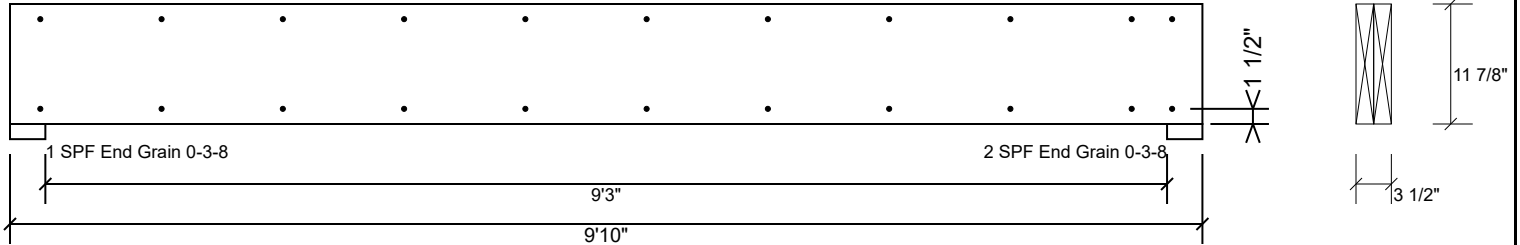

Multi-Ply Analysis

Fasten all plies using 2 rows of 10d Box nails (.128x3") at 12" o.c.. Maximum end distance not to exceed 6".

Capacity	0.0 %
Load	0.0 PLF
Yield Limit per Foot	163.7 PLF
Yield Limit per Fastener	81.9 lb.
C _m	1
Yield Mode	IV
Edge Distance	1 1/2"
Min. End Distance	3"
Load Combination	
Duration Factor	1.00

Notes

Calculated Structural Designs is responsible only of the structural adequacy of this component based on the design criteria and loadings shown. It is the responsibility of the customer and/or the contractor to ensure the component suitability of the intended application, and to verify the dimensions and loads.

Lumber

1. Dry service conditions, unless noted otherwise
2. LVL not to be treated with fire retardant or corrosive

chemicals

Handling & Installation

1. LVL beams must not be cut or drilled
2. Refer to manufacturer's product information regarding installation requirements, multi-ply fastening details, beam strength values, and code approvals
3. Damaged Beams must not be used
4. Design assumes top edge is laterally restrained
5. Provide lateral support at bearing points to avoid lateral displacement and rotation

6. For flat roofs provide proper drainage to prevent ponding

This design is valid until 6/28/2026

Manufacturer Info

Metsä Wood
301 Merritt 7 Building, 2nd Floor
Norwalk, CT 06851
(800) 622-5850
www.metsawood.com/us