



ECS Southeast, LLC
 6151 Raeford Road, Suite A
 Fayetteville, NC 28304
T 910.401.3288
F 910.323.0539

LETTER OF TRANSMITTAL

June 18, 2025
 Onsite Homes NC
 2931 Breezewood Ave STE 202
 Fayetteville, NC 28303
 ATTN: Chris Greene

RE: **HA 177 Stemwall**
 ECS Job # **33:7012-A6**
 Permits:
 Location: **Graham Road**
Cameron, NC 28326

☒ Field Reports ☒ For your use ☒ As requested

CC:

ENCL: Field Report # 1 6/17/2025

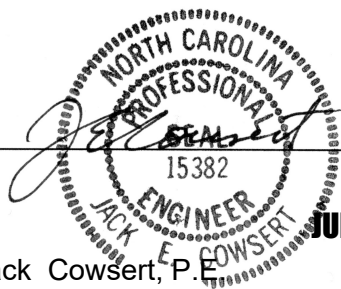

Jack Cowsert, P.E.
 Office Manager

Aaron Kyle Adair
 CMT Senior Project Coordinator

Disclaimer

1. This report (and any attachments) shall not be reproduced except in full without prior written approval of ECS.
2. The information in this report relates only to the activities performed on the report date.
3. Where appropriate, this report includes statements as to compliance with applicable project drawings, and specifications for the activities, performed on this report date.
4. Incomplete or non-conforming work will be reported for future resolution.
5. The results of samples and/or specimens obtained or prepared for subsequent laboratory testing will be presented in separate reports/documents.



ECS Southeast, LLC
 6151 Raeford Road, Suite A
 Fayetteville, NC 28304
 T 910.401.3288
 F 910.323.0539

FIELD REPORT

Project **HA 177 Stemwall**
 Location **Cameron, NC**
 Client **Onsite Homes NC**
 Contractor **Onsite Homes NC**

Project No. **33:7012-A6**
 Report No. **1**
 Day & Date **Tuesday 6/17/2025**
 Weather **78 °/ Clear**
 On-Site Time **1.50**
 Lab Time **0.00**
 Travel Time* **0.00**
 Total **1.50**
 Re Obs Time **0.00**

Remarks

Trip Charges*	Tolls/Parking*	Mileage*	Time of Arrival	Departure
Chargeable Items			9:00A	10:30A

* Travel time and mileage will be billed in accordance with the contract.

Summary of Services Performed (field test data, locations, elevations & depths are estimates) & Individuals Contacted.

ECS arrived on site, as requested, to check the bearing capacity of soils via hand auger/DCP method (ASTM STP-399) for stem wall backfill. Please see the attached sketch and data sheet for details.

A total of 3 hand auger/DCP evaluations were performed to a depth of approximately 4 feet below the current footing sub grade elevation. The test results indicated that the materials in place (at the locations and elevations tested) did appear to be suitable to support the design bearing capacity of 2,000 psf.

ECS will return upon request to provide additional services.

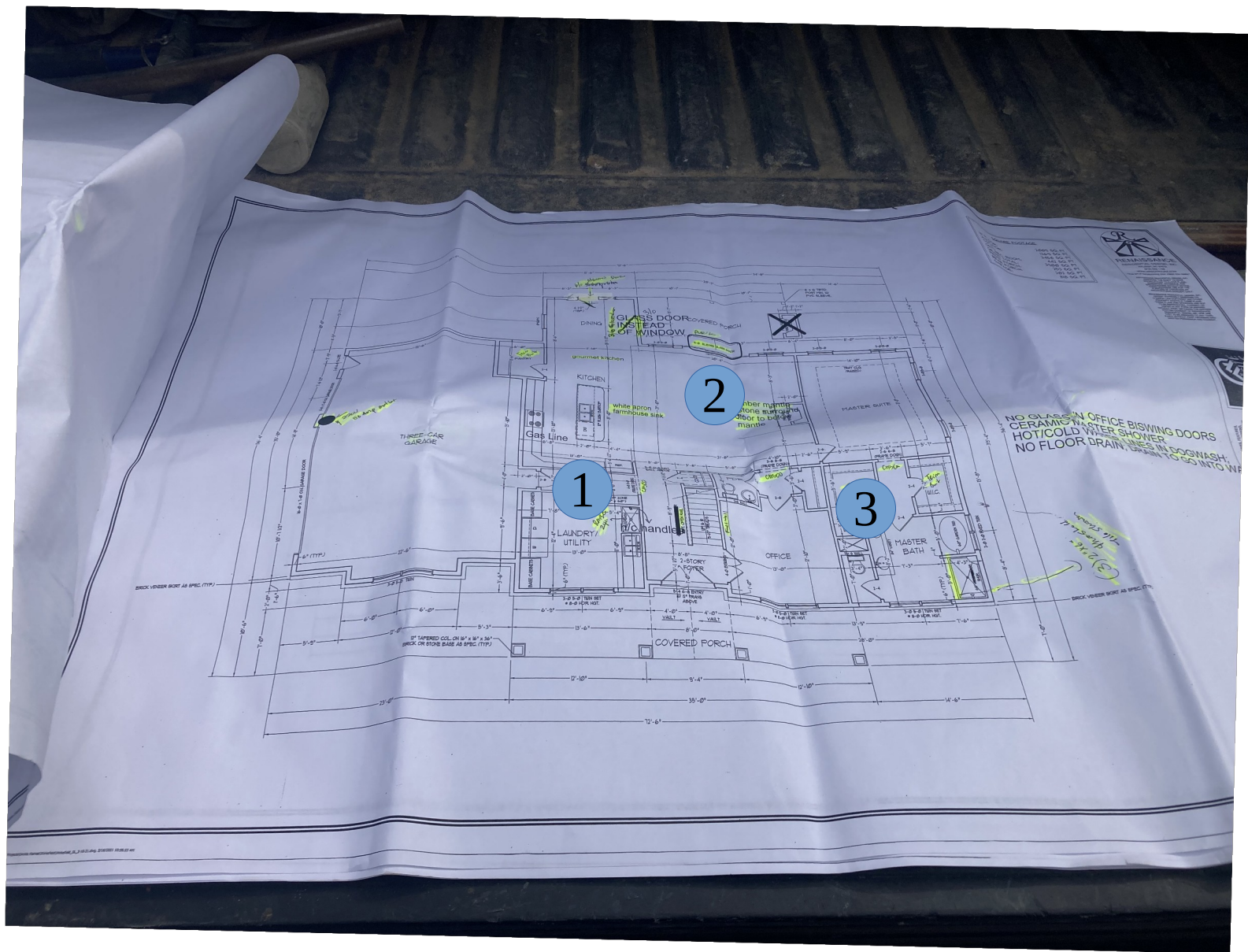

Andrew Gomez
6/17/2025
177 graham mills ln,
Cameron 28326
Proj #: 7012-A6
W/O # 85263

Key (NTS)
DCP
Test Location:

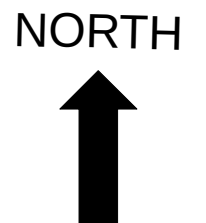



Andrew Gomez
6/17/2025
177 graham mills ln,
Cameron 28326
Proj #: 7012-A6
W/O # 85263

Key (NTS)
DCP
Test Location:



NORTH

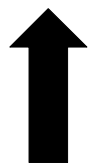



Report of Foundation Observations

Project: HA 177 Stemwall
 Location: Graham Road
 Cameron - Harnett County - NC - 28326

ECS Project No. : 33:7012-A6
 Date: 6/17/2025

General Location: 177 graham mills ln, cameron 28326
 Footing Type: spread

Design Bearing Pressure: 2000

Test No.	Location	Size			Footing Bottom Elevation		Depth of Undercut	Description of Steel Placed	Description of Foundation Subgrade Material	Depth of Test*	Number of Blows
			Design	Actual	Design	Actual**					
1	south west center	W	0' 0"	0' 0"			0' 0"		brown soil	-1 bcs	12,15+
		D	0' 0"	0' 0"						-2 bcs	15+
		L	0' 0"	0' 0"						-3 bcs	10,12,15+
										-3 bcs	15+
2	north center	W	0' 0"	0' 0"			0' 0"		brown soil	-1 bs	7,10,10
		D	0' 0"	0' 0"						-2 bcs	14,15+
		L	0' 0"	0' 0"						-3 bcs	15+
										-3 bcs	15+
3	south east center	W	0' 0"	0' 0"			0' 0"		brown soil	-1 bs	15+
		D	0' 0"	0' 0"						-2 bcs	10,14,15+
		L	0' 0"	0' 0"						-3 bcs	15+
										-4 bcs	15+

* Depth of DCP, or other methods of determining the soil stiffness

** Subgrade elevation reported by any means the contractor provided

By: Andrew N Gomez

ECS Southeast, LLC

WO: 85263