

I, Robert E. Leach, II, certify that this plat was drawn under my supervision from an actual survey made under my supervision, that the ratio of precision as calculated by latitude and departures is 1/10,000, that the boundaries not surveyed are shown as broken lines plotted from information found in Map Book ____ Page ____;

I further certify that this survey is of an existing parcel or parcels of land. Witness my original signature, license number and seal, this the 27th day of January, 2025.

Robert E. Leach, II, Professional Land Surveyor
License Number L-4869

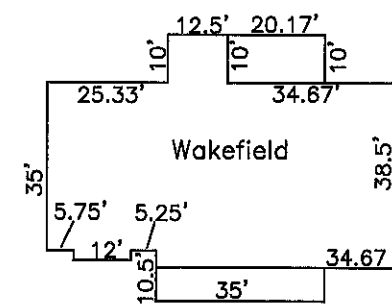
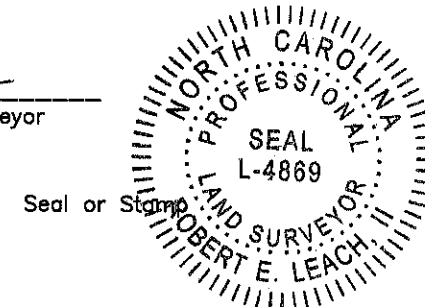

VICINITY MAP

IMPERVIOUS CALCULATIONS:

Total Lot area: 443,985 sq'
Total Impervious area: 5,178 sq'
% of total area= 1.1662%

Lot Information:

Address: TBD
PIN# 9575-01-0287 (portion of)

SITE PLAN LOT 8 FOR ON SITE HOMES JOHNSONVILLE TOWNSHIP

HARNETT COUNTY

DATE 01/27/2025

SURVEYED BY :

DRAWING NO. 2025011A

NORTH CAROLINA

SCALE 1" = 100 FEET

ROBERT E. LEACH, II

HASTY LAND SURVEYING, PLLC
102 SHANNON ROAD
RED SPRINGS, NC 28377
(910) 843-4510
FIRM LIC# P-1406

