



ECS Southeast, LLC
 6151 Raeford Road, Suite A
 Fayetteville, NC 28304
T 910.401.3288
F 910.323.0539

LETTER OF TRANSMITTAL

May 16, 2025
 Precision Custom Homes

Raeford, NC 28376
 ATTN: Shaun Gardner

RE: **Magnolia Hills Subdivision - Lot 18**
 ECS Job # **33:7095-Z1**

Permits:
 Location: **359 Persimmon Tree Drive**
Cameron, NC 28326

☒ Field Reports ☒ For your use ☒ As requested

CC: Precision Custom Homes - Allen Peterson Precision Custom Homes - Lauren Ceruti

ENCL: Field Report # 2 5/15/2025

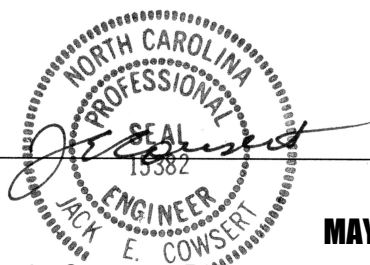

Jack Cowsert, P.E.
 Office Manager

MAY 16 2025

Aaron Kyle Adair
 CMT Senior Project Coordinator

Disclaimer

1. This report (and any attachments) shall not be reproduced except in full without prior written approval of ECS.
2. The information in this report relates only to the activities performed on the report date.
3. Where appropriate, this report includes statements as to compliance with applicable project drawings, and specifications for the activities, performed on this report date.
4. Incomplete or non-conforming work will be reported for future resolution.
5. The results of samples and/or specimens obtained or prepared for subsequent laboratory testing will be presented in separate reports/documents.



ECS Southeast, LLC
 6151 Raeford Road, Suite A
 Fayetteville, NC 28304
 T 910.401.3288
 F 910.323.0539

FIELD REPORT

Project **Magnolia Hills Subdivision - Lot 18**
 Location **Cameron, NC**
 Client **Precision Custom Homes**
 Contractor **Precision Custom Homes**

Project No. **33:7095-Z1**
 Report No. **2**
 Day & Date **Thursday 5/15/2025**
 Weather **84 °/ Partly Cloudy**
 On-Site Time **1.25**
 Lab Time **0.00**
 Travel Time* **0.00**
 Total **1.25**
 Re Obs Time **0.00**

Remarks

Trip Charges*	Tolls/Parking*	Mileage*	Time of Arrival	Departure
Chargeable Items			1:30P	2:45P

* Travel time and mileage will be billed in accordance with the contract.

Summary of Services Performed (field test data, locations, elevations & depths are estimates) & Individuals Contacted.

ECS arrived on site, as requested, to check the bearing capacity of soils via hand auger/DCP method (ASTM STP-399) for foundation footings. Please see the attached sketch and data sheet for details.

A total of 4 hand auger/DCP evaluations were performed to a depth of approximately 4 feet below the current footing sub grade elevation. The test results indicated that the materials in place (at the locations and elevations tested) did appear to be suitable to support the design bearing capacity of 2,000 psf, however, the soils encountered at locations 3 and 4 at elevations of -2 to -4 below the current subgrade appeared to be a potentially highly plastic (fat) Grey Clay.

A sample of the encountered soils was collected for testing in our laboratory to assess the potential for expansion, and a recommendation will be made on the suitability of the soils pending the test results.

ECS will return upon request to provide additional services.

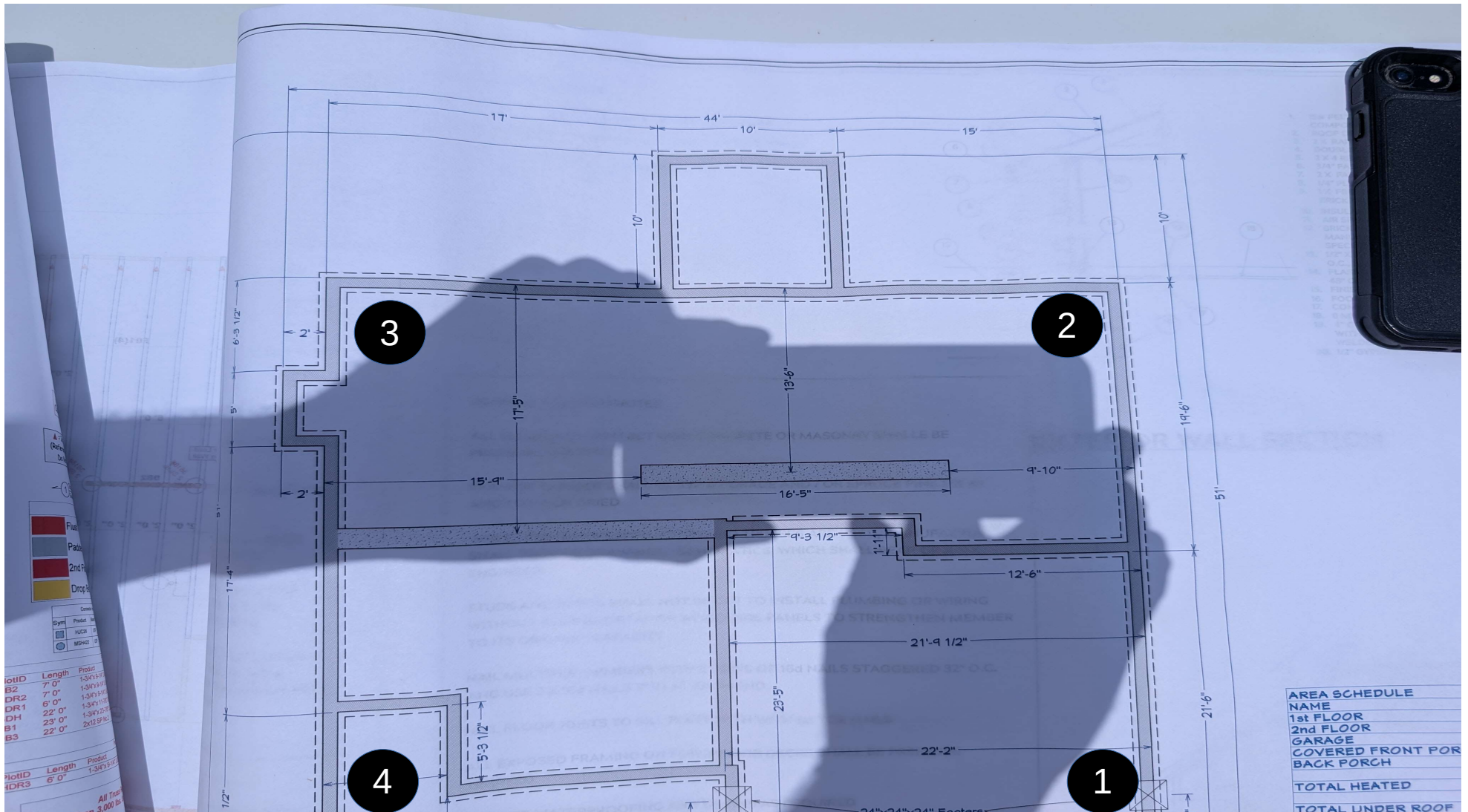

Jacob Jackson
 05/15/2025
 Mangolia Hills Lo t18
 Proj #: 7095 - Z1
 W/O # 84623

Key (NTS)
 DCP Test Locations



NORTH





Report of Foundation Observations

Project: Magnolia Hills Subdivision - Lot 18

Location: 359 Persimmon Tree Drive
Cameron - Harnett - NC - 28326

ECS Project No. :

33:7095-Z1

Date:

5/15/2025

General Location: Building Pad

Footing Type: Continuous

Design Bearing Pressure:

2000

Test No.	Location	Size			Footing Bottom Elevation		Depth of Undercut	Description of Steel Placed	Description of Foundation Subgrade Material	Depth of Test*	Number of Blows
			Design	Actual	Design	Actual**					
1	SE Corner	W	0' 0"	0' 0"	0		0' 0"		(-1) Brown Clayey Sand (-2- -4) Tan Sand	-1	6, 10, 9
		D	0' 0"	0' 0"						-2	6, 6, 6
		L	0' 0"	0' 0"						-3	5, 7, 7
										-4	15
2	NE Corner	W	0' 0"	0' 0"	0		0' 0"		(-1) Brown Clayey Sand (-2- -4) Tan Sand	-1	5, 4, 5
		D	0' 0"	0' 0"						-2	11, 9, 8
		L	0' 0"	0' 0"						-3	8, 7, 7
										-4	15
3	NW Corner	W	0' 0"	0' 0"	0		0' 0"		(-1) Orange Clayey Sand (-2- -4) Grey Clay	-1	10, 9, 10
		D	0' 0"	0' 0"						-2	12, 10, 10
		L	0' 0"	0' 0"						-3	11, 12, 11
										-4	15
4	SW Corner	W	0' 0"	0' 0"	0		0' 0"		(-1- -2) Grey Clayey Sand (-3- -4) Grey Clay	-1	11, 12, 13
		D	0' 0"	0' 0"						-2	10, 11, 10
		L	0' 0"	0' 0"						-3	14, 13, 11
										-4	15

* Depth of DCP, or other methods of determining the soil stiffness

** Subgrade elevation reported by any means the contractor provided

By: Jacob D Jackson

ECS Southeast, LLC

WO: 84623

Attachments



Job Site

Figure 1