



ECS Southeast, LLC
6151 Raeford Road, Suite A
Fayetteville, NC 28304
T 910.401.3288
F 910.323.0539

LETTER OF TRANSMITTAL

June 09, 2025
Wellco Contractors Inc
511 Hwy 210 North
Spring Lake, NC 28390
ATTN: Cliff McLamb

RE: **Hidden Lakes North- Lot 102**
ECS Job # **33:7257-G**

Permits:
Location: **2968 Docs Road**
Spring Lake, NC 28390

☒ Field Reports ☒ For your use ☒ As requested

CC:

ENCL: Field Report # 1 6/6/2025



Jack Cowsert, P.E.
Office Manager

JUN 09 2025

Ryan H. Parrish
CMT Group Supervisor

Disclaimer

1. This report (and any attachments) shall not be reproduced except in full without prior written approval of ECS.
2. The information in this report relates only to the activities performed on the report date.
3. Where appropriate, this report includes statements as to compliance with applicable project drawings, and specifications for the activities, performed on this report date.
4. Incomplete or non-conforming work will be reported for future resolution.
5. The results of samples and/or specimens obtained or prepared for subsequent laboratory testing will be presented in separate reports/documents.



ECS Southeast, LLC

6151 Raeford Road, Suite A

Fayetteville, NC 28304

T 910.401.3288

F 910.323.0539

FIELD REPORT

Project **Hidden Lakes North- Lot 102**
Location **Spring Lake, NC**
Client **Wellco Contractors Inc**
Contractor **None Listed**

Project No. **33:7257-G**
Report No. **1**
Day & Date **Friday 6/6/2025**
Weather **88 °/ Sunny**
On-Site Time **1.50**
Lab Time **0.00**
Travel Time* **0.00**
Total **1.50**
Re Obs Time **0.00**

Remarks

Trip Charges*	Tolls/Parking*	Mileage*	Time of Arrival	Departure
Chargeable Items			11:00A	12:30P

* Travel time and mileage will be billed in accordance with the contract.

Summary of Services Performed (field test data, locations, elevations & depths are estimates) & Individuals Contacted.

ECS arrived on site, as requested, to check the bearing capacity of soils via hand auger/DCP method (ASTM STP-399) for foundation footings.

Please see the attached sketch and data sheet for details.

A total of 4 hand auger/DCP evaluations were performed to a depth of approximately 4 feet below the current footing sub grade elevation. The test results indicated that the materials in place (at the locations and elevations tested) did appear to be suitable to support the design bearing capacity of 2,000 psf.

ECS will return upon request to provide additional services.

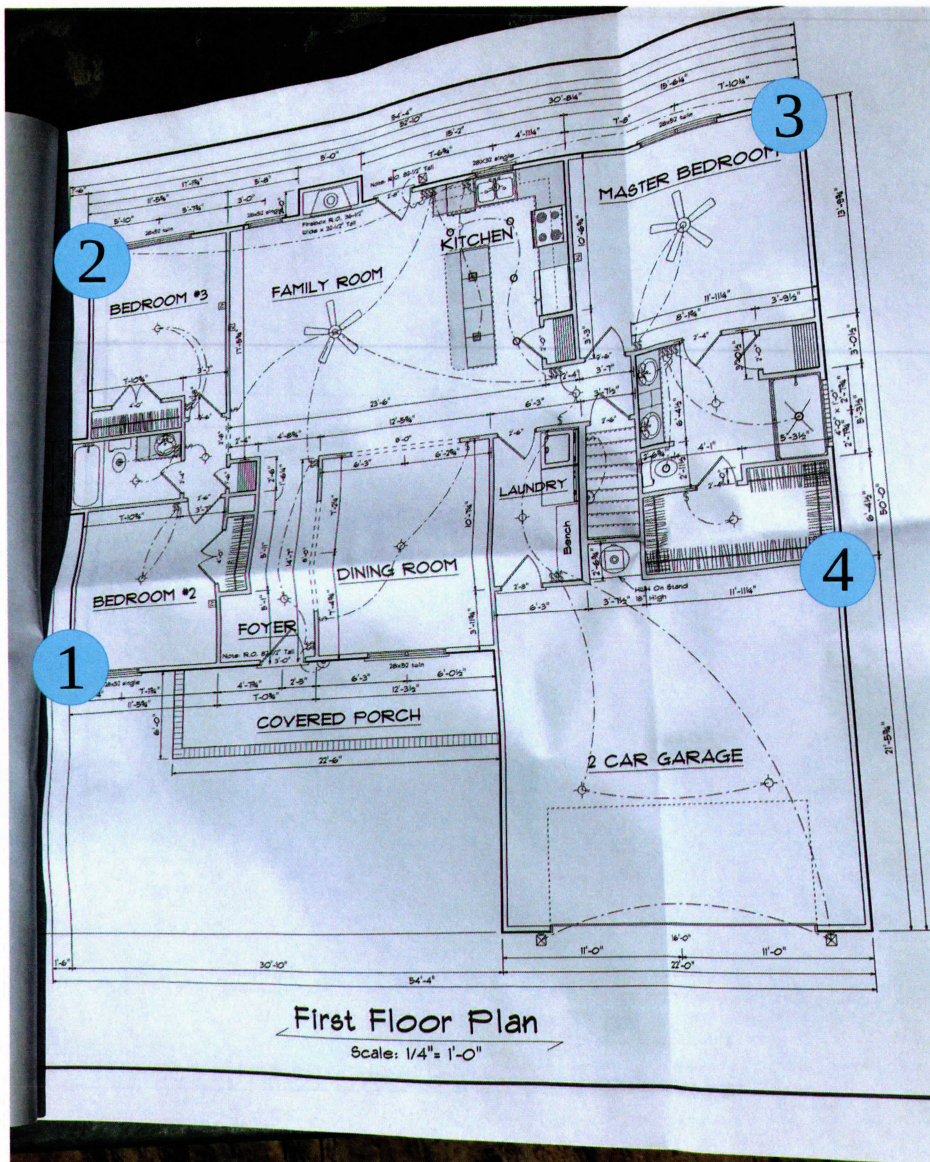

Andrew Gomez
6/06/2025
2968 Docs Road,
Spring Lake, NC 28390
Proj #: 7257-G
W/O # 85008

Key (NTS)
DCP inspection
Test Location:



NORTH





Report of Foundation Observations

Project: Hidden Lakes North- Lot 102
Location: 2968 Docs Road
Spring Lake - Cumberland - NC - 28390

ECS Project No. : 33:7257-G
Date: 6/6/2025

General Location: 2968 Docs Road, Spring Lake, NC 28390
Footing Type: continuous

Design Bearing Pressure: 2000

Test No.	Location	Size			Footing Bottom Elevation		Depth of Undercut	Description of Steel Placed	Description of Foundation Subgrade Material	Depth of Test*	Number of Blows
			Design	Actual	Design	Actual**					
1	south west corner	W	0' 0"	0' 0"			0' 0"			-1 BCS	7,7,7
		D	0' 0"	0' 0"						-2 BCS	6,6,8
		L	cont.	cont.						-3 BCS	10,15+
										-4 BCS	15+
2	north west corner	W	0' 0"	0' 0"			0' 0"			-1 BS	6,7,7
		D	0' 0"	0' 0"						-2 BS	8,10,10
		L	cont.	cont.						-3 BS	9,9,9
										-4 BS	12,15+
3	north east corner	W	0' 0"	0' 0"			0' 0"			-1 BCS	7,12,12
		D	0' 0"	0' 0"						-2 BCS	13,13,13
		L	cont.	cont.						-3 BCS	15+
										-4 BCS	15+
4	south east corner	W	0' 0"	0' 0"			0' 0"			-1 BCS	8,8,10
		D	0' 0"	0' 0"						-2 BCS	9,12,12
		L	cont.	cont.						-3 BCS	15+
										-4 BCS	15+

* Depth of DCP, or other methods of determining the soil stiffness
** Subgrade elevation reported by any means the contractor provided

By: Andrew N Gomez
ECS Southeast, LLC
WO: 85008