

Harnett County Department of Public Health

PERMIT # SFD 2504-0025Operation Permit☒ New Installation ☒ Septic Tank ☒ Nitrification Line ☐ Repair ☐ ExpansionPROPERTY LOCATION: SR 1532 OAKBROOK CHURCH RDName: (owner) Clayton Properties SUBDIVISION Cambridge Reserve LOT # 37System Installer: Bentley & SonsBasement with plumbing: ☐ Garage ☒ Number of Bedrooms 4Type of Water Supply: ☐ Community ☒ Public ☐ Well Distance from well _____ feetSystem Type: 25% REDUCED SYSTEM ~~OTHER~~ Types V and VI Systems expire in 5 years.

(In accordance with Table V a)

EZFDN ~~OTHER~~ Owner must contact Health Department 6 months prior to expiration for permit renewal.

This system has been installed in compliance with applicable North Carolina General Statutes, Rules for Sewage Treatment and Disposal, and all conditions of the Improvement Permit and Construction Authorization.

*LSS Permit

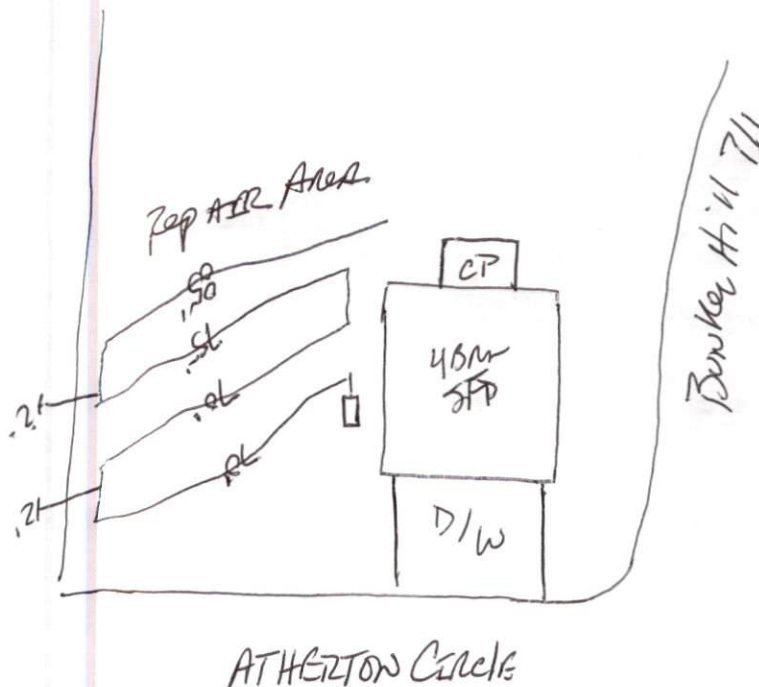

PERMIT CONDITIONS:

I. Performance: System shall perform in accordance with Rule .1961.

II. Monitoring: As required by Rule .1961.

III. Maintenance: As required by Rule .1961. Other: _____

Subsurface system operator required? Yes ☐ No ☐

If yes, see attached sheet for additional operation conditions, maintenance and reporting.

IV. Operation: _____

V. Other: _____

☐ _____ D-Box ☐ _____ Pump ☐ _____ Alarm ☐ _____ H2O Line ☐ _____ PWR Line

Following are the specifications for the sewage disposal system on the above captioned property.

Type of system: ☐ Conventional ☒ Other 25% REDUCED Septic Tank: 1000 gallons Pump Tank: _____ gallonsSubsurface No. of exact length width of depth of
Drainage Field ditches 1 of each ditch 300 feet ditches 3 feet ditches 18 inches

French Drain Required: _____ Linear feet

Authorized State Agent

James E. Marshall ~~SR 2504~~Date 6-16-25

PRELIMINARY PLOT PLAN FOR

LOT 37, CAMBRIDGE SUBDIVISION

18 ATHERTON CIRCLE

REF: P.B. 2025, PG.7

NEILL'S CREEK TOWNSHIP

HARNETT COUNTY, NORTH CAROLINA

FEBRUARY 12, 2025

ZONED RA-30

50 25 0 50 100

SCALE 1"=50'

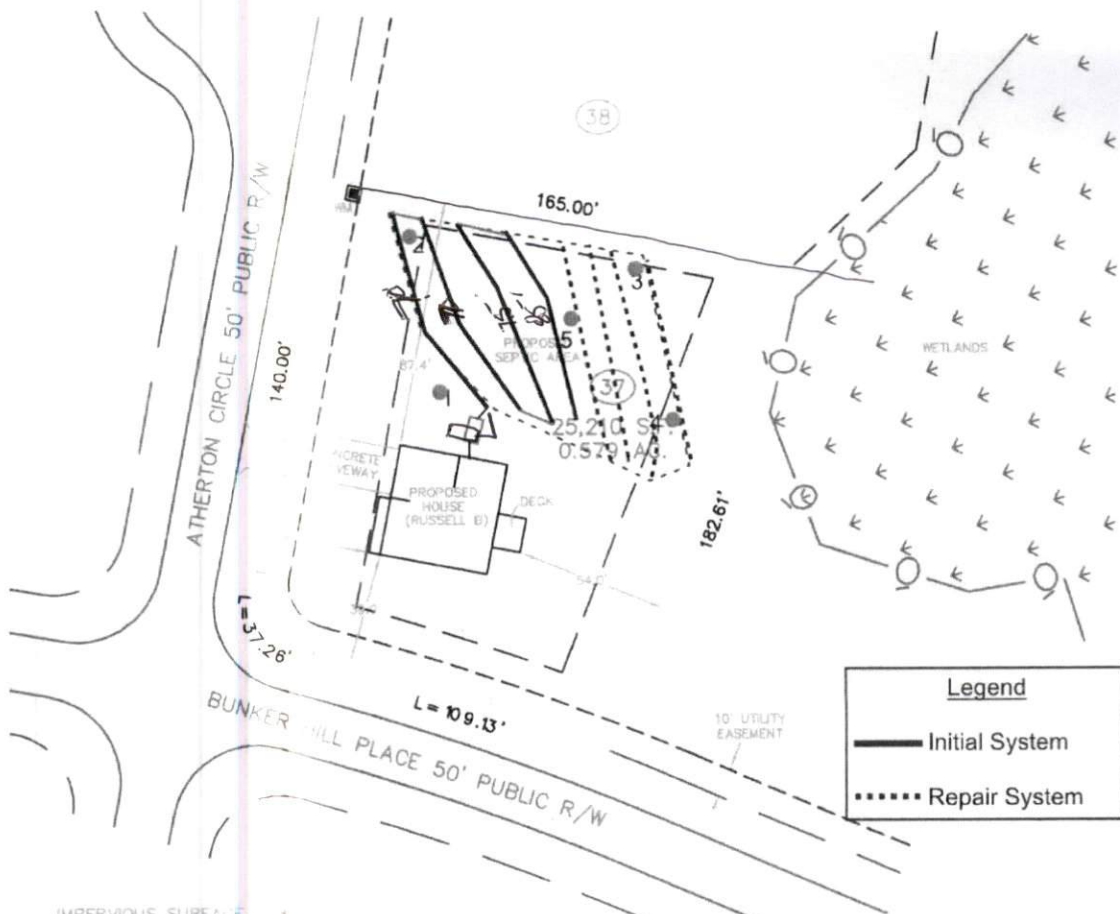

IMPERVIOUS SURFACE

HOUSE	
DECK	
DRIVEWAY	
SIDEWALKS	
MISC./UTILITIES	
TOTAL IMPERVIOUS AREA	
TOTAL LOT AREA	
PERCENTAGE OF IMPERVIOUS	

TOTAL CONCRETE & LANDSCAPE

CONCRETE	832 S.F.
LANDSCAPE	25,632 S.F.

THIS SURVEYOR DOES NOT WARRANTY THE ACCURACY OF ARCHITECTURAL DIMENSIONS. THEY ARE TO BE VERIFIED BY THE CONTRACTOR.

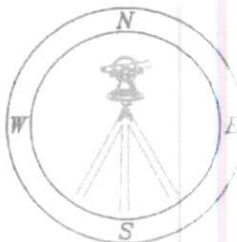

Professional Land Surveyors
C 1525
333 S. White Street
Post Office Box 1253
Lake Forest, N.C. 27586
(919)556-3148