

PRELIMINARY PLOT PLAN FOR

MUNGO HOMES

LOT 24, CAMBRIDGE SUBDIVISION

54 SAGAMORE AVENUE

REF: P.B. 2025, PG.7

NEILL’S CREEK TOWNSHIP

HARNETT COUNTY, NORTH CAROLINA

FEBRUARY 12, 2025

ZONED RA-30



SCALE 1"=50'

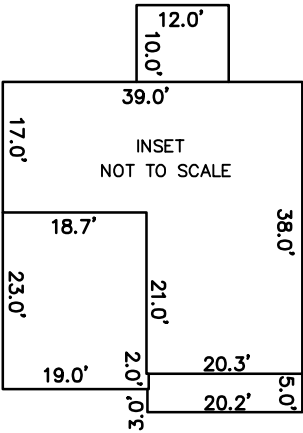
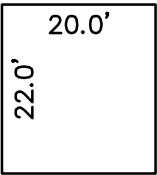

22

CAMBRIDGE  
RESERVE PH.1  
P.B. 2025, PG. 7

23

CAMBRIDGE  
RESERVE PH.1  
P.B. 2025, PG. 7

21

CAMBRIDGE  
RESERVE PH.1  
P.B. 2025, PG. 7

24

25,093 S.F.  
0.576 AC.

PROPOSED  
SEPTIC AREA

PATIO

PROPOSED  
HOUSE  
(RUSSELL C)

PROPOSED  
DETACHED  
GARAGE

CONCRETE  
DRIVEWAY

25

CAMBRIDGE  
RESERVE PH.1  
P.B. 2025, PG. 7

IMPERVIOUS SURFACE TABLE

HOUSE	1,620 S.F.
PATIO	120 S.F.
DRIVEWAY	1,414 S.F.
SIDEWALKS	39 S.F.
DETACHED GARAGE	440 S.F.
MISC/UTILITIES	9 S.F.
TOTAL IMPERVIOUS AREA	3,633 S.F.
TOTAL LOT AREA	25,093 S.F.
PERCENTAGE OF IMPERVIOUS AREA	14.47 %

TOTAL CONCRETE & LANDSCAPE	
CONCRETE	1,762 S.F.
LANDSCAPE	23,598 S.F.

THIS SURVEYOR DOES NOT  
WARRANTY THE ACCURACY  
OF ARCHITECTURAL DIMENSIONS.  
THEY ARE TO BE VERIFIED BY  
THE CONTRACTOR.

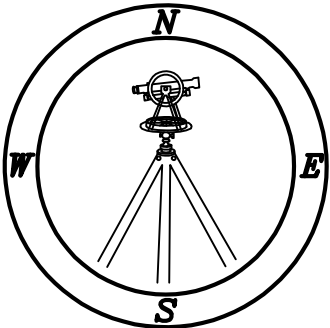

**CMP**

Professional Land Surveyors  
C-1525

333 S. White Street  
Post Office Box 1253  
Wake Forest, N.C. 27588  
(919)556-3148

NOTES:

—THIS PLAN DOES NOT REFLECT AN  
ACTUAL SURVEY. IT IS A PRELIMINARY  
PLAN AND SHOULD BE USED FOR ITS  
INTENDED PURPOSE ONLY.  
—NOT FOR RECORDATION, CONVEYANCES,  
OR SALES.