

# Harnett County Department of Public Health

PERMIT # SFD 2503-0146

## Operation Permit

☒ New Installation ☒ Septic Tank ☒ Nitrification Line ☐ Repair ☐ Expansion

PROPERTY LOCATION: 15 Celtic LN, Lillington

Name: (owner) DRB Group North Carolina SUBDIVISION Blake Pond LOT # 114

System Installer: Weather Master

Basement with plumbing: ☐ Garage ☒ Number of Bedrooms 4

Type of Water Supply: ☐ Community ☒ Public ☐ Well Distance from well \_\_\_\_\_ feet

System Type: 25% Reduction Type III (b) 24 chambers Types V and VI Systems expire in 5 years.

(In accordance with Table V a)

Owner must contact Health Department 6 months prior to expiration for permit renewal.

This system has been installed in compliance with applicable North Carolina General Statutes, Rules for Sewage Treatment and Disposal, and all conditions of the Improvement Permit and Construction Authorization.

\*Needs Septic  
Lines Installed  
\*Needs pump  
Alarm For Email

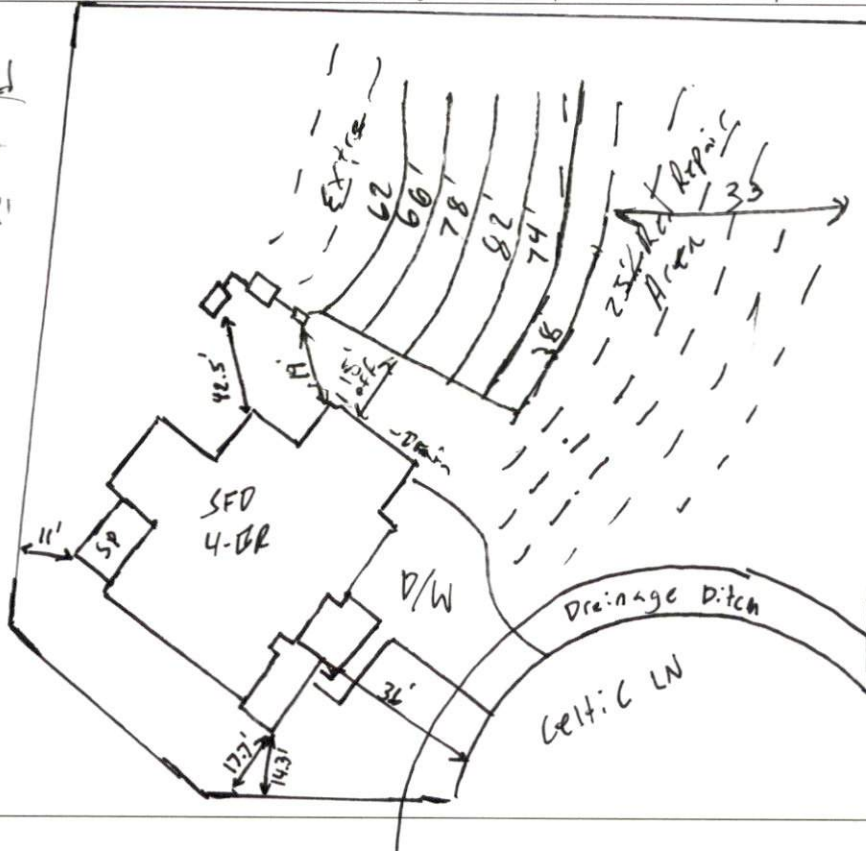

### PERMIT CONDITIONS:

I. Performance: System shall perform in accordance with Rule .1961.

II. Monitoring: As required by Rule .1961.

III. Maintenance: As required by Rule .1961. Other: \_\_\_\_\_

Subsurface system operator required? Yes ☐ No ☒

If yes, see attached sheet for additional operation conditions, maintenance and reporting.

IV. Operation: \_\_\_\_\_

V. Other: \_\_\_\_\_

☒ D-Box ☒ Pump ☒ Alarm ☐ H2O Line ☐ PWR Line

Following are the specifications for the sewage disposal system on the above captioned property.

Type of system: ☐ Conventional ☒ Other Type III (b) 24 chambers Septic Tank: 1,000 gallons Pump Tank: 1,000 gallons

Subsurface No. of \_\_\_\_\_ exact length \_\_\_\_\_ width of \_\_\_\_\_ depth of \_\_\_\_\_  
Drainage Field ditches 1 of each ditch 400' feet ditches 3' feet ditches 18'-20' inches

French Drain Required: \_\_\_\_\_ Linear feet

Authorized State Agent

*Moh R. RTH*

Date 11-12-25