

Harnett County Department of Public Health

PERMIT # SFD 2503-0114

Operation Permit

☒ New Installation ☒ Septic Tank ☒ Nitrification Line ☐ Repair ☐ Expansion

PROPERTY LOCATION: 17 Camp Rock Rd

Name: (owner) LGI Home SUBDIVISION Boone Trail Village Ph I LOT # 46

System Installer: Quality Septic

Basement with plumbing: ☐ Garage ☒ Number of Bedrooms 4 (8 people)

Type of Water Supply: ☐ Community ☒ Public ☐ Well Distance from well _____ feet

System Type: TYPE III B Types V and VI Systems expire in 5 years.

(In accordance with Table V a)

Owner must contact Health Department 6 months prior to expiration for permit renewal.

This system has been installed in compliance with applicable North Carolina General Statutes, Rules for Sewage Treatment and Disposal, and all conditions of the Improvement Permit and Construction Authorization.

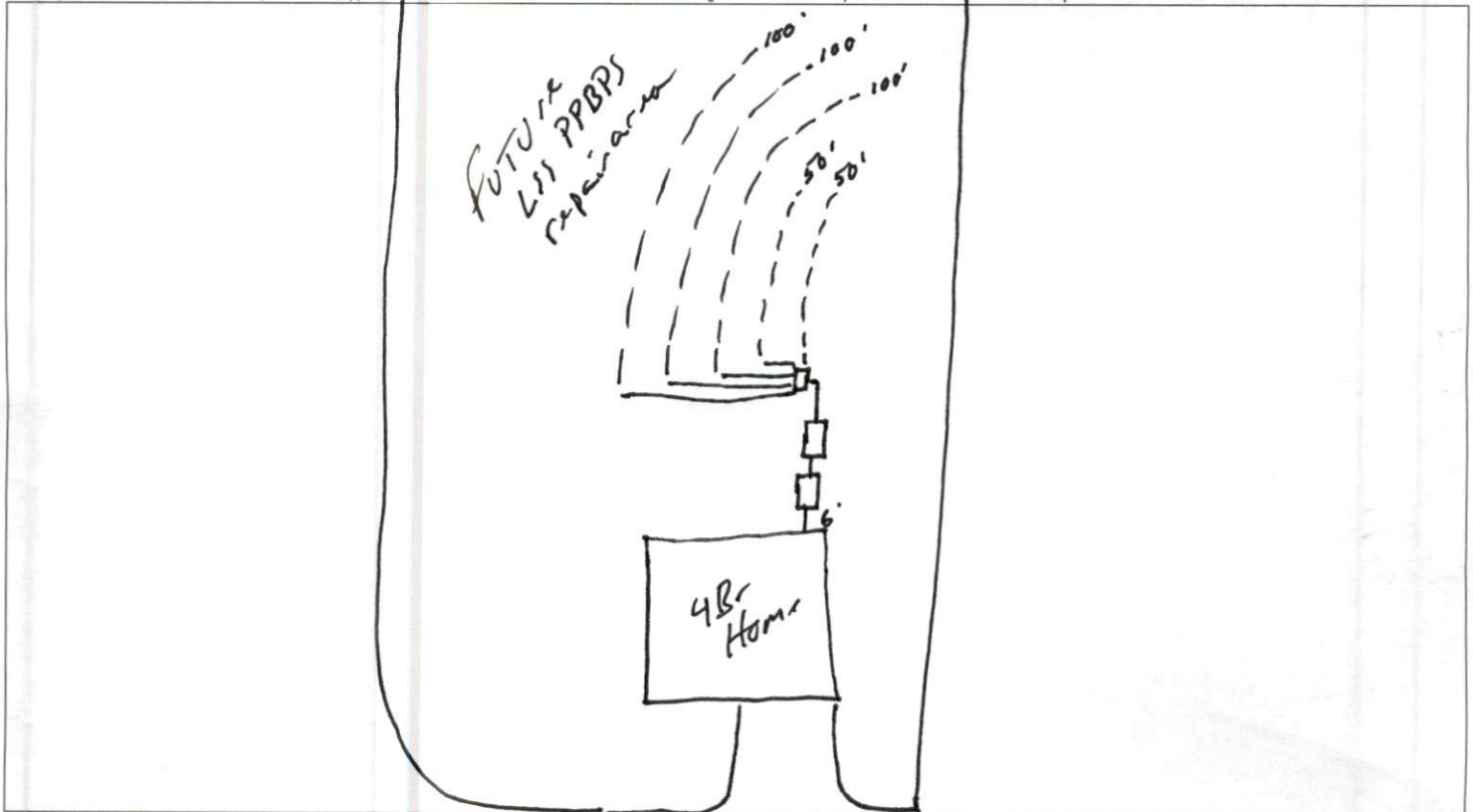

PERMIT CONDITIONS:

I. Performance: System shall perform in accordance with Rule .1961.

II. Monitoring: As required by Rule .1961.

III. Maintenance: As required by Rule .1961. Other: _____

Subsurface system operator required? Yes ☐ No ☒

If yes, see attached sheet for additional operation conditions, maintenance and reporting.

IV. Operation: _____

V. Other: _____

☐ Manifold D-Box ☒ Pump ☒ Alarm ☐ H2O Line ☐ PWR Line

Following are the specifications for the sewage disposal system on the above captioned property.

Type of system: ☐ Conventional ☒ Other 25% reduction (2 flow) Septic Tank: 1000 gallons Pump Tank: _____ gallons

Subsurface No. of exact length width of depth of
Drainage Field ditches 1 of each ditch 400 feet ditches 3 feet ditches 23 inches

French Drain Required: _____ Linear feet

Authorized State Agent

[Signature] REHS

Date 7-30-25

4-Bedroom
 LTAR: 0.3 gpd/ft²
 Initial: Pump-to-Innovative 25%
 Reduction Status Product utilizing
 lines 1-5 (400')
 Repair: Gravity-to-PPBPS utilizing
 lines 6-8 (270')

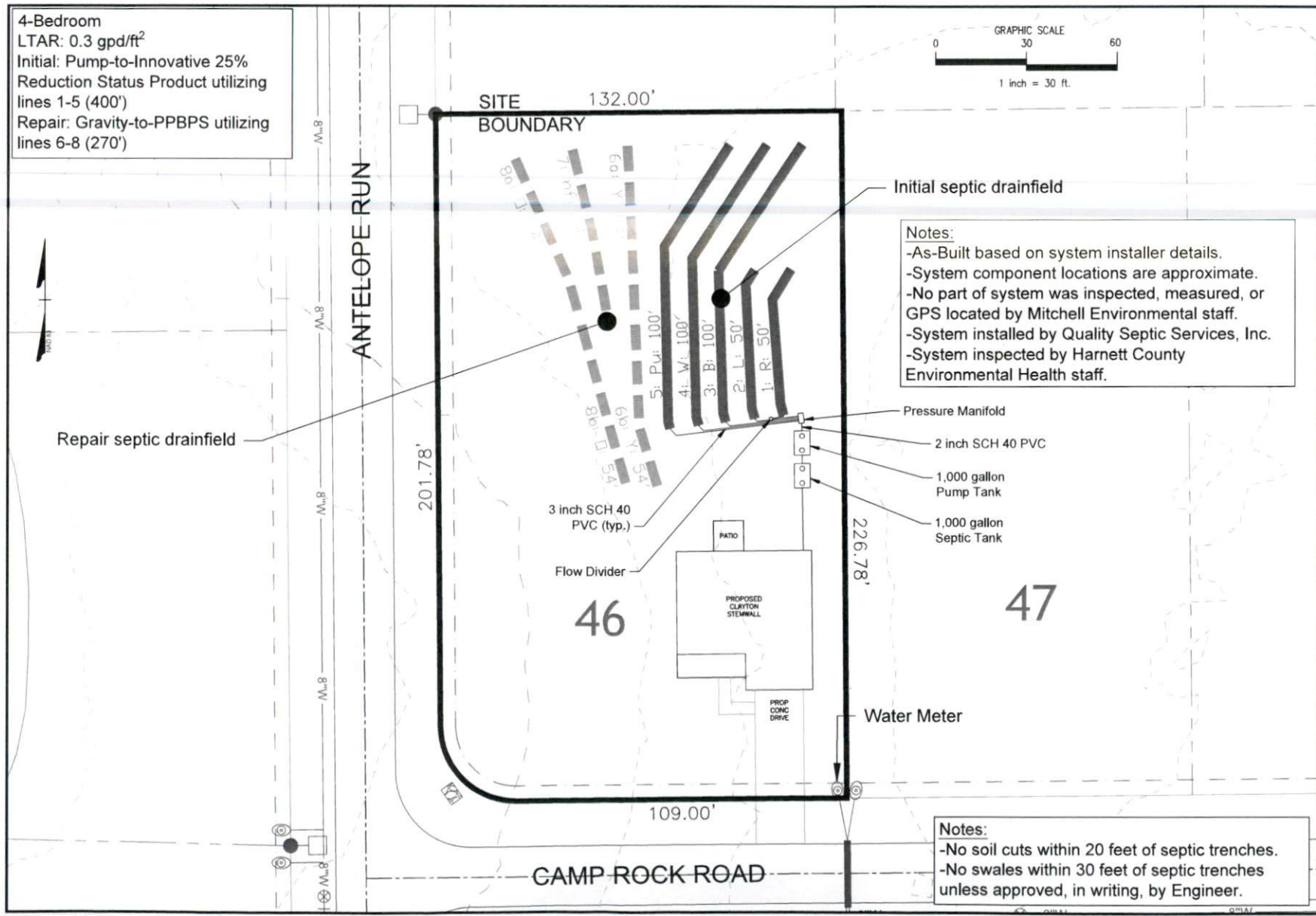
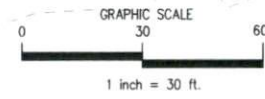

Notes:
 -As-Built based on system installer details.
 -System component locations are approximate.
 -No part of system was inspected, measured, or GPS located by Mitchell Environmental staff.
 -System installed by Quality Septic Services, Inc.
 -System inspected by Harnett County Environmental Health staff.

Notes:
 -No soil cuts within 20 feet of septic trenches.
 -No swales within 30 feet of septic trenches unless approved, in writing, by Engineer.

MITCHELL ENVIRONMENTAL, PA C-2911 1501 LAKESTONE VILLAGE LANE SUITE 205 FUQUAY VARINA, NC 27526		SHEET NUMBER 1 of 1	
		Boone Tract Village Lot 46 Overall Septic As-Built	
PREPARED FOR : LG Homes 5511 Capital Center Drive Raleigh, NC 27612		REVISION NO. Original Submittal	DATE July 29, 2025
DATE : July 29, 2025 DESIGNER CONTACT: ADAM AYCOCK, EI		Revision 1	---
DRAWN BY: SCOTT MITCHELL, PE, LSS		Revision 2	---
		Revision 3	---
		Master Set	---