

Owner: New Castle Applicant:

Address: 298 Dove Rd
Proposed Facility: CFB

Date Evaluated:
Design Flow (.1949): 360 GPD

Property Size:

Location of Site:

☒ Public ☐ Individual ☐ Well☐ Spring ☐ Other

Water Supply:

Evaluation Method: ☒ Auger Boring

☐ Pit ☐ Cut

Type of Wastewater:

☒ Sewage☐ Industrial Process☐ Mixed

Description	Initial System	Repair System	Other Factors (.1946): Site Classification (.1948): Evaluated By: <i>SMH RCH</i> Others Present:
Available Space (.1945)	<input checked="" type="checkbox"/>	<input checked="" type="checkbox"/>	
System Type(s)	<input checked="" type="checkbox"/>	<input checked="" type="checkbox"/>	
Site I.T.A.R.	.6	.6	

COMMENTS: _____

LANDSCAPE POSITIONS	GROUP	TEXTURES	.1955 LTAR	CONSISTENCE MOIST	WET
R-RIDGE	I	S-SAND	1.2 - 0.8	VFR-VERY FRIABLE FR-FRIABLE	NS-NON-STICKY
S-SHOULDER SLOPE		LS-LOAMY SAND			SS-SLIGHTLY STICKY
L-LINEAR SLOPE	II	SL-SANDY LOAM L-LOAM	0.8 - 0.6	FI-FIRM	S-STICKY
FS-FOOT SLOPE				VFI-VERY FIRM	VS-VERY STICKY
N-NOSE SLOPE				EFI-EXTREMELY FIRM	NP-NON-PLASTIC
H-HEAD SLOPE	III	SI-SILT	0.6 - 0.3		SP-SLIGHTLY STICKY
CC-CONCLAVE SLOPE		SIL-SILT LOAM			P-PLASTIC
CV-CONVEX SLOPE		CL-CLAY LOAM			VP-VERY PLASTIC
T-TERRACE		SCL-SANDY CLAY LOAM			
FP-FLOOD PLAN	IV	SIC-SILTY CLAY	0.4 - 0.1		
		C-CLAY			
		SC-SANDY CLAY			

STRUCTURE

SG-SINGLE GRAIN
M-MASSIVE
CR-CRUMB
GR-GRANULAR
SBK-SUBANGULAR BLOCKY
ABK-ANGULAR BLOCKY
PL-PLATY
PR-PRISMATIC

MINERALOGY

SLIGHTLY EXPANSIVE
EXPANSIVE

Show profile locations and other site features (dimensions, references or benchmark, and North)

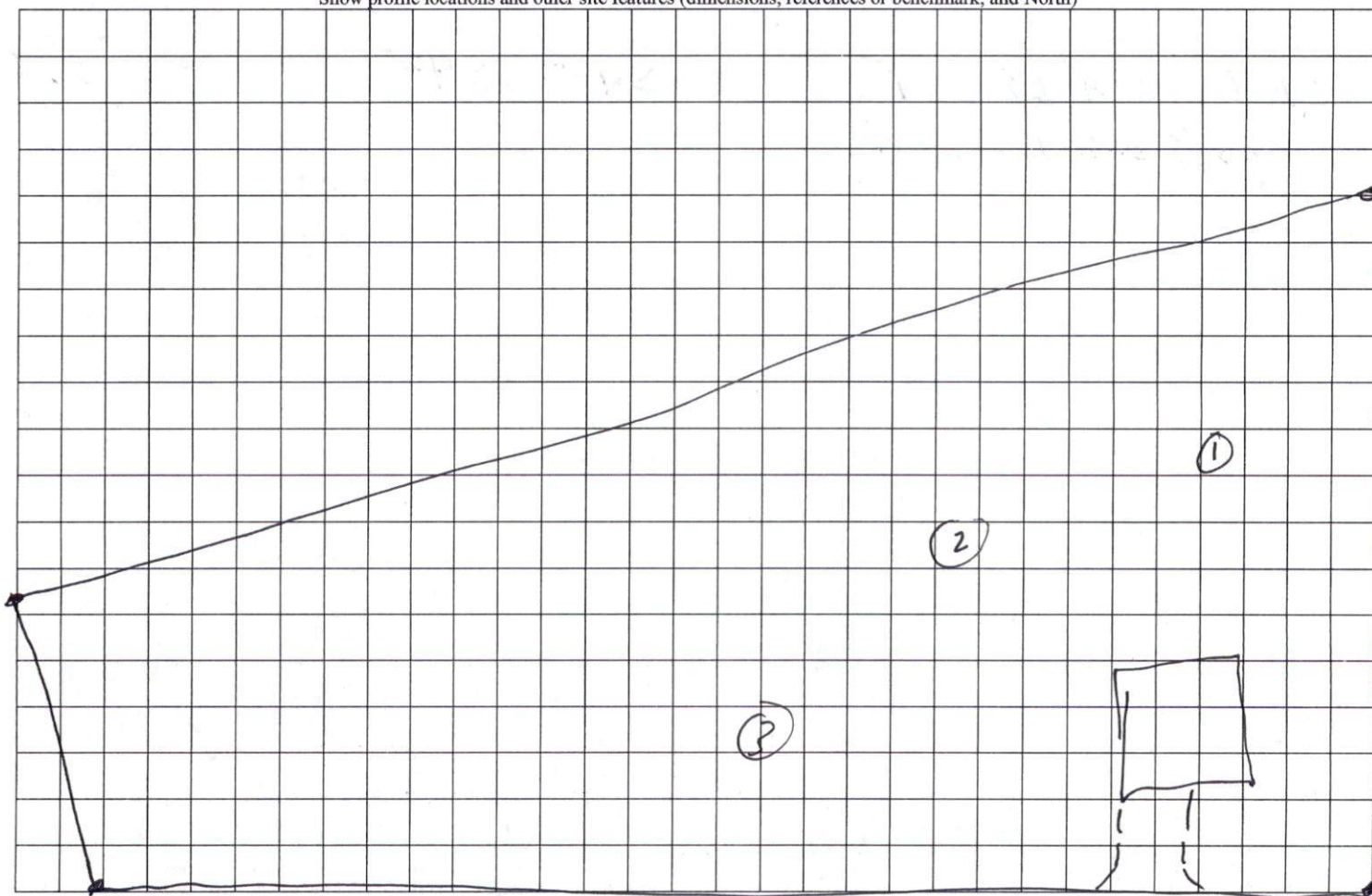

Dove Rd