



ROOF & FLOOR TRUSSES & BEAMS

Reilly Road Industrial Park
Fayetteville, N.C. 28309
Phone: (910) 864-8787
Fax: (910) 864-4444

Bearing reactions less than or equal to 3000# are deemed to comply with the prescriptive Code requirements. The contractor shall refer to the attached Tables (derived from the prescriptive Code requirements) to determine the minimum foundation size and number of wood studs required to support reactions greater than 3000# but not greater than 15000#. A registered design professional shall be retained to design the support system for any reaction that exceeds those specified in the attached Tables. A registered design professional shall be retained to design the support system for all reactions that exceed 15000#.

Signature Lenny Norris

Lenny Norris

LOAD CHART FOR JACK STUDS

(BASED ON TABLES R502.5(1) & (b))

NUMBER OF JACK STUDS REQUIRED @ EA END OF HEADER/GIRDER

END REACTION (UP TO)	REQ'D STUDS FOR (1) FLY HEADER	END REACTION (UP TO)	REQ'D STUDS FOR (1) FLY HEADER	END REACTION (UP TO)	REQ'D STUDS FOR (1) FLY HEADER
1700	1	2550	1	3400	1
3400	2	5100	2	6800	2
5100	3	7650	3	10200	3
6800	4	10200	4	13600	4
8500	5	12750	5	17000	5
10200	6	15300	6		
11900	7				
13600	8				
15300	9				

CITY / CO.	Sanford / Harnett
ADDRESS	274 Boyce Court
MODEL	ROOF
DATE REV.	/ /
DRAWN BY	Lenny Norris
SALES REP.	Lenny Norris

BUILDER	Weaver Homes, Inc.
JOB NAME	Lot 53 West Preserve
PLAN	The Highland / Mod
SEAL DATE	Seal Date
QUOTE #	Quote #
JOB #	J0225-1078

THIS IS A TRUSS PLACEMENT DIAGRAM ONLY. These trusses are designed as individual building components to be incorporated into the building design at the specification of the building designer. See individual design sheets for each truss design identified on the placement drawing. The building designer is responsible for temporary and permanent bracing of the roof and floor system and for the overall structure. The design of the truss support structure including headers, beams, walls, and columns is the responsibility of the building designer. For general guidance regarding bracing, consult BCSI-B1 and BCSI-B3 provided with the truss delivery package or online @ sbcindustry.com

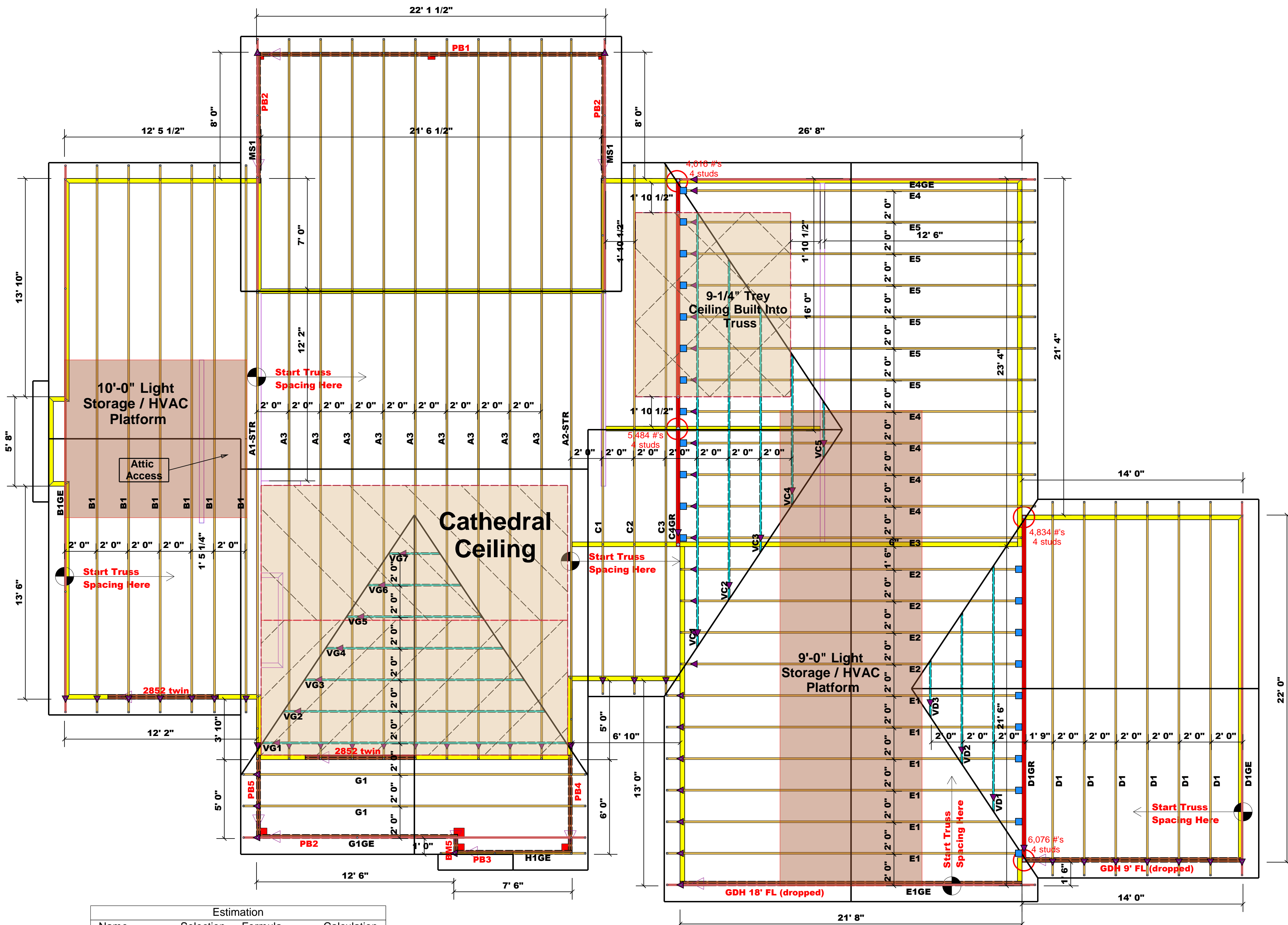

Estimation			
Name	Selection	Formula	Calculation
Roof Area	1st Floor	Roof Area	3702.09
Roof Decking	1st Floor	Roof Decking	127

BEAM LEGEND					
PlotID	Length	Product	Plies	Net Qty	Fab Type
2852 twin	7'-00'-00	1-3/4"x 9'-1/4" LVL Kerto-S	2	4	FF
GDH 9' FL (dropped)	14'-00'-00	1-3/4"x 11'-7/8" LVL Kerto-S	2	2	FF
GDH 18' FL (dropped)	22'-00'-00	1-3/4"x 14" LVL Kerto-S	2	2	FF
PB1	24'-00'-00	2x10 SP No.2	2	2	FF
PB2	14'-00'-00	2x10 SP No.2	2	2	FF
PB3	8'-00'-00	2x10 SP No.2	2	2	FF
PB4	8'-00'-00	2x10 SP No.2	2	2	FF
PB5	6'-00'-00	2x10 SP No.2	2	2	FF

HUS26	USP	22	NA	16d/3-1/2"	16d/3-1/2"
-------	-----	----	----	------------	------------

Hatch Legend

= LOAD BEARING WALLS @ 9'-1-8 HGT.

Truss Placement Plan

SCALE: 1/4" = 1'-0"

▲ = Denotes Left End of Truss
(Reference Engineered Truss Drawing)

All Truss Reactions are Less than 3,000 lbs. Unless Noted Otherwise.

-- Denotes Reaction Greater than 3,000 lbs. Reaction / # of Studs



ROOF & FLOOR TRUSSES & BEAMS

Reilly Road Industrial Park
Fayetteville, N.C. 28309
Phone: (910) 864-8787
Fax: (910) 864-4444

Bearing reactions less than or equal to 3000# are deemed to comply with the prescriptive Code requirements. The contractor shall refer to the attached Tables (derived from the prescriptive Code requirements) to determine the minimum foundation size and number of wood studs required to support reactions greater than 3000# but not greater than 15000#. A registered design professional shall be retained to design the support system for any reaction that exceeds those specified in the attached Tables. A registered design professional shall be retained to design the support system for all reactions that exceed 15000#.

Signature Lenny Norris

Lenny Norris

LOAD CHART FOR JACK STUDS

(BASED ON TABLES R502.5(1) & (b))

NUMBER OF JACK STUDS REQUIRED @ EA END OF HEADER/GIRDER

END REACTION (UP TO)	REQ'D STUDS FOR (1) 1" X 4" HEADER	END REACTION (UP TO)	REQ'D STUDS FOR (1) 1" X 4" HEADER	END REACTION (UP TO)	REQ'D STUDS FOR (1) 1" X 4" HEADER
1700	1	2550	1	3400	1
3400	2	5100	2	6800	2
5100	3	7650	3	10200	3
6800	4	10200	4	13600	4
8500	5	12750	5	17000	5
10200	6	15300	6		
11900	7				
13600	8				
15300	9				

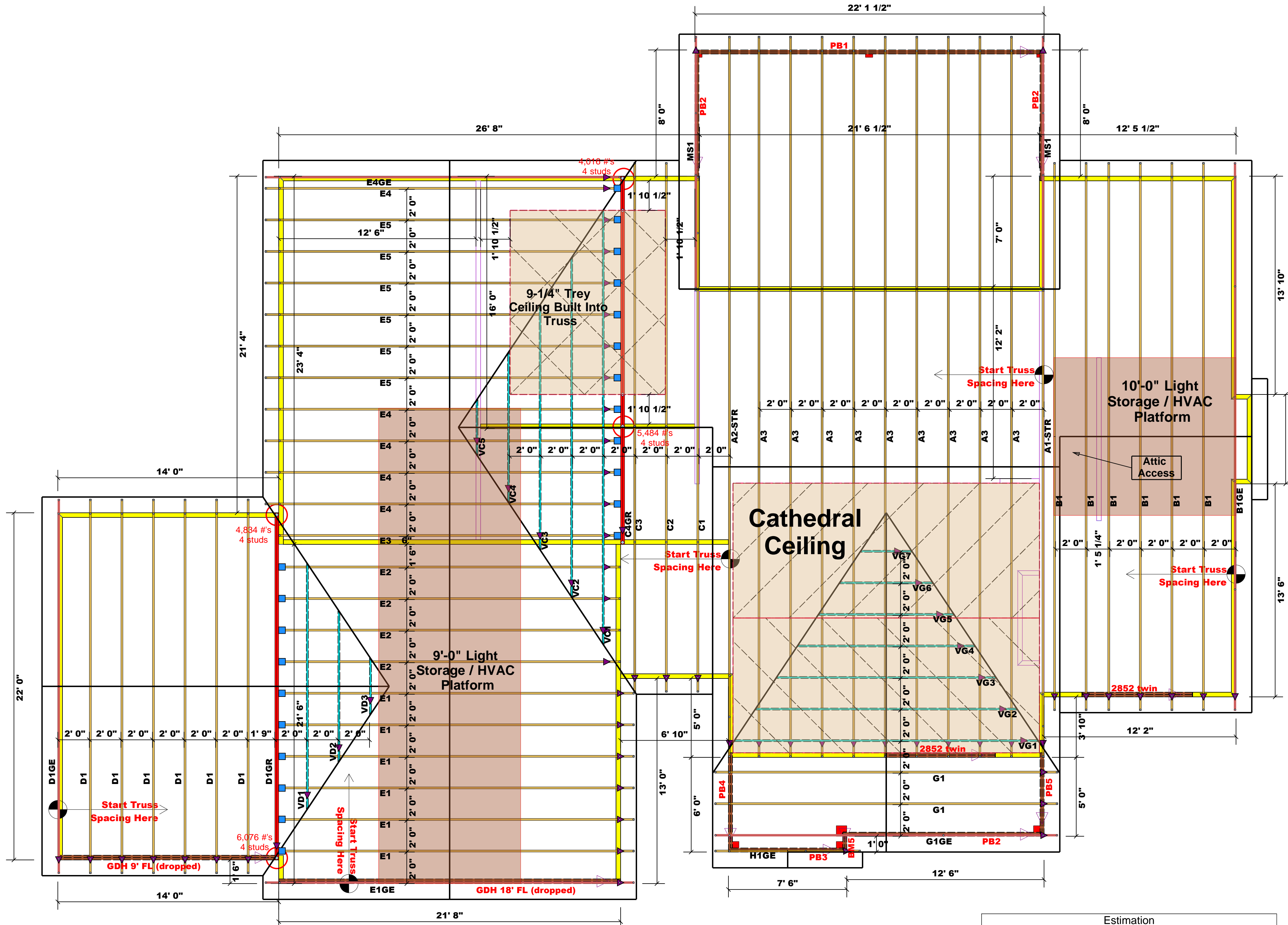

▲ = Denotes Left End of Truss
(Reference Engineered Truss Drawing)

All Truss Reactions are Less than 3,000 lbs. Unless Noted Otherwise.

-- Denotes Reaction Greater than 3,000 lbs. Reaction / # of Studs

HUS26	USP	22	NA	16d/3-1/2"	16d/3-1/2"
-------	-----	----	----	------------	------------

Hatch Legend

[Yellow Box] = LOAD BEARING WALLS @ 9-1-8 HGT.

Truss Placement Plan

SCALE: 1/4" = 1'-0"

Estimation			
Name	Selection	Formula	Calculation
Roof Area	1st Floor	Roof Area	3702.09
Roof Decking	1st Floor	Roof Decking	127

BEAM LEGEND					
PlotID	Length	Product	Plies	Net Qty	Fab Type
2852 twin	7' 0"	1-3/4"x 9-1/4" LVL Kerto-S	2	4	FF
GDH 9' FL (dropped)	14' 0"	1-3/4"x 11-7/8" LVL Kerto-S	2	2	FF
GDH 18' FL (dropped)	22' 0"	1-3/4"x 14" LVL Kerto-S	2	2	FF
PB1	24' 0"	2x10 SP No.2	2	2	FF
PB2	13' 0"	2x10 SP No.2	2	2	FF
PB3	8' 0"	2x10 SP No.2	2	2	FF
PB4	7' 0"	2x10 SP No.2	2	2	FF
PB5	6' 0"	2x10 SP No.2	2	2	FF

BUILDER	CITY / CO.	Sanford / Harnett
JOB NAME	ADDRESS	274 Boyce Court
PLAN	MODEL	ROOF
SEAL DATE	DATE REV.	/ /
QUOTE #	DRAWN BY	Lenny Norris
JOB #	SALES REP.	Lenny Norris

THIS IS A TRUSS PLACEMENT DIAGRAM ONLY. These trusses are designed as individual building components to be incorporated into the building design at the specification of the building designer. See individual design sheets for each truss design identified on the placement drawing. The building designer is responsible for temporary and permanent bracing of the roof and floor system and for the overall structure. The design of the truss support structure including headers, beams, walls, and columns is the responsibility of the building designer. For general guidance regarding bracing, consult BCSI-B1 and BCSI-B3 provided with the truss delivery package or online @ sbcindustry.com