

LOAD CHART FOR JACK STUDS			
(BASED ON TABLES R502.5(1) & (b))			
NUMBER OF JACK STUDS REQUIRED @ EA END OF HEADER/GIRDER			
END REACTION (UP TO)	REQ'D STUDS FOR (2) PLY HEADER	END REACTION (UP TO)	REQ'D STUDS FOR (3) PLY HEADER
1700	1	2550	1
3400	2	5100	2
5100	3	7650	3
6800	4	10200	4
8500	5	12750	5
10200	6	15300	6
11900	7		
13600	8		
15300	9		

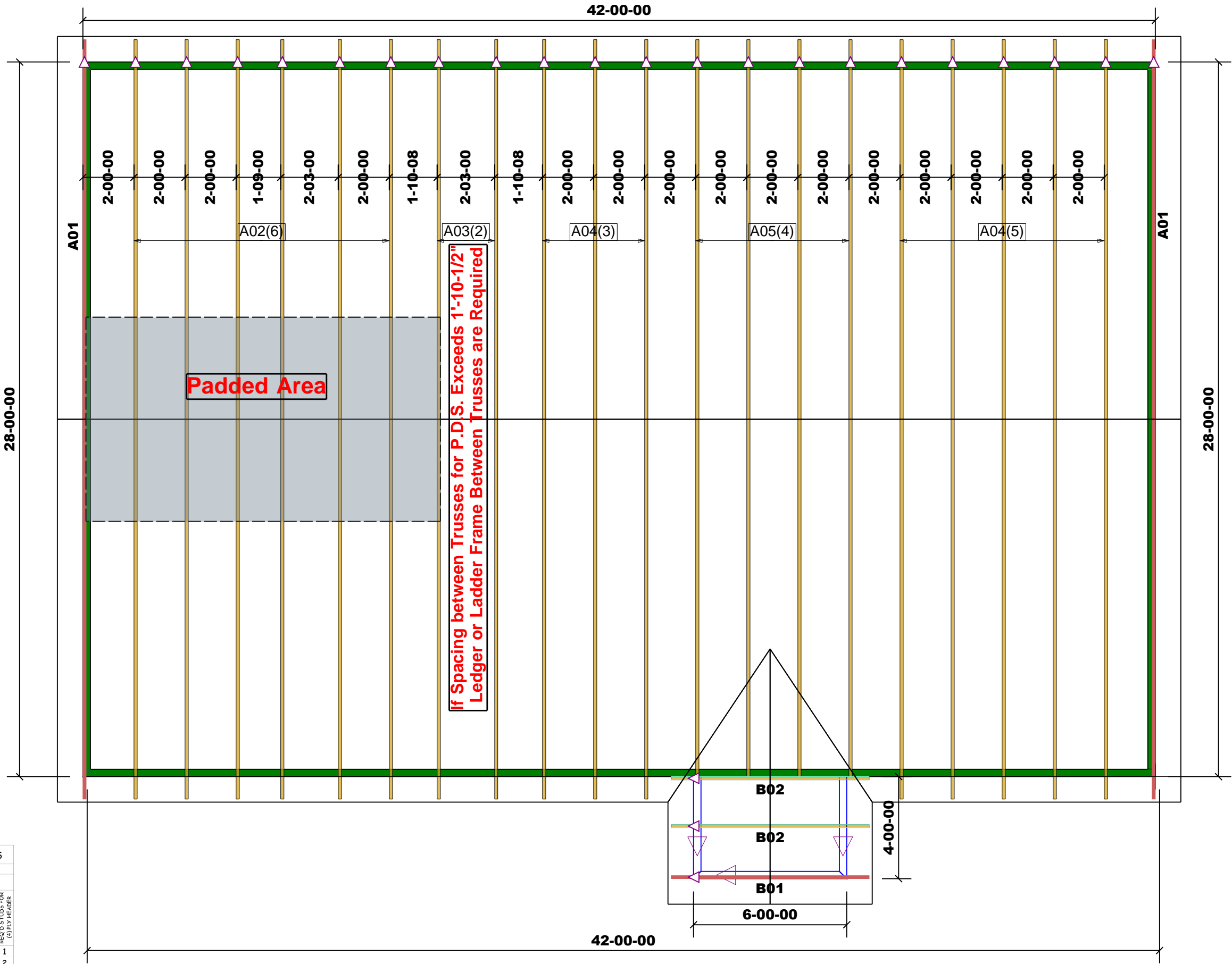

TRUSS PLACEMENT PLAN
SCALE: 3/16" = 1'-0"

△= Denotes Left End On Truss(s)
(Refer To Engineered Truss Drawings)



ROOF & FLOOR
TRUSSES & BEAMS

Reilly Road Industrial Park
Fayetteville, N.C. 28309
Phone: (910) 864-8787
Fax: (910) 864-4444

THIS IS A TRUSS PLACEMENT DIAGRAM ONLY.

These trusses are designed as individual building components to be incorporated into the building design at the specification of the building designer. See individual design sheets for each truss design identified on the placement drawing. The building designer is responsible for temporary and permanent bracing of the roof and floor system and for the overall structure. The design of the truss support structure including headers, beams, walls, and columns is the responsibility of the building designer. For general guidance regarding bracing, consult BCSI-B1 and BCSI-B3 provided with the truss delivery package or online @ sbcindustry.com

Bearing reactions less than or equal to 3000# are deemed to comply with the prescriptive Code requirements. The contractor shall refer to the attached Tables (derived from the prescriptive Code requirements) to determine the minimum foundation size and number of wood studs required to support reactions greater than 3000# but not greater than 15000#. A registered design professional shall be retained to design the support system for any reaction that exceeds those specified in the attached Tables. A registered design professional shall be retained to design the support system for all reactions that exceed 15000#.

Marshall

Signature: Marshall Naylor

BUILDER	Red Door Homes	CITY / CO.	Angier / Harnett
JOB NAME	109-24-133 Ryals	ADDRESS	763 Butts Rd.,
PLAN	Aspen	MODEL	Roof
SEAL DATE	N/A	DATE REV.	03/27/25
QUOTE #		DRAWN BY	Marshall Naylor
JOB #	J0325-1502	SALES REP.	Marshall Naylor