

Harnett County Department of Public Health

PERMIT # SFD 2502-0104

Operation Permit

☒ New Installation ☒ Septic Tank ☒ Nitrification Line ☐ Repair ☐ Expansion

PROPERTY LOCATION: 63 Laforce Ln (SR 1284)

SUBDIVISION Brayden Preserve

LOT # 62

Name: (owner) LGI Homes

System Installer: Quality Septic

Basement with plumbing: ☐ Garage ☒ Number of Bedrooms 3 (6 people)

Type of Water Supply: ☐ Community ☒ Public ☐ Well Distance from well _____ feet

System Type: TYPE III B Types V and VI Systems expire in 5 years.

(In accordance with Table V a)

Owner must contact Health Department 6 months prior to expiration for permit renewal.

This system has been installed in compliance with applicable North Carolina General Statutes, Rules for Sewage Treatment and Disposal, and all conditions of the Improvement Permit and Construction Authorization.

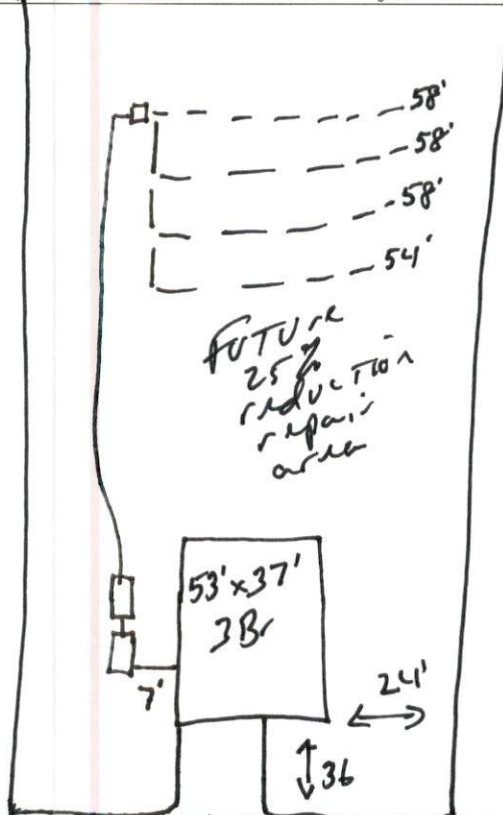

PERMIT CONDITIONS:

- I. Performance: System shall perform in accordance with Rule .1961.
- II. Monitoring: As required by Rule .1961.
- III. Maintenance: As required by Rule .1961. Other: _____
Subsurface system operator required? Yes ☐ No ☒
If yes, see attached sheet for additional operation conditions, maintenance and reporting.

- IV. Operation: _____
- V. Other: _____

☒ D-Box ☒ Pump ☒ Alarm ☐ H2O Line ☐ PWR Line

Following are the specifications for the sewage disposal system on the above captioned property.

Type of system: ☐ Conventional ☒ Other 25% reduction TQ4 Septic Tank: 1000 gallons Pump Tank: 1000 gallons

Subsurface No. of exact length width of depth of
Drainage Field ditches 1 of each ditch 228 feet ditches 3 feet ditches 24 inches

French Drain Required: _____ Linear feet

Authorized State Agent

Mal A. Dett

Date 8-18-25