

I, MICHAEL P. GRIFFIN, certify that under my direction and supervision this map was drawn from an actual field survey; that the error of closure of the survey as calculated by coordinates is 1: 10,000+; that the area shown hereon was calculated by coordinates. Dashed lines shown hereon were not surveyed.

Witness my hand and seal this 23RD day of MAY 2025.

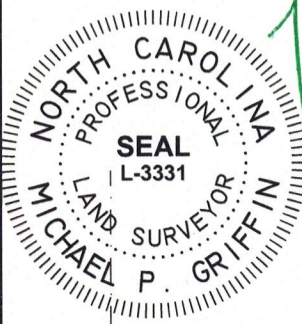

*Handwritten signature and date:*  
5.23.25

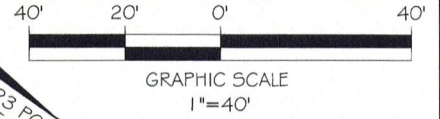

BK 2023 PG 381  
HARNETT CO. REGISTRY

S37°47'14"W 158.61'  
TIE  
EIP  
10' CAPED EIP  
LOT 95

N 37°47'14"E

4  
N/F  
FRANK JOSEPH VUTURO, JR.  
& WIFE,  
KAREN W. VUTURO  
DB 3869, PG 930  
PB 2020, PG 165

94

29,519 SF  
0.68 AC

10' UTILITY EASEMENT

ELEC PED  
LP

EIS

WHIMBREL COURT

50' PUBLIC RW & UTILITY ACCESS

EIS

93

S 11°42'43"E

232.72'

288.10'

EIP

ZONING: RA-30  
SETBACKS

FRONT 35'  
REAR 25'  
SIDE 10'  
CORNER SIDE 20'

CI R=50.00' L=57.96' S45°04'38"W 54.77'

THIS PROPERTY IS NOT LOCATED  
IN THE 100 YEAR FLOOD ZONE.

#### LEGEND

EIP	EXISTING IRON PIPE	FES	FLARED END SECTION
IPS	IRON PIPE SET	WM	WATER METER
R/W	RIGHT OF WAY	CO	CLEAN OUT
N/F	NOW OR FORMERLY	FH	FIRE HYDRANT
EIS	EXISTING IRON STAKE	CB	CATCH BASIN

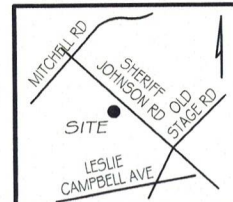

GRIFFIN LAND SURVEYING, INC.

P.O. BOX 148  
FUQUAY-VARINA, NC 27526  
(919) - 567 - 1963

FIRM LIC.# C-1345

FOUNDATION SURVEY  
FOR

DRB HOMES

BLAKE POND SUBDIVISION

LOT 94

149 WHIMBREL COURT

LILLINGTON, N.C.

HARNETT COUNTY NEILL'S CREEK & GROVE TOWNSHIP

DRAWN BY KDF

DATE 5/23/25

CHECKED BY MPG

SCALE 1" = 40'