

NOTE : CONTRACTOR TO VERIFY ALL BUILDING SETBACKS PRIOR TO CONSTRUCTION.

NOTE : CONTRACTOR TO LOCATE UTILITY TIE-INS AND CONTACT LOCAL REGULATORY AGENCY PRIOR TO PAVING OVER WITH DRIVEWAY.

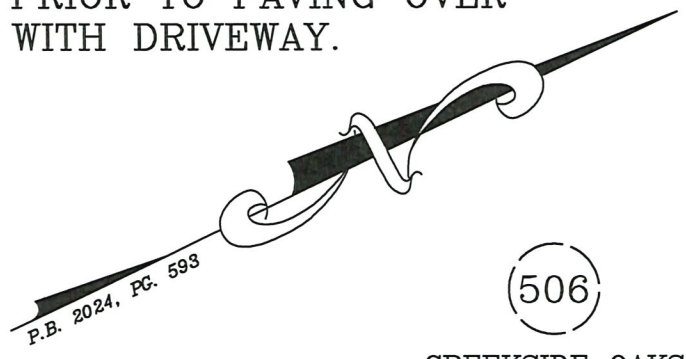

THE MAXIMUM ALLOWABLE BUILT UPON AREA FOR THIS RESIDENTIAL LOT IS 4,000 SQUARE FEET. THIS ALLOTTED AMOUNT INCLUDES ANY BUILT-UPON AREA CONSTRUCTED WITHIN THE LOT PROPERTY BOUNDARIES. BUILT UPON AREA INCLUDES, BUT IS NOT LIMITED TO, STRUCTURE FOOTPRINTS, ASPHALT, CONCRETE, GRAVEL, BRICK, STONE, SLATE, COQUINA AND PARKING AREAS, BUT DOES NOT INCLUDE RAISED, OPEN WOOD DECKING, OR THE WATER SURFACE OF SWIMMING POOLS.

IMPERVIOUS AREA:  
 HOUSE, PORCHES 1,634 SQ. FT.  
 DRIVEWAY, SIDEWALK 1,074 SQ. FT.  
 TOTAL 2,708 SQ. FT.

PLOT PLAN FOR: CAVINESS LAND  
 ADDRESS: HARBORWOOD STREET  
 CITY OF: LILLINGTON, NC  
 COUNTY OF: CUMBERLAND

**HARBORWOOD STREET**

50 FT. PUBLIC R/W  
 (PUBLIC & UTILITY ACCESS)

ZONING: RA-20R  
 SETBACKS:  
 FRONT - 35'  
 REAR - 25'  
 SIDE - 10'

**PLOT PLAN**

TOWNSHIP OF: ANDERSON CREEK

DATE: JANUARY 20TH, 2025

SCALE: 1" = 20'

REFERENCE: LOT 505  
 CREEKSIDE OAKS SOUTH  
 P.B. 2024, PG. 593

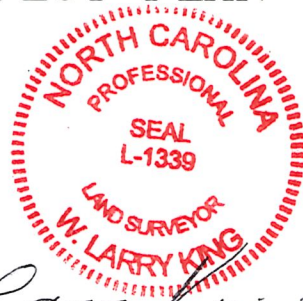

*W. Larry King*  
 W. LARRY KING, PLS - L-1339

**Larry King & Associates, R.L.S., P.A.**

P.O. Box 53787  
 1333 Morganton Road, Suite 201  
 Fayetteville, NC 28305  
 Phone: (910)483-4300  
 Fax: (910)483-4052  
 www.LKandA.com  
 NC Firm License C-0887

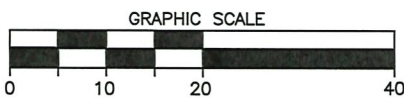

I, W. LARRY KING, CERTIFY THAT THIS MAP IS FOR THE PURPOSE OF PERMITTING ONLY, IT IS NOT A SURVEY AND NO RELIANCE MAY BE PLACED ON ITS ACCURACY. THE STRUCTURE SHOWN ON THIS PLOT PLAN IS PLACED ACCORDING TO THE INSTRUCTIONS GIVEN BY THE BUILDER. ALL DIMENSIONS AND SETBACKS SHOULD BE VERIFIED FOR COMPLIANCE WITH ZONING AND COVENANTS.

THIS MAP CAN NOT BE USED FOR RECORDATION OR ATTACHED TO A DEED TO BE RECORDED. THIS MAP IS NOT DRAWN IN ACCORDANCE WITH GS 47-30.

THE BOUNDARY AND LOT INFORMATION SHOWN ON THIS MAP IS TAKEN FROM THAT DOCUMENT DESCRIBED IN THE "REFERENCE" LINE SHOWN HEREON. THIS INFORMATION SHOULD BE CONFIRMED AS THE MOST CURRENT FOR THIS PROPERTY BEFORE ISSUANCE OF PERMITS OR COMMENCEMENT OF CONSTRUCTION. NO TITLE SEARCH WAS PERFORMED ON THIS PROPERTY BY THIS SURVEYOR.