



**ECS Southeast, LLC**  
 6151 Raeford Road, Suite A  
 Fayetteville, NC 28304  
**T** 910.401.3288  
**F** 910.323.0539

## LETTER OF TRANSMITTAL

March 06, 2025  
 Wellco Contractors Inc

Spring Lake, NC 28390  
 ATTN: Cliff McLamb

RE: **Hidden Lakes North- Lot 132**  
 ECS Job # **33:7257-F**

Permits:  
 Location: **21 Blackgum Ct**  
**Spring Lake, NC 28390**

☒ Field Reports ☒ For your use ☒ As requested

CC:

ENCL: Field Report # 1 3/4/2025



**MAR 06 2025**

Jack Cowsert, P.E.  
 Office Manager

*Ryan H. Parrish*

Ryan H. Parrish  
 CMT Group Supervisor

### Disclaimer

1. This report (and any attachments) shall not be reproduced except in full without prior written approval of ECS.
2. The information in this report relates only to the activities performed on the report date.
3. Where appropriate, this report includes statements as to compliance with applicable project drawings, and specifications for the activities, performed on this report date.
4. Incomplete or non-conforming work will be reported for future resolution.
5. The results of samples and/or specimens obtained or prepared for subsequent laboratory testing will be presented in separate reports/documents.



**ECS Southeast, LLC**  
 6151 Raeford Road, Suite A  
 Fayetteville, NC 28304  
 T 910.401.3288  
 F 910.323.0539

## FIELD REPORT

Project **Hidden Lakes North- Lot 132**  
 Location **Spring Lake, NC**  
 Client **Wellco Contractors Inc**  
 Contractor **None Listed**

Project No. **33:7257-F**  
 Report No. **1**  
 Day & Date **Tuesday 3/4/2025**  
 Weather **60 °/ Sunny**  
 On-Site Time **1.25**  
 Lab Time **0.00**  
 Travel Time\* **0.00**  
 Total **1.25**  
 Re Obs Time **0.00**

### Remarks

Trip Charges*	Tolls/Parking*	Mileage*	Time of Arrival	Departure
Chargeable Items			<b>11:15A</b>	<b>12:30P</b>

\* Travel time and mileage will be billed in accordance with the contract.

### Summary of Services Performed (field test data, locations, elevations & depths are estimates) & Individuals Contacted.

ECS arrived on site, as requested, to check the bearing capacity of soils via hand auger/DCP method for the preliminary foundation footings for Lot 132. Please see the attached sketch and data sheet for details.

A total of 4 hand auger/DCP evaluations were performed to a depth of approximately 4 feet below the current footing subgrade elevation.

Based on the test results, the materials in place (at the locations and elevations tested) did appear to be suitable to support the design bearing capacity of 2,000 psf.

ECS will return, as requested, for additional services.



ECS Southeast, LLC  
 Fayetteville, NC  
 Phone: 910-401-3288

## DYNAMIC CONE PENETROMETER TEST REPORT

Hidden Lakes North Lot 132								Design Bearing Capacity: 2000 psf				
Project No: 7257-F								Native Soil				
Technician:Harvey Sangster												
Date:3/4/2025												
Test Location	Water Table Depth	Test Depth	Footing Dimensions	Penetrometer Blow Counts				Remarks/Soil Descriptions				
				1 3/4"	1 3/4"	1 3/4"	Average					
SE												
1		-1		5	6	8	7	Orange Clay Sand				
1		-2		9	6	7	6.5	Orange Clay Sand				
1		-3		11	6	8	7	Orange Clay Sand				
1		-4		9	9	7	8	Orange Clay Sand				
NE												
2		-1		4	5	4	4.3	Tan Sand				
2		-2		8	6	9	7.6	Tan Sand				
2		-3		8	9	8	8.3	Orange Clay Sand				
2		-4		11	9	7	9	Orange Clay Sand				
NW												
3		-1		9	15		8	Tan Sand				
3		-2		6	10	8	8	Tan Sand				
3		-3		7	7	8	7.3	Tan Sand				
3		-4		10	10	9	9.6	Orange Sandy Clay				
SW												
4		-1		8	8	8	8	Tan Sand				
4		-2		8	6	7	7	Tan Sand				
4		-3		10	10	8	9.3	Tan Sand				
4		-4		7	8	9	8	Tan Sand				

--	--	--	--	--	--	--	--	--

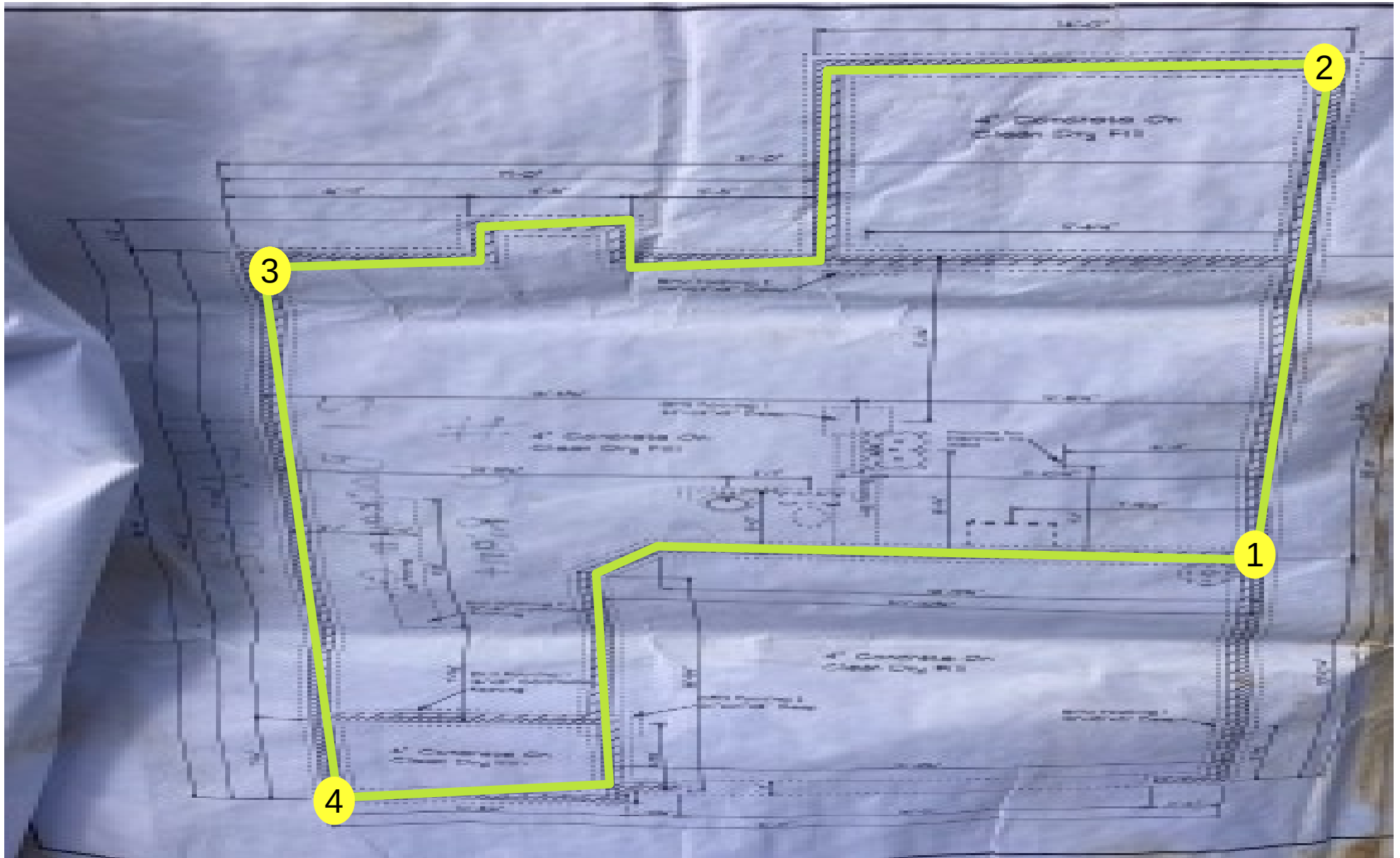

Harvey Sangster  
 03/4/2025  
 Hidden Lakes North  
 lot 132  
 Proj #: 7257-F  
 W/O # 83031

**Key**  
 Preliminary  
 Footing Location  
  
 DCP Test Location



Transmittal Page 5/7



NORTH



## Attachments



1

Figure 1



2

Figure 2

## Attachments



3

Figure 3



4

Figure 4