

**ECS Southeast, LLC**

6151 Raeford Road, Suite A

Fayetteville, NC 28304

T 910.401.3288

F 910.323.0539

LETTER OF TRANSMITTAL

April 03, 2025
 Wellco Contractors Inc
 511 Hwy 210 North
 Spring Lake, NC 28390
 ATTN: Cliff McLamb

RE: **Hidden Lakes North- Lot 132**ECS Job # **33:7257-F**

Permits:

 Location: **21 Blackgum Ct
 Spring Lake, NC 28390**
☒

Field Reports

☒

For your use

☒

As requested

CC:

ENCL: Field Report # 2 4/1/2025



Jack Cowser, P.E.
 Office Manager

APR 03 2025

Ryan H. Parrish
 CMT Group Supervisor

Disclaimer

1. This report (and any attachments) shall not be reproduced except in full without prior written approval of ECS.
2. The information in this report relates only to the activities performed on the report date.
3. Where appropriate, this report includes statements as to compliance with applicable project drawings, and specifications for the activities, performed on this report date.
4. Incomplete or non-conforming work will be reported for future resolution.
5. The results of samples and/or specimens obtained or prepared for subsequent laboratory testing will be presented in separate reports/documents.



ECS Southeast, LLC
 6151 Raeford Road, Suite A
 Fayetteville, NC 28304
 T 910.401.3288
 F 910.323.0539

FIELD REPORT

Project **Hidden Lakes North- Lot 132**
 Location **Spring Lake, NC**
 Client **Wellco Contractors Inc**
 Contractor **None Listed**

Project No. **33:7257-F**
 Report No. **2**
 Day & Date **Tuesday 4/1/2025**
 Weather **73 °/ Partly Cloudy**
 On-Site Time **1.00**
 Lab Time **0.00**
 Travel Time* **0.00**
 Total **1.00**
 Re Obs Time **0.00**

Remarks

Trip Charges*	Tolls/Parking*	Mileage*	Time of Arrival	Departure
Chargeable Items			10:00A	11:00A

* Travel time and mileage will be billed in accordance with the contract.

Summary of Services Performed (field test data, locations, elevations & depths are estimates) & Individuals Contacted.

ECS arrived on site, as requested, to check the stability of soils via hand auger/DCP method for the stem wall backfill for lots 132. Please see the attached sketch and data sheet for details.

A total of 3 hand auger/DCP evaluations were performed to a depth of approximately 3 feet below the current footing subgrade elevation.

Based on the test results, the materials in place (at the locations and elevations tested) did appear to be suitable to support the design bearing capacity of 2,000 psf.

ECS will return, as requested, for additional services.

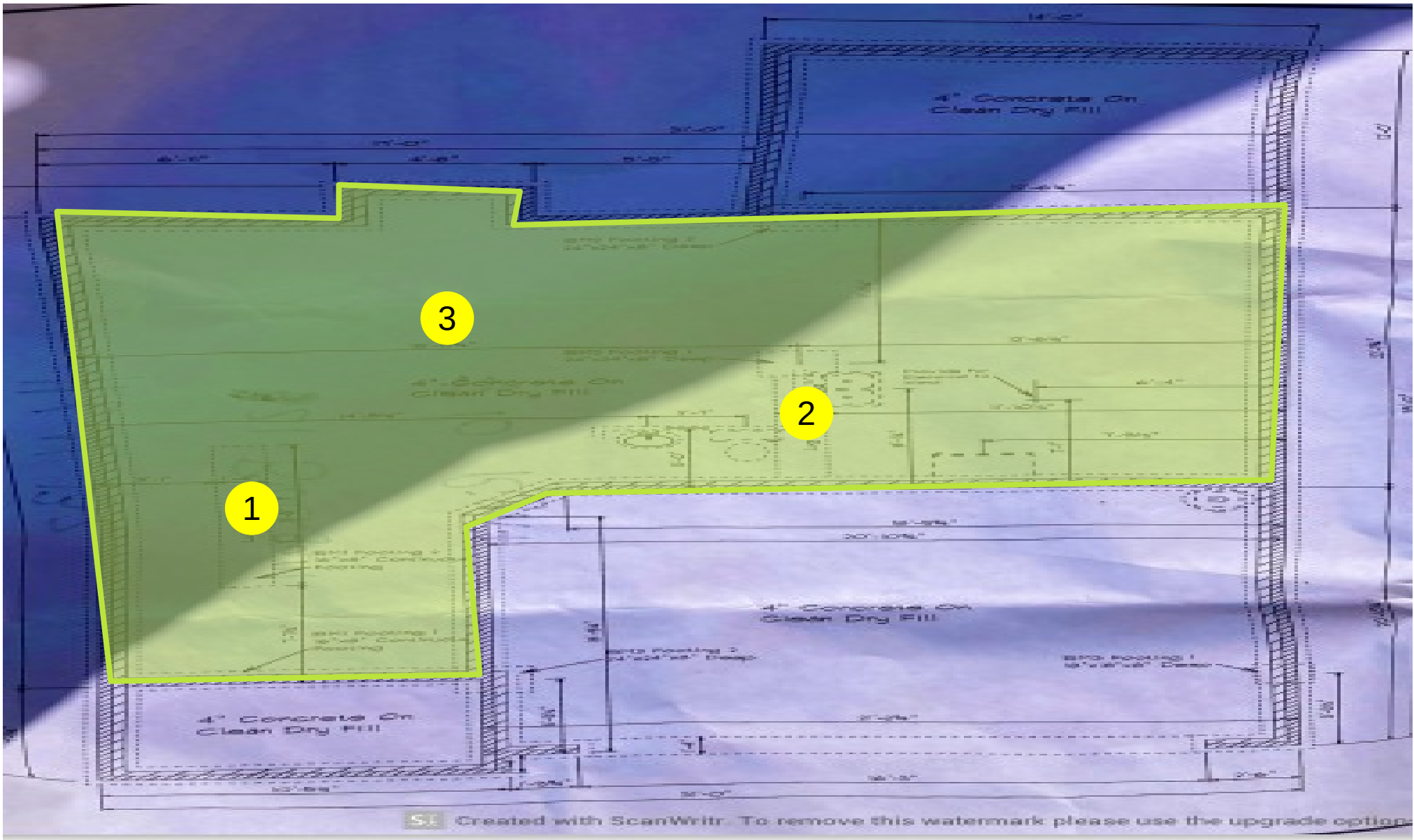

Harvey Sangster
 04/01/2025
 Hidden Lakes North Lot 132
 Proj #: 7257-F
 W/O #83651

Key
 DCP Test
 Location =



Stem wall Footings =



Transmittal Page 3/6



NORTH





Report of Foundation Observations

Project: Hidden Lakes North- Lot 132
 Location: 21 Blackgum Ct
 Spring Lake - Cumberland - NC - 28390

ECS Project No. : 33:7257-F
 Date: 4/1/2025

General Location: Stem wall back fill
 Footing Type: Spread

Design Bearing Pressure: 2000

Test No.	Location	Size			Footing Bottom Elevation		Depth of Undercut	Description of Steel Placed	Description of Foundation Subgrade Material	Depth of Test*	Number of Blows
			Design	Actual	Design	Actual**					
1		W	0' 0"	0' 0"			0' 0"		(0/-1)Orange Clay Sand (-2/-3)Tan Sand	0	6,5,6
		D	0' 0"	0' 0"						-1	8,11,12
		L	0' 0"	0' 0"						-2	11,15+
										-3	7,9,8
2		W	0' 0"	0' 0"			0' 0"		(0/-1)Orange Clay Sand (-2/-3)Tan Sand	0	6,7,9
		D	0' 0"	0' 0"						-1	8,5,6
		L	0' 0"	0' 0"						-2	7,8,12
										-3	10,10,12
3		W	0' 0"	0' 0"			0' 0"		(0/-1)Orange Clay Sand (-2/-3)Tan Sand	0	5,6,4
		D	0' 0"	0' 0"						-1	9,13,12
		L	0' 0"	0' 0"						-2	5,9,9
										-3	8,9,10

* Depth of DCP, or other methods of determining the soil stiffness

** Subgrade elevation reported by any means the contractor provided

By: Harvey Lamar Sangster

ECS Southeast, LLC

WO: 83651

Attachments



1

Figure 1



2

Figure 2

Attachments



3

Figure 3