

- All bracing, blocking, beams, purlins @ 2'0" o.c., ledger, etc. provided by others.
- Roof truss to roof truss connections provided by Riverside Roof Truss.
- Truss to building connections provided by others.

Refer to Sealed drawings for connection detail of multiple ply trusses.

NOT ALL TRUSSES ARE SYMMETRICAL AND MAY NOT PERFORM CORRECTLY IF INSTALLED BACKWARDS. PLEASE REFER TO SEALS WHILE SETTING TRUSSES TO ENSURE TRUSSES ARE ORIENTED CORRECTLY

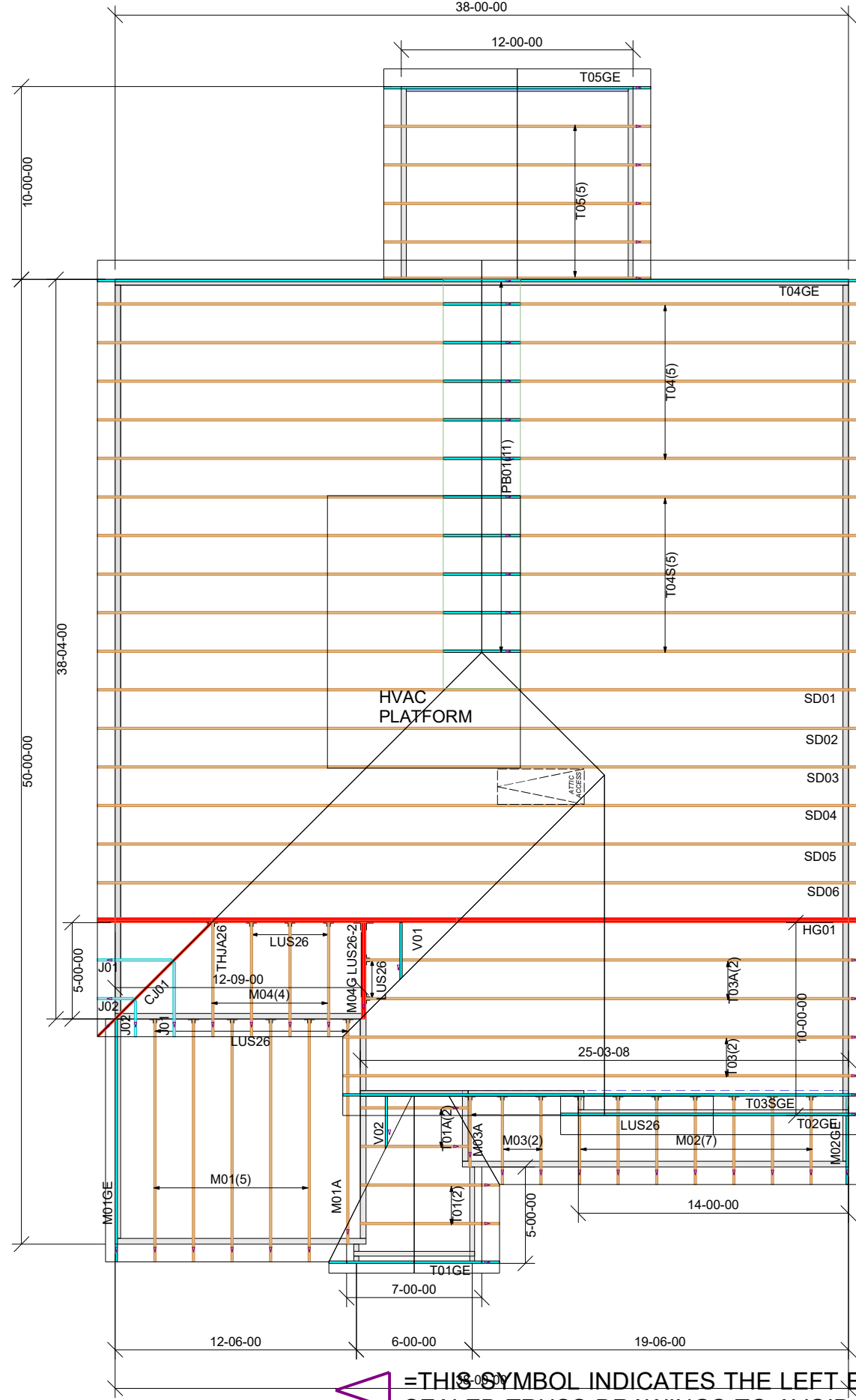

Truss Connector Total List		
Qty	Product	Manuf
5	LUS26	Simpson
1	LUS26-2	Simpson
1	THJA26	Simpson

Truss Connector Total List		
Qty	Product	Manuf
16	LUS26	Simpson

SHOP DRAWING APPROVAL
 THIS LAYOUT IS THE SOLE SOURCE FOR FABRICATION OF TRUSSES AND VOIDS ALL PREVIOUS ARCHITECTURAL OR OTHER TRUSS LAYOUTS. REVIEW AND APPROVAL OF THIS LAYOUT MUST BE RECEIVED BEFORE ANY TRUSSES WILL BE BUILT. VERIFY ALL CONDITIONS TO INSURE AGAINST CHANGES THAT WILL RESULT IN EXTRA CHARGES TO YOU.

REVIEWED BY: _____ APPROVED BY: _____ DATE: _____

Hanger Conversion Chart		Client: MATTAMY HOMES
USP	Simpson	Job Name: RVF-LOT #1 ROOF
JUS26	LUS26	Model: SEQUOIA-RH-FC-PORCH
THD26	HUS26	Lot #: 1
THD26-2	HHUS26-2	Subdivision: RIVERFALL
HJC26	THJA26	Order #: 24-6520-A
MSH422	THA422	Sales Rep: C Walden
		Designer: M N
		Date: 11/7/2024

733 RIVER PARK DRIVE
DANVILLE, VA 24540
(434) 793-0217
FAX: (434) 799-8767

RIVERSIDE ROOF TRUSS, LLC

Roof Surface Area: **2508** Sq. Ft.
 Floor Surface Area: **0** Sq. Ft.

