

Harnett County Department of Public Health

PERMIT # SFD2412-0021

Operation Permit

☒ New Installation ☒ Septic Tank ☒ Nitrification Line ☐ Repair ☐ Expansion

PROPERTY LOCATION: 131 Knoll way

Name: (owner) Smith Douglas Homes SUBDIVISION Briarwood Bluffs LOT # 7

System Installer: A+R

Basement with plumbing: ☐ Garage ☒ Number of Bedrooms 3 (6 people)

Type of Water Supply: ☐ Community ☒ Public ☐ Well Distance from well _____ feet

System Type: TYPE III g Types V and VI Systems expire in 5 years.

(In accordance with Table V a)

Owner must contact Health Department 6 months prior to expiration for permit renewal.

This system has been installed in compliance with applicable North Carolina General Statutes, Rules for Sewage Treatment and Disposal, and all conditions of the Improvement Permit and Construction Authorization.

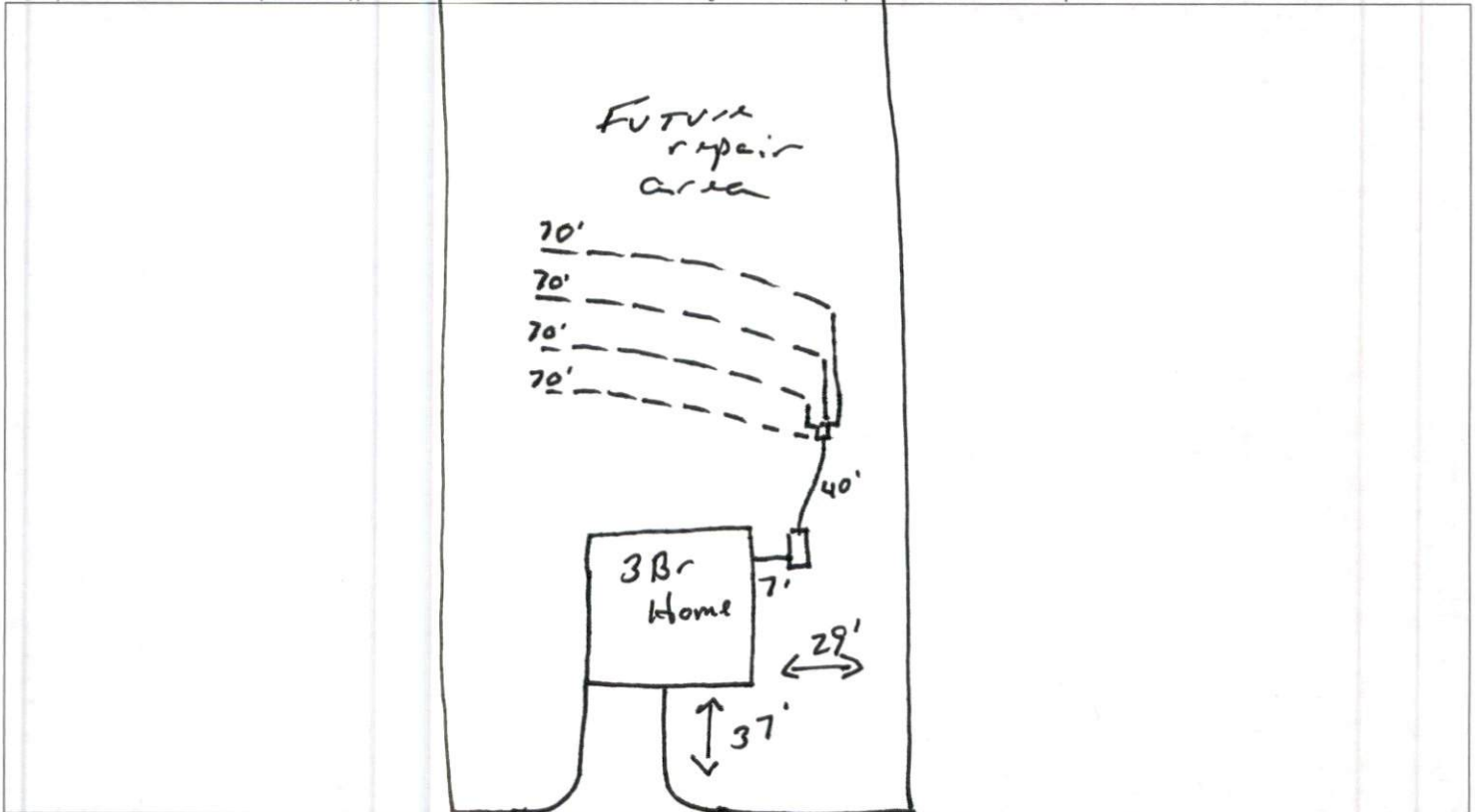

PERMIT CONDITIONS:

- I. Performance: System shall perform in accordance with Rule .1961.
 II. Monitoring: As required by Rule .1961.
 III. Maintenance: As required by Rule .1961. Other: _____
 Subsurface system operator required? Yes ☐ No ☒
 If yes, see attached sheet for additional operation conditions, maintenance and reporting.

IV. Operation: _____

V. Other: _____

☒ D-Box ☐ Pump ☐ Alarm ☐ H2O Line ☐ PWR Line

Following are the specifications for the sewage disposal system on the above captioned property.

Type of system: ☐ Conventional ☒ Other 25% reduction IGY Septic Tank: 1000 gallons Pump Tank: _____ gallons
 Subsurface No. of 4 exact length 70 feet width of 3 depth of 23 inches
 Drainage Field ditches 4 of each ditch 70 feet ditches 3 ditches 23 inches
 French Drain Required: _____ Linear feet

Authorized State Agent

Mohd R. REHS

Date

3-13-25

Briarwood Bluff Lot 7 System Detail "As Built"

1,106 SF
89 SF
K = 55 SF
Y = 617 SF
L20 SF
PREVIOUS = 1,987 SF
PREVIOUS = 9.19%

BACKS



Elevation Table

Benchmark = 100'
Line 1 = 99.0'
Line 2 = 98.9'
Line 3 = 98.8'
Line 4 = 98.6'
Line 5 = 98.3'
Line 6 = 98.8'
Line 7 = 98.6'
Line 8 = 98.2'

System Details "As Built"

Initial:
1060 gal Septic Tank
0.4 LTAR
Lines 1-4 (280')
Accepted - Gravity
Distribution - Parallel
Quick 4 Chamber
24" MTD

Repair:
1060 gal Septic Tank
0.45 LTAR
Lines 5-8 (280')
Accepted - Gravity
Distribution - Parallel
Product - EZ Flow
24" MTD

ED 5'
ILITY
MENT



0' 30'
1 inch = 30'

N82°29'22"E 92.00'

25' REAR SETBACK

LINE 8: RED 70'

LINE 7: YELLOW 70'

LINE 6: BLUE 70'

LINE 5: RED 70'

LINE 4: YELLOW 70'

LINE 3: PINK 70'

LINE 2: BLUE 70'

LINE 1: YELLOW 70'

0.496 AC

N7°30'38"W 235.00'

10' SIDE SETBACK

N7°30'38"W 235.00'

29.0'

29.0'

29.0'

35' FRONT SETBACK

37.0'

N82°29'22"E 92.00'

Benchmark = 100.0'

PROPOSED
LAWSON A
SLAB
2 CAR LEFT

PO

SW

DW

16.5'

Legend

Initial
Repair
End Cap

