

SOUTHEASTERN SOIL & ENVIRONMENTAL ASSOC., INC.

PROPOSED SUBSURFACE WASTE DISPOSAL SYSTEM DETAIL SHEET

SUBDIVISION: Blake Pond

LOT 105

^{GRAV}
INITIAL SYSTEM: APPROVED 25% REDUCTION

^{GRAV}
REPAIR Approved 50% Reduction

DISTRIBUTION: SERIAL OR P. Mani.

DISTRIBUTION SERIAL OR P. Mani

BENCHMARK: 100.0

LOCATION ToS FC 105/106

NO. BEDROOMS: 4

LTAR 0.35 gpd / F+2

LINE	FLAG COLOR	ELEVATION	LENGTH
1	W	99.67	50
I {	2	R	99.50
	3	W	99.33
	4	R	99.33
	5	W	99.25
	6	R	99.00
	7	W	45
			345
R {	8	R	99.67
	9	W	99.67
	10	R	99.50
	11	W	99.09
	12	R	99.09
			50
			250 AVAIL

BY B.C. Raynor

DATE 01/04/2023

TYPICAL PROFILE

THERE SHALL BE NO GRADING,

0-20 LS vfri gran

CUTTING, LOGGING OR OTHER SOIL

20-36 SCLAY firm SBK

DISTURBANCE IN SEPTIC AREA

Pm/cr 2 ≥ 36"

HEALTH DEPARTMENT USE ONLY.

DESIGNS DO NOT GURANTEE FUNCTIONALITY

Southeastern Soil & Environmental Associates, Inc.

P.O. Box 9321
Fayetteville, NC 28311
Phone/Fax (910) 822-4540
Email mike@southeasternsoil.com

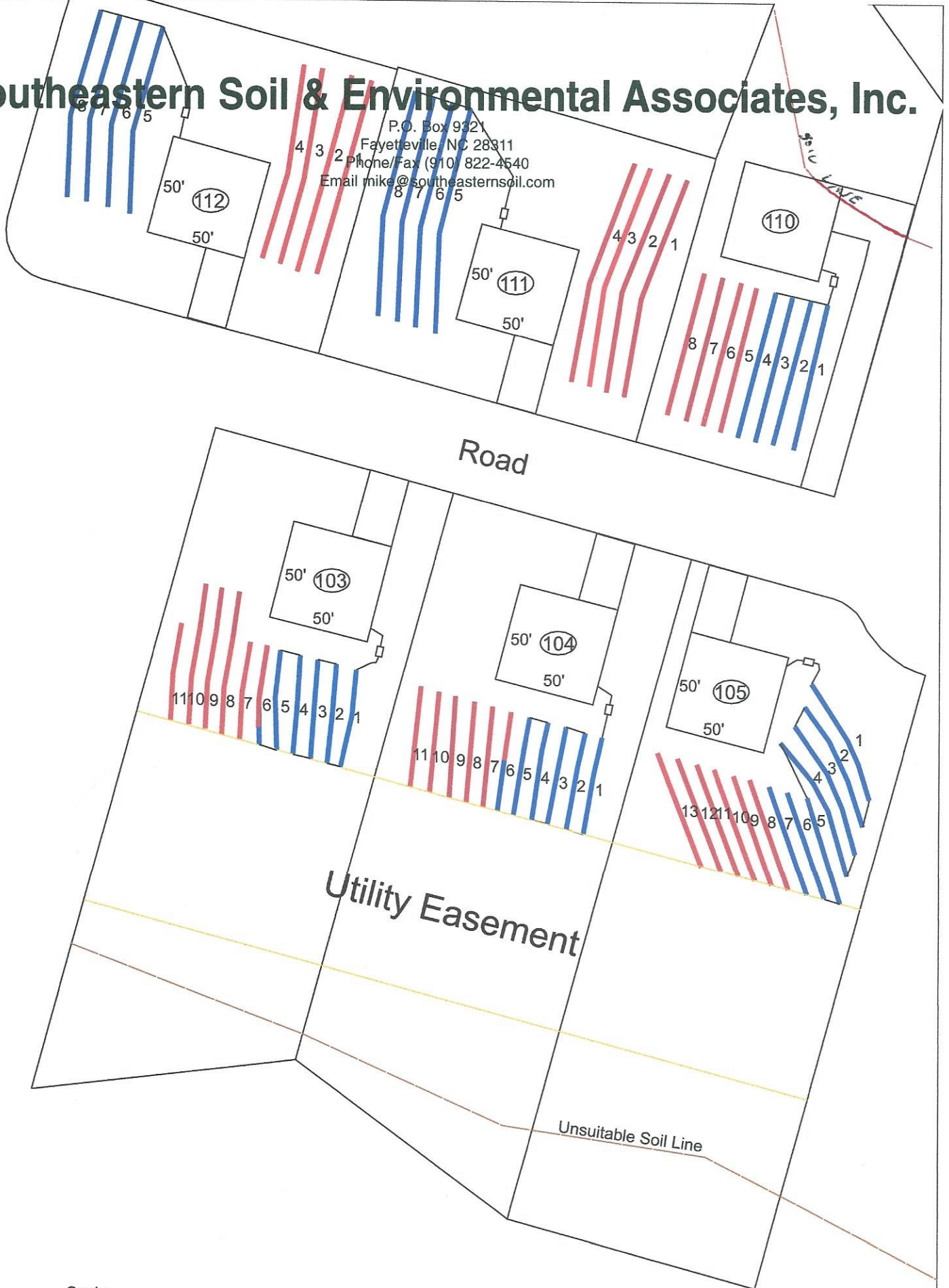

Scale
1:60

